

APPROVED: *R S DeLo*
DATE: 10/9/2023

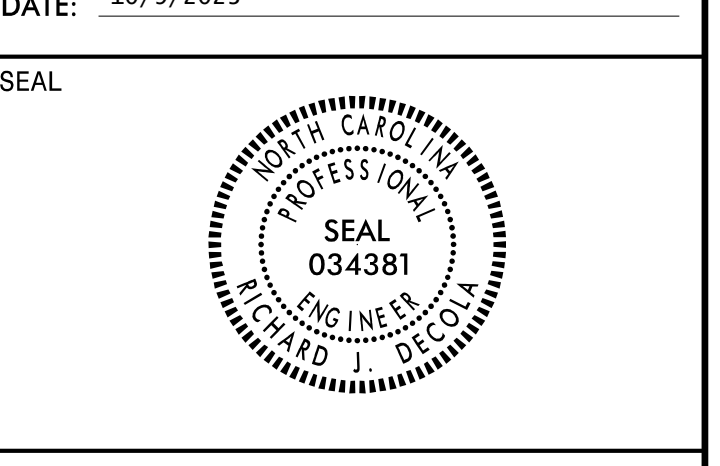

DOCUMENT NOT CONSIDERED FINAL
UNLESS ALL SIGNATURES COMPLETED
Mead&Hunt
111 E. Hargett Street, Suite 300
Raleigh, North Carolina 27601
919-714-8870 | meadandhunt.com
NC License No. F-1235

PAVEMENT MARKING SCHEDULE

THERMOPLASTIC

T1	WHITE EDGELINE (4", 90 MIL)
T2	WHITE SOLID LANE LINE (4", 90 MIL)
T3	10 FT. WHITE SKIP (4", 90 MIL)
T11	YELLOW SINGLE CENTER (4", 90 MIL)
T13	YELLOW DOUBLE CENTER (4", 90 MIL)
T20	WHITE EDGELINE (6", 90 MIL)
T23	3 FT. - 9 FT./SP WHITE MINISKIP (6", 90 MIL)
T24	2 FT. - 6 FT./SP WHITE MINISKIP (6", 90 MIL)
T30	YELLOW EDGELINE (6", 90 MIL)
T31	YELLOW SINGLE CENTER (6", 90 MIL)
T40	WHITE GORELINE (8", 90 MIL)
T51	WHITE DIAGONAL (12", 90 MIL)
T52	YELLOW DIAGONAL (12", 90 MIL)
T61	WHITE STOPBAR (24", 90 MIL)
T71	RIGHT TURN ARROW (90 MIL)
T77	U-TURN ARROW (90 MIL)

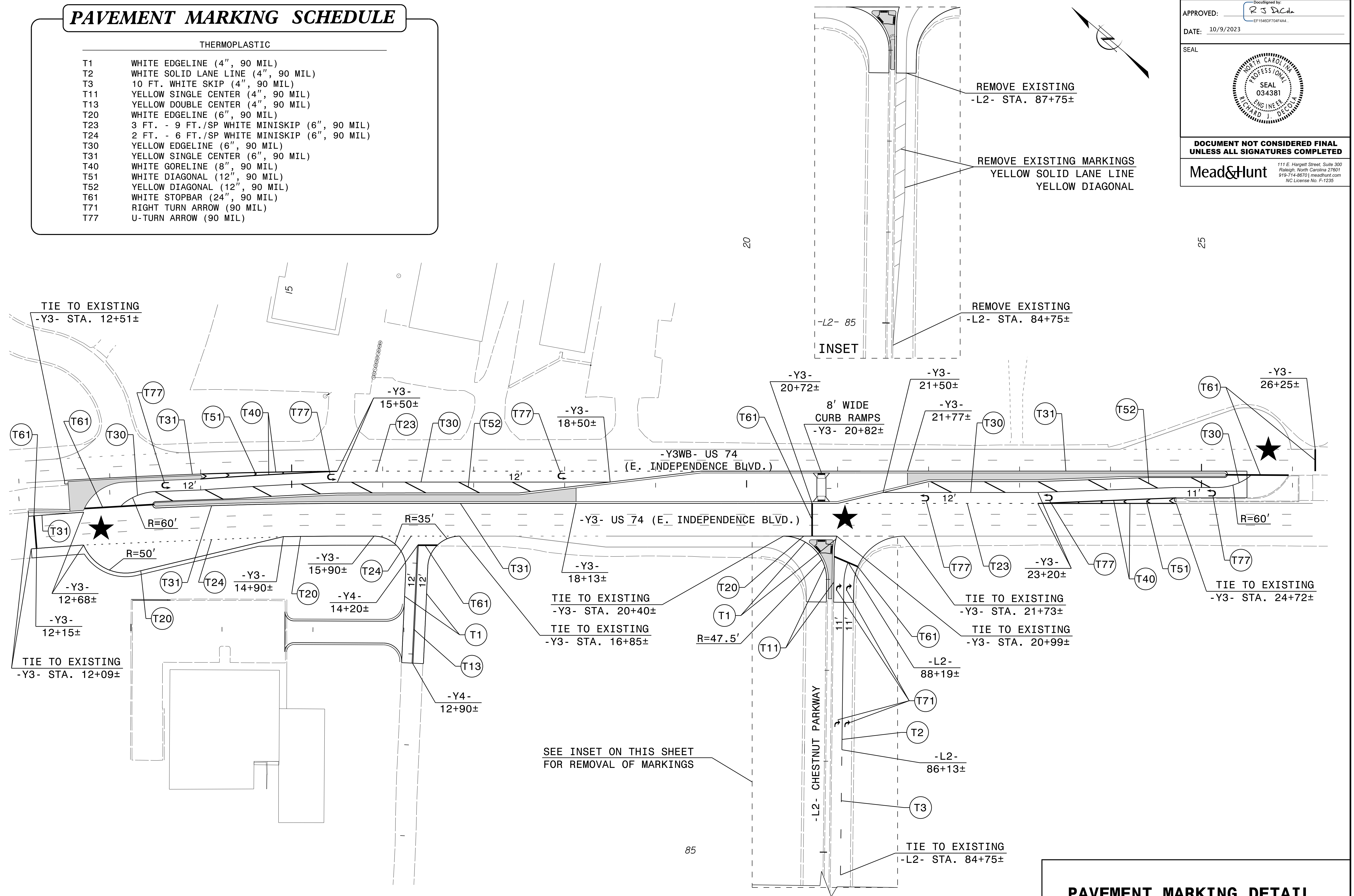

10/09/23
R:\Users\jrs\OneDrive\Working\CADD\Pavement Marking Plans\U5808_Sgn_PMP_5.dgn
User: jrs

PAVEMENT MARKING DETAIL