

PROJECT REFERENCE NO.	SHEET NO.
BR-0046	EC-7/CONST.2B-1
RW SHEET NO.	
ROADWAY DESIGN ENGINEER	HYDRAULICS ENGINEER

DETOUR

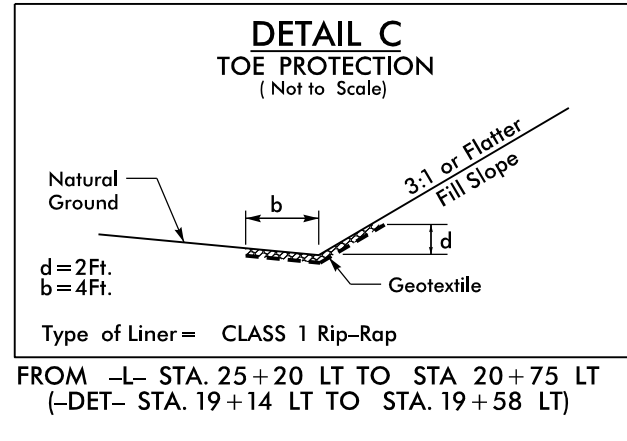
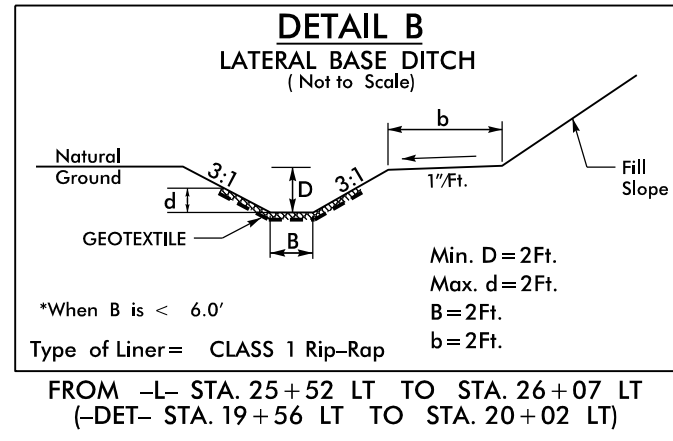
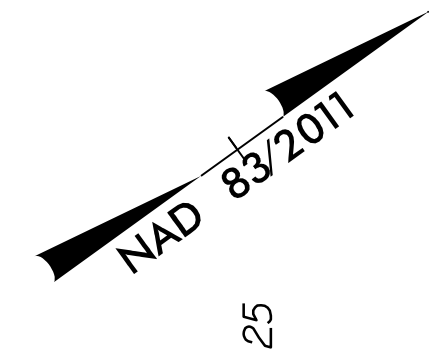

1

BOBBY L. BARNES
DB 2012, PG 336

9 x 47 x 3
1.5 inch Skimmer
with 0.375 inch
Orifice Diameter
4 ft. weir
ID 2B-1.1

3

JONATHON B. MYERS
&
ELIZABETH MYERS
DB 1150, PG 897

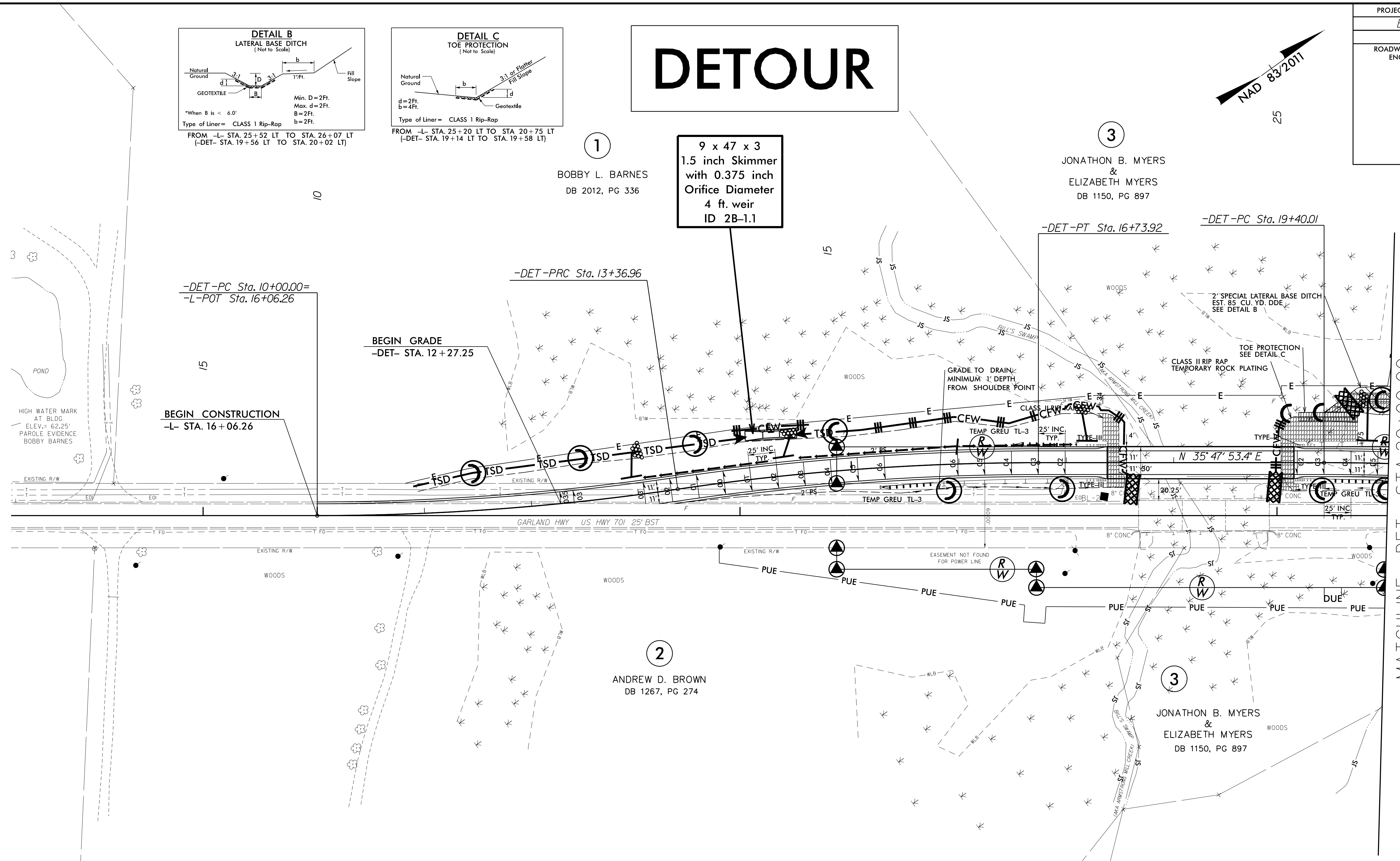

2

ANDREW D. BROWN
DB 1267, PG 274

3

JONATHON B. MYERS
&
ELIZABETH MYERS
DB 1150, PG 897

-DET-		
PI Sta 11+68.78	PI Sta 15+05.74	PI Sta 21+19.95
$\Delta = 8' 23' 38.5" (LT)$	$\Delta = 8' 23' 38.5" (RT)$	$\Delta = 8' 56' 48.7" (RT)$
$D = 2' 29' 28.0"$	$D = 2' 29' 28.0"$	$D = 2' 29' 28.0"$
$L = 336.96'$	$L = 336.96'$	$L = 359.15'$
$T = 168.78'$	$T = 168.78'$	$T = 179.94'$
$R = 2,300.00'$	$R = 2,300.00'$	$R = 2,300.00'$
$e = 0.035$	$e = 0.04$	$e = 0.04$
$RO = 100'$	$RO = 100'$	$RO = 100'$

Place Matting for Erosion Control on Slopes Adjacent to Permitted Wetlands as Work Allows.

Place Matting for Erosion Control on Slope as Work Allows.
-Det- Sta. 12+00 to Sta. 17+30 LT
-Det- Sta. 19+75 to Sta. 20+00 LT

NOTE: UTILIZE COIR FIBER MATTING ADJACENT TO WETLANDS/JURISDICTIONAL AREAS AND AS DIRECTED

NOTE: UTILIZE TEMPORARY SEDIMENT BASIN OR SPECIAL STILLING BASIN(S) AS STILLING BASIN WHERE APPLICABLE.

8/17/99
14-FEB-2023 11:17
R:\ENVI\Projects\1\Design\BR0046_EC_PSH2B-1.dgn
USER:JMB