

PROJECT REFERENCE NO. U-5907	SHEET NO. 13
RW SHEET NO.	
ROADWAY DESIGN ENGINEER	HYDRAULICS ENGINEER
Frank W. Masterson 10/25/2023	Jason Leving 10/26/2023
DOCUMENT NOT CONSIDERED FINAL UNLESS ALL SIGNATURES COMPLETED	

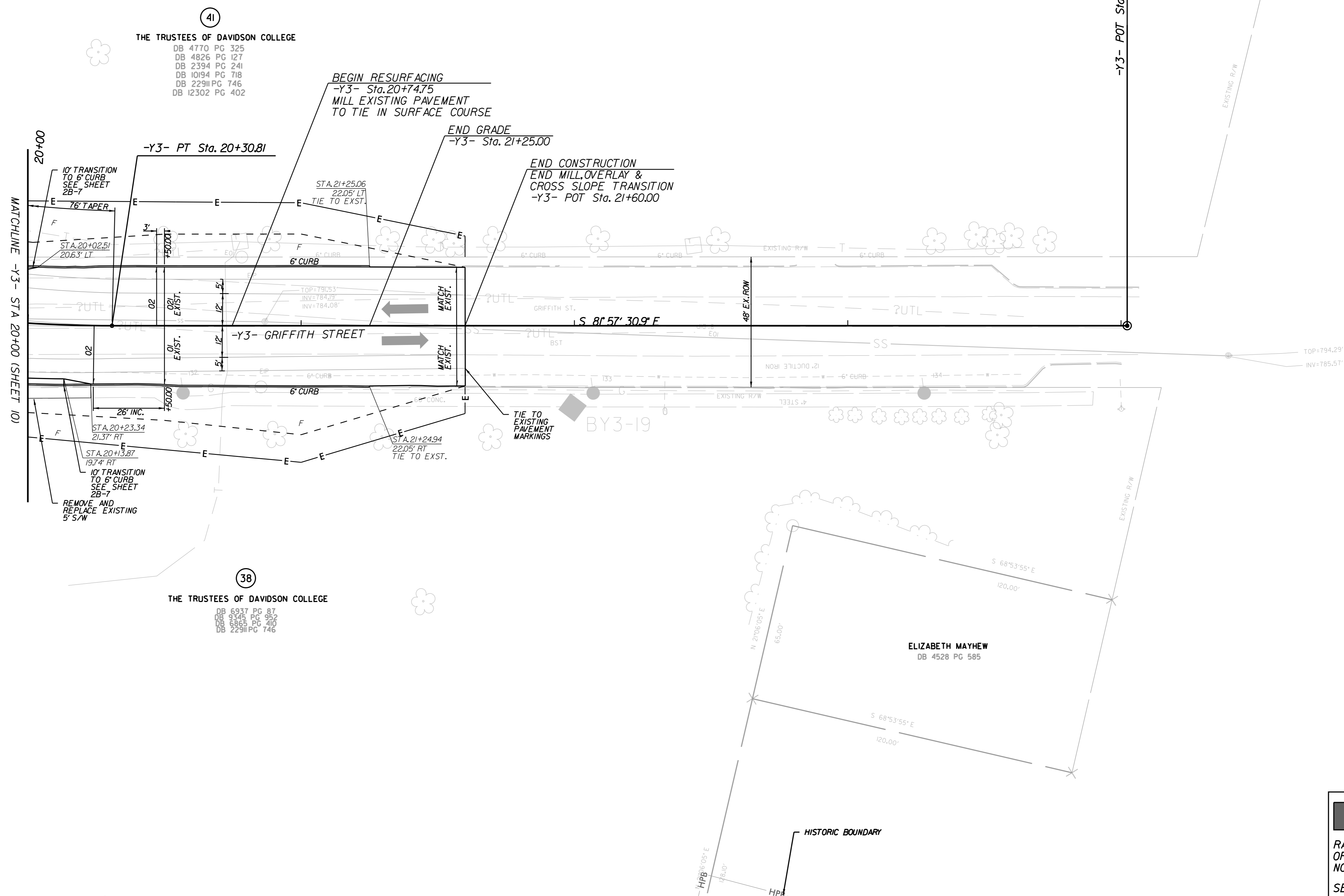

PROPOSED DRIVEWAYS, MONOLITHIC ISLAND, AND SIDEWALK

RADI DIMENSIONS ARE TO THE EDGE OF PAVEMENT UNLESS OTHERWISE NOTED

SEE SHEET 16 FOR -Y3- PROFILE