

PROJECT REFERENCE NO. U-5907	SHEET NO. 8
RW SHEET NO.	
ROADWAY DESIGN ENGINEER	HYDRAULICS ENGINEER
Frank W. Masterson 10/25/2023	Jason Lawing 10/26/2023
DOCUMENT NOT CONSIDERED FINAL UNLESS ALL SIGNATURES COMPLETED	

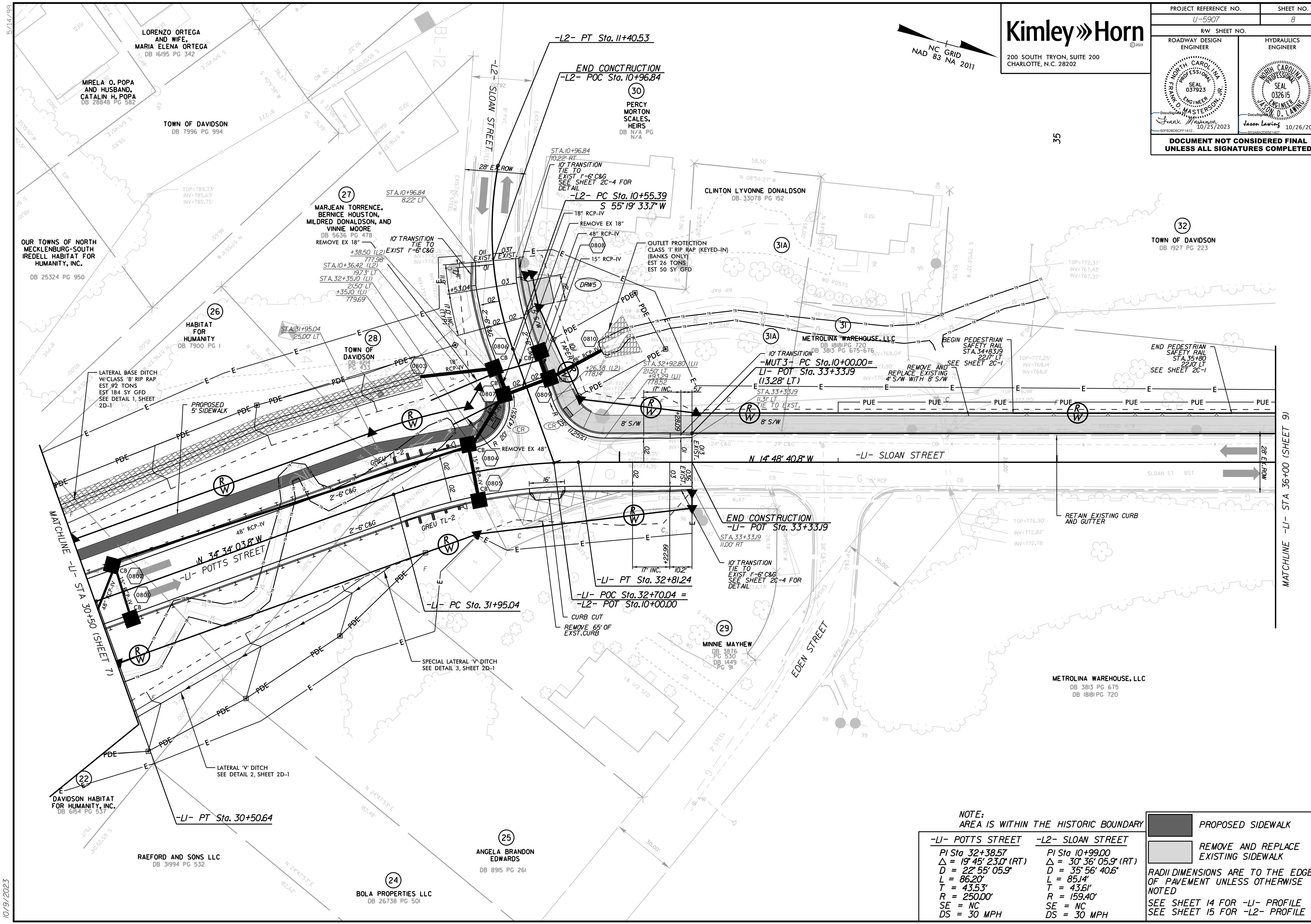

NOTE:
AREA IS WITHIN THE HISTORIC BOUNDARY

	PROPOSED SIDEWALK
	REMOVE AND REPLACE EXISTING SIDEWALK

-L1- POTTS STREET	-L2- SLOAN STREET
PI Sta 32+38.57	PI Sta 10+99.00
$\Delta = 19^{\circ} 45' 23.0''$ (RT)	$\Delta = 30^{\circ} 36' 05.9''$ (RT)
D = 22' 55' 05.9"	D = 35' 56' 40.6"
L = 86.20'	L = 85.14'
T = 43.53'	T = 43.61'
R = 250.00'	R = 159.40'
SE = NC	SE = NC
DS = 30 MPH	DS = 30 MPH

RADI DIMENSIONS ARE TO THE EDGE OF PAVEMENT UNLESS OTHERWISE NOTED
SEE SHEET 14 FOR -L1- PROFILE
SEE SHEET 15 FOR -L2- PROFILE

10/9/2023