

Kimley»Horn

200 SOUTH TRYON, SUITE 200
CHARLOTTE, N.C. 28202

PROJECT REFERENCE NO. U-5907		SHEET NO. 5	
RW SHEET NO.		HYDRAULICS ENGINEER	
ROADWAY DESIGN ENGINEER		SEAL 037923	
F. J. MASTERS, III		SEAL 032615	
10/26/2023		10/26/2023	
DOCUMENT NOT CONSIDERED FINAL UNLESS ALL SIGNATURES COMPLETED			

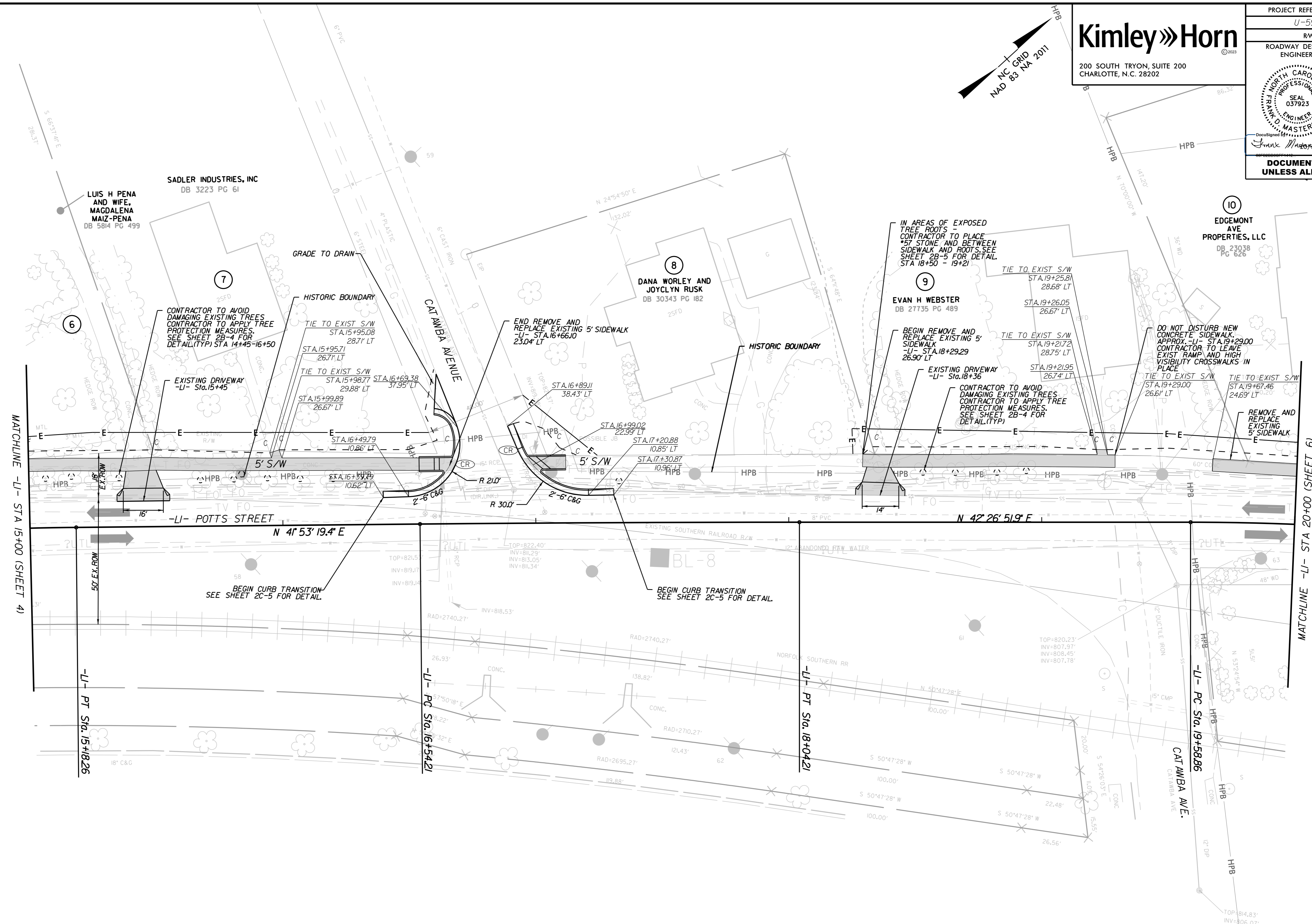

-LI- POTTS STREET		
PI Sta 14+43.40	PI Sta 17+29.21	PI Sta 19+96.42
Δ = 6° 11' 24.5" (RT)	Δ = 0° 33' 32.4" (RT)	Δ = 4° 18' 07.9" (RT)
D = 4° 07' 50.8"	D = 0° 22' 21.6"	D = 5° 43' 46.5"
L = 149.85'	L = 150.00'	L = 75.09'
T = 75.00'	T = 75.00'	T = 37.56'
R = 1,387.05'	R = 15,374.09'	R = 1,000.00'

- TEMPORARY TREE PROTECTION
 - REMOVE AND REPLACE EXISTING SIDEWALK
- RADI DIMENSIONS ARE TO THE EDGE OF PAVEMENT UNLESS OTHERWISE NOTED
- LI- PROFILE MATCHES EXISTING PROFILE