

TIP PROJECT: U-5873

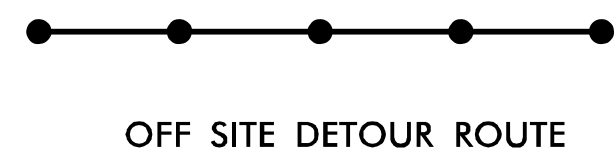
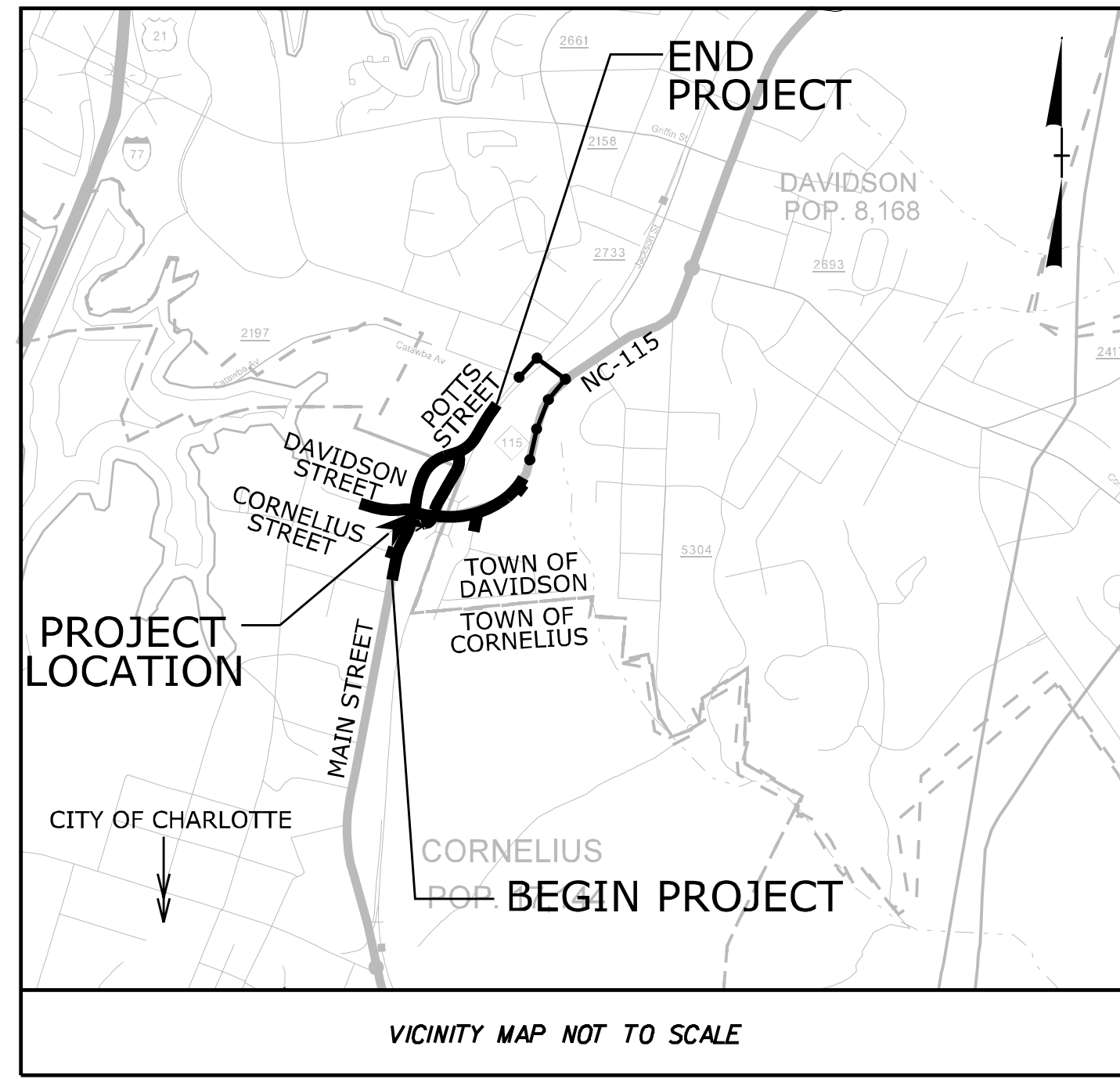

BEGIN TIP PROJECT U-5873
-L- POT Sta. 11+95.33

STATE OF NORTH CAROLINA
DIVISION OF HIGHWAYS

MECKLENBURG COUNTY

LOCATION: INTERSECTION OF NC 115/MAIN STREET AND POTTS STREET
TYPE OF WORK: WATER AND SEWER MAIN RELOCATIONS

*NOTE TO CONTRACTOR: ALL WATER MAINS SHALL BE RESTRAINED JOINT DI PIPE.

PROJECT REFERENCE NO.	SHEET NO.
U-5873	UC-1

DOCUMENT NOT CONSIDERED FINAL
UNLESS ALL SIGNATURES COMPLETED

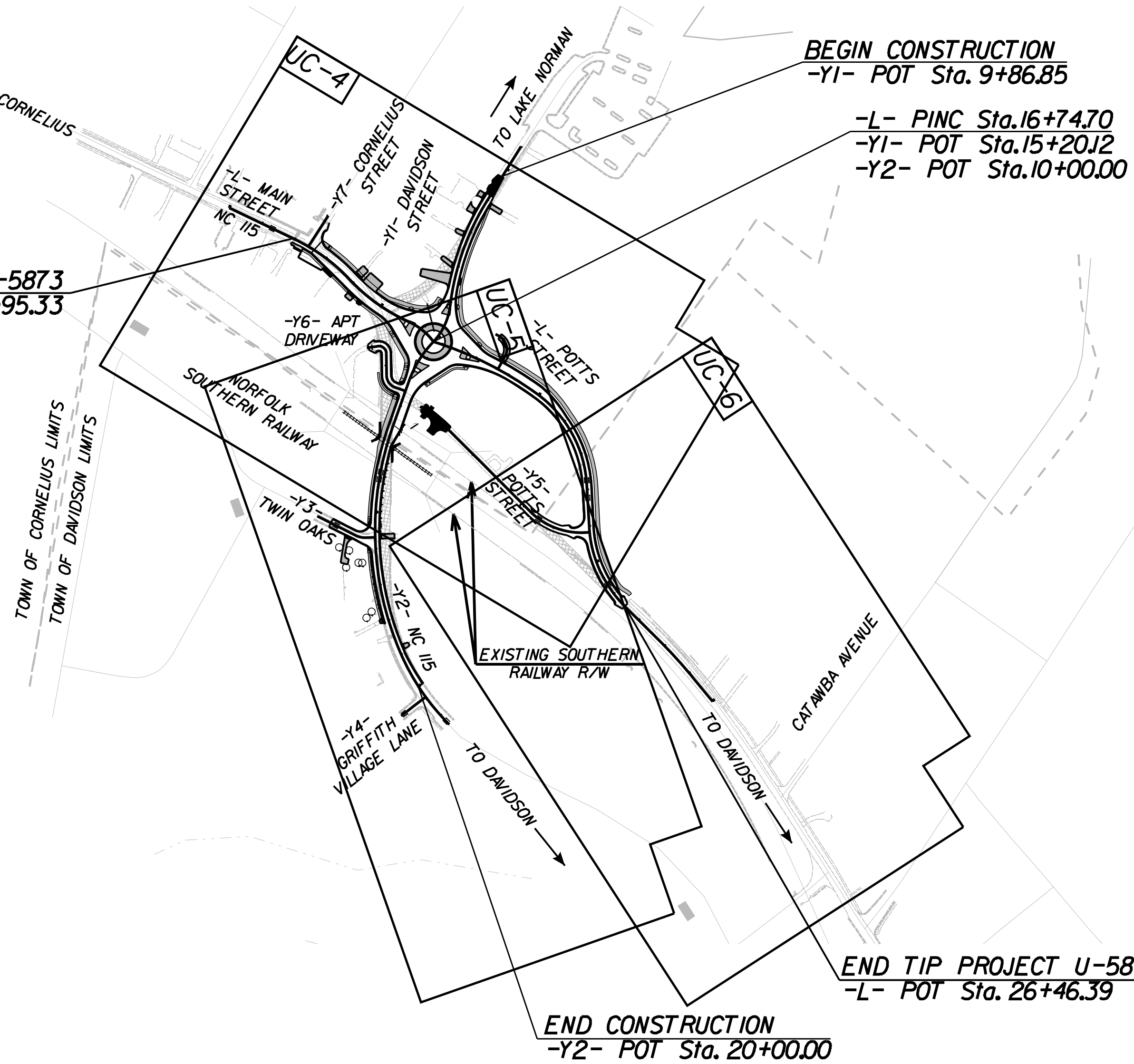
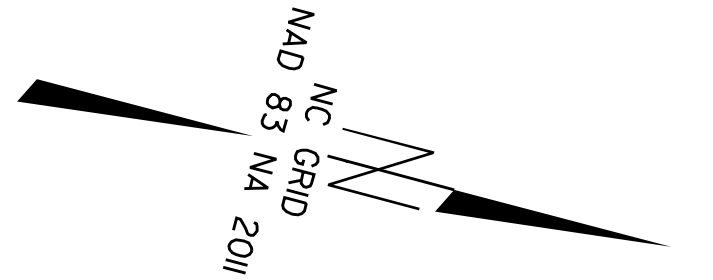

A PORTION OF THIS PROJECT IS LOCATED WITHIN THE MUNICIPAL BOUNDARIES OF THE TOWNS OF DAVIDSON AND CORNELIUS

A PORTION OF THIS PROJECT IS LOCATED WITHIN THE RIGHT-OF-WAY OF NORFOLK SOUTHERN RAILROAD

NCDOT CONTACT:
SEAN EPPERSON, P.E.
NCDOT - DIVISION 10
716 W. MAIN STREET
ALBEMARLE, NC 28001

CONTACT INFORMATION	
OWNER:	CHUCK BLISS, P.E. (704) 995-7518 CBLISS@CI.CHARLOTTE.NC.US
PROJECT ENGINEER:	MATTHEW SHOESMITH, P.E. (704) 954-7490 MATTHEW.SHOESMITH@KIMLEY-HORN.COM 200 SOUTH TRYON STREET, SUITE 200 CHARLOTTE, NORTH CAROLINA 28202

CONTRACT:

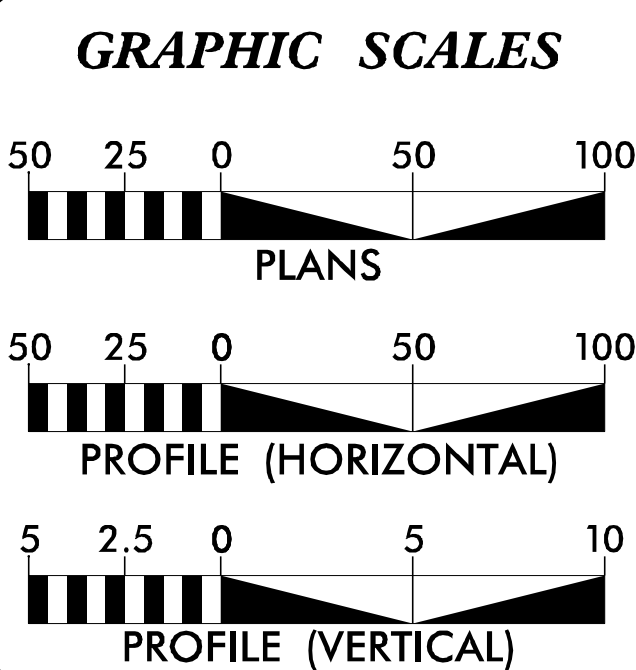

INDEX OF SHEETS	
SHEET NO.:	DESCRIPTION:
UC-1	TITLE SHEET
UC-2	NCDOT SYMBOLOGY
UC-2A	PERMIT SHEET
UC-3	GENERAL NOTES
UC-3A THRU UC-3F	STANDARD DETAILS
UC-4 THRU UC-6	UTILITY CONSTRUCTION PLAN
UC-7 THRU UC-8	UTILITY CONSTRUCTION PROFILE

UTILITY OWNERS
WATER - CHARLOTTE WATER
SEWER - CHARLOTTE WATER

PLANS PREPARED FOR THE NCDOT BY:
2018 STANDARD SPECIFICATIONS

Kimley»Horn
NC LICENSE #P-0102
200 SOUTH TRYON STREET, SUITE 200
CHARLOTTE, NORTH CAROLINA 28202
PHONE: (704) 333-5131

MATTHEW A. SHOESMITH, P.E.
CONSULTANT CONTACT #1

SOPHIA I. JOHNSTON, E.I.
CONSULTANT CONTACT #2

SEAN EPPERSON, P.E.
NCDOT CONTACT

SEAL

8/25/2023

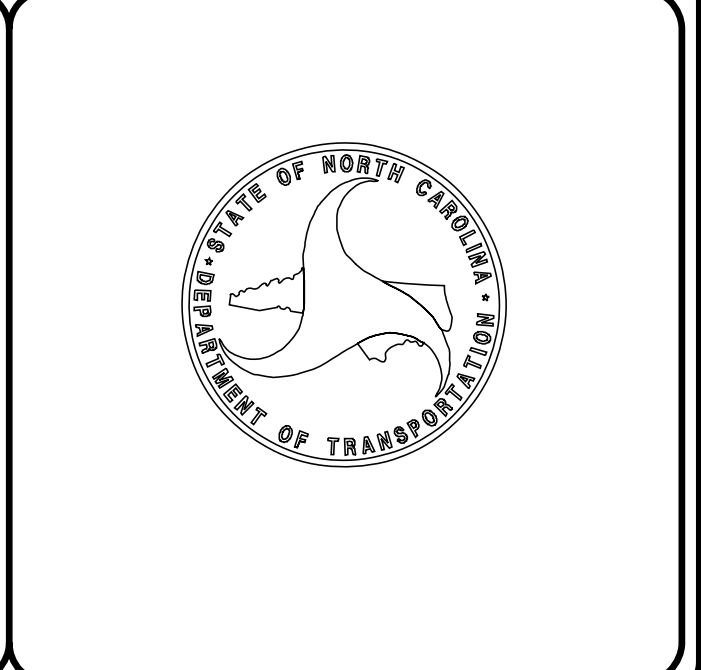

\$\$\$\$\$SYTIME\$\$\$\$\$
\$\$\$\$\$USERNAME\$\$\$\$\$