

NOTE:
USE DETOUR SHEET -
SLOAN STREET TMP-2D

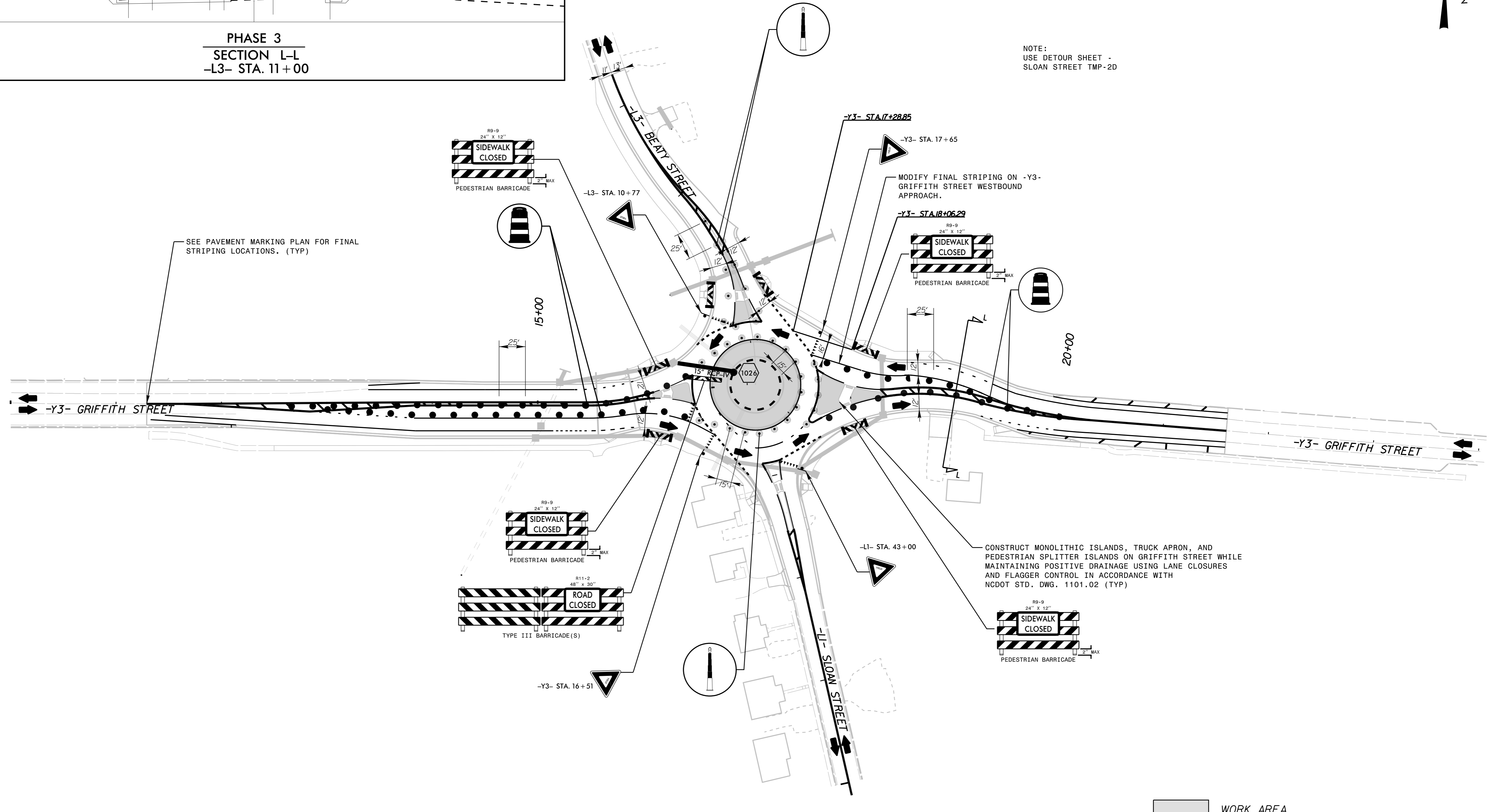

SEE PAVEMENT MARKING PLAN FOR FINAL STRIPING LOCATIONS. (TYP)

CONSTRUCT MONOLITHIC ISLANDS, TRUCK APRON, AND PEDESTRIAN SPLITTER ISLANDS ON GRIFFITH STREET WHILE MAINTAINING POSITIVE DRAINAGE USING LANE CLOSURES AND FLAGGER CONTROL IN ACCORDANCE WITH NCDOT STD. DWG. 1101.02 (TYP)

MODIFY FINAL STRIPING ON -Y3- GRIFFITH STREET WESTBOUND APPROACH.

WORK AREA

10/12/2023 K:\CHL\PR\01036360_U-5907_Ports-Sloan_Ext\Traffic\TrafficControl\CP\Sheets\U-5907_rdy_tmp_18.dgn



APPROVED: *[Signature]* DATE: 10/24/2023

SEAL

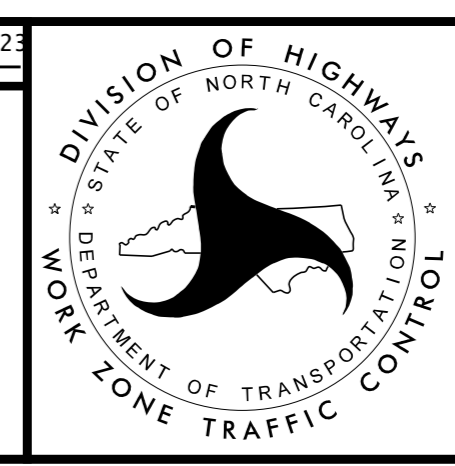

**PHASE 3D
TRAFFIC CONTROL
DETAILS**