

-Y20-	-Y20-	-Y14-
PI Sta 10-90.03	PI Sta 11-38.93	PI Sta 12-48.70
Δ · 17° 21' 32.5" (RT)	Δ · 16° 40' 15.6" (LT)	Δ · 3° 31' 19.9" (RT)
D · 63' 39" 43.1"	D · 57' 17" 44.8"	D · 3' 26' 50.6"
L · 27.27'	L · 29.10'	L · 102.17'
T · 13.74'	T · 14.65'	T · 5.110'
R · 90.00'	R · 100.00'	R · 1662.00'
SE · EXIST	SE · EXIST	SE · RC
		Vd · 25 MPH

NOTE: UTILIZE FABRIC INSERT INLET DEVICES IN LIEU OF ROCK INLET SEDIMENT TRAPS, TYPE-C AS DIRECTED TO AVOID IMPOUNDMENT OF RUNOFF IN ROADWAY OPEN TO TRAFFIC.

MATCHLINE -L- STA. 51 + 50 SEE SHEET 11

MATCHLINE -L- STA. 57 + 10 SEE SHEET 13

MATCHLINE -Y14- STA. 12 + 70 SEE SHEET 22

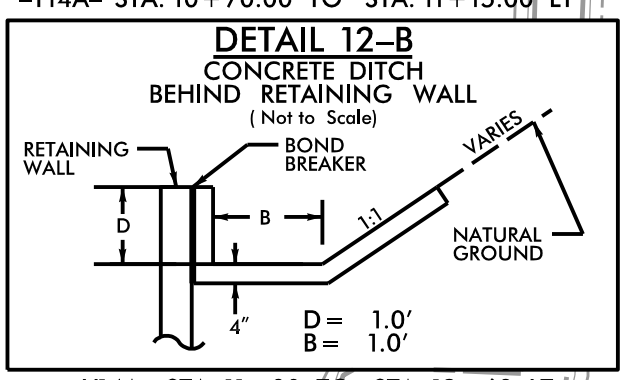
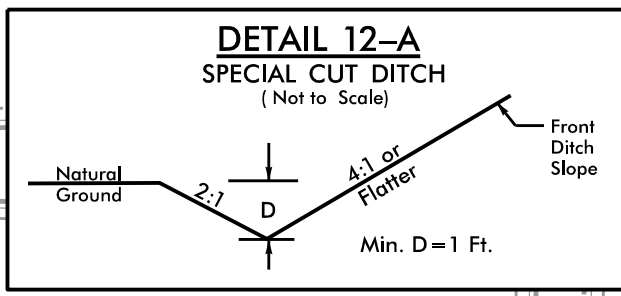
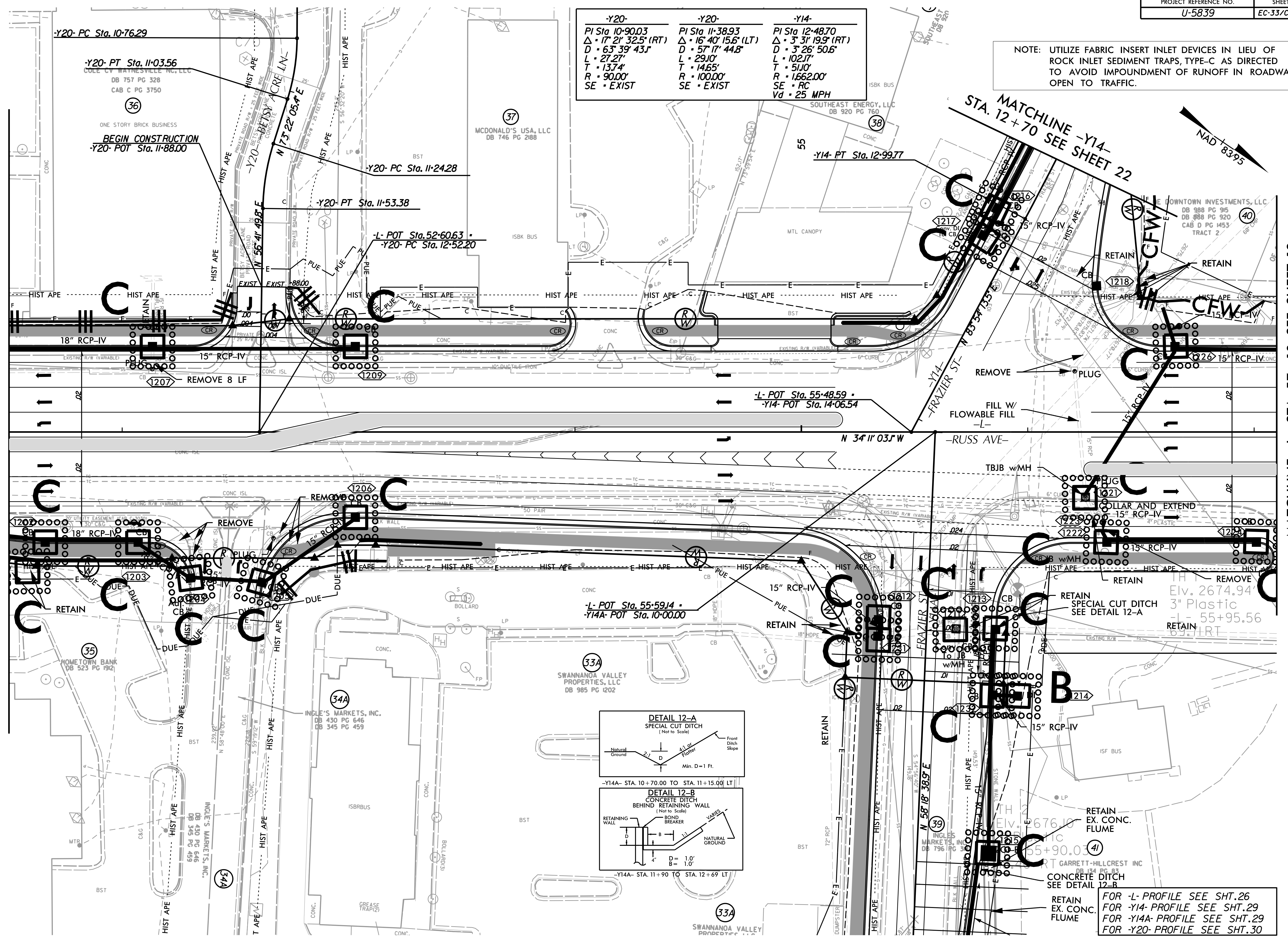

FOR -L- PROFILE SEE SHT.26  
FOR -Y14- PROFILE SEE SHT.29  
FOR -Y14A- PROFILE SEE SHT.29  
FOR -Y20- PROFILE SEE SHT.30

REVISIONS

8/17/99  
3/10/2023 R:\Environmental\Design\U5839-EC-33.F.incl.dgn