

<p>-Y15- PI Sta 14+96.19 Δ • 17° 12' 54.8" (RT) D • 10' 5" 05.3" L • 158.64' T • 79.92' R • 528.00' SE • EXIST</p>	<p>-Y2IRPB- PI Sta 12+08.35 Θs • 21' 23" 06.2" Ls • 212.00' LT • 142.38' ST • 71.62'</p>	<p>-Y2IRPB- PI Sta 13+50.94 Δ • 28° 49' 20.1" (RT) D • 20' 10" 28.5" L • 142.86' T • 72.98' R • 284.00' SE • EXIST Vd • 35 MPH</p>
<p>-Y2ILPB- PI Sta 11+46.83 Θs • 38° 15' 23.4" Ls • 215.00' LT • 146.83' ST • 74.86'</p>	<p>-Y2ILPB- PI Sta 16+48.28 Δ • 139° 13' 54.6" (RT) D • 35' 35" 14.8" L • 391.24' T • 433.28' R • 161.00' SE • EXIST</p>	<p>-Y2ILPB- PI Sta 16+81.09 Θs • 38° 15' 23.4" Ls • 215.00' LT • 146.83' ST • 74.86'</p>

NOTE: PLACE TEMPORARY ROCK SEDIMENT DAMS TYPE - B AND TEMPORARY ROCK SILT CHECKS TYPE - A AT DRAINAGE OUTLETS.

CLEARING AND GRUBBING EROSION CONTROL FOR CONSTRUCTION SHEET 23

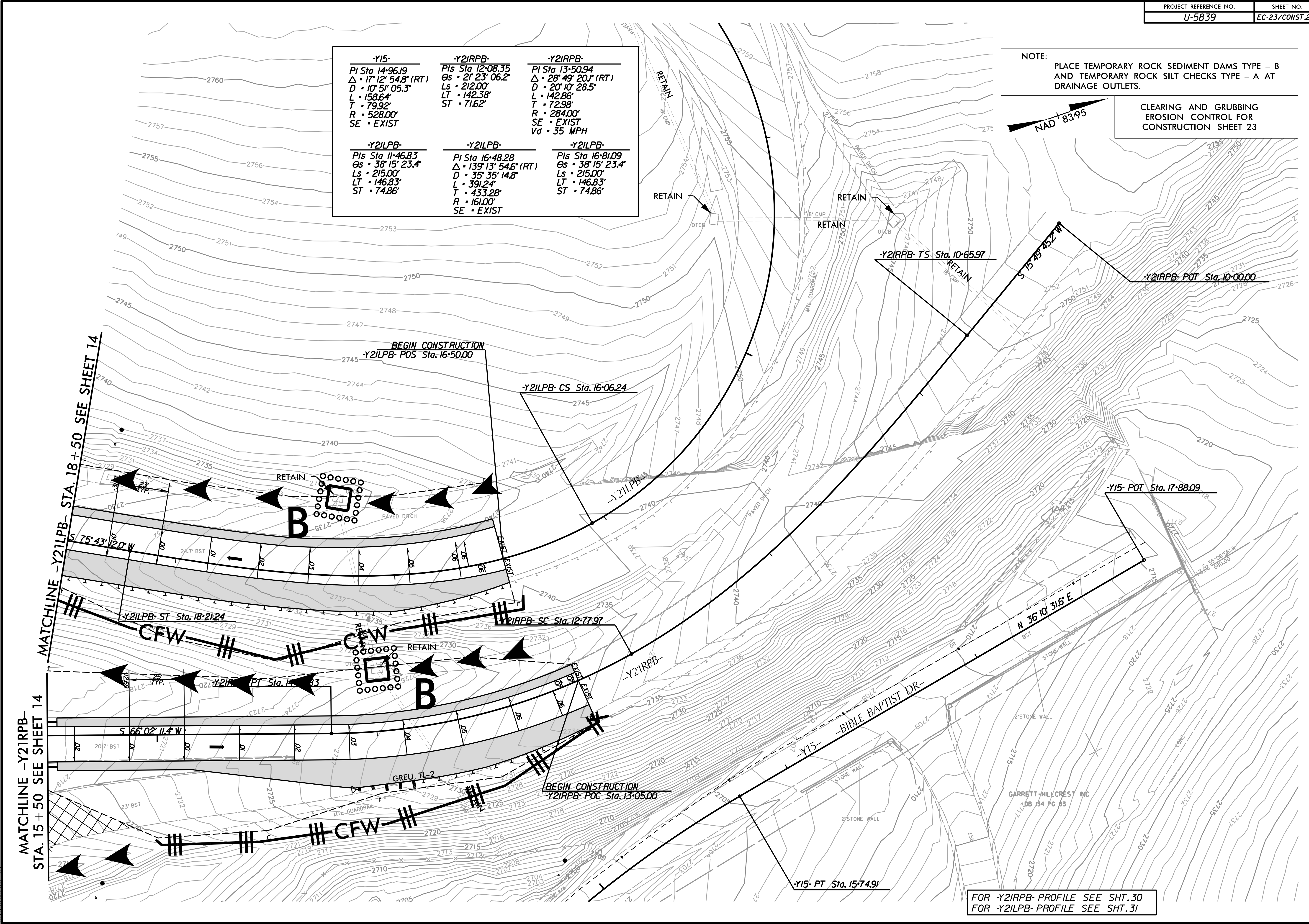
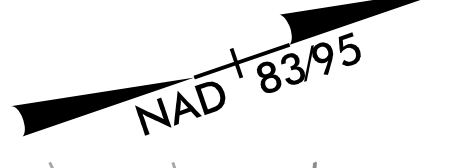

MATCHLINE -Y2IRPB- STA. 15+50 SEE SHEET 14

MATCHLINE -Y2ILPB- STA. 18+50 SEE SHEET 14

FOR -Y2IRPB- PROFILE SEE SHT.30
 FOR -Y2ILPB- PROFILE SEE SHT.31