



-Y9-	-Y9-	-Y9-
PI Sta 11+03.95	PI Sta 13+19.87	PI Sta 15+48.02
$\Delta \cdot 3^{\circ} 04' 15.7" (LT)$	$\Delta \cdot 15^{\circ} 56' 26.3" (LT)$	$\Delta \cdot 35^{\circ} 10' 22.8" (RT)$
D · 1' 28' 38.8"	D · 7' 09' 43.1"	D · 15' 26' 37.0"
L · 207.86'	L · 222.57'	L · 227.75'
T · 103.95'	T · 112.01'	T · 117.59'
R · 3.878.00'	R · 800.00'	R · 371.00'
SE · EXIST	SE · 04	SE · 04
	Vd · 35 MPH	Vd · 35 MPH

CLEARING AND GRUBBING
EROSION CONTROL FOR
CONSTRUCTION SHEET 19

NOTE:
PLACE TEMPORARY ROCK SEDIMENT DAMS TYPE - B
AND TEMPORARY ROCK SILT CHECKS TYPE - A AT
DRAINAGE OUTLETS.

NOTE: UTILIZE FABRIC INSERT INLET DEVICES IN LIEU OF
ROCK INLET SEDIMENT TRAPS, TYPE-C AS DIRECTED
TO AVOID IMPOUNDMENT OF RUNOFF IN ROADWAY
OPEN TO TRAFFIC.

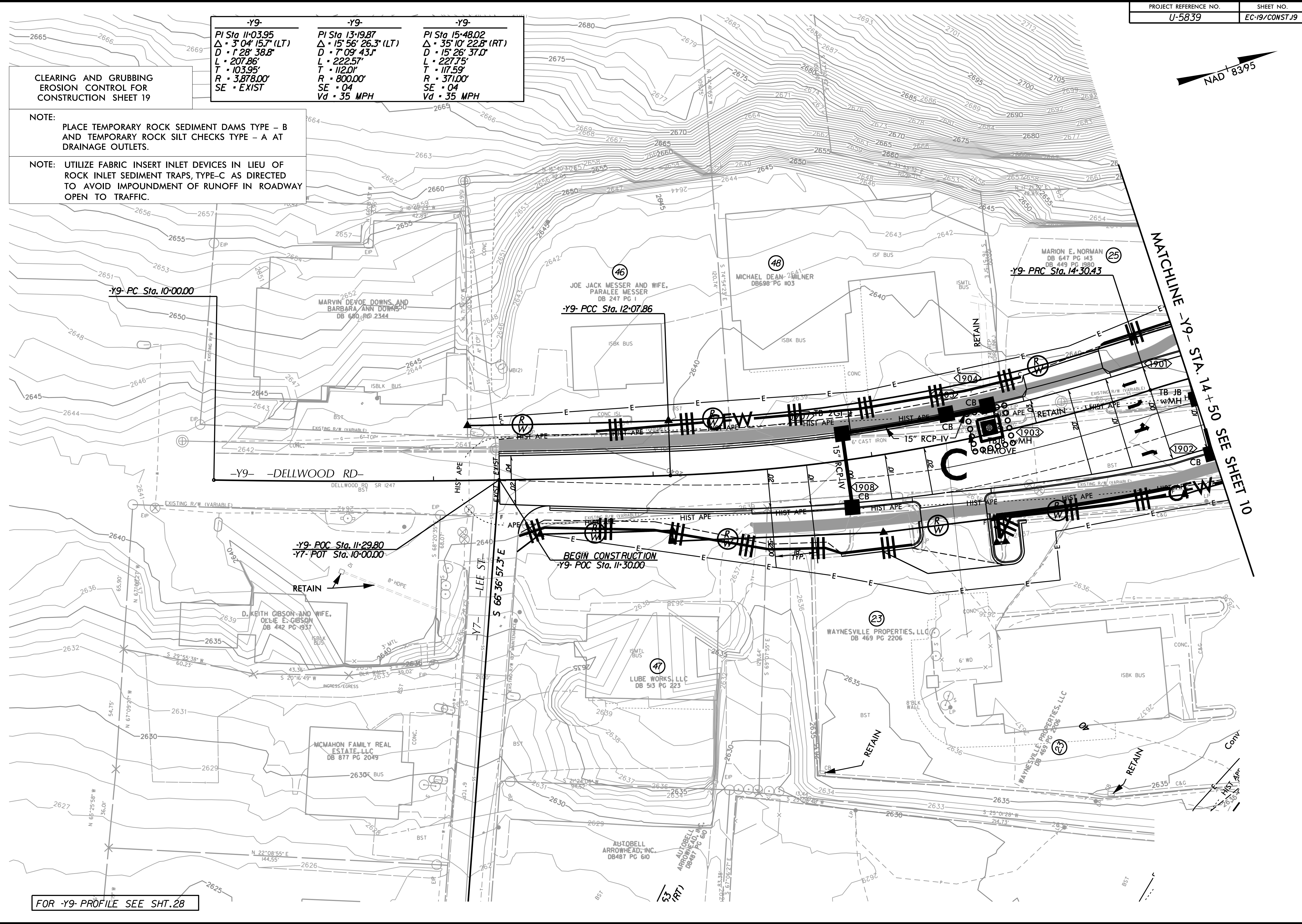

FOR -Y9- PROFILE SEE SHT. 28

3/10/2023 R:\Environmental\Design\U5839-EC-19-C&G.dgn