

TIP NO. U-5839	SHEET NO. PMP-3
APPROVED: <i>William J. Hamilton</i> A05600704645484	
DATE: 03/08/2023	
SEAL	
DOCUMENT NOT CONSIDERED FINAL UNLESS ALL SIGNATURES COMPLETED	
Infrastructure Consulting Services, Inc. RAMEY KEMP ASSOCIATES <small>8210 University Executive Park Drive Suite 220 Charlotte, North Carolina 28262 Phone: 704-548-4260 www.rameykemp.com NC License No. F-1489</small>	

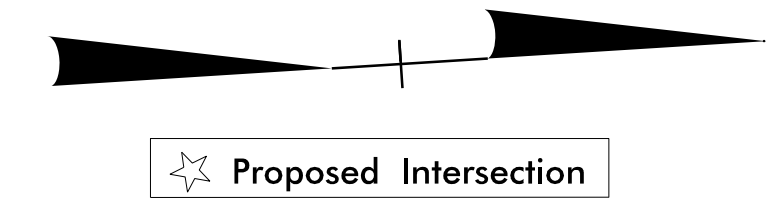
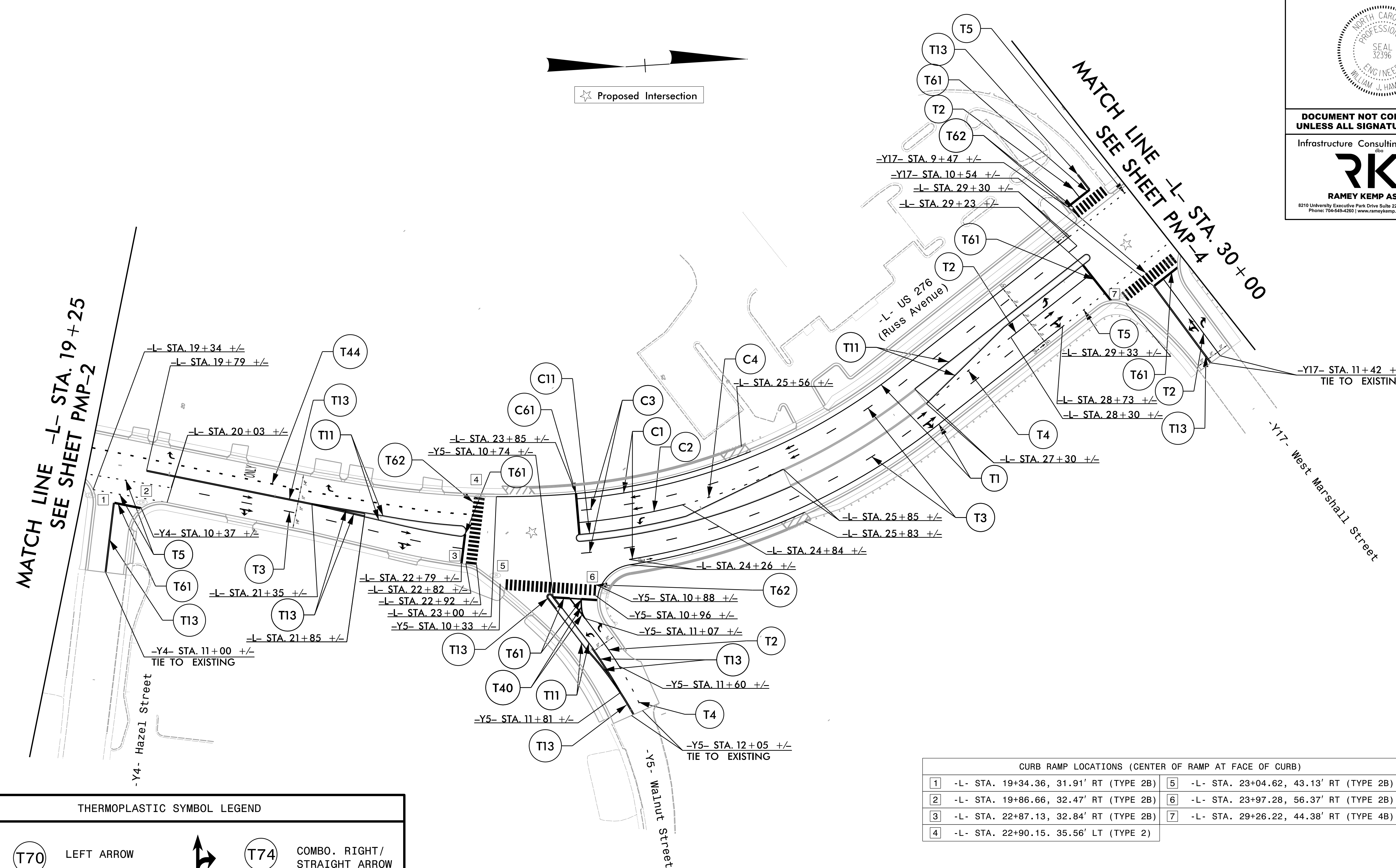

MATCH LINE -L- STA. 19+25
SEE SHEET PMP-2

MATCH LINE -L- STA. 30+00
SEE SHEET PMP-4

THERMOPLASTIC SYMBOL LEGEND					
	(T70)	LEFT ARROW		(T74)	COMBO. RIGHT/ STRAIGHT ARROW
	(T71)	RIGHT ARROW		(T93)	BICYCLE CHAR. HEATED-IN-PLACE
	(T72)	STRAIGHT ARROW	ONLY	(T100)	ALPHANUMERIC CHARACTERS
	(T73)	COMBO. LEFT/ STRAIGHT ARROW			

COLD APPLIED PLASTIC SYMBOL LEGEND					
	(C70)	LEFT ARROW		(C93)	BICYCLE CHAR. HEATED-IN-PLACE
	(C72)	STRAIGHT ARROW			

CURB RAMP LOCATIONS (CENTER OF RAMP AT FACE OF CURB)			
1	-L- STA. 19+34.36, 31.91' RT (TYPE 2B)	5	-L- STA. 23+04.62, 43.13' RT (TYPE 2B)
2	-L- STA. 19+86.66, 32.47' RT (TYPE 2B)	6	-L- STA. 23+97.28, 56.37' RT (TYPE 2B)
3	-L- STA. 22+87.13, 32.84' RT (TYPE 2B)	7	-L- STA. 29+26.22, 44.38' RT (TYPE 4B)
4	-L- STA. 22+90.15, 35.56' LT (TYPE 2)		

**PAVEMENT
MARKING DETAILS**