

**NOTE A:**

ENSURE ALL FIBER AND CONDUIT FROM -L- 10+19 +/- TO -L- 25+75 +/- IS BUILT IN PHASE I. REFER TO ITS PLANS FOR MORE DETAILS.

DUE TO THE LARGE AMOUNT OF UTILITIES BEING INSTALLED NEAR BRANNER AVENUE, SPECIAL CARE IS REQUIRED. CONTRACTOR TO COORDINATE WITH ALL UTILITY COMPANIES TO ENSURE UTILITIES ARE INSTALLED APPROPRIATELY WITH DRAINAGE OPEN CUTS TO MINIMIZE TRAFFIC IMPACTS.

**NOTE B:**

BEFORE STARTING CONSTRUCTION ON -Y3- AND -Y2A-, ENSURE -Y2- IS BUILT AND OPEN ALONG WITH ALL TRAFFIC CONTROL SIGNAGE REMOVED ON -Y2-.

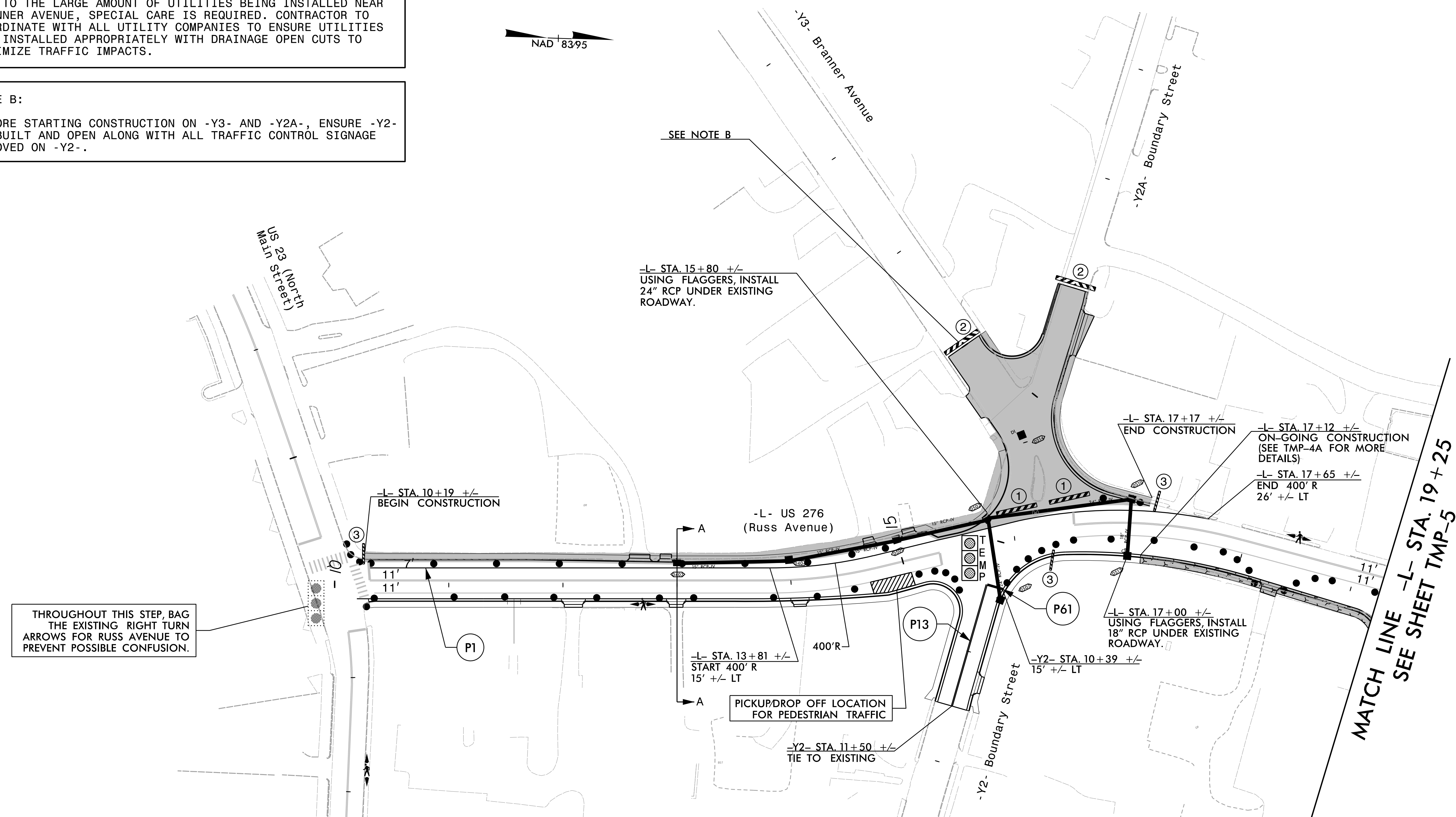
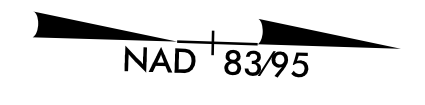

THROUGHOUT THIS STEP, BAG THE EXISTING RIGHT TURN ARROWS FOR RUSS AVENUE TO PREVENT POSSIBLE CONFUSION.

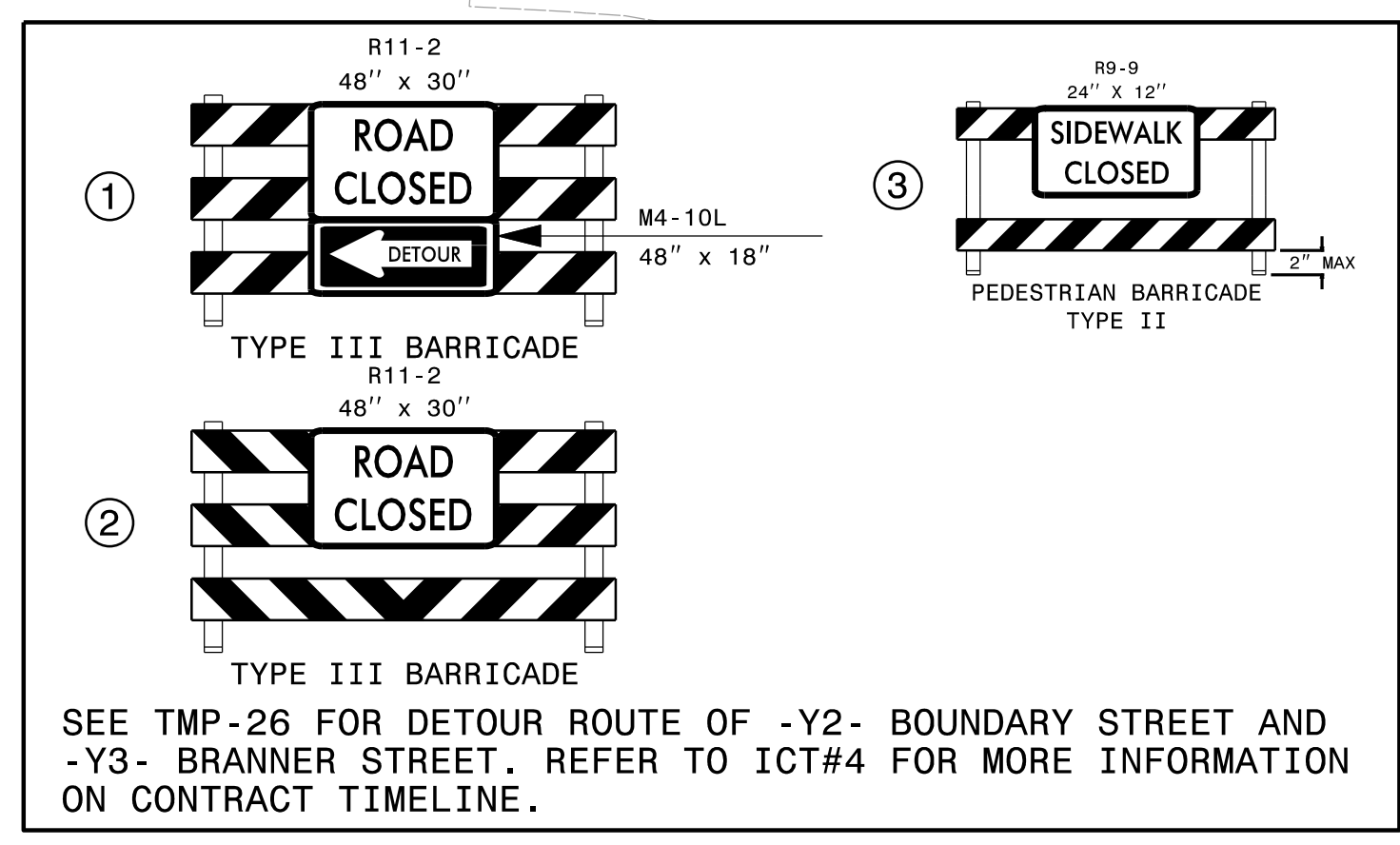
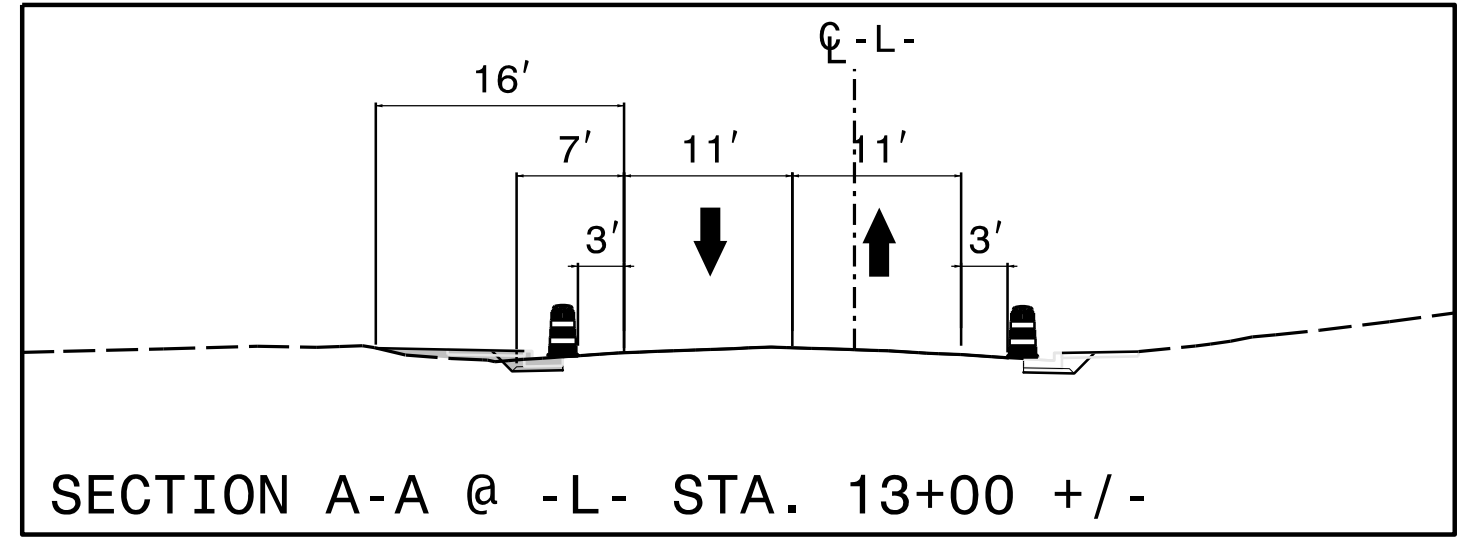

APPROVED: *William J. Hamilton*  
DATE: 2/23/2023

SEAL

PROFESSIONAL ENGINEER  
WILLIAM J. HAMILTON  
SEAL 32396

DOCUMENT NOT CONSIDERED FINAL  
UNLESS ALL SIGNATURES COMPLETED

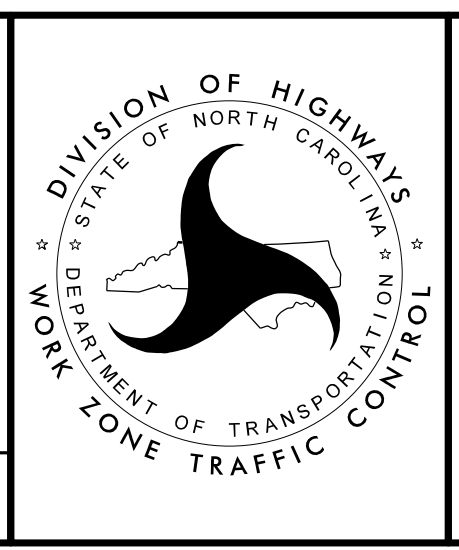

**TEMPORARY  
TRAFFIC CONTROL  
PHASE I – STEP 1**