

DETAIL "B"
CLOSURE POUR DECK REINFORCEMENT
END BENT 1 SHOWN, END BENT 2 SIMILAR

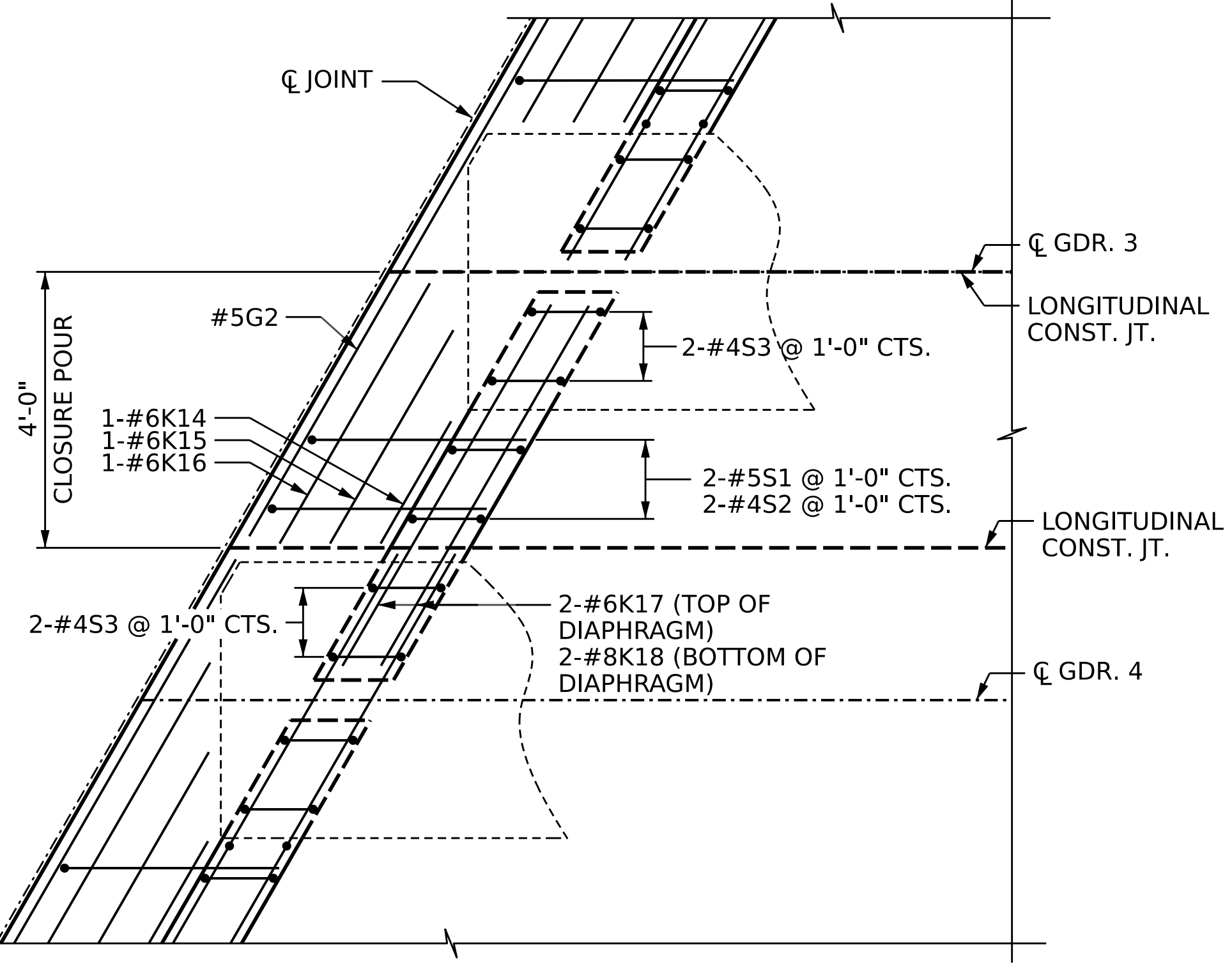

DETAIL "B"
CLOSURE POUR DIAPHRAGM REINFORCEMENT
END BENT 1 SHOWN, END BENT 2 SIMILAR

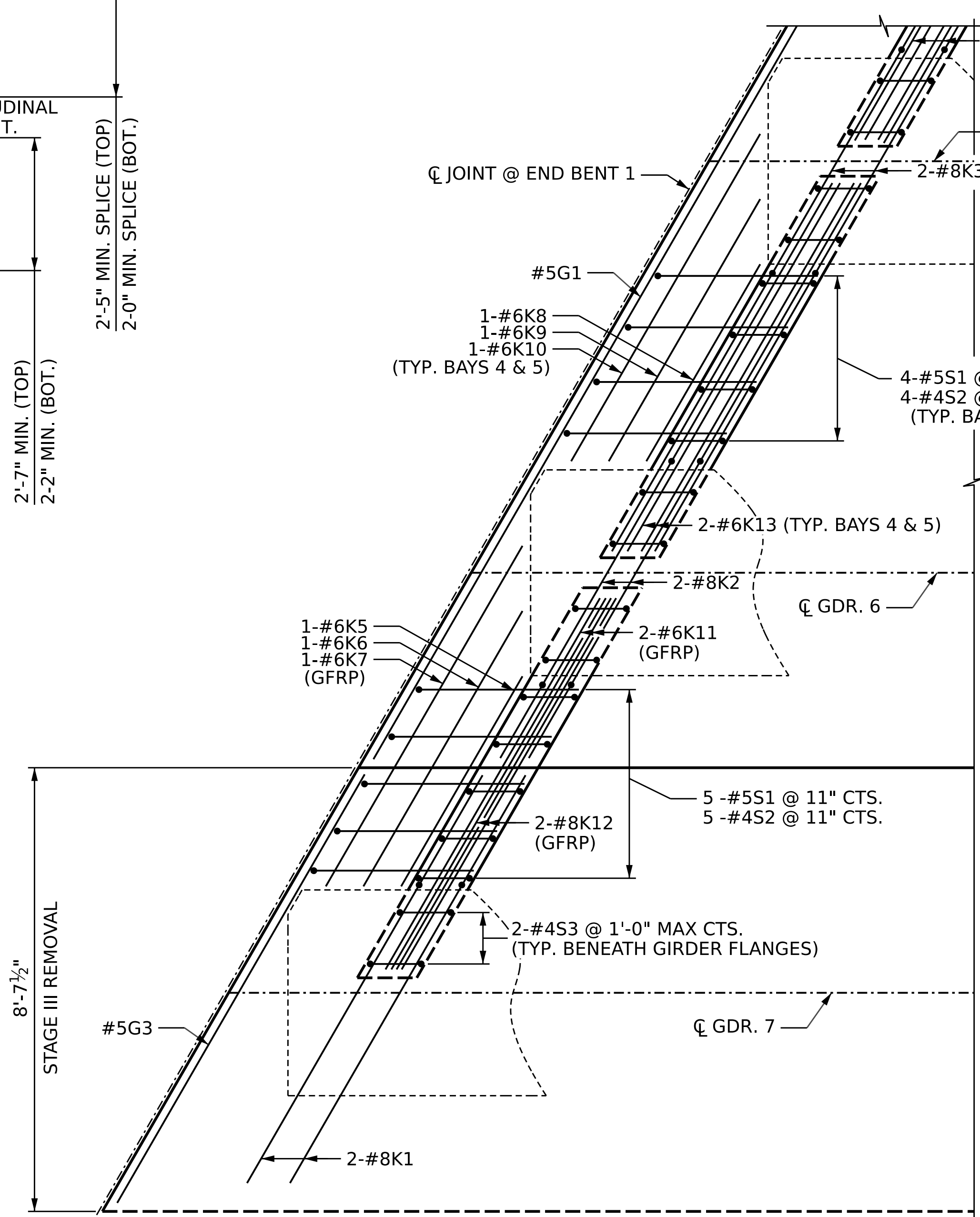

END BENT DIAPHRAGM
STAGE I & OVERBUILD
END BENT 1 SHOWN, END BENT 2 SIMILAR

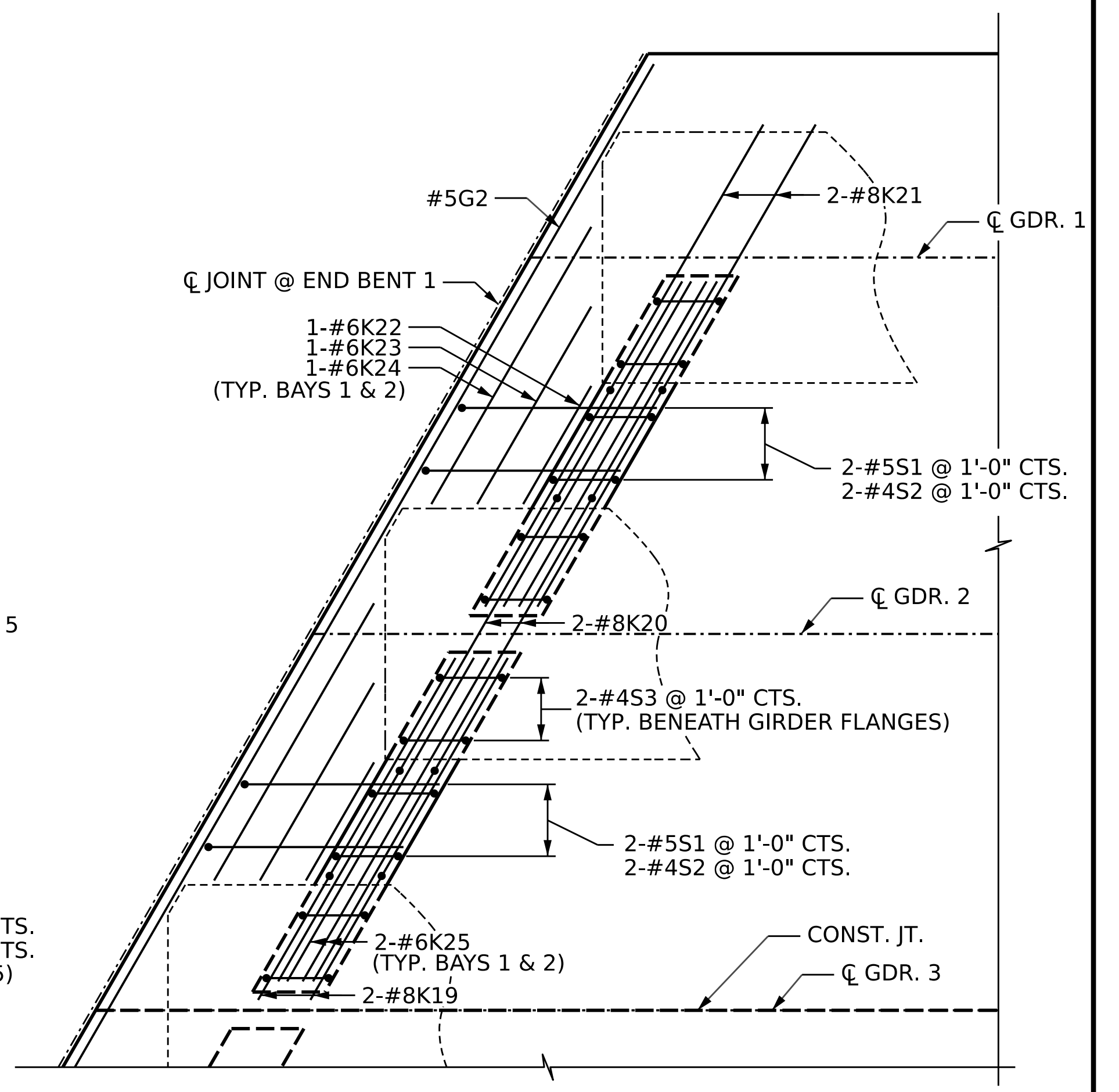

END BENT DIAPHRAGM
STAGE II
END BENT 1 SHOWN, END BENT 2 SIMILAR

DRAWN BY :	M.L. CATER	DATE :	06/2023
CHECKED BY :	D. TUTTLE	DATE :	06/2023
DESIGN ENGINEER OF RECORD :	D. TUTTLE	DATE :	06/2023

DOCUMENT NOT CONSIDERED
FINAL UNLESS ALL
SIGNATURES COMPLETED

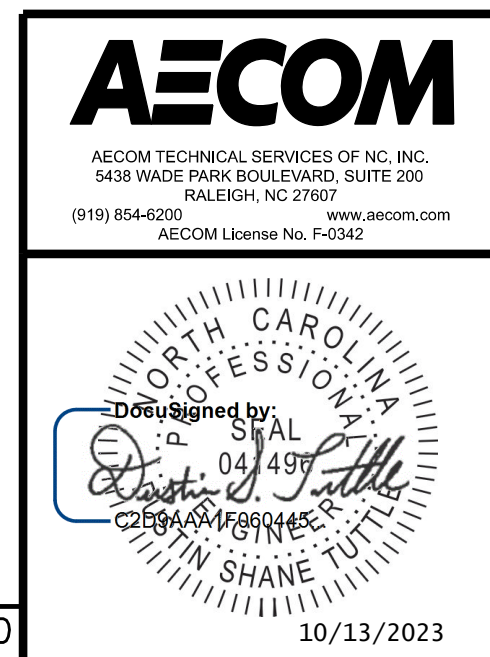

PROJECT NO. B-3186 / B-5898
HAYWOOD COUNTY
STATION: 24+70.00 -L_LT-
SHEET 5 OF 5

STATE OF NORTH CAROLINA DEPARTMENT OF TRANSPORTATION RALEIGH					
SUPERSTRUCTURE					
PLAN OF SPAN DETAILS					
REVISIONS					
NO.	BY:	DATE:	NO.	BY:	DATE:
1			3		
2			4		
SHEET NO.					S3-15
TOTAL SHEETS					50