

SURVEY CONTROL SHEET

W/EXISTING CENTERLINE ALIGNMENTS PRIOR TO CONSTRUCTION

BASELINE POINTS TABLE				
POINT	DESC	NORTH	EAST	ELEVATION
1	EBL-1	665070.49	816057.73	2704.55
2	EBL-2	665230.45	816639.41	2688.07
3	EBL-3	665315.28	817234.33	2672.1
4	EBL-4	665430.84	817950.66	2635.8
5	EBL-5	665864.41	818615.15	2590.88
6	EBL-6	666482.53	819099.39	2576.91
7	EBL-7	666910.9	819440.69	2589.66
8	EBL-8	667215.28	820025.37	2622.19
9	EBL-9	667578.4	820623.06	2647.83
10	WBL-10	665282.78	816426.8	2694.43
11	WBL-11	665424.92	817200.83	2672.6
12	WBL-12	665473.58	817581.69	2653.24
13	WBL-13	665555.23	817956.24	2628.78
14	WBL-14	665813.29	818473.8	2598.05
15	WBL-15	666294.48	818811.73	2576.58
16	WBL-16	666863.13	819239.79	2600.17
17	WBL-17	667571.58	820485.34	2644.63
18	WBL-18	667897.82	821151.24	2646.08
19	EBY1-19	666921.7	817747.77	2574.48
20	EBY1-20	666831.46	818242.24	2583
21	EBY1-21	666830.42	818808.75	2584.18
22	EBY1-22	667070.6	819428.6	2613.83
23	WBY1-23	666851.45	818531.9	2595.98
24	WBY1-24	666958.75	818936.33	2586.61
25	WBY1-25	667133.5	819393.54	2613.95
101	GPS-101	667233.5	819804.26	2625
102	GPS-102	667361.08	820172.68	2635.15

BENCHMARK POINTS TABLE				
BENCHMARK	NORTHING	EASTING	ELEVATION	DESCRIPTION
BM-2	667147	819706	2615.00'	RR SPIKE SET IN BASE OF 48" OAK TREE
BM-1	665750	818548	2596.60'	RR SPIKE SET IN BASE OF 28" WALNUT TREE
BM-8	666939	817675	2574.61'	MARKED CONCRETE HEAD WALL CORNER
BM-3	667668	820939	2649.74'	PAINTED BOLT ON HIGHWAY SIGN
BM-5	665133	815819	2709.07'	RR SPIKE SET IN BASE OF 36" OAK TREE
BM-4	664969	815236	2723.60'	MARKED CONCRETE FOOTTER FOR SIGN
BM-7	666028	818542	2589.00'	RR SPIKE SET IN BASE OF 18" WALNUT TREE
BM-6	665425	816971	2681.63'	RR SPIKE SET IN BASE OF 16" MAPLE TREE

EXISTING ALIGNMENT NAME: EL									
POINT	NORTHING	EASTING	BEARING	DIST	DELTA	D	L	T	R
SC	665214.29	816363.76							
CURVE					06°34'35" Right	01°28'09"	447.645	224.069	3900
ST	665354.77	817097.19							
LINE			N82°44'24"E	559.26					
END	665425.44	817651.96							

EXISTING ALIGNMENT NAME: EEL									
POINT	NORTHING	EASTING	BEARING	DIST	DELTA	D	L	T	R
SC	665426.68	817830.56							
CURVE					32°33'44" Left	03°53'52"	835.431	429.334	1470.000
ST	666059.58	818743.08							
LINE			N37°54'44"E	544.78					
SC	666720.55	819268.87							
CURVE					12°11'37" Right	03°19'52"	366.044	183.716	1720.000
ST	667117.27	819800.12							
LINE			N60°05'36"E	48.89					
PC	667141.64	819842.50							
CURVE					03°22'47" Right	00°57'18"	353.932	177.017	6000.000
PT	667308.96	820154.32							
LINE			N63°28'23"E	1324.94					
END	667900.70	821339.78							

EXISTING ALIGNMENT NAME: WEL									
POINT	NORTHING	EASTING	BEARING	DIST	DELTA	D	L	T	R
SC	665490.52	817821.03							
CURVE					34°07'34" Left	03°58'44"	857.682	441.985	1440.000
ST	666153.94	818735.86							
LINE			N36°29'13"E	870.60					
PC	666853.89	819253.55							
CURVE					33°01'15" Right	05°00'14"	659.887	339.390	1145.000
PT	667245.57	819773.28							
LINE			N69°30'27"E	400.46					
PC	667385.77	820148.40							
CURVE					05°57'18" Left	01°54'35"	311.801	156.041	3000.000
PT	667509.89	820434.28							
LINE			N63°33'10"E	978.23					
END	667945.57	821310.13							

EXISTING ALIGNMENT NAME: EEY1									
POINT	NORTHING	EASTING	BEARING	DIST	DELTA	D	L	T	R
START	666963.94	817659.81							
LINE			S77°10'31"E	235.05					
PC	666911.77	817888.99							
CURVE					08°17'46" Left	01°54'35"	434.384	217.572	3000.000
PT	666846.30	818318.03							
LINE			S85°28'17"E	39.43					
PC	666843.18	818357.34							
CURVE					04°42'02" Left	02°17'31"	205.100	102.608	2500.000
PCC	666835.39	818562.23							
CURVE					19°02'23" Left	02°04'47"	915.509	462.014	2755.000
PCC	666988.81	819460.52							
CURVE					06°08'50" Left	02°32'47"	241.400	120.816	2250.000
PT	667080.31	819683.79							
LINE			N64°38'27"E	146.35					
END	667142.99	819816.04							

EXISTING ALIGNMENT NAME: WEY1									
POINT	NORTHING	EASTING	BEARING	DIST	DELTA	D	L	T	R
PC	666999.99	817668.01							
CURVE					00°22'10" Left	00°08'36"	258.000	129.000	40000.000
PCC	666942.32	817919.48							
CURVE					10°28'09" Left	02°07'19"	493.342	247.360	2700.000
PCC	666878.03	818407.93							
CURVE					23°49'16" Left	03°28'21"	686.000	348.028	1650.000
PT	666992.16	819079.37							
LINE			N68°26'34"E	777.07					
END	667277.68	819802.08							

I, BRIAN BARWATT, PLS, CERTIFY THAT THE PROJECT CONTROL WAS VERIFIED UNDER MY SUPERVISION FROM AN ACTUAL GPS SURVEY MADE UNDER MY SUPERVISION AND THE FOLLOWING INFORMATION WAS USED TO PERFORM THE SURVEY:

CLASS OF SURVEY: **AA**
 TYPE OF GPS FIELD PROCEDURE: VRS
 DATES OF SURVEY: MARCH 2017 - MAY 2017
 DATUM/EPOCH: NAD83/NA 2011
 PUBLISHED/FIXED-CONTROL USE: N/A
 LOCALIZED AROUND: GPS-101
 NORTHING: 667233.497'
 EASTING: 819804.260'
 COMBINED GRID FACTOR: 0.9997624084
 GEOID MODEL: 12NC
 UNITS: U.S. SURVEY FEET

I ALSO CERTIFY THAT THE BASELINE CONTROL FOR THIS PROJECT WAS COMPLETED UNDER MY DIRECT AND RESPONSIBLE CHARGE FROM AN ACTUAL SURVEY MADE UNDER MY SUPERVISION; THAT ALL HORIZONTAL CLOSURES HAD A MINIMUM RATIO OF PRECISION OF 1:20,000 (CLASS AA) AND VERTICAL ACCURACY TO CLASS A. FIELD WORK WAS PERFORMED FROM MARCH 2017 TO MAY 2017, AND ALL COORDINATES ARE BASED ON NAD 83/2011 AND ALL ELEVATIONS ARE BASED ON NAVD 88; THAT THIS SURVEY WAS PERFORMED TO MEET THE REQUIREMENTS OF 21NCAC 56.1600 AS APPLICABLE.

THIS 13TH DAY OF SEPTEMBER, 2023.

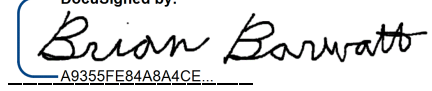
DocuSigned by:

 49352728484848

PROFESSIONAL LAND SURVEYOR L-4727

NOTES:

1. PROJECT CONTROL WAS ESTABLISHED USING GNSS, THE GLOBAL NAVIGATION SATELLITE SYSTEM.
2. THE PROPOSED ALIGNMENT CONTROL DATA FOR THIS PROJECT HAS BEEN COMPILED FROM VARIOUS SOURCES. IF FURTHER INFORMATION REGARDING PROJECT CONTROL IS NEEDED, PLEASE CONTACT THE LOCATION AND SURVEYS UNIT.

B5898-B3186

R/W 02C-7

NORTH CAROLINA
DEPARTMENT
OF TRANSPORTATION

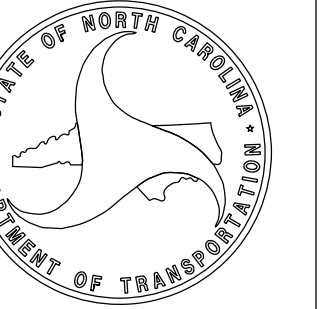

PROFESSIONAL LAND
SURVEYOR

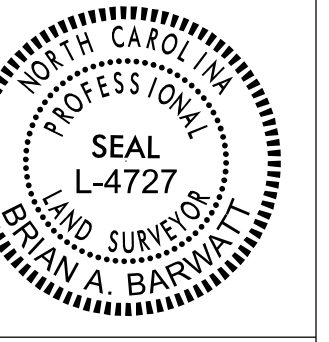

DOCUMENT NOT CONSIDERED
FINAL UNLESS ALL SIGNATURES
ARE COMPLETED

2018 STANDARD
SPECIFICATIONS

TIP PROJECT: B5898-B3186
 County: Haywood

PREPARED FOR

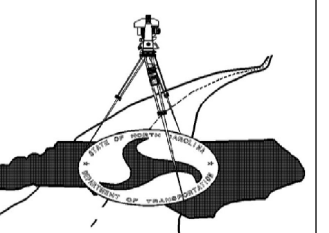

LOCATION AND
SURVEYS UNIT

PREPARED BY
 LOCATION AND SURVEYS
 DIVISION 14
 122 BONNIE LANE,
 SYLVIA, NC 28779