

# DUPLIN COUNTY

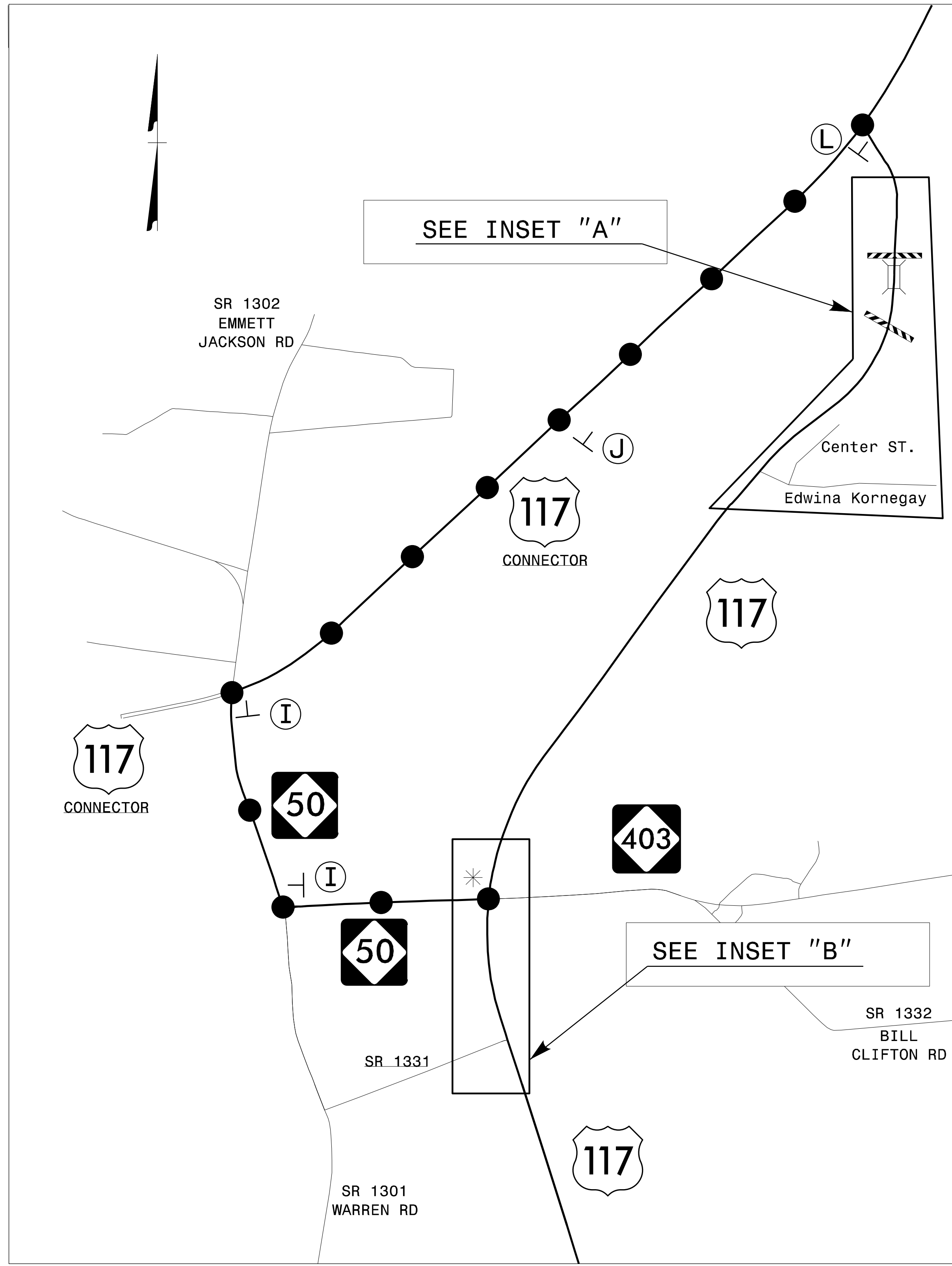

SEE INSET "A"

SEE INSET "B"

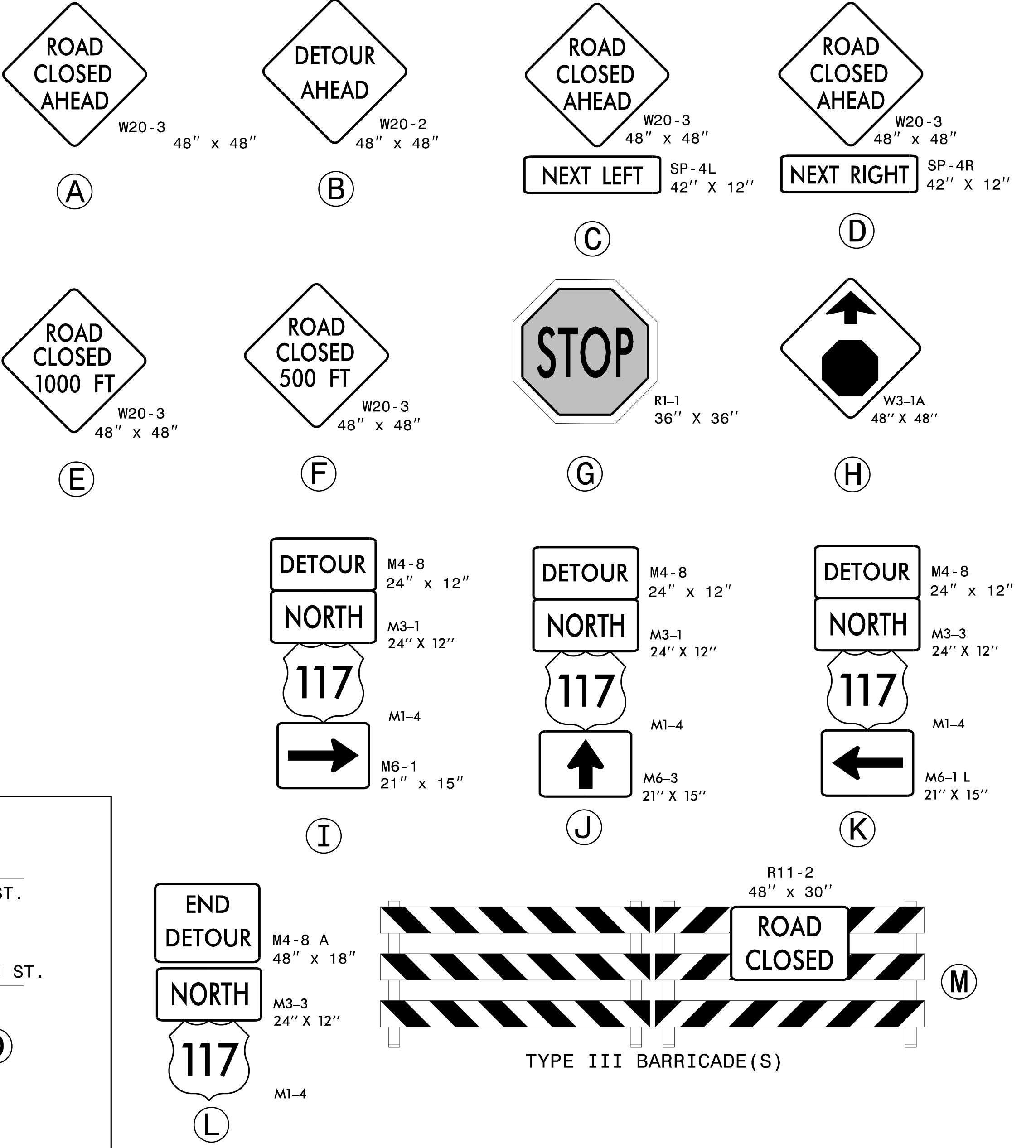
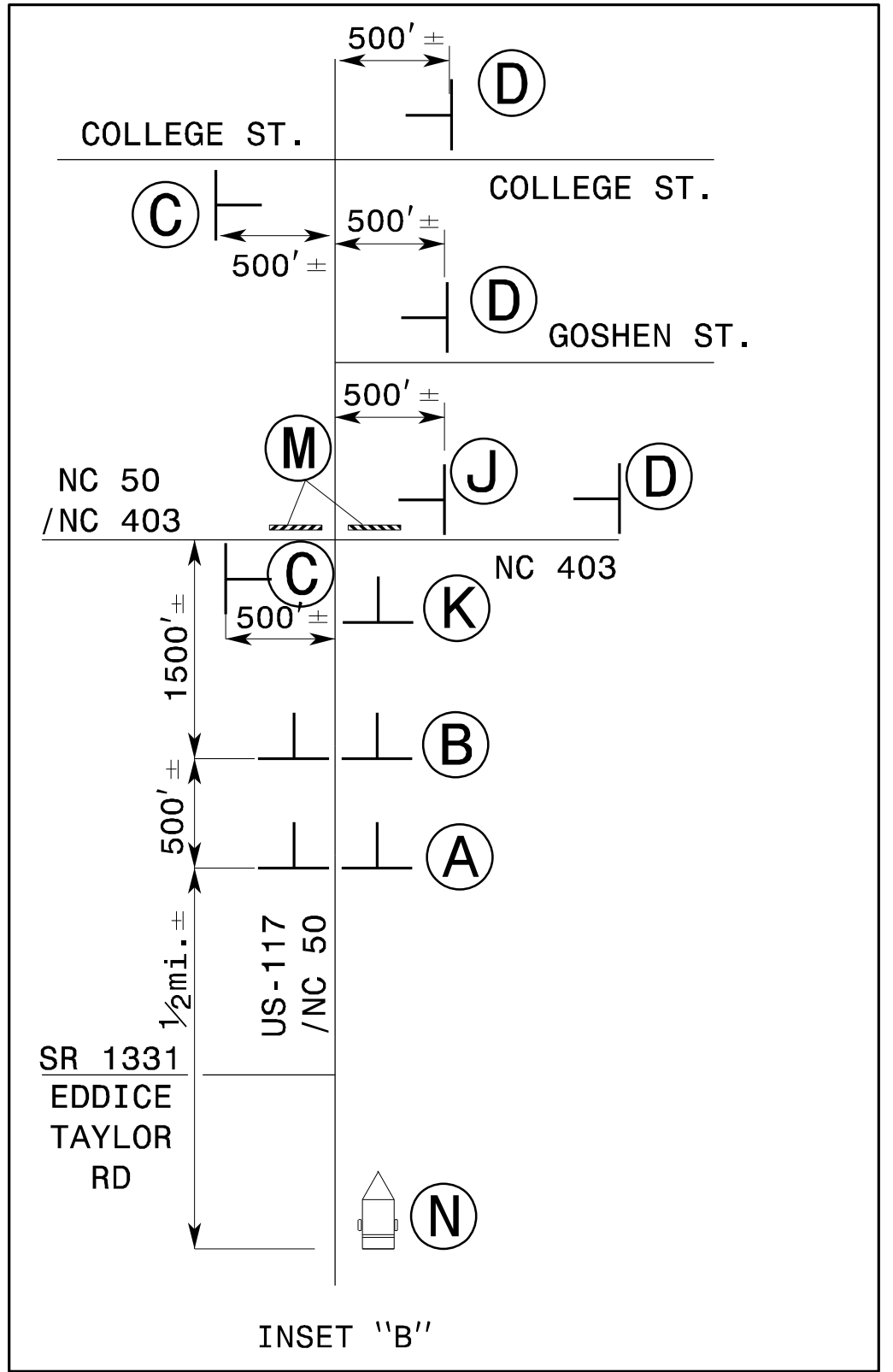
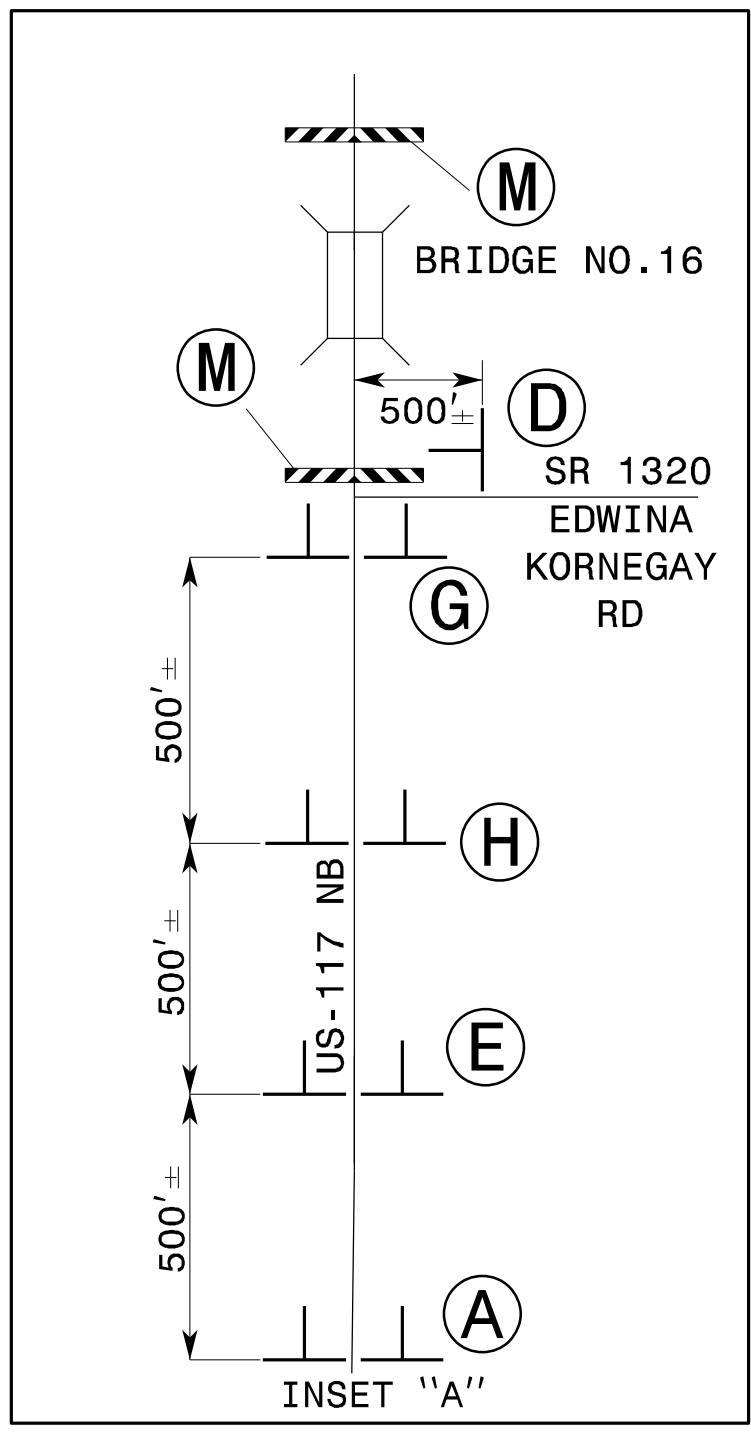

\* ADJUST SIGNAL TIMING AS DETERMINED BY THE ENGINEER

NOTES:  
1. REFER TO RSD 1101.03, SHEET 1 OF 9, FOR SIGN DISTANCES AND APPLICABLE NOTES.

APPROVED: *Zachary T. Clark*  
DATE: 05/09/2023

SEAL

DOCUMENT NOT CONSIDERED FINAL UNLESS ALL SIGNATURES COMPLETED

DIVISION OF HIGHWAYS  
STATE OF NORTH CAROLINA  
DEPARTMENT OF TRANSPORTATION  
WORK ZONE TRAFFIC CONTROL

OFFSITE DETOUR FOR US-117 NB

5/1/2023 P:\TIP\Projects-B\B5981\TrafficControl\TCP\B-5981\_TC\_TMP\_2Bnew.dgn User:cbhoward