

STATE OF NORTH CAROLINA  
DIVISION OF HIGHWAYS

**TRANSPORTATION MANAGEMENT PLAN**

**NEW HANOVER COUNTY**

**DIVISION 3**

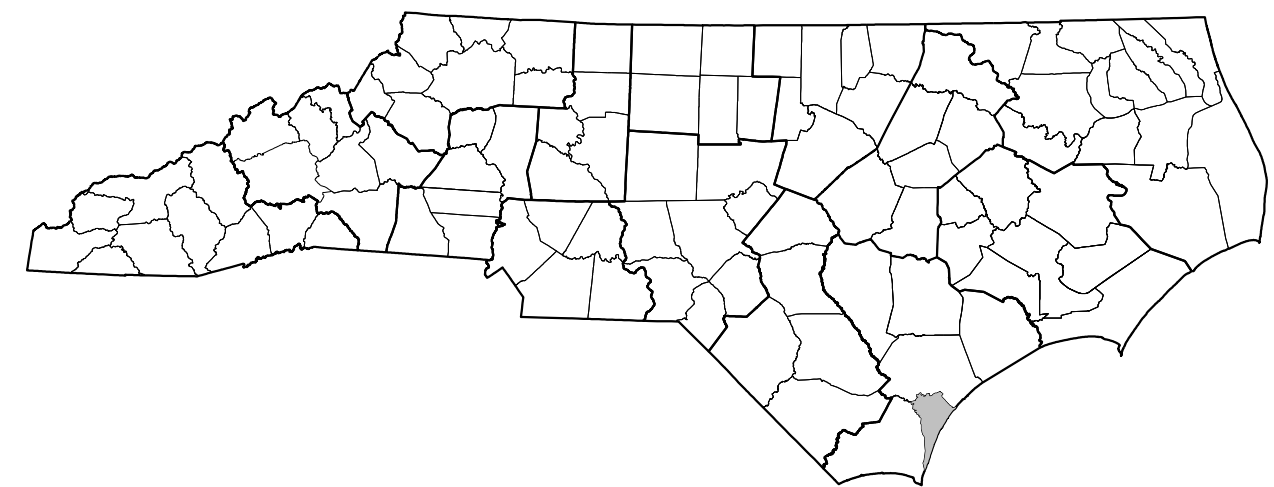

**CAPE FEAR MEMORIAL BRIDGE NO. 13 (US 17/74/76/421)  
OVER CAPE FEAR RIVER IN WILMINGTON**

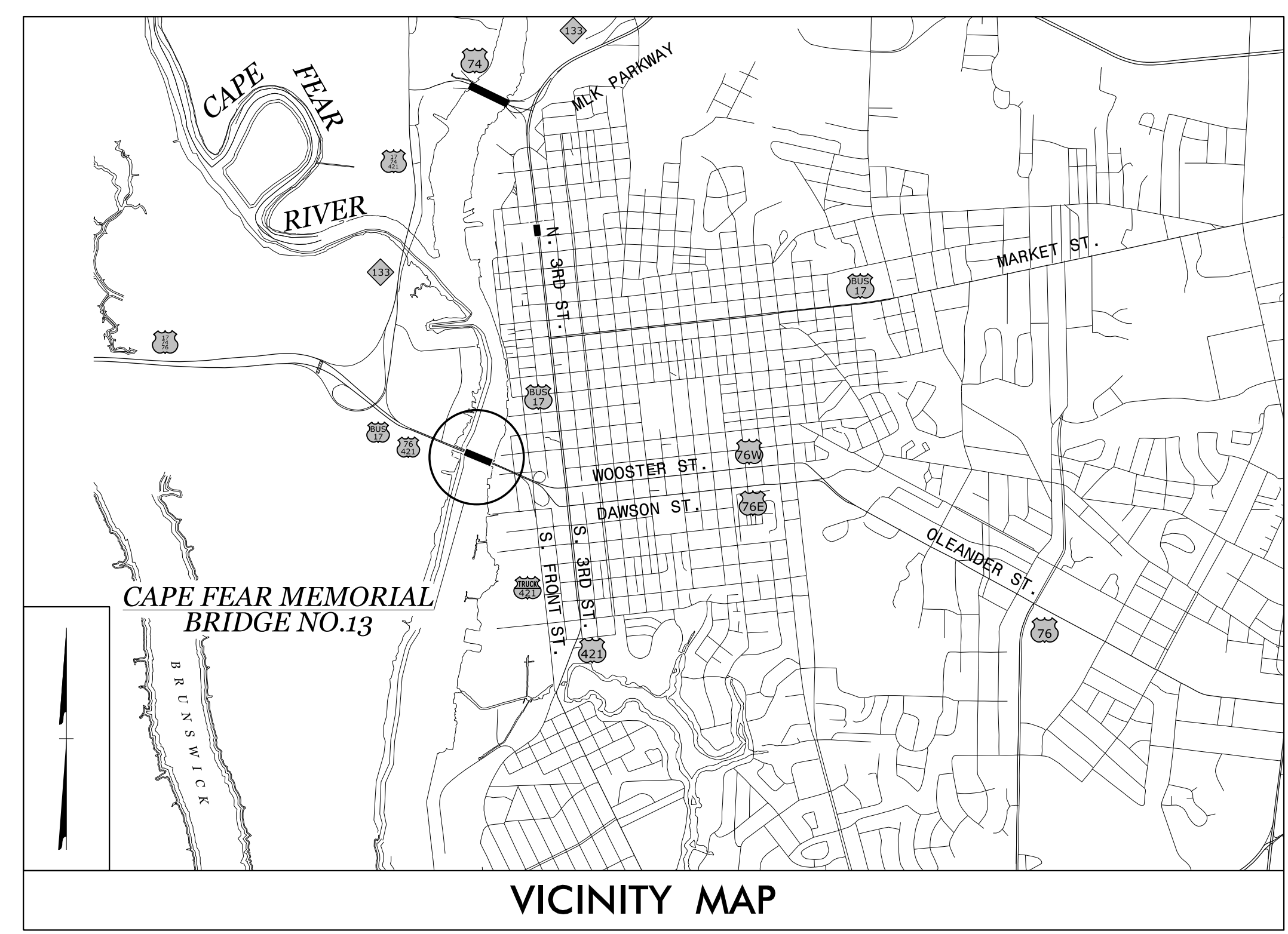

VICINITY MAP

SHEET NO.	TITLE
TMP-1	TITLE SHEET, VICINITY MAP, AND INDEX OF SHEETS
TMP-1A	LIST OF APPLICABLE ROADWAY STANDARD DRAWINGS, AND LEGEND
TMP-2	GENERAL NOTES
TMP-3	TEMPORARY TRAFFIC CONTROL PHASING
TMP-4	WORK ZONE ADVANCE WARNING SIGNS
TMP-4A	TRAFFIC SHIFT DETAILS
TMP-5	DETOUR SIGNS AND CMS MESSAGES
TMP-6	EASTBOUND BRIDGE CLOSURE DETOUR ROUTE
TMP-7	EASTBOUND ROAD CLOSURE DETAIL
TMP-8	WESTBOUND LANE CLOSURES
TMP-9	WESTBOUND BRIDGE CLOSURE DETOUR ROUTE
TMP-10	WESTBOUND ROAD CLOSURE DETAIL

SHEET NO.  
TMP-1

11/3/2023  
U:\Traffic\Transportation Management Plan\TCP\PLAN SHEETS\15BR.102.3\_TMP\_01\_TITLE.dgn  
angood

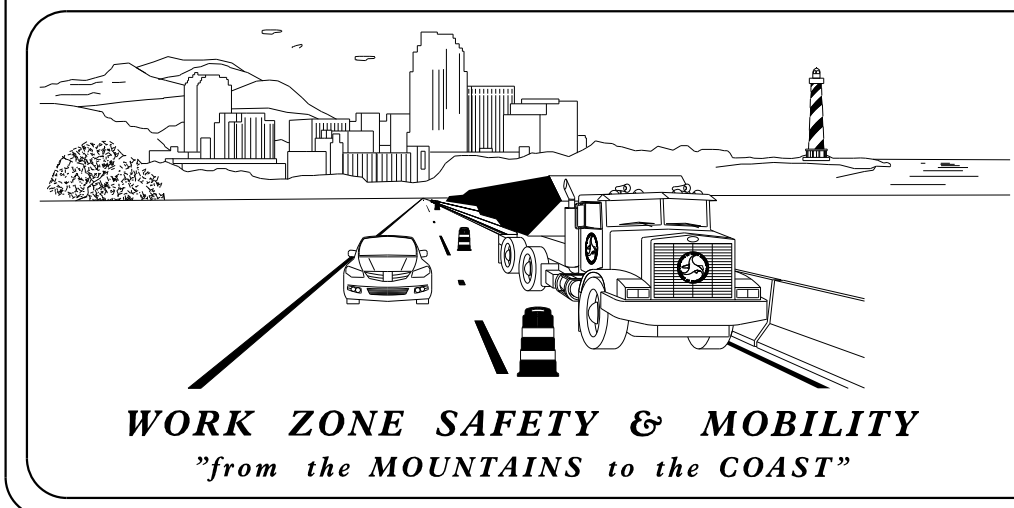

**PLANS PREPARED BY:**

JAY W. WOOLARD, PE  
SENIOR TRANSPORTATION ENGINEER

ANDREW N. GOOD  
TRANSPORTATION DESIGNER

**NCDOT CONTACTS:**

TIM SHERRILL, PE  
PROJECT ENGINEER

PROJECT DESIGN ENGINEER

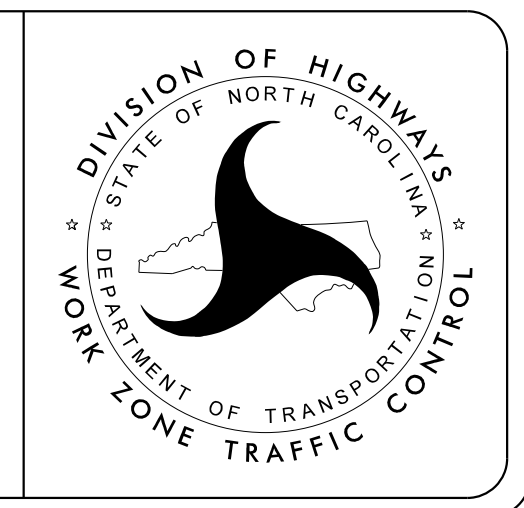

Stantec Consulting Services Inc.  
801 Jones Franklin Road, Suite 300  
Raleigh, NC 27606  
Tel. 919.851.6866  
Fax. 919.851.7024  
www.stantec.com  
License No. F-0672

DOCUMENT NOT CONSIDERED FINAL  
UNLESS ALL SIGNATURES COMPLETED



11/3/2023

DOCUMENT NOT CONSIDERED FINAL  
UNLESS ALL SIGNATURES COMPLETED

**PROJECT: 15BR.102.3**

# ROADWAY STANDARD DRAWINGS

THE FOLLOWING ROADWAY STANDARDS AS APPEAR IN "ROADWAY STANDARD DRAWINGS" - PROJECT SERVICES UNIT - N.C. DEPARTMENT OF TRANSPORTATION - RALEIGH, N.C., DATED JANUARY 2018 ARE APPLICABLE TO THIS PROJECT AND BY REFERENCE HEREBY ARE CONSIDERED A PART OF THESE PLANS:

STD. NO.	TITLE
1101.01	WORK ZONE ADVANCE WARNING SIGNS
1101.02	TEMPORARY LANE CLOSURES
1101.03	TEMPORARY ROAD CLOSURES
1101.11	TRAFFIC CONTROL DESIGN TABLES
1110.01	STATIONARY WORK ZONE SIGNS
1110.02	PORTABLE WORK ZONE SIGNS
1115.01	FLASHING ARROW BOARDS
1130.01	DRUMS
1135.01	CONES
1145.01	BARRICADES
1165.01	TRUCK MOUNTED ATTENUATOR
1180.01	SKINNY - DRUM

## GENERAL

- DIRECTION OF TRAFFIC FLOW
- EXIST. PVMT.
- PROPOSED PVMT.
- NORTH ARROW
- TEMP. SHORING (LOCATION PURPOSES ONLY)
- WORK AREA
- PREVIOUSLY STARTED / CONCURRENT CONSTRUCTION
- PAVEMENT REMOVAL
- TEMPORARY PAVEMENT

## PAVEMENT MARKINGS

- |  |                     |
|--|---------------------|
|  | EXISTING LINES      |
|  | TEMPORARY MARKINGS  |
|  | PREVIOUSLY PLACED   |
|  | WHITE EDGE LINE     |
|  | YELLOW EDGE LINE    |
|  | BROKEN LANE LINES   |
|  | MINISKIP LANE LINES |
|  | DOUBLE YELLOW LINES |
|  | GORELINE            |
|  | STOP BAR            |

## PAVEMENT MARKING SYMBOLS

- EXISTING PAVEMENT MARKING SYMBOLS (HOLLOW)
- TEMPORARY SYMBOLS
- PREVIOUSLY PLACED
- PAVEMENT MARKING SYMBOLS
- ONLY
- ONLY
- PAVEMENT MARKING ALPHANUMERIC CHARACTERS

## TRAFFIC CONTROL DEVICES

- | TEMPORARY DEVICES | PREVIOUSLY PLACED |                                |
|-------------------|-------------------|--------------------------------|
|                   |                   | BARRICADE (TYPE III)           |
|                   |                   | CONE                           |
|                   |                   | DRUM                           |
|                   |                   | SKINNY DRUM                    |
|                   |                   | FLASHING ARROW BOARD           |
|                   |                   | FLAGGER                        |
|                   |                   | LAW ENFORCEMENT                |
|                   |                   | TRUCK MOUNTED ATTENUATOR (TMA) |
|                   |                   | CHANGEABLE MESSAGE SIGN        |
|                   |                   | TEMPORARY CRASH CUSHION RESET  |

## SIGNALS

- EXISTING
- PROPOSED
- TEMPORARY

## TEMPORARY SIGNING

- | TEMPORARY SIGNS | PREVIOUSLY PLACED |                 |
|-----------------|-------------------|-----------------|
|                 |                   | PORTABLE SIGN   |
|                 |                   | STATIONARY SIGN |

## PAVEMENT MARKERS

- CRYSTAL/CRYSTAL
- CRYSTAL/RED
- YELLOW/YELLOW

ANCHORED CONCRETE BARRIER (RESET)

9/9/2023 U:\Traffic\Transportation Management\Plan\TCP\PLAN SHEETS\15BPR.102.3\_TMP\_01A\_RDWYSTDSLEGEND.dgn angood

<p>Stantec Consulting Services Inc. 801 Jones Franklin Road Suite 300 Raleigh, NC 27606 Tel. 919.851.6866 Fax. 919.851.7024 www.stantec.com License No. F-0672</p>	<p>9/11/2023</p> <p><b>DOCUMENT NOT CONSIDERED FINAL UNLESS ALL SIGNATURES COMPLETED</b></p>		<p><b>ROADWAY STANDARD DRAWINGS, AND LEGEND</b></p>
--	--	--	---



## GENERAL NOTES

CHANGES MAY BE REQUIRED WHEN PHYSICAL DIMENSIONS IN THE DETAIL DRAWINGS, STANDARD DETAILS, AND ROADWAY DETAILS ARE NOT ATTAINABLE TO MEET FIELD CONDITIONS OR RESULT IN DUPLICATE OR UNDESIRED OVERLAPPING OF DEVICES. MODIFICATION MAY INCLUDE: MOVING, SUPPLEMENTING, COVERING, OR REMOVAL OF DEVICES AS DIRECTED BY THE ENGINEER.

THE FOLLOWING GENERAL NOTES APPLY AT ALL TIMES FOR THE DURATION OF THE CONSTRUCTION PROJECT EXCEPT WHEN OTHERWISE NOTED IN THE PLAN OR DIRECTED BY THE ENGINEER.

### TIME RESTRICTIONS

A) DO NOT CLOSE OR NARROW TRAVEL LANES ON ANY ROADWAY AS FOLLOWS:

#### ROAD NAME

-L- (US 76, 421, BUS 17)

#### DAY AND TIME RESTRICTIONS

5:00 A.M. - 7:00 P.M. MONDAY THROUGH SUNDAY

B) DO NOT CLOSE OR NARROW TRAVEL LANES DURING HOLIDAYS AND SPECIAL EVENTS AS FOLLOWS:

#### ROAD NAME

-L- (US 76, 421, BUS 17)

#### HOLIDAY

1. FOR ANY UNEXPECTED OCCURRENCE THAT CREATES UNUSUALLY HIGH TRAFFIC VOLUMES, AS DIRECTED BY THE ENGINEER.
2. FOR NEW YEAR'S, BETWEEN THE HOURS OF 5:00 A.M. DECEMBER 31st TO 7:00 P.M. JANUARY 2ND. IF NEW YEAR'S DAY IS ON A FRIDAY, SATURDAY, SUNDAY, OR MONDAY THEN UNTIL 7:00 P.M. THE FOLLOWING TUESDAY.
3. FOR MEMORIAL DAY, BETWEEN THE HOURS OF 5:00 A.M. FRIDAY TO 7:00 P.M. TUESDAY.
4. FOR INDEPENDENCE DAY, BETWEEN THE HOURS OF 5:00 A.M. THE DAY BEFORE INDEPENDENCE DAY AND 7:00 P.M. THE DAY AFTER INDEPENDENCE DAY.  
  
IF INDEPENDENCE DAY IS ON A FRIDAY, SATURDAY, SUNDAY OR MONDAY THEN BETWEEN THE HOURS OF 5:00 A.M. THE THURSDAY BEFORE INDEPENDENCE DAY AND 7:00 P.M. THE TUESDAY AFTER INDEPENDENCE DAY.
5. FOR LABOR DAY, BETWEEN THE HOURS OF 5:00 A.M. FRIDAY AND 7:00 P.M. TUESDAY.
6. FOR THANKSGIVING DAY, BETWEEN THE HOURS OF 5:00 A.M. TUESDAY TO 7:00 P.M. MONDAY.
7. FOR CHRISTMAS, BETWEEN THE HOURS OF 5:00 A.M. THE FRIDAY BEFORE THE WEEK OF CHRISTMAS DAY AND 7:00 P.M. THE FOLLOWING TUESDAY AFTER THE WEEK OF CHRISTMAS.
8. FOR THE AZALEA FESTIVAL EVENT, BETWEEN THE HOURS OF 5:00 A.M. THE TUESDAY BEFORE THE WEEKEND OF THE AZALEA FESTIVAL TO 7:00 P.M. MONDAY AFTER THE WEEKEND OF THE AZALEA FESTIVAL.
9. FOR THE RIVERFEST EVENT, BETWEEN THE HOURS OF 5:00 A.M. THE FRIDAY BEFORE THE WEEKEND OF THE RIVERFEST TO 7:00 P.M. THE MONDAY AFTER THE WEEKEND OF THE RIVERFEST.

C) CONTRACTOR SHALL NOT CLOSE A LANE OF TRAFFIC OR ALLOW ANY MATERIAL DELIVERIES ON THE OPEN SIDE OF TRAFFIC ON THE CAPE FEAR MEMORIAL BRIDGE WHEN A DIRECTIONAL CLOSURE IS IN PLACE.

### LANE AND SHOULDER CLOSURE REQUIREMENTS

D) REMOVE LANE CLOSURE DEVICES FROM THE LANE WHEN WORK IS NOT BEING PERFORMED BEHIND THE LANE CLOSURE OR WHEN A LANE CLOSURE IS NO LONGER NEEDED OR AS DIRECTED BY THE ENGINEER.

E) WHEN PERSONNEL AND/OR EQUIPMENT ARE WORKING WITHIN 15 FT OF AN OPEN TRAVEL LANE, CLOSE THE NEAREST OPEN SHOULDER USING ROADWAY STANDARD DRAWING NO. 1101.04 UNLESS THE WORK AREA IS PROTECTED BY BARRIER OR GUARDRAIL OR A LANE CLOSURE IS INSTALLED.

F) WHEN PERSONNEL AND/OR EQUIPMENT ARE WORKING ON THE SHOULDER ADJACENT TO AN UNDIVIDED FACILITY AND WITHIN 5 FT OF AN OPEN TRAVEL LANE, CLOSE THE NEAREST OPEN TRAVEL LANE USING ROADWAY STANDARD DRAWING NO. 1101.02 UNLESS THE WORK AREA IS PROTECTED BY BARRIER OR GUARDRAIL.

WHEN PERSONNEL AND/OR EQUIPMENT ARE WORKING ON THE SHOULDER ADJACENT TO A DIVIDED FACILITY AND WITHIN 10 FT OF AN OPEN TRAVEL LANE, CLOSE THE NEAREST OPEN TRAVEL LANE USING ROADWAY STANDARD DRAWING NO. 1101.02 UNLESS THE WORK AREA IS PROTECTED BY BARRIER OR GUARDRAIL.

G) WHEN PERSONNEL AND/OR EQUIPMENT ARE WORKING WITHIN A LANE OF TRAVEL OF AN UNDIVIDED OR DIVIDED FACILITY, CLOSE THE LANE ACCORDING TO THE TRAFFIC CONTROL PLANS, ROADWAY STANDARD DRAWINGS, OR AS DIRECTED BY THE ENGINEER. CONDUCT THE WORK SO THAT ALL PERSONNEL AND/OR EQUIPMENT REMAIN WITHIN THE CLOSED TRAVEL LANE.

### TRAFFIC PATTERN ALTERATIONS

H) NOTIFY THE ENGINEER TWENTY ONE (21) CALENDAR DAYS PRIOR TO ANY TRAFFIC PATTERN ALTERATION.

### SIGNING

I) INSTALL WORK ZONE ADVANCE WARNING SIGNS WHEN WORK IS WITHIN 40 FT FROM THE EDGE OF TRAVEL LANE AND NO MORE THAN THREE (3) DAYS PRIOR TO THE BEGINNING OF CONSTRUCTION.

J) PROVIDE SIGNING AND DEVICES REQUIRED TO CLOSE THE ROAD ACCORDING TO THE ROADWAY STANDARD DRAWINGS AND TRAFFIC CONTROL PLANS.

AND

PROVIDE SIGNING REQUIRED FOR THE OFFSITE DETOUR ROUTES AS SHOWN IN THE TRAFFIC CONTROL PLANS.

K) COVER OR REMOVE ALL SIGNS AND DEVICES REQUIRED TO CLOSE THE ROAD WHEN ROAD CLOSURE IS NOT IN OPERATION.

AND

COVER OR REMOVE ALL SIGNS REQUIRED FOR THE OFFSITE DETOURS WHEN THE DETOUR IS NOT IN OPERATION, UNLESS OTHERWISE ALLOWED BY THE ENGINEER.

L) ENSURE ALL NECESSARY SIGNING IS IN PLACE PRIOR TO ALTERING ANY TRAFFIC PATTERN.

### MISCELLANEOUS

M) LAW ENFORCEMENT MAY BE USED TO MAINTAIN TRAFFIC THROUGH THE WORK AREA AND/OR INTERSECTIONS AS DIRECTED BY THE ENGINEER.

N) ALL DIMENSIONS AND STATIONS IN THE TRAFFIC CONTROL PLAN AND PHASING ARE APPROXIMATE; FIELD ADJUST AS NECESSARY OR AS DIRECTED BY THE ENGINEER.

O) THE CONTRACTOR IS TO FURNISH, INSTALL, MAINTAIN, RELOCATE AND REMOVE CHANGEABLE MESSAGE SIGNS DURING VARIOUS STAGES OF CONSTRUCTION AT THE DISCRETION OF THE ENGINEER TO ADEQUATELY INFORM MOTORISTS OF CHANGING WORK ZONE CONDITIONS.

P) PLACE ALL CHANGEABLE MESSAGE SIGNS AS NEEDED IN THE LOCATIONS AND WITH THE WORD MESSAGES AS SHOWN IN THE TCP OR AS DIRECTED BY THE ENGINEER TO PROVIDE ADVANCE WARNING TO THE PUBLIC DURING CONSTRUCTION.

Q) ENSURE THE OVERSIZE/OVERWEIGHT PERMIT UNIT (888) 221-8166 OR (919) 814-3700 HAS BEEN ADVISED OF THE ONGOING TRAFFIC OPERATIONS THROUGH THE DIVISION OFFICE INCLUDING THE FOLLOWING AREAS OF CONCERN:

A. LANE CLOSURE RESTRICTIONS.

B. DETOURS OFFSITE AND ONSITE.

C. AREAS OF CONSTRICTED HORIZONTAL CLEARANCES (NARROW LANES OR LANES BORDERED ALONG THE OUTSIDE WITH EITHER PCB OR GUARDRAIL).

9/21/2023 1:41:11 PM Traffic\Transportation Management\Plan\TCP\PLAN SHEETS\15BPR.102.3\_TMP\_02\_GENERAL NOTES.dgn angood



Stantec Consulting Services Inc.  
801 Jones Franklin Road  
Suite 300  
Raleigh, NC 27606  
Tel. 919.851.6866  
Fax. 919.851.7024  
www.stantec.com  
License No. F-0672

DocuSigned by  
9/21/2023

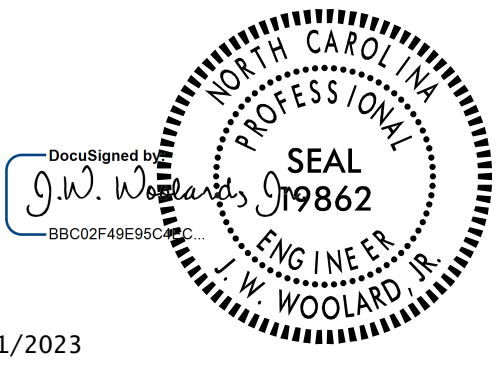

**DOCUMENT NOT CONSIDERED FINAL  
UNLESS ALL SIGNATURES COMPLETED**



GENERAL NOTES

# TRAFFIC CONTROL PHASING

PERFORM ALL BRIDGE REPAIR OPERATIONS IN THE PHASING USING LANE CLOSURES OR ROAD CLOSURES AS OUTLINED BELOW:

REFER TO GENERAL NOTES FOR TIME AND HOLIDAY RESTRICTIONS.

### LANE CLOSURES

-EASTBOUND TO DOWNTOWN WILMINGTON USE ROADWAY STD. DRAWING 1101.02, SHEET 3 FOR LANE CLOSURES.

-WESTBOUND FROM DOWNTOWN WILMINGTON USE SHEET TCP-8 FOR LEFT OR RIGHT LANE CLOSURES.

-WHEN WORKING IN AN INTERIOR LANE ON THE BRIDGE, CLOSE BOTH INBOUND AND OUTBOUND INTERIOR LANES.

### ROAD CLOSURES

-EASTBOUND TO DOWNTOWN WILMINGTON CLOSE BRIDGE NO.13 IN ACCORDANCE WITH SHEET TCP-6 AND TCP-7 IN CONJUNCTION WITH ROADWAY STD. DRAWING 1101.03, SHEET 7.

-WESTBOUND FROM DOWNTOWN WILMINGTON CLOSE BRIDGE NO.13 IN ACCORDANCE WITH SHEET TCP-9 AND TCP-10.

### PHASING

STEP 1: INSTALL WORK ZONE ADVANCE WARNING SIGNS (SEE TCP-4) ON PROJECT NO MORE THAN THREE (3) CALENDAR DAYS BEFORE BEGINNING WORK.

STEP 2: INSTALL AND COVER OFF-SITE DETOUR SIGNS FOR EASTBOUND US 76, 421, BUS 17 AS SHOWN ON TMP-6, 7.

STEP 3: USING LANE CLOSURES AND RSD 1101.02, SHEET 3, INSTALL PCB AND TEMPORARY ATTENUATOR, TRAFFIC SHIFT MARKINGS AND DEVICES, AND TEMPORARY STEEL BARRIER ON WESTBOUND US 76, 421, BUS 17.(SEE TMP-4A)

COMPLETE THE WORK OF STEPS 4 - 6 BY APRIL 1, 2024. (SEE SPECIAL PROVISIONS)

STEP 4: UNCOVER EASTBOUND US 76, 421, BUS 17 DETOUR SIGNS AND SHIFT TRAFFIC ONTO THE DETOUR.

REMOVE THE PERMANENT MEDIAN BARRIER RAIL AND BEGIN GRID DECK REPLACEMENT ON EASTBOUND US 76, 421, BUS 17 AS SHOWN IN THE STRUCTURE PLANS.

COMPLETE THE WORK OF STEP 4A BETWEEN 7:00 PM FRIDAY AND 5:00 AM THE FOLLOWING MONDAY (58 CONSECUTIVE HOURS). (SEE SPECIAL PROVISIONS)

STEP 4A: INSTALL OFF-SITE DETOUR SIGNS FOR WESTBOUND US 76, 421, BUS 17 AS SHOWN ON TMP-9,10 AND SHIFT TRAFFIC ONTO THE DETOUR.

WELD STIFFENERS BACK ONTO THE FLOOR BEAMS ON THE EASTBOUND SIDE OF THE BRIDGE.

COVER OFF-SITE DETOUR SIGNS FOR WESTBOUND US 76, 421, AND BUS 17 AND OPEN WESTBOUND TRAFFIC ON THE CAPE FEAR MEMORIAL BRIDGE TO TRAFFIC.

STEP 5: COMPLETE THE GRID DECK REPLACEMENT ON EASTBOUND US 76, 421, BUS 17 AS SHOWN IN THE STRUCTURE PLANS.

STEP 6: INSTALL TEMPORARY STEEL BARRIER ON THE EASTBOUND SIDE OF THE BRIDGE AS SHOWN IN THE STRUCTURE PLANS.

INSTALL TRAFFIC SHIFT MARKINGS AND DEVICES, INCLUDING PCB AND TEMPORARY ATTENUATOR ON EASTBOUND US 76, 421, BUS 17 AS SHOWN ON TMP-4A. OPEN EASTBOUND US 76, 421, BUS 17 TO TRAFFIC IN THE SHIFTED PATTERN.

COMPLETE THE WORK OF STEPS 8 - 10 BETWEEN 7:00PM APRIL 8, 2024 AND MAY 23, 2024. (SEE SPECIAL PROVISIONS)

STEP 7: UNCOVER DETOUR SIGNS INSTALLED IN STEP 4A, CLOSE WESTBOUND US 76, 421, BUS 17 AND PLACE TRAFFIC ON THE OFF-SITE DETOUR. (SEE TMP-9,10)

STEP 8: REMOVE TEMPORARAY STEEL BARRIER FROM WESTBOUND SIDE OF THE BRIDGE. BEGIN GRID DECK REPLACEMENT ON WESTBOUND US 76, 421, BUS 17 AS SHOWN IN THE STRUCTURE PLANS.

COMPLETE THE WORK OF STEP 8A BETWEEN 7:00 PM FRIDAY AND 5:00 AM THE FOLLOWING MONDAY (58 CONSECUTIVE HOURS). (SEE SPECIAL PROVISIONS)

STEP 8A: INSTALL OFF-SITE DETOUR SIGNS FOR EASTBOUND US 76, 421, BUS 17 AS SHOWN ON TMP-6,7 AND SHIFT TRAFFIC ONTO THE DETOUR.

WELD STIFFENERS BACK ONTO THE FLOOR BEAMS ON THE WESTBOUND SIDE OF THE BRIDGE.

COVER OFF-SITE DETOUR SIGNS FOR EASTBOUND US 76, 421, AND BUS 17 AND OPEN EASTBOUND TRAFFIC ON THE CAPE FEAR MEMORIAL BRIDGE TO TRAFFIC.

STEP 9: COMPLETE THE GRID DECK REPLACEMENT ON WESTBOUND US 76, 421, BUS 17 AS SHOWN IN THE STRUCTURE PLANS. INSTALL THE PERMANENT MEDAIN BARRIER RAIL.

PLACE FINAL MARKINGS ON WESTBOUND US 76, 421, BUS 17 AS SHOWN IN THE FINAL PAVEMENT MARKING PLANS.

STEP 10: REMOVE ALL TRAFFIC CONTROL DEVICES AND REOPEN WESTBOUND US 76, 421, BUS 17 TO TRAFFIC IN THE FINAL PATTERN.

STEP 11: USING LANE CLOSURES PER ROADWAY STD. DRAWING 1101.02, SHEET 3, REMOVE TEMPORARY STEEL BARRIER AND ALL TRAFFIC CONTROL DEVICES, PLACE FINAL MARKINGS ON EASTBOUND US 76, 421, BUS 17 AS SHOWN IN THE FINAL PAVEMENT MARKING PLANS, AND OPEN EASTBOUND TO FINAL PATTERN.

STEP 12: USING LANE CLOSURES, RSD 1101.01, SHEET 3, AND TMP-8, COMPLETE REMAINING STRUCTURE REPAIRS AS SHOWN IN THE STRUCTURE PLANS

STEP 13: REMOVE ALL TRAFFIC CONTROL DEVICES AND OPEN TRAFFIC TO FINAL PATTERN.

11/3/2023  
U:\Traffic\Transportation Management\Plan\TCP\PLAN SHEETS\15BPR.102.3\_TMP\_03\_PHASING.dgn  
angood



Stantec Consulting Services Inc.  
801 Jones Franklin Road  
Suite 300  
Raleigh, NC 27606  
Tel. 919.851.6866  
Fax. 919.851.7024  
www.stantec.com  
License No. F-0672

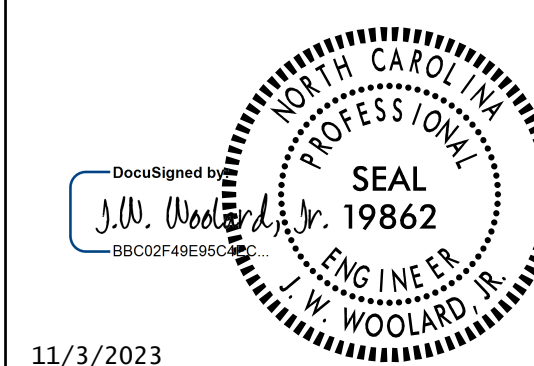

11/3/2023

DOCUMENT NOT CONSIDERED FINAL  
UNLESS ALL SIGNATURES COMPLETED

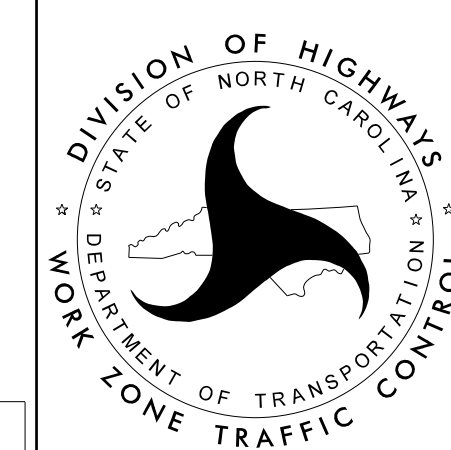

PHASING



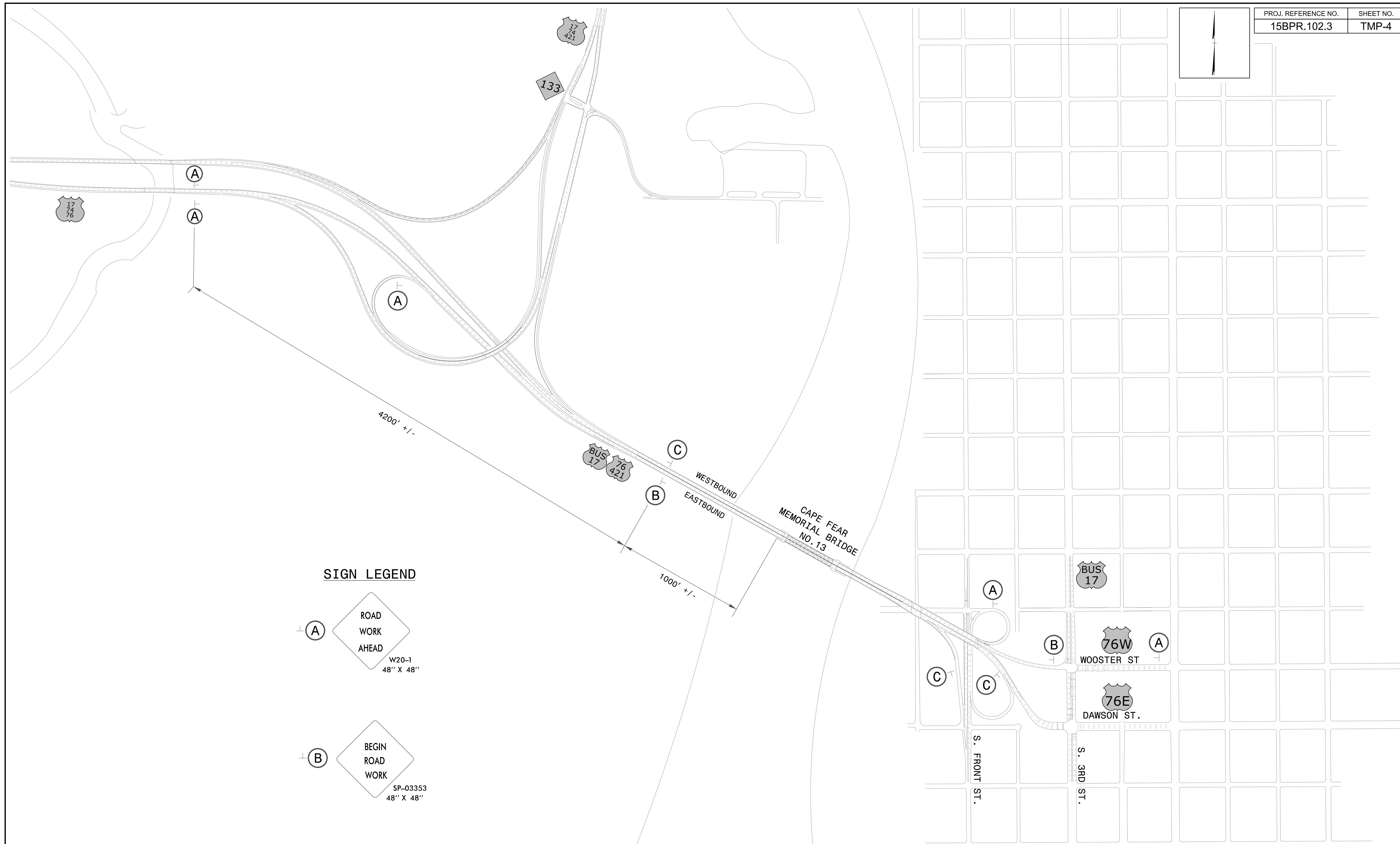
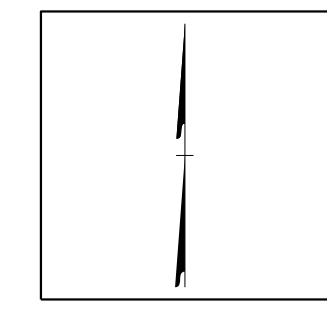

**SIGN LEGEND**

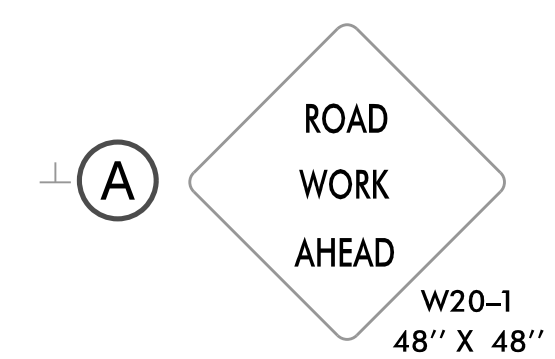
- 

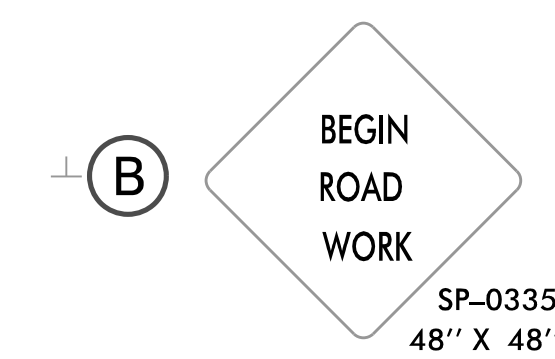
ROAD WORK AHEAD  
W20-1  
48" X 48"
- 

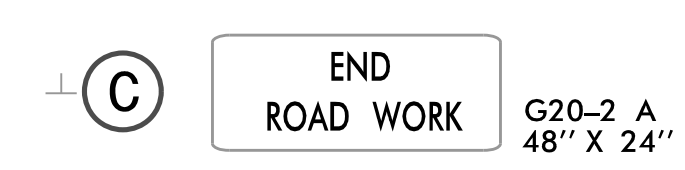
BEGIN ROAD WORK  
SP-03353  
48" X 48"
- 

END ROAD WORK  
G20-2 A  
48" X 24"

**NOTE: INSTALL SIGNS NO MORE THAN 3 DAYS BEFORE BEGINNING WORK.**

9/9/2023  
 U:\Traffic\Transportation Management Plan\TCP\PLAN SHEETS\15BPR.102.3\_TMP\_04\_WZ\_ADVANCE\_SIGNS.dgn  
 angood



Stantec Consulting Services Inc.  
 801 Jones Franklin Road  
 Suite 300  
 Raleigh, NC 27606  
 Tel. 919.851.6866  
 Fax. 919.851.7024  
 www.stantec.com  
 License No. F-0672

DocuSigned by  
*J.W. Woollard*  
 99862  
 88002F48E959



9/11/2023

**DOCUMENT NOT CONSIDERED FINAL  
 UNLESS ALL SIGNATURES COMPLETED**



DIVISION OF HIGHWAYS  
 STATE OF NORTH CAROLINA  
 DEPARTMENT OF TRANSPORTATION  
 WORK ZONE TRAFFIC CONTROL

**WORK ZONE  
 ADVANCE WARNING SIGNS**

# EASTBOUND CLOSURE DETAIL

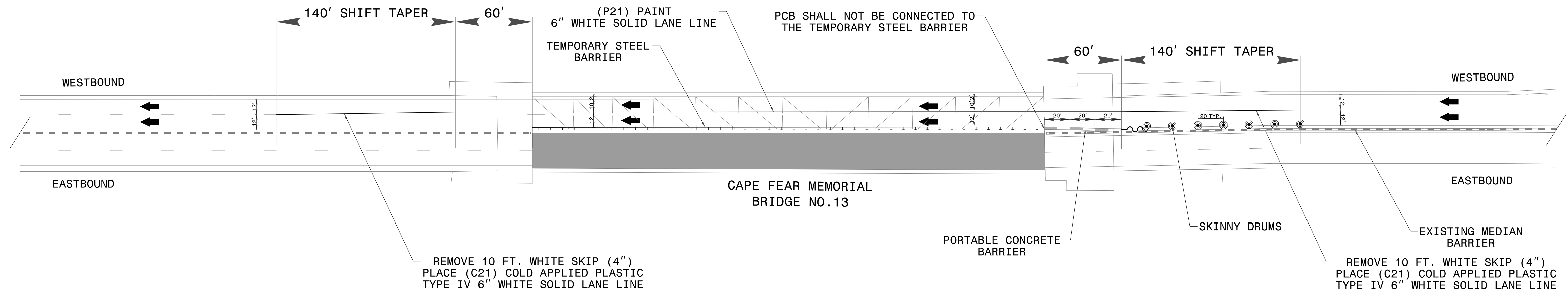

# WESTBOUND CLOSURE DETAIL

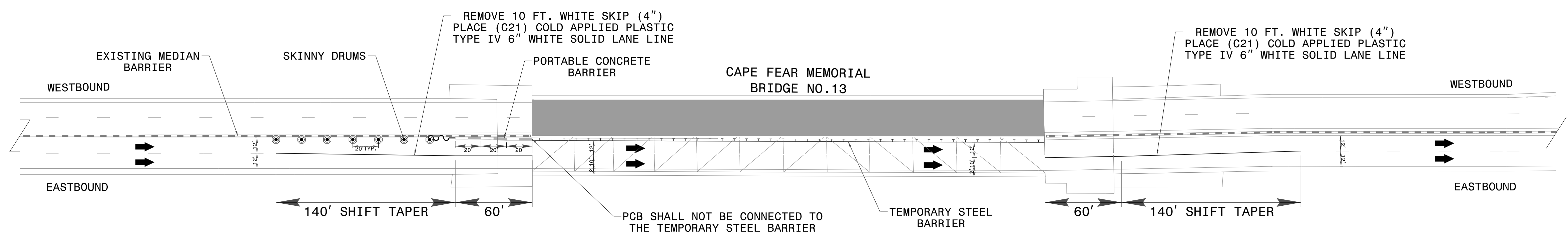

9/9/2023  
U:\Traffic\Transportation Management\Plan\TCP\PLAN SHEETS\15BPR.102.3\_TMP\_04A\_TRAFFIC\_SHIFT\_DETAILS.dgn  
angood

<p>Stantec Consulting Services Inc. 801 Jones Franklin Road Suite 300 Raleigh, NC 27606 Tel. 919.851.6866 Fax. 919.851.7024 www.stantec.com License No. F-0672</p>	<p>DocuSigned by: J.W. Williams 98002F48E950</p> <p>9/11/2023</p> <p><b>DOCUMENT NOT CONSIDERED FINAL UNLESS ALL SIGNATURES COMPLETED</b></p>	<p>DIVISION OF HIGHWAYS DEPARTMENT OF TRANSPORTATION WORK ZONE TRAFFIC CONTROL</p>	<p>TRAFFIC SHIFT DETAILS</p>
--	---	--	----------------------------------



**DETOUR SIGNS AND  
CHANGEABLE MESSAGE SIGN MESSAGES  
FOR WESTBOUND, AND EASTBOUND BRIDGE CLOSURES**

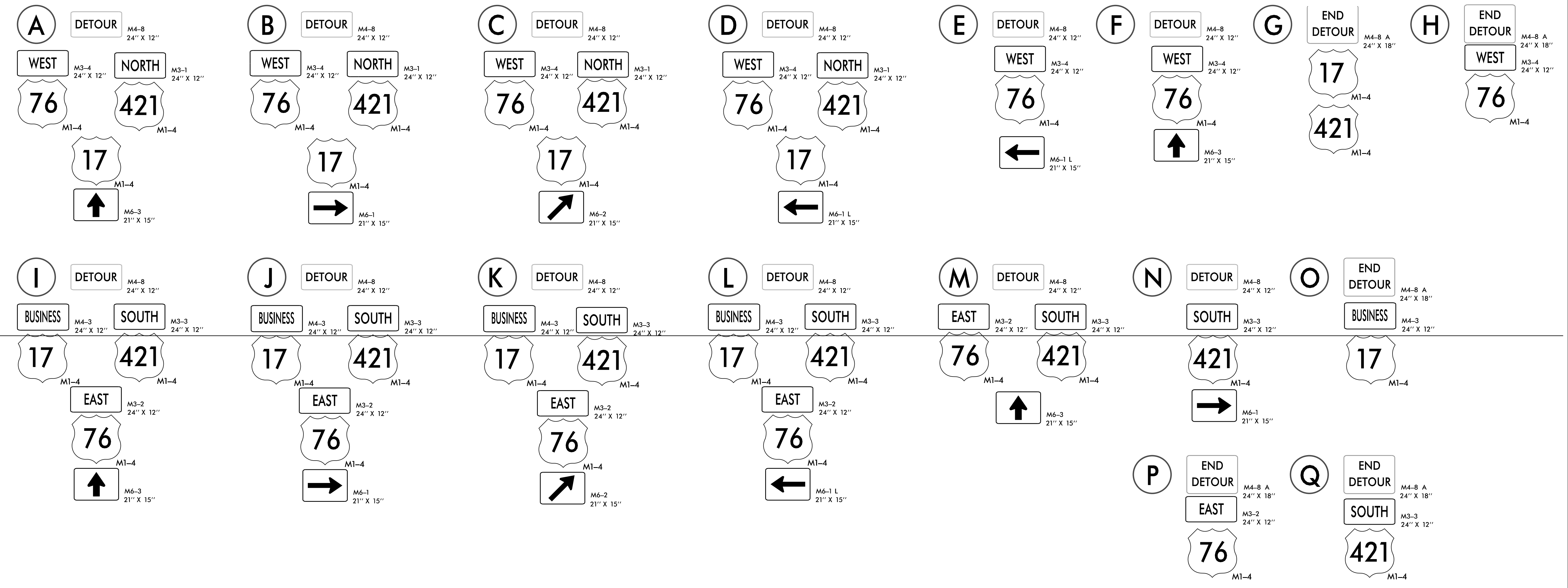

<p><b>CMS 1</b></p> <table border="1"> <tr><th>MESSAGE NO. 1</th><th>MESSAGE NO. 2</th><th>MESSAGE NO. 3</th></tr> <tr><td>MEMORIAL BRIDGE CLOSED</td><td>US 17 76 WEST 421NORTH</td><td>DETOUR NEXT RIGHT</td></tr> </table>	MESSAGE NO. 1	MESSAGE NO. 2	MESSAGE NO. 3	MEMORIAL BRIDGE CLOSED	US 17 76 WEST 421NORTH	DETOUR NEXT RIGHT	<p><b>CMS 2</b></p> <table border="1"> <tr><th>MESSAGE NO. 1</th><th>MESSAGE NO. 2</th><th>MESSAGE NO. 3</th></tr> <tr><td>ROAD CLOSED</td><td>NO THRU TRAFFIC</td><td>DETOUR USE LEFT LANE</td></tr> </table>	MESSAGE NO. 1	MESSAGE NO. 2	MESSAGE NO. 3	ROAD CLOSED	NO THRU TRAFFIC	DETOUR USE LEFT LANE	<p><b>CMS 3</b></p> <table border="1"> <tr><th>MESSAGE NO. 1</th><th>MESSAGE NO. 2</th><th>MESSAGE NO. 3</th></tr> <tr><td>MEMORIAL BRIDGE CLOSED</td><td>US 17 76 WEST 421NORTH</td><td>DETOUR USE LEFT LANE</td></tr> </table>	MESSAGE NO. 1	MESSAGE NO. 2	MESSAGE NO. 3	MEMORIAL BRIDGE CLOSED	US 17 76 WEST 421NORTH	DETOUR USE LEFT LANE	<p><b>CMS 4</b></p> <table border="1"> <tr><th>MESSAGE NO. 1</th><th>MESSAGE NO. 2</th><th>MESSAGE NO. 3</th></tr> <tr><td>US 17 76 WEST 421NORTH</td><td>DETOUR NEXT LEFT</td><td>USE MLK PKWY</td></tr> </table>	MESSAGE NO. 1	MESSAGE NO. 2	MESSAGE NO. 3	US 17 76 WEST 421NORTH	DETOUR NEXT LEFT	USE MLK PKWY	<p><b>CMS 8</b></p> <table border="1"> <tr><th>MESSAGE NO. 1</th><th>MESSAGE NO. 2</th><th>MESSAGE NO. 3</th></tr> <tr><td>MEMORIAL BRIDGE CLOSED</td><td>17 BUS 76 EAST 421SOUTH</td><td>DETOUR VIA 74 EAST</td></tr> </table>	MESSAGE NO. 1	MESSAGE NO. 2	MESSAGE NO. 3	MEMORIAL BRIDGE CLOSED	17 BUS 76 EAST 421SOUTH	DETOUR VIA 74 EAST	<p><b>CMS 9</b></p> <table border="1"> <tr><th>MESSAGE NO. 1</th><th>MESSAGE NO. 2</th><th>MESSAGE NO. 3</th></tr> <tr><td>17 BUS 76 EAST 421SOUTH</td><td>EXIT CLOSED</td><td>DETOUR NEXT LEFT</td></tr> </table>	MESSAGE NO. 1	MESSAGE NO. 2	MESSAGE NO. 3	17 BUS 76 EAST 421SOUTH	EXIT CLOSED	DETOUR NEXT LEFT	<p><b>CMS 10</b></p> <table border="1"> <tr><th>MESSAGE NO. 1</th><th>MESSAGE NO. 2</th><th>MESSAGE NO. 3</th></tr> <tr><td>17 BUS 76 EAST 421SOUTH</td><td>DETOUR EXIT RIGHT</td><td>FOLLOW US 74 EAST</td></tr> </table>	MESSAGE NO. 1	MESSAGE NO. 2	MESSAGE NO. 3	17 BUS 76 EAST 421SOUTH	DETOUR EXIT RIGHT	FOLLOW US 74 EAST	<p><b>CMS 11</b></p> <table border="1"> <tr><th>MESSAGE NO. 1</th><th>MESSAGE NO. 2</th></tr> <tr><td>17 BUS 76 EAST 421SOUTH</td><td>DETOUR NEXT RIGHT</td></tr> </table>	MESSAGE NO. 1	MESSAGE NO. 2	17 BUS 76 EAST 421SOUTH	DETOUR NEXT RIGHT
MESSAGE NO. 1	MESSAGE NO. 2	MESSAGE NO. 3																																																			
MEMORIAL BRIDGE CLOSED	US 17 76 WEST 421NORTH	DETOUR NEXT RIGHT																																																			
MESSAGE NO. 1	MESSAGE NO. 2	MESSAGE NO. 3																																																			
ROAD CLOSED	NO THRU TRAFFIC	DETOUR USE LEFT LANE																																																			
MESSAGE NO. 1	MESSAGE NO. 2	MESSAGE NO. 3																																																			
MEMORIAL BRIDGE CLOSED	US 17 76 WEST 421NORTH	DETOUR USE LEFT LANE																																																			
MESSAGE NO. 1	MESSAGE NO. 2	MESSAGE NO. 3																																																			
US 17 76 WEST 421NORTH	DETOUR NEXT LEFT	USE MLK PKWY																																																			
MESSAGE NO. 1	MESSAGE NO. 2	MESSAGE NO. 3																																																			
MEMORIAL BRIDGE CLOSED	17 BUS 76 EAST 421SOUTH	DETOUR VIA 74 EAST																																																			
MESSAGE NO. 1	MESSAGE NO. 2	MESSAGE NO. 3																																																			
17 BUS 76 EAST 421SOUTH	EXIT CLOSED	DETOUR NEXT LEFT																																																			
MESSAGE NO. 1	MESSAGE NO. 2	MESSAGE NO. 3																																																			
17 BUS 76 EAST 421SOUTH	DETOUR EXIT RIGHT	FOLLOW US 74 EAST																																																			
MESSAGE NO. 1	MESSAGE NO. 2																																																				
17 BUS 76 EAST 421SOUTH	DETOUR NEXT RIGHT																																																				
<p><b>CMS 5</b></p> <table border="1"> <tr><th>MESSAGE NO. 1</th><th>MESSAGE NO. 2</th></tr> <tr><td>US 17 76 WEST 421NORTH</td><td>DETOUR NEXT RIGHT</td></tr> </table>	MESSAGE NO. 1	MESSAGE NO. 2	US 17 76 WEST 421NORTH	DETOUR NEXT RIGHT	<p><b>CMS 6</b></p> <table border="1"> <tr><th>MESSAGE NO. 1</th><th>MESSAGE NO. 2</th><th>MESSAGE NO. 3</th></tr> <tr><td>MEMORIAL BRIDGE CLOSED</td><td>US 17 76 WEST 421NORTH</td><td>DETOUR RIGHT ON 76 EAST</td></tr> </table>	MESSAGE NO. 1	MESSAGE NO. 2	MESSAGE NO. 3	MEMORIAL BRIDGE CLOSED	US 17 76 WEST 421NORTH	DETOUR RIGHT ON 76 EAST	<p><b>CMS 7</b></p> <table border="1"> <tr><th>MESSAGE NO. 1</th><th>MESSAGE NO. 2</th></tr> <tr><td>US 17 76 WEST 421NORTH</td><td>DETOUR LEFT ON COLLEGE</td></tr> </table>	MESSAGE NO. 1	MESSAGE NO. 2	US 17 76 WEST 421NORTH	DETOUR LEFT ON COLLEGE	<p><b>EXAMPLE MESSAGES FOR PERIODS JUST PRIOR TO BRIDGE CLOSURE</b></p> <table border="1"> <tr><th>MESSAGE NO. 1</th><th>MESSAGE NO. 2</th></tr> <tr><td>STARTING (DATE)</td><td>WB BRIDGE CLOSED</td></tr> </table>	MESSAGE NO. 1	MESSAGE NO. 2	STARTING (DATE)	WB BRIDGE CLOSED	<p><b>EXAMPLE MESSAGES FOR PERIODS JUST PRIOR TO BRIDGE CLOSURE</b></p> <table border="1"> <tr><th>MESSAGE NO. 1</th><th>MESSAGE NO. 2</th></tr> <tr><td>STARTING (DATE)</td><td>EB BRIDGE CLOSED</td></tr> </table>	MESSAGE NO. 1	MESSAGE NO. 2	STARTING (DATE)	EB BRIDGE CLOSED																											
MESSAGE NO. 1	MESSAGE NO. 2																																																				
US 17 76 WEST 421NORTH	DETOUR NEXT RIGHT																																																				
MESSAGE NO. 1	MESSAGE NO. 2	MESSAGE NO. 3																																																			
MEMORIAL BRIDGE CLOSED	US 17 76 WEST 421NORTH	DETOUR RIGHT ON 76 EAST																																																			
MESSAGE NO. 1	MESSAGE NO. 2																																																				
US 17 76 WEST 421NORTH	DETOUR LEFT ON COLLEGE																																																				
MESSAGE NO. 1	MESSAGE NO. 2																																																				
STARTING (DATE)	WB BRIDGE CLOSED																																																				
MESSAGE NO. 1	MESSAGE NO. 2																																																				
STARTING (DATE)	EB BRIDGE CLOSED																																																				

9/9/2023 U:\Traffic\Transportation Management\Plan\TCP\PLAN SHEETS\15BPR.102.3\_TMP\_05\_DETOUR\_SIGNS.dgn angood

<p>Stantec Consulting Services Inc. 801 Jones Franklin Road Suite 300 Raleigh, NC 27606 Tel. 919.851.6866 Fax. 919.851.7024 www.stantec.com License No. F-0672</p>	<p>DocuSigned by <i>J.W. Woollard</i> SEAL 19862 ENG/INEE J. W. WOOLLARD, P.E.</p> <p>9/11/2023</p> <p><b>DOCUMENT NOT CONSIDERED FINAL UNLESS ALL SIGNATURES COMPLETED</b></p>	<p>DIVISION OF HIGHWAYS STATE OF NORTH CAROLINA DEPARTMENT OF TRANSPORTATION WORK ZONE TRAFFIC CONTROL</p>	<p align="center"><b>DETOUR ROUTE SIGNS</b></p>
--	---	--	---

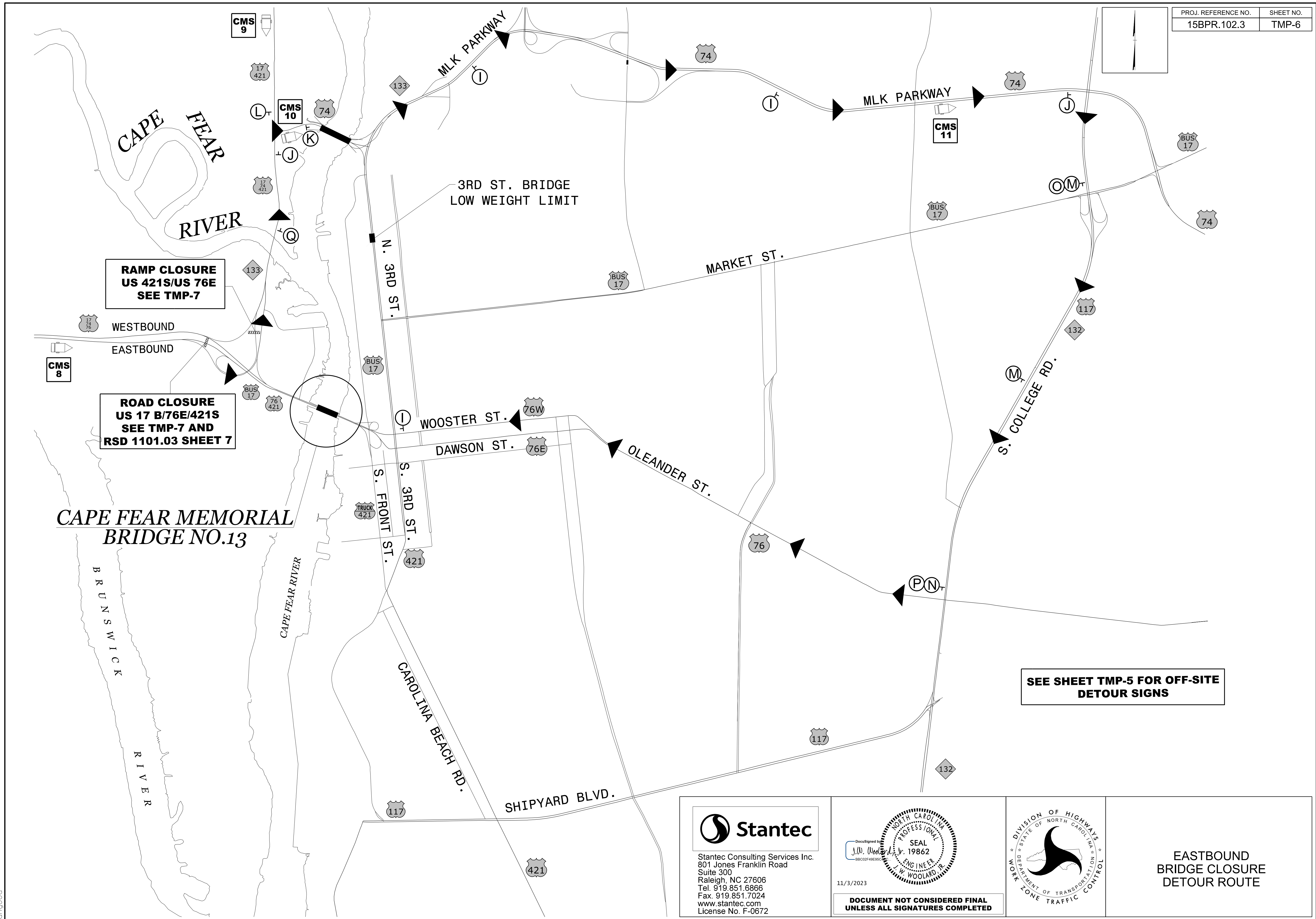

11/3/2023  
 U:\Traffic\Transportation Management Plan\TCP\PLAN SHEETS\15BPR.102.3\_TMP\_06.EAST\_DETOUR.dgn  
 angood

**Stantec**  
 Stantec Consulting Services Inc.  
 801 Jones Franklin Road  
 Suite 300  
 Raleigh, NC 27606  
 Tel. 919.851.6866  
 Fax. 919.851.7024  
 www.stantec.com  
 License No. F-0672

DocuSigned by  
 J.W. Woolard, Jr.  
 11/3/2023

SEAL  
 J.W. WOOLARD, JR.  
 19862  
 PROFESSIONAL ENGINEER  
 NORTH CAROLINA

**DOCUMENT NOT CONSIDERED FINAL UNLESS ALL SIGNATURES COMPLETED**

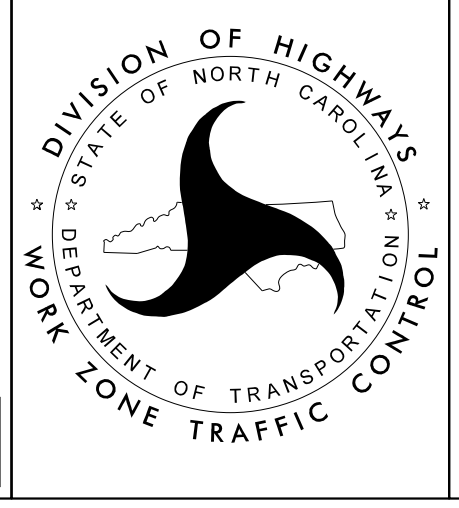

**EASTBOUND BRIDGE CLOSURE DETOUR ROUTE**



PROJ. REFERENCE NO.	SHEET NO.
15BPR.102.3	TMP-7

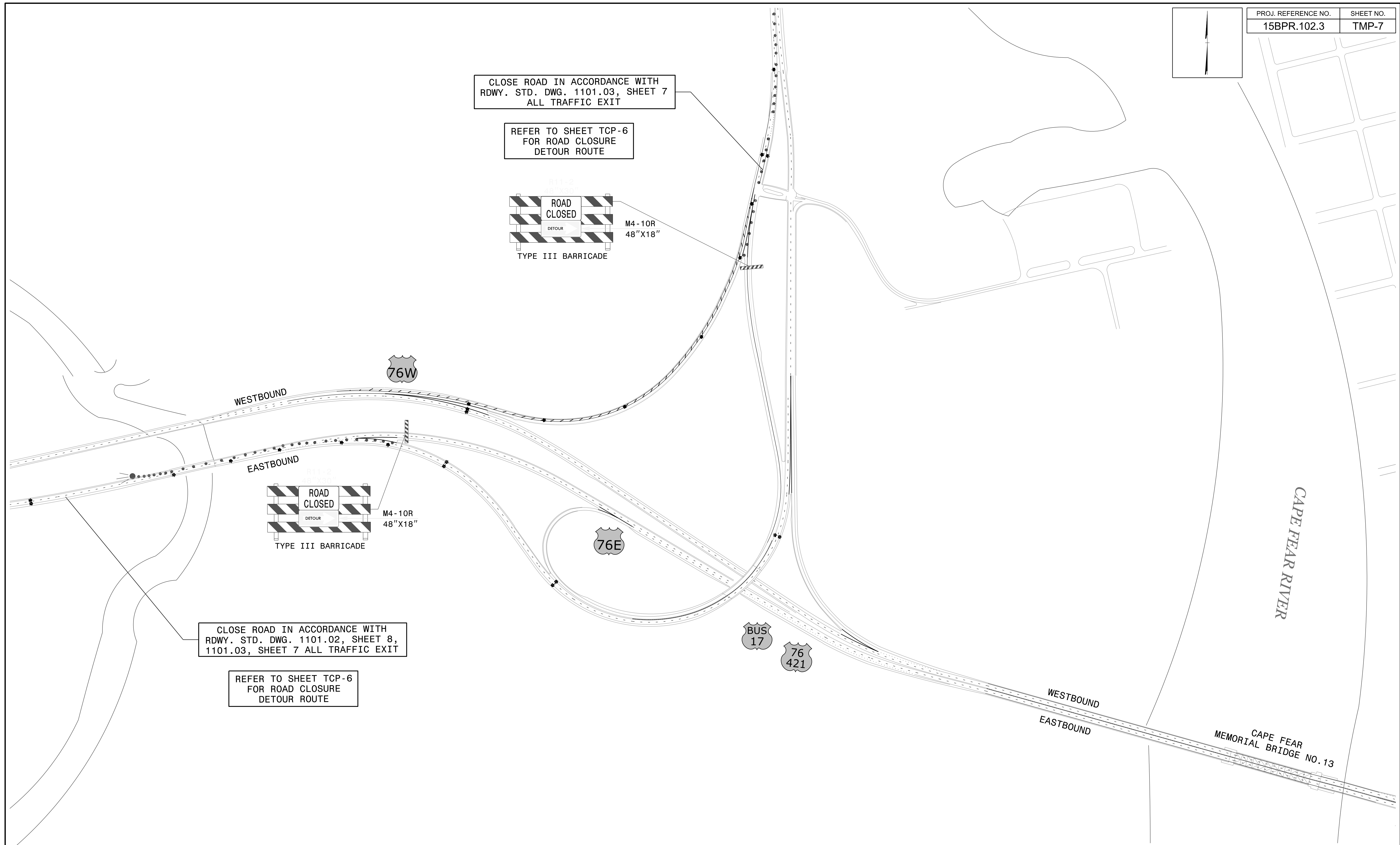
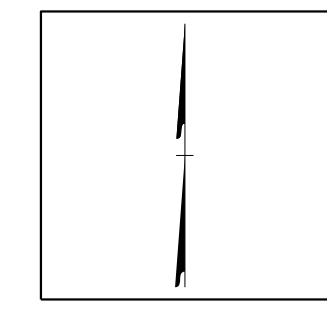

CLOSE ROAD IN ACCORDANCE WITH RDWY. STD. DWG. 1101.03, SHEET 7 ALL TRAFFIC EXIT

REFER TO SHEET TCP-6 FOR ROAD CLOSURE DETOUR ROUTE

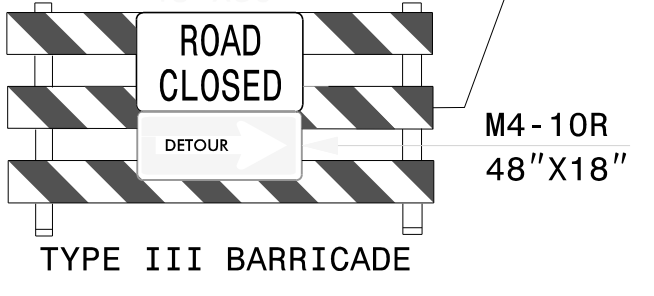
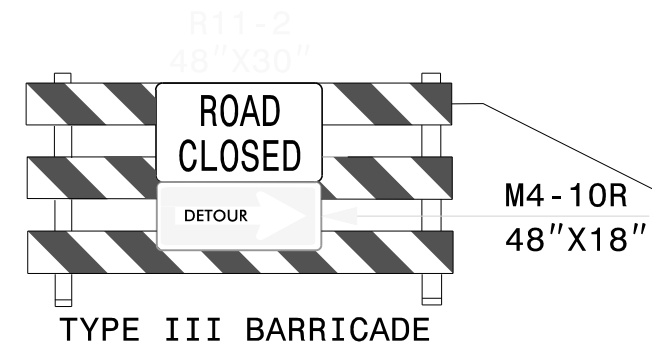

CLOSE ROAD IN ACCORDANCE WITH RDWY. STD. DWG. 1101.02, SHEET 8, 1101.03, SHEET 7 ALL TRAFFIC EXIT

REFER TO SHEET TCP-6 FOR ROAD CLOSURE DETOUR ROUTE

11/3/2023  
 U:\Traffic\Transportation Management\Plan\TCP\PLAN SHEETS\15BPR.102.3\_TMP\_07\_EAST\_CLOSURE\_DETAIL.dgn  
 angood

Stantec Consulting Services Inc.  
 801 Jones Franklin Road  
 Suite 300  
 Raleigh, NC 27606  
 Tel. 919.851.6866  
 Fax. 919.851.7024  
 www.stantec.com  
 License No. F-0672

11/3/2023  
 DOCUMENT NOT CONSIDERED FINAL  
 UNLESS ALL SIGNATURES COMPLETED

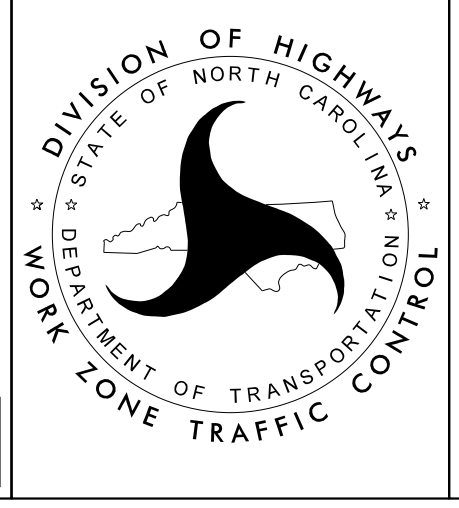

EASTBOUND  
 US 17 BUS/76 EAST/421 SOUTH  
 ROAD CLOSURE DETAIL

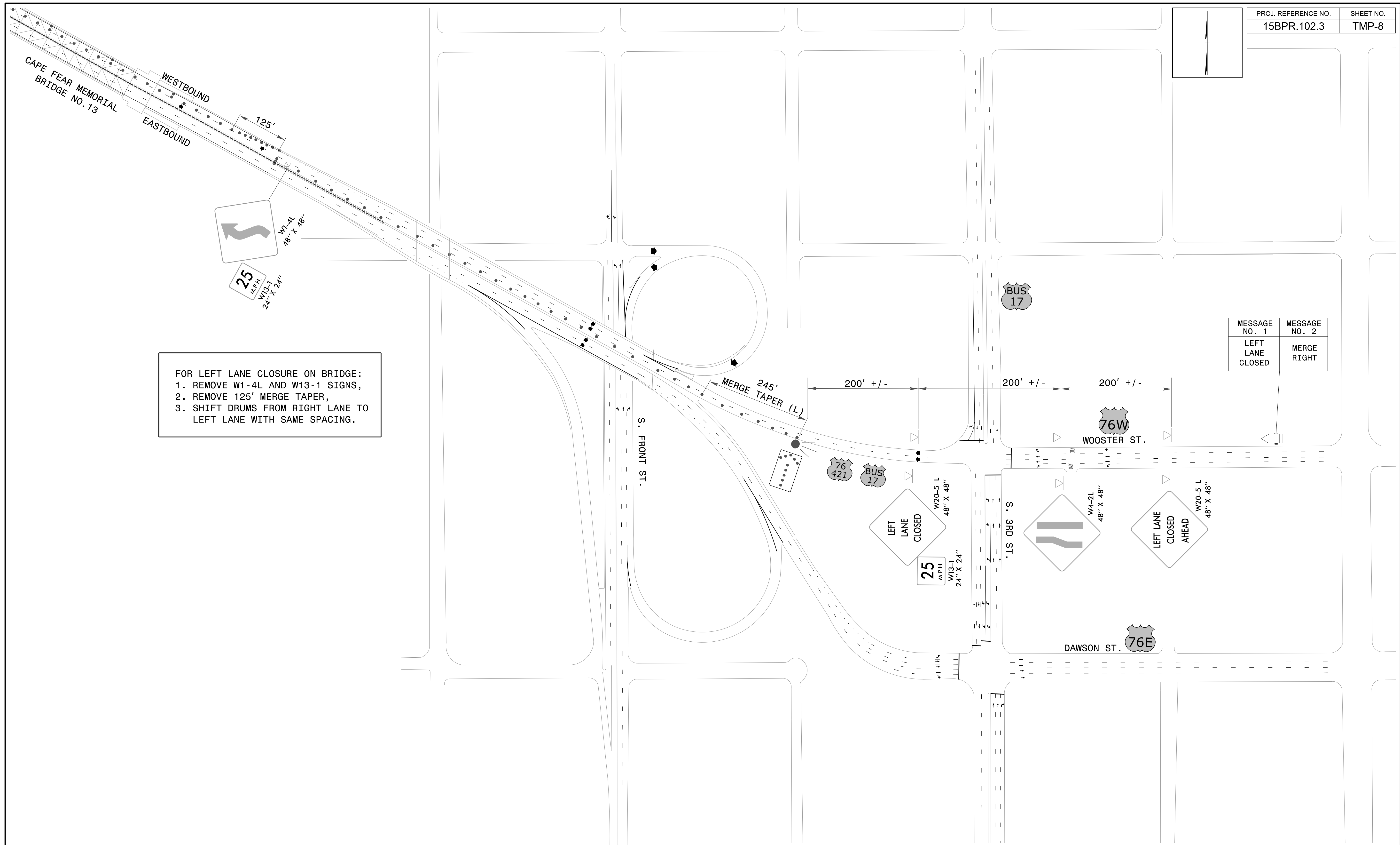
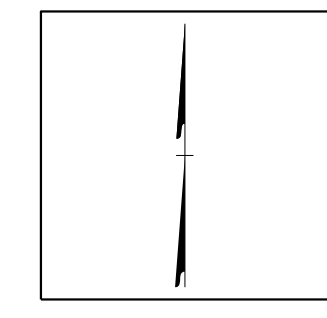

FOR LEFT LANE CLOSURE ON BRIDGE:  
 1. REMOVE W1-4L AND W13-1 SIGNS,  
 2. REMOVE 125' MERGE TAPER,  
 3. SHIFT DRUMS FROM RIGHT LANE TO LEFT LANE WITH SAME SPACING.

MESSAGE NO. 1	MESSAGE NO. 2
LEFT LANE CLOSED	MERGE RIGHT

11/3/2023  
 U:\Traffic\Transportation Management\Plan\TCP\PLAN SHEETS\15BPR.102.3\_TMP\_08\_WESTBOUND\_LANE\_CLOSURE\_DETAIL.dgn  
 angood

Stantec Consulting Services Inc.  
 801 Jones Franklin Road  
 Suite 300  
 Raleigh, NC 27606  
 Tel. 919.851.6866  
 Fax. 919.851.7024  
 www.stantec.com  
 License No. F-0672

Documented by  
 J.W. Woolard, Jr.  
 19862  
 ENGINEER  
 W. WOOLARD, JR.  
 11/3/2023  
**DOCUMENT NOT CONSIDERED FINAL  
 UNLESS ALL SIGNATURES COMPLETED**

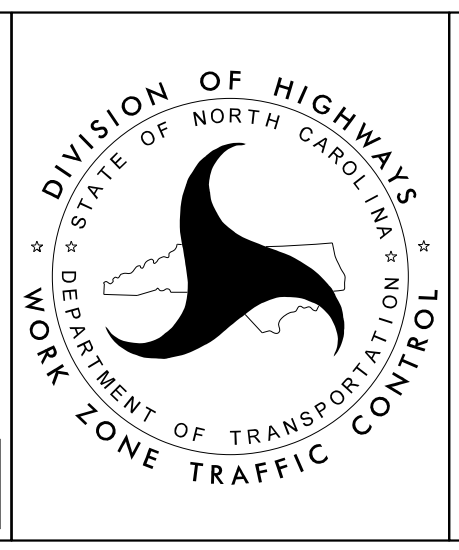

**WESTBOUND  
 LANE CLOSURE DETAIL**



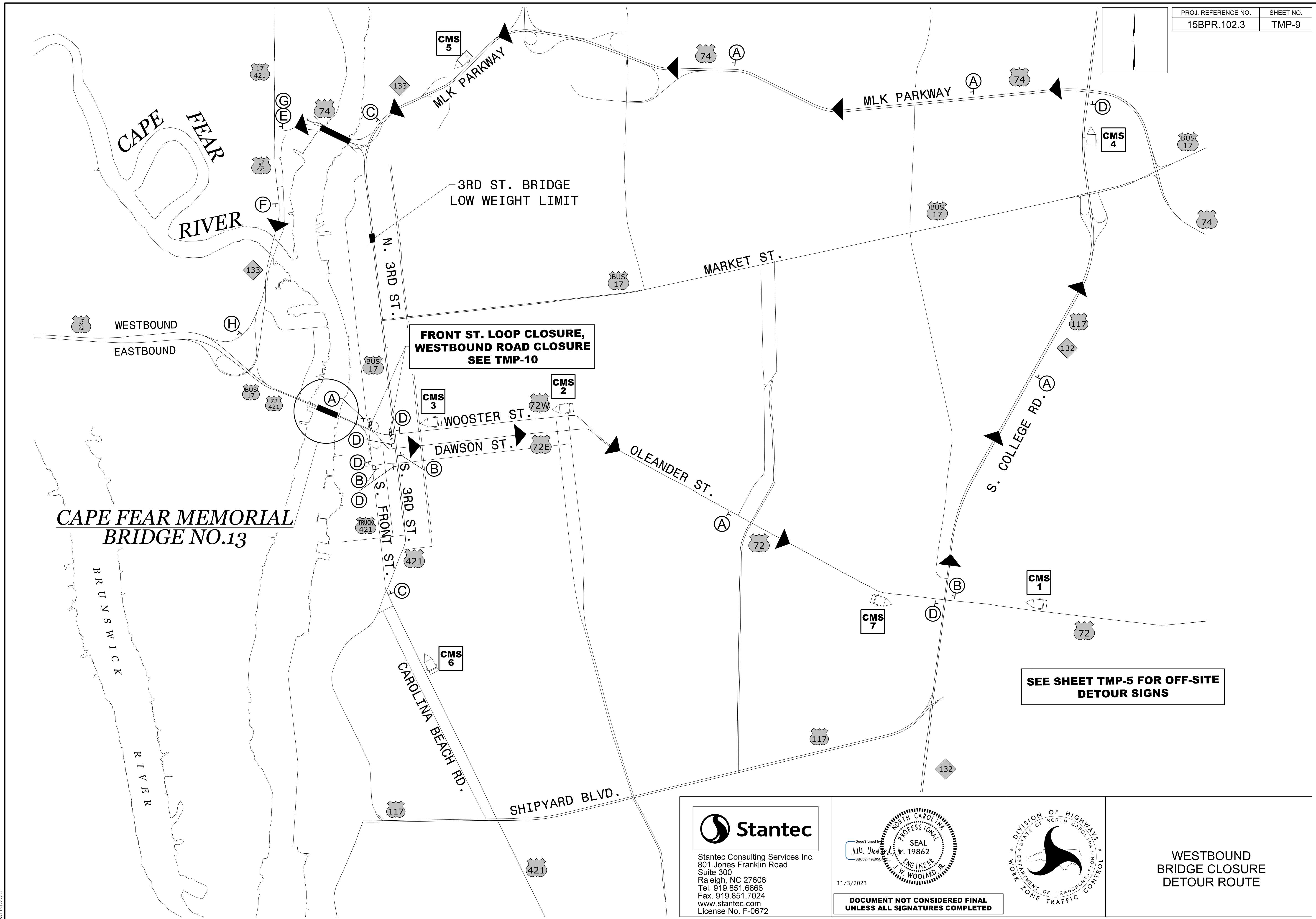

11/3/2023  
 U:\Traffic\Transportation Management Plan\TCP\PLAN SHEETS\15BPR.102.3\_TMP\_09\_WEST\_DETOUR.dgn  
 angood

**CAPE FEAR MEMORIAL  
BRIDGE NO.13**

**Stantec**  
 Stantec Consulting Services Inc.  
 801 Jones Franklin Road  
 Suite 300  
 Raleigh, NC 27606  
 Tel. 919.851.6866  
 Fax. 919.851.7024  
 www.stantec.com  
 License No. F-0672

DocuSigned by  
 J.W. Woolard, Jr.  
 11/3/2023

**SEAL**  
 J.W. WOOLARD, JR.  
 19862  
 ENGINEER

**DOCUMENT NOT CONSIDERED FINAL  
UNLESS ALL SIGNATURES COMPLETED**

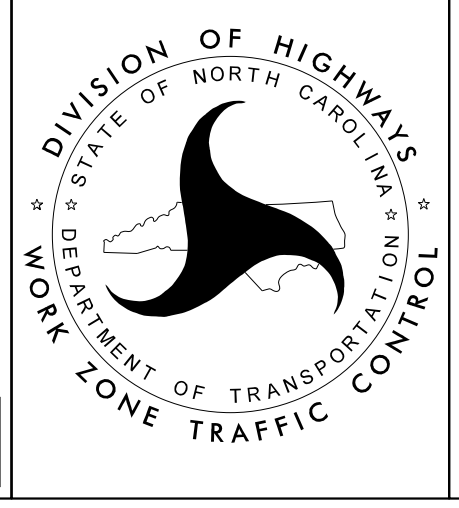

**WESTBOUND  
BRIDGE CLOSURE  
DETOUR ROUTE**

OPTIONAL SIGN  
PLACE AS DIRECTED  
BY ENGINEER

MESSAGE NO. 1	MESSAGE NO. 2
US 17 76 WEST 421NORTH	DETOUR LEFT ON WRIGHT

CLOSE  
LEFT TURN LANE  
USING DRUMS

CLOSE  
EXIT AREA  
USING DRUMS

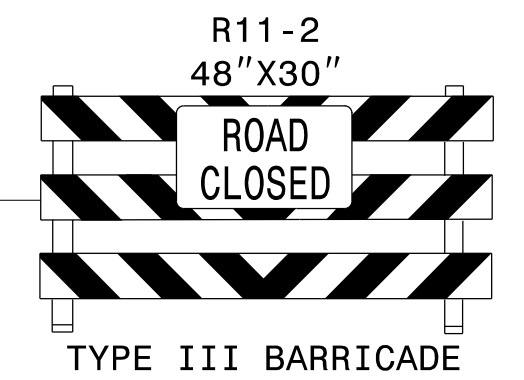
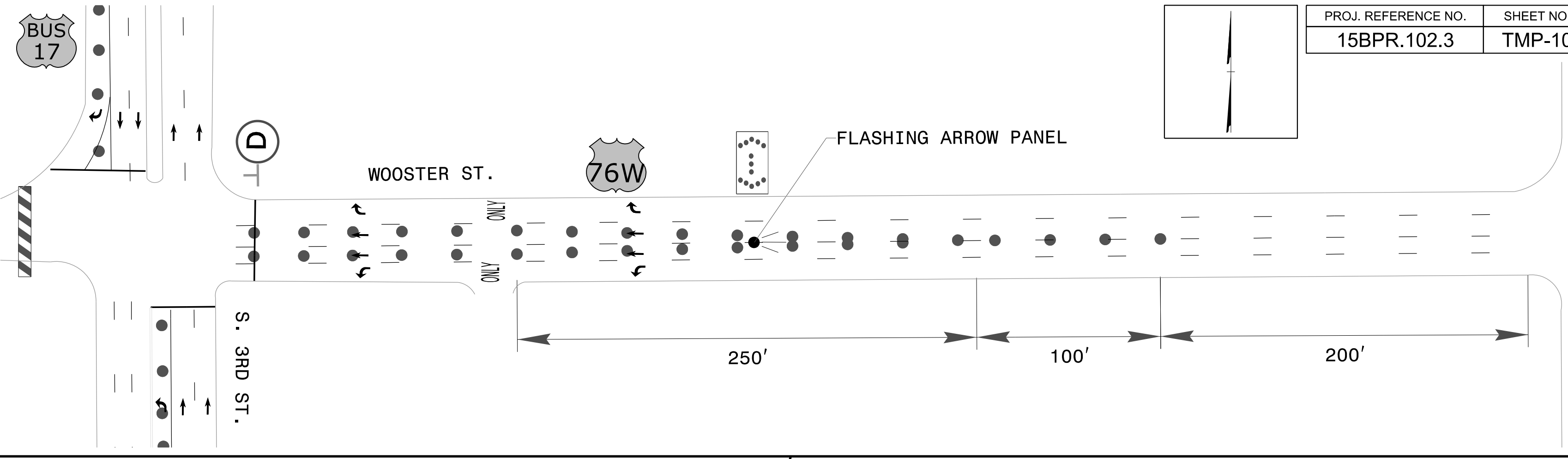
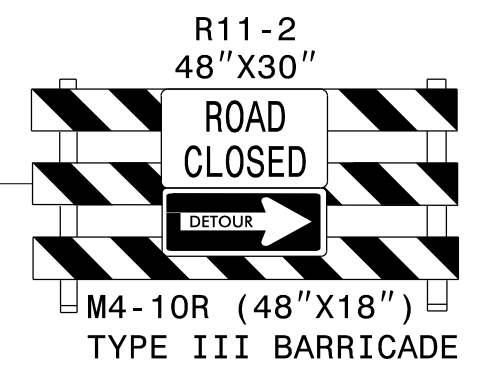

CLOSE  
RIGHT TURN LANE  
USING DRUMS

PROVIDE  
LAW ENFORCEMENT  
AT INTERSECTION

CLOSE  
LEFT TURN LANE  
USING DRUMS

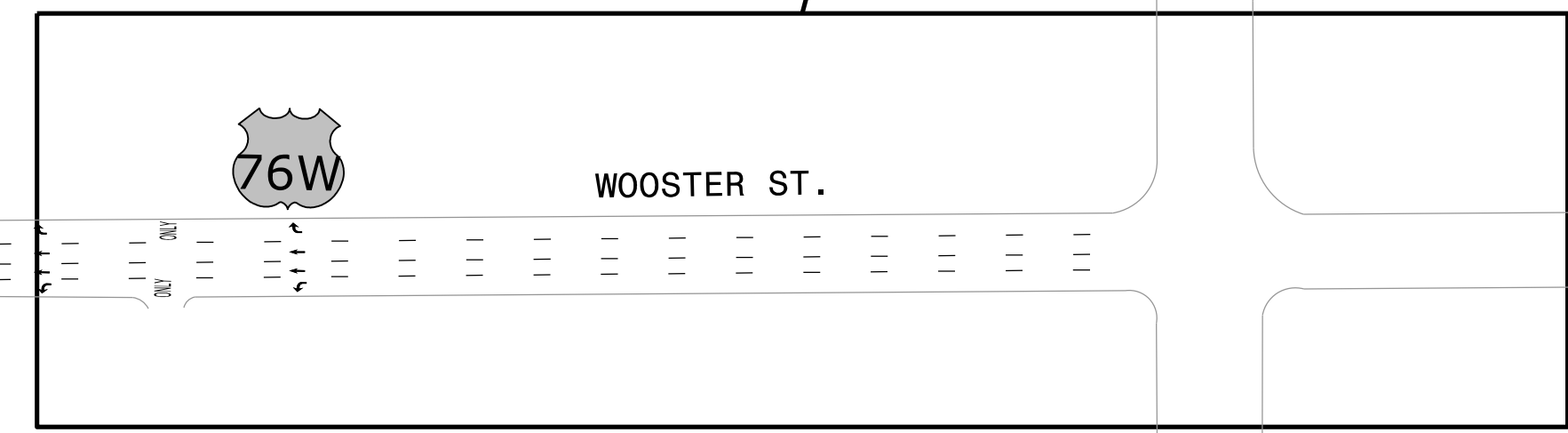

SEE SHEET TMP-5 FOR OFF-SITE  
DETOUR SIGNS

WESTBOUND  
EASTBOUND

(A)

(D)

(D)

(D)

(D)

(B)

(D)

(B)

(D)

CMS  
5

**Stantec**  
Stantec Consulting Services Inc.  
801 Jones Franklin Road  
Suite 300  
Raleigh, NC 27606  
Tel. 919.851.6866  
Fax. 919.851.7024  
www.stantec.com  
License No. F-0672

DocuSigned by  
J.W. Woolard, Jr. 19862  
11/3/2023  
SEAL  
PROFESSOR  
19862  
W. WOOLARD, JR.  
ENGINEER

**DOCUMENT NOT CONSIDERED FINAL  
UNLESS ALL SIGNATURES COMPLETED**

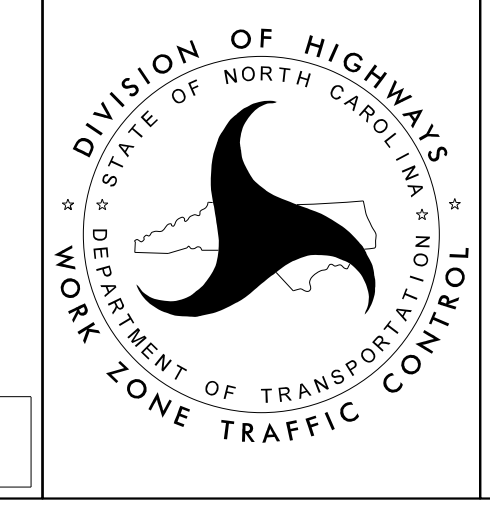

WESTBOUND  
US 17/76 WEST/421 NORTH  
ROAD CLOSURE DETAIL

11/3/2023  
U:\Traffic\Transportation Management\Plan\TCP\PLAN SHEETS\15BPR.102.3\_TMP.10.WEST\_CLOSURE\_DETAIL.dgn  
angood