

6/2/2021

RIGHT OF WAY CONTROL SHEET

PROJECT REFERENCE NO. SHEET NO.
I-5972 RW03E-1

Location and Surveys

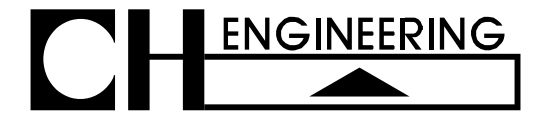

3220 GLEN ROYAL RD. RALEIGH, NC 27617
TEL. (919) 788-0224 FAX (919) 788-0232
CORPORATE LICENSE # P-0189

PROJECT SURVEYOR

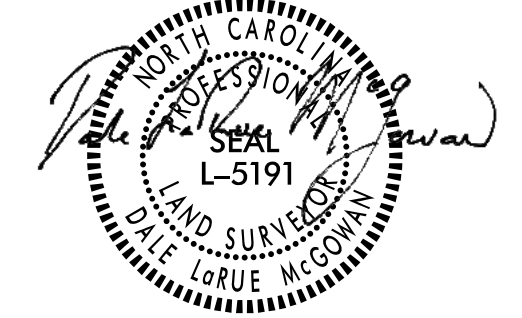

DOCUMENT NOT CONSIDERED FINAL
UNLESS ALL SIGNATURES COMPLETED

ROW MARKER IRON PIN AND CAP-E

ALIGN	STATION	OFFSET	NORTH	EAST
RPC	14+60.00	-59.15	638479.0861	2200813.2797
RPC	16+20.00	-72.49	638597.8974	2200914.1815

ROW MARKER IRON PIN AND CAP-E

ALIGN	STATION	OFFSET	NORTH	EAST
RPD	13+55.00	55.86	638312.5577	2201030.4301
RPD	15+30.00	70.18	638341.5854	2201194.1536
RPD	15+30.00	100.00	638312.2930	2201199.7428
RPD	15+80.00	100.00	638319.9429	2201244.9298
RPD	15+80.00	69.81	638349.8046	2201240.5122
RPD	16+30.00	67.48	638358.0435	2201286.9814
RPD	21+75.00	58.35	638333.6321	2201819.1535
RPD	24+55.00	65.00	638360.9066	2202117.7167
RPD	26+90.00	75.00	638459.0945	2202352.8781
RPD	28+45.00	125.00	638529.5571	2202519.6812
RPD	28+45.00	75.00	638565.2787	2202484.6960
RPD	28+90.00	140.00	638556.8801	2202566.8922
RPD	29+40.00	150.00	638595.2261	2202612.9002
RPD	29+75.00	140.00	638634.0979	2202630.1619

ROW MARKER IRON PIN AND CAP-E

ALIGN	STATION	OFFSET	NORTH	EAST
Y1	44+40.00	105.00	638690.2110	2202686.3589
Y1	44+90.00	-177.35	638931.8063	2202840.8749
Y1	44+95.00	110.00	638664.8032	2202734.5529
Y1	46+00.00	-116.10	638831.5155	2202919.9120
Y1	46+50.00	90.00	638622.6542	2202883.0228
Y1	51+50.52	90.00	638408.3327	2203328.9246
Y1	54+45.00	90.00	638272.4197	2203590.1650
Y1	56+50.01	47.63	638215.8009	2203792.8294

ROW MARKER IRON PIN AND CAP-E

ALIGN	STATION	OFFSET	NORTH	EAST
Y2	11+10.00	-40.00	637429.5434	2201886.1950
Y2	11+48.00	40.00	637349.7104	2201924.5447
Y2	16+55.00	-40.00	637431.9285	2202431.1897
Y2	16+55.00	-75.00	637466.9282	2202431.0366
Y2	16+85.00	75.00	637317.0609	2202461.6927
Y2	16+85.00	40.00	637352.0606	2202461.5396
Y2	17+50.00	-40.00	637432.3443	2202526.1888
Y2	17+50.00	-75.00	637467.3440	2202526.0356
Y2	17+90.00	40.00	637352.5201	2202566.5386
Y2	17+90.00	75.00	637317.5205	2202566.6917
Y2	18+69.27	-40.00	637432.8663	2202645.4623
Y2	18+69.27	40.00	637352.8671	2202645.8124
Y2	29+89.11	-40.00	637978.2477	2203507.1125
Y2	29+89.11	40.00	637943.6969	2203579.2668
Y2	32+35.00	-40.00	638200.0203	2203613.3074
Y2	32+50.00	40.00	638178.9985	2203691.9399

ROW MARKER IRON PIN AND CAP-E

ALIGN	STATION	OFFSET	NORTH	EAST
Y3	24+14.60	-118.34	638298.1495	2201574.2930
Y3	24+20.58	87.68	638283.2615	2201779.8624
Y3	16+30.00	30.06	637510.8767	2201790.8425
Y3	13+65.15	30.06	637248.2372	2201824.9878

REVISIONS

I, DALE LaRUE McGOWAN, a Professional Land Surveyor in the state of North Carolina hereby certify to the best of my knowledge and belief that the following work item(s) (R/W Staking) performed under my responsible charge meet NCDOT Survey Standards as directed in the NCDOT Location & Surveys guidelines and procedures.

I further certify that the right of way and permanent easement points shown herein and outlined in the tables shown hereon (localized coordinates, station/offset) have been checked and are accurate representations of the right of way and permanent easement points depicted on the corresponding highway plans. I also certify that the right of way and permanent easement points shown herein have been field monumented under my supervision from existing survey control provided by others; that the depicted property data shown herein were surveyed by others; and these monuments denote the right of way and easement boundaries at the time of staking which may be subject to change due to right of way revisions (See deeds for final determination).

Witness my original signature, registration number and seal this 9th day of June, 2021.

Dale LaRue McGowan

Professional Land Surveyor

L-5191
PLS #

Seal

NOTES:

- IF FURTHER INFORMATION REGARDING PROJECT CONTROL IS NEEDED PLEASE CONTACT THE LOCATION AND SURVEYS UNIT.
- PROJECT CONTROL WAS ESTABLISHED USING GNSS, THE GLOBAL NAVIGATION SATELLITE SYSTEM.