

09/27/21

STATE	STATE PROJECT REFERENCE NO.	SHEET NO.	TOTAL SHEETS
N.C.	U-6003	RW1	8

STATE OF NORTH CAROLINA
 DIVISION OF HIGHWAYS

SURVEY CONTROL, EXISTING CENTERLINES,
 RIGHT OF WAY, EASEMENTS AND PROPERTY TIES

FORSYTH COUNTY

LOCATION: **KERNERSVILLE - KERNERSVILLE LOOP**
FROM EAST OF SR 1969 (PINEY GROVE RD) TO NC150
(NORTH MAIN ST)

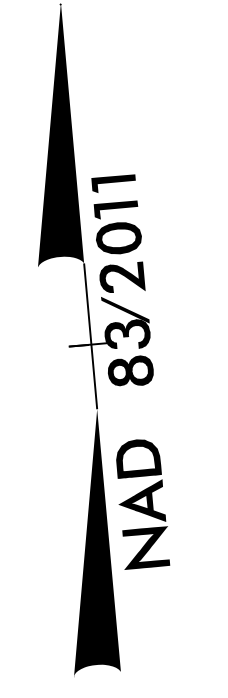

TIP PROJECT: U-6003

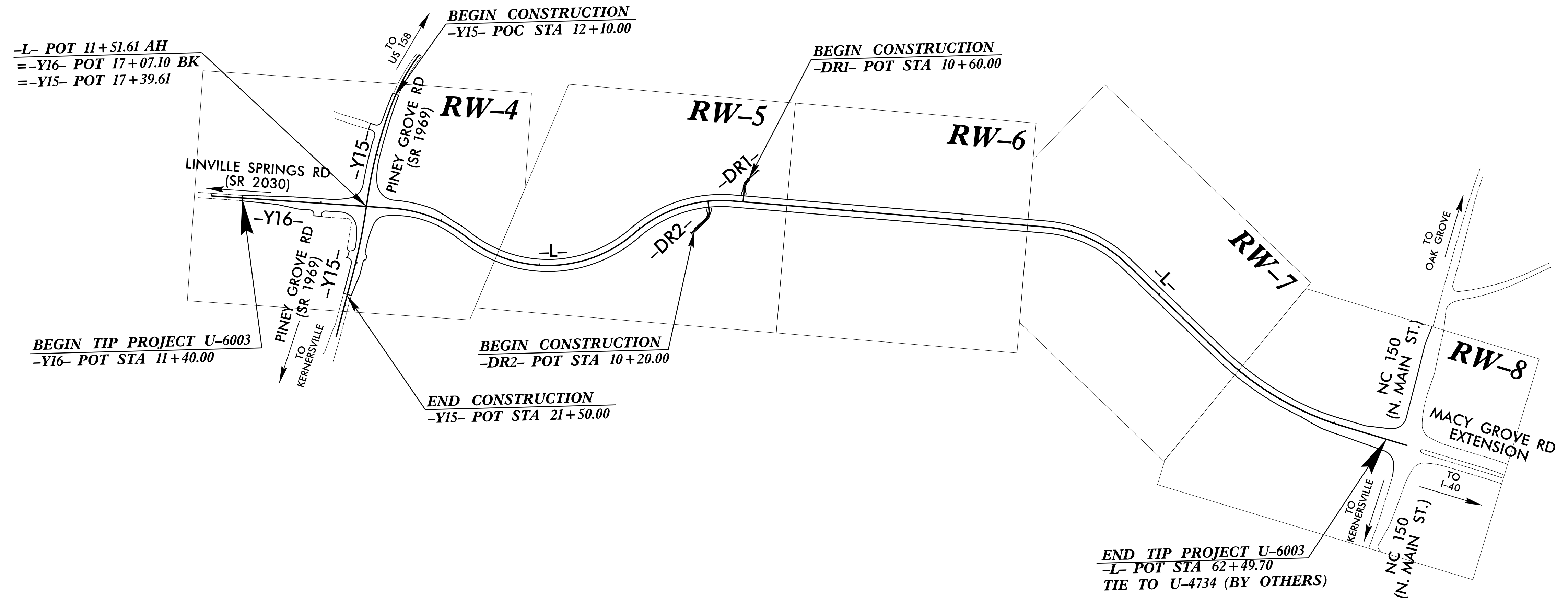

GRAPHIC SCALE

PLANS

RW1 NOT TO SCALE

DATUM DESCRIPTION

THE LOCALIZED COORDINATE SYSTEM DEVELOPED FOR THIS PROJECT IS BASED ON THE STATE PLANE COORDINATES ESTABLISHED BY NCDOT FOR MONUMENT "U4734-1" WITH NAD 83/NSRS 2011 STATE PLANE GRID COORDINATES OF NORTHING: 865552.146 (ft) EASTING: 1691621.319 (ft) ELEVATION: 956.93 (ft)

THE AVERAGE COMBINED GRID FACTOR USED ON THIS PROJECT (GROUND TO GRID) IS: 0.999947655

THE N.C. LAMBERT GRID BEARING AND LOCALIZED HORIZONTAL GROUND DISTANCE FROM "U4734-1" TO -L- STATION 11+51.61 IS N 53° 26' 16.97" W, 9,219.025 (ft)

ALL LINEAR DIMENSIONS ARE LOCALIZED HORIZONTAL DISTANCES VERTICAL DATUM USED IS NAVD 88

Prepared in the Office of:
DIVISION OF HIGHWAYS
 NINTH DIVISION DESIGN\CONSTRUCT
 375 SILAS CREEK PARKWAY WINSTON-SALEM, N.C. 27127

2018 STANDARD SPECIFICATIONS

RIGHT OF WAY DATE:
 NOVEMBER 30, 2018

LETTING DATE:
 NOVEMBER 21, 2023

PROFESSIONAL LAND SURVEYOR

DocuSigned by:
 Jeremy Keaton
 17372596384356

10/17/2023

SIGNATURE:

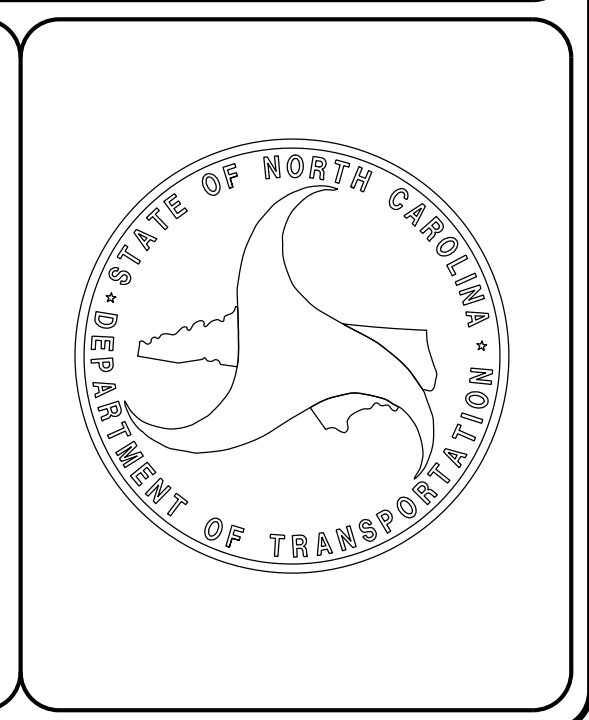

10-AUG-2023 10:56 SA:\Project_Development\TIP_Projects_U-U-6003-KvilleLoop\Surveys\ControlSheets\U-6003-ddc_CTL_tsh.dgn \$\$\$USERNAME\$\$\$