

TIP NO. U-5824	SHEET NO. PMP-2
APPROVED: <i>Faith E. Johnke</i>	
DATE: 9/15/2023	
SEAL	
Prepared in the Office of:	
	<small>NC FIRM LICENSE No. P-0339 320 Executive Ct. Wilmington, NC 28403 (919) 732-3883 (919) 732-8676 (FAX)</small>

**CURB RAMP LOCATIONS
(BACK OF CURB REFERENCE POINT)**

- 1 -Y1- STA. 11+90.86, 22.98' RT (STANDARD)
- 2 -L- STA. 13+54.64, 44.12' LT (STANDARD)
- 3 -L- STA. 13+34.39, 44.35' RT (STANDARD)
- 4 -L- STA. 13+48.10, 60.32' RT (STANDARD)
- 5 -L- STA. 14+03.34, 66.03' RT (STANDARD)
- 6 -L- STA. 14+19.09, 54.94' RT (STANDARD)
- 7 -Y1- STA. 11+79.12, 37.67' LT (STANDARD)
- 8 -L- STA. 16+40.58, 52.89' RT (STANDARD)
- 9 -L- STA. 16+97.03, 51.31' RT (STANDARD)

BIKE LANES ARE 4' WIDE UNLESS DIMENSIONED OTHERWISE

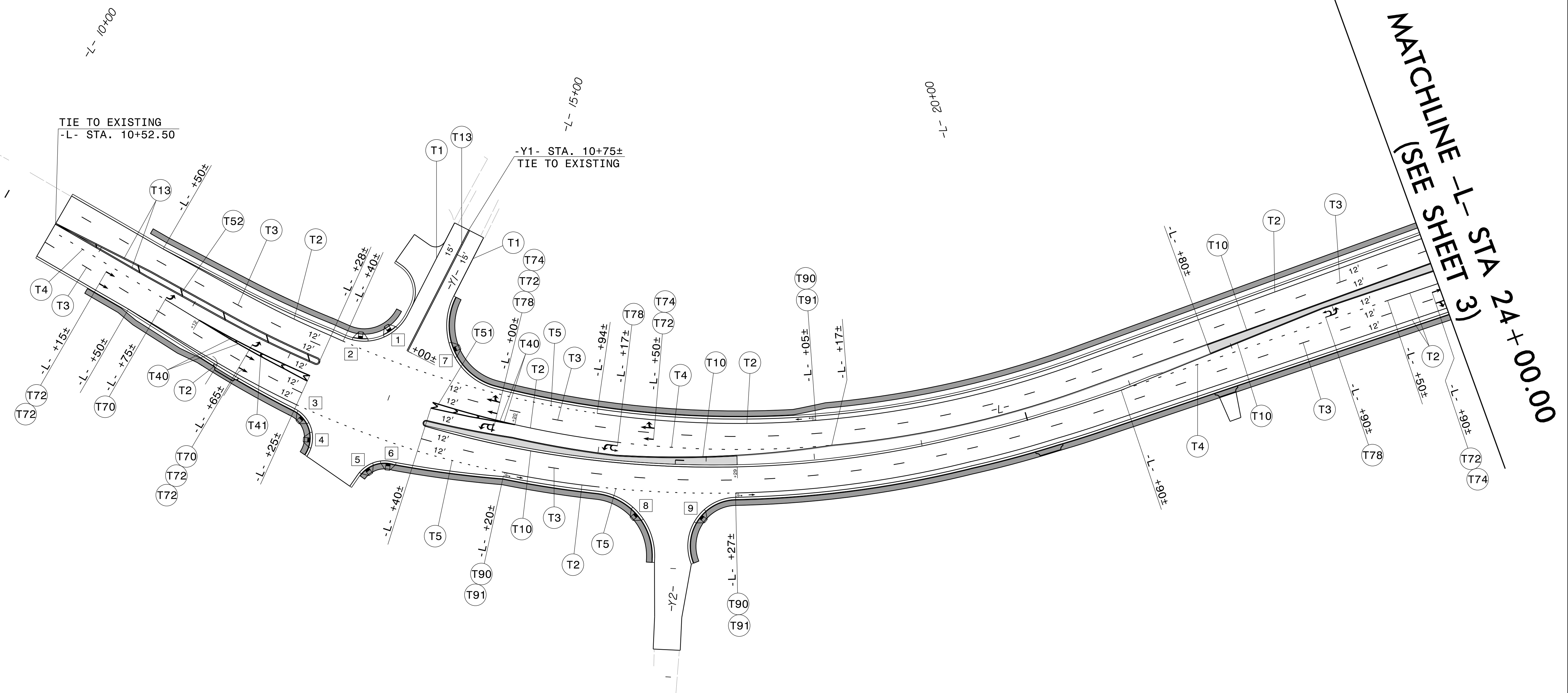

MATCHLINE (SEE SHEET 3)
-L- STA 24+00.00

REVISIONS

10-AUG-2023 18:32
 U5824_PMP-2.dgn
 Faith Johnke