

NOTES

1. INSTALL ANTENNA CABLE:
ON PERMANENT METAL STRAIN POLES, RUN ANTENNA CABLE UP THROUGH THE POLE AND OUT THE WEATHERHEAD AND ROUTE THE ANTENNA CABLE TO THE ANTENNA.
2. MAINTAIN PROPER CLEARANCE FROM ALL UTILITIES PER THE NATIONAL ELECTRICAL SAFETY CODE.
3. RELOCATE AND REATTACH ANTENNA AT THE SAME ATTACHMENT HEIGHT. FIELD ADJUST AS NECESSARY TO ENSURE FULLY FUNCTIONING COMMUNICATIONS.
4. REFERENCE "WIRELESS RADIO ANTENNA TYPICAL DETAILS."

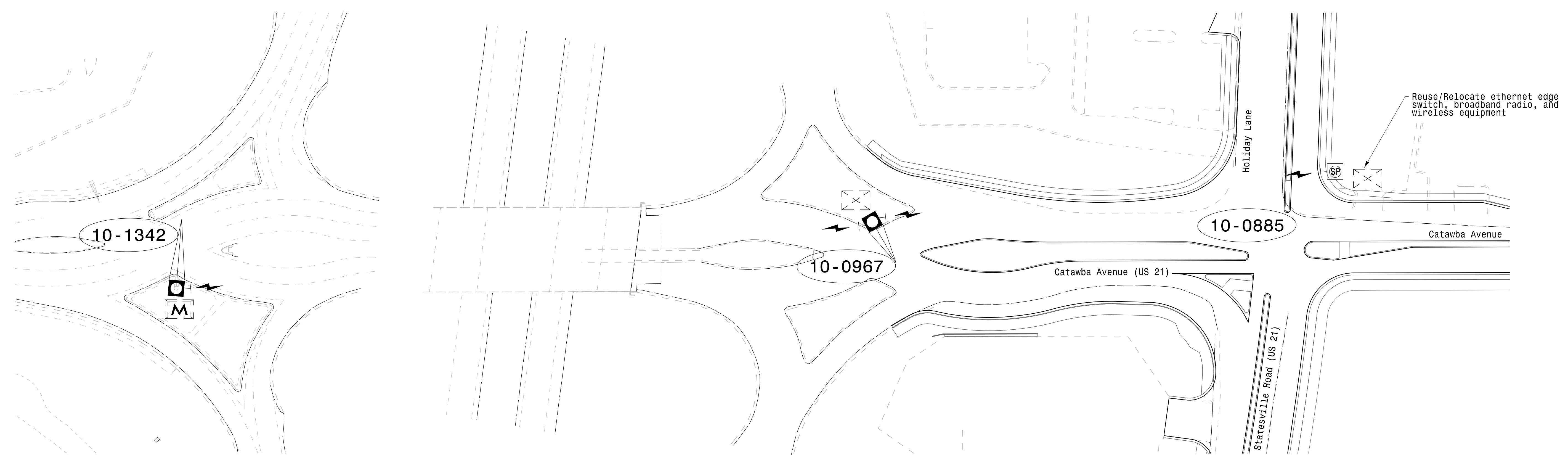

LEGEND

- FLAT PANEL ANTENNA
- SIGNAL INVENTORY NUMBER
- EXISTING CONTROLLER AND CABINET
- MASTER RADIO LOCATION
- NEW CONTROLLER AND CABINET
- NEW METAL POLE
- NEW WOOD POLE
- SIGNAL POLE
- EXISTING METAL POLE WITH MAST ARM

This plan supersedes the wireless communication plan signed and sealed by Steven G. Haynie, PE on 05/31/2022.

Final Configuration

DOCUMENT NOT CONSIDERED FINAL UNLESS ALL SIGNATURES COMPLETED

		Prepared for the Office of: Catawba Avenue at US 21 (Statesville Road) Wireless Communications Plans		SEAL 	
Division 10 Mecklenburg County Cornelius		PLAN DATE: February 2023 REVIEWED BY: S. Haynie		PREPARED BY: P. Koloski REVIEWED BY:	
REVISIONS	INIT.	DATE			
			Steven G. Haynie 2/21/2023 SIGNATURE DATE		

CADD Filename: C-5621scp02.dgn

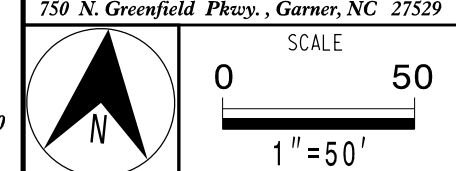

21-Feb-23 13:28:47
 C:\Users\jtc\OneDrive\Design\Plan_Sheets\C-5621scp02.dgn