

PROJECT REFERENCE NO.	SHEET NO.
U-5312	EC-24/CONST.15
RW SHEET NO.	
ROADWAY DESIGN ENGINEER	HYDRAULICS ENGINEER

FINAL GRADING
EROSION CONTROL FOR
CONSTRUCTION SHEET 15

NOTE:
UTILIZE FABRIC INSERT INLET PROTECTION DEVICES IN LIEU OF
ROCK INLET SEDIMENT TRAPS, TYPE-C AS DIRECTED TO AVOID
IMPOUNDMENT OF RUNOFF IN ROADWAY OPEN TO TRAFFIC.

NAD 83/NSRS 2007

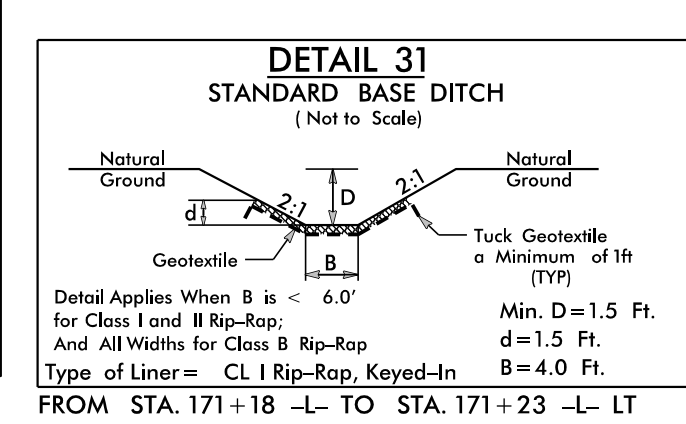
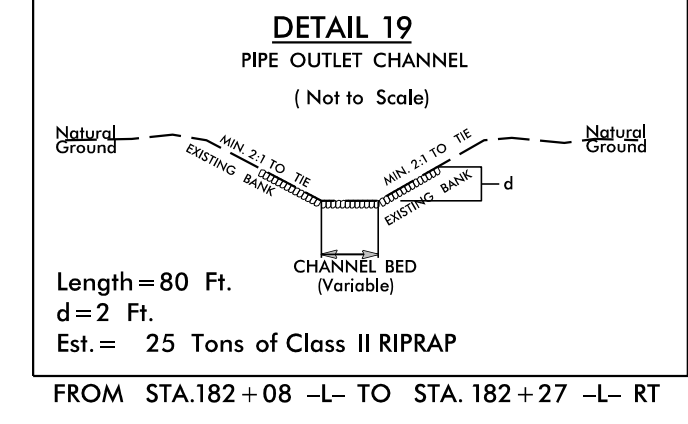
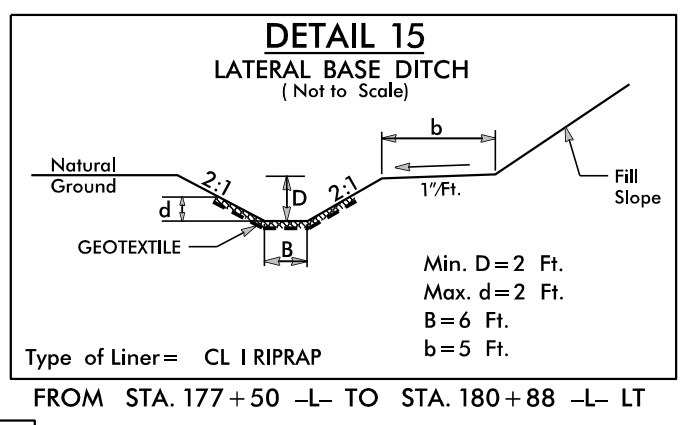
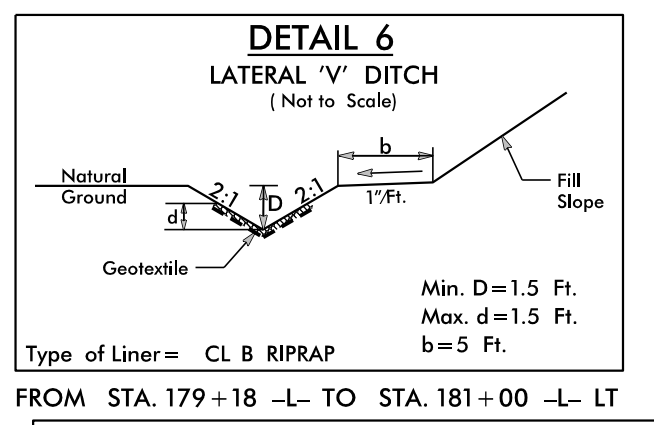
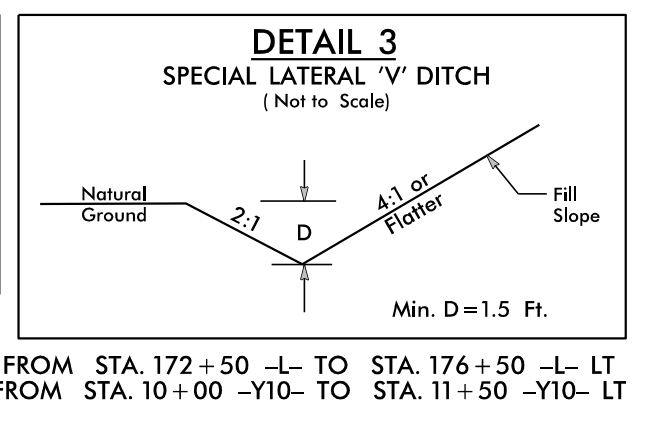
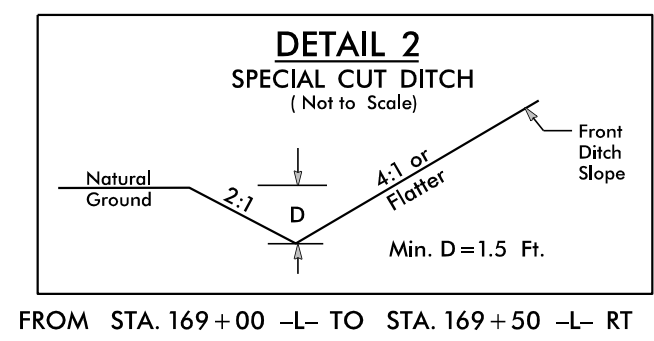
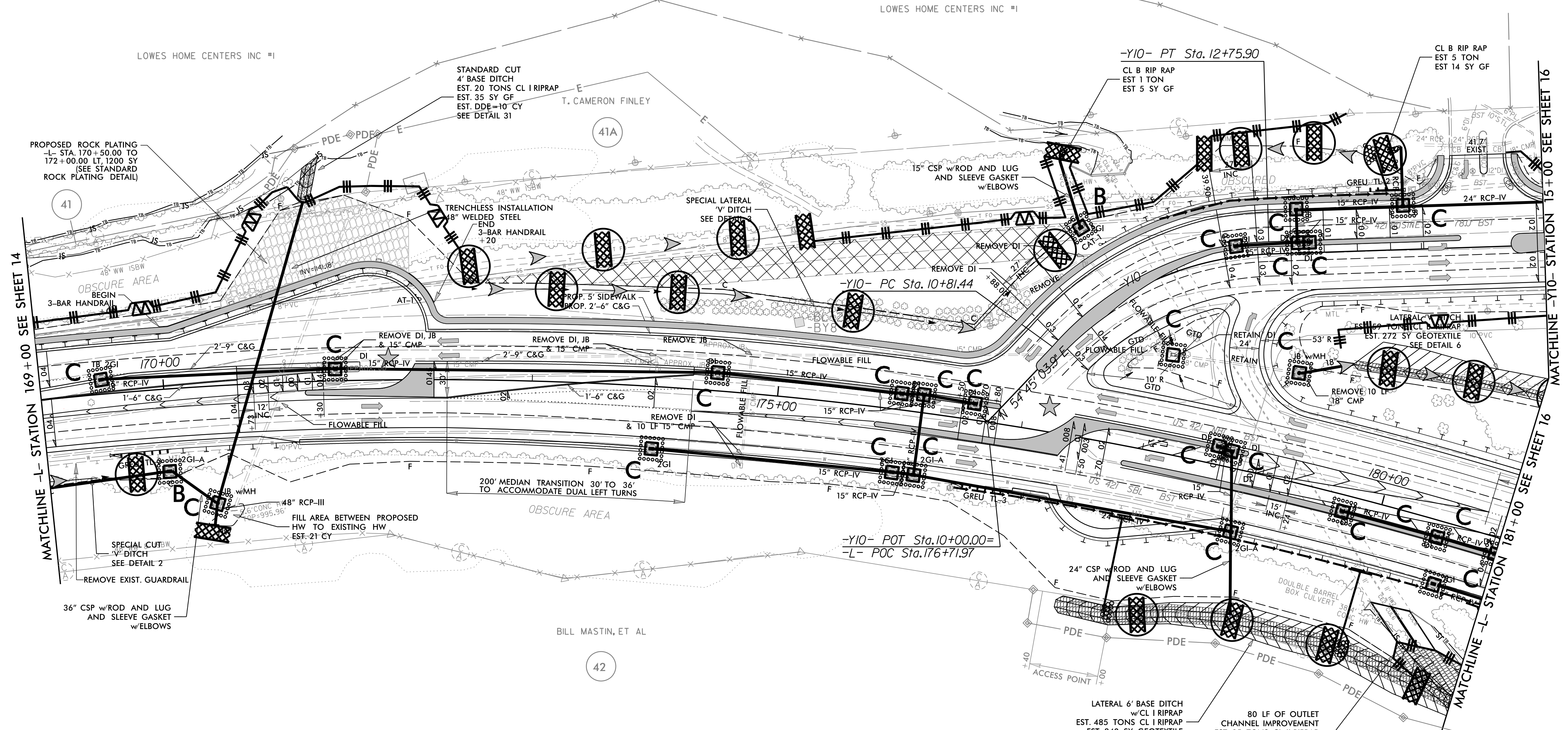

Place Matting for Erosion Control
on Slope as Work Allows.
Sta. 176+50 to Sta. 181+00 -L- RT

FOR -L- & -Y10- PROFILES SEE SHEETS 22 & 24
FOR INTERSECTION AND U-TURN BULB DETAILS SEE SHEETS 2B-14 & 2B-15

★ DENOTES PROPOSED SIGNALIZED INTERSECTION