

PROJECT REFERENCE NO. U-5312	SHEET NO. EC-22/CONST 13
RW SHEET NO.	
ROADWAY DESIGN ENGINEER	HYDRAULICS ENGINEER

FINAL GRADING  
EROSION CONTROL FOR  
CONSTRUCTION SHEET 13

NOTE:  
UTILIZE FABRIC INSERT INLET PROTECTION DEVICES IN LIEU OF  
ROCK INLET SEDIMENT TRAPS, TYPE-C AS DIRECTED TO AVOID  
IMPOUNDMENT OF RUNOFF IN ROADWAY OPEN TO TRAFFIC.

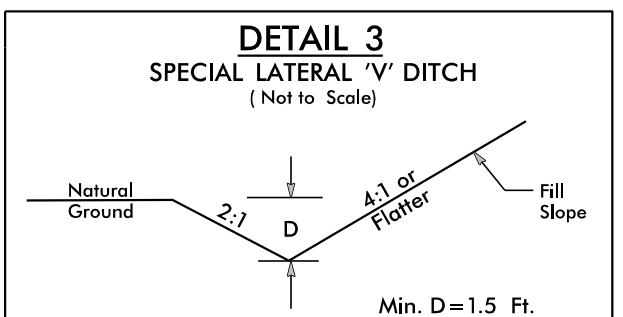
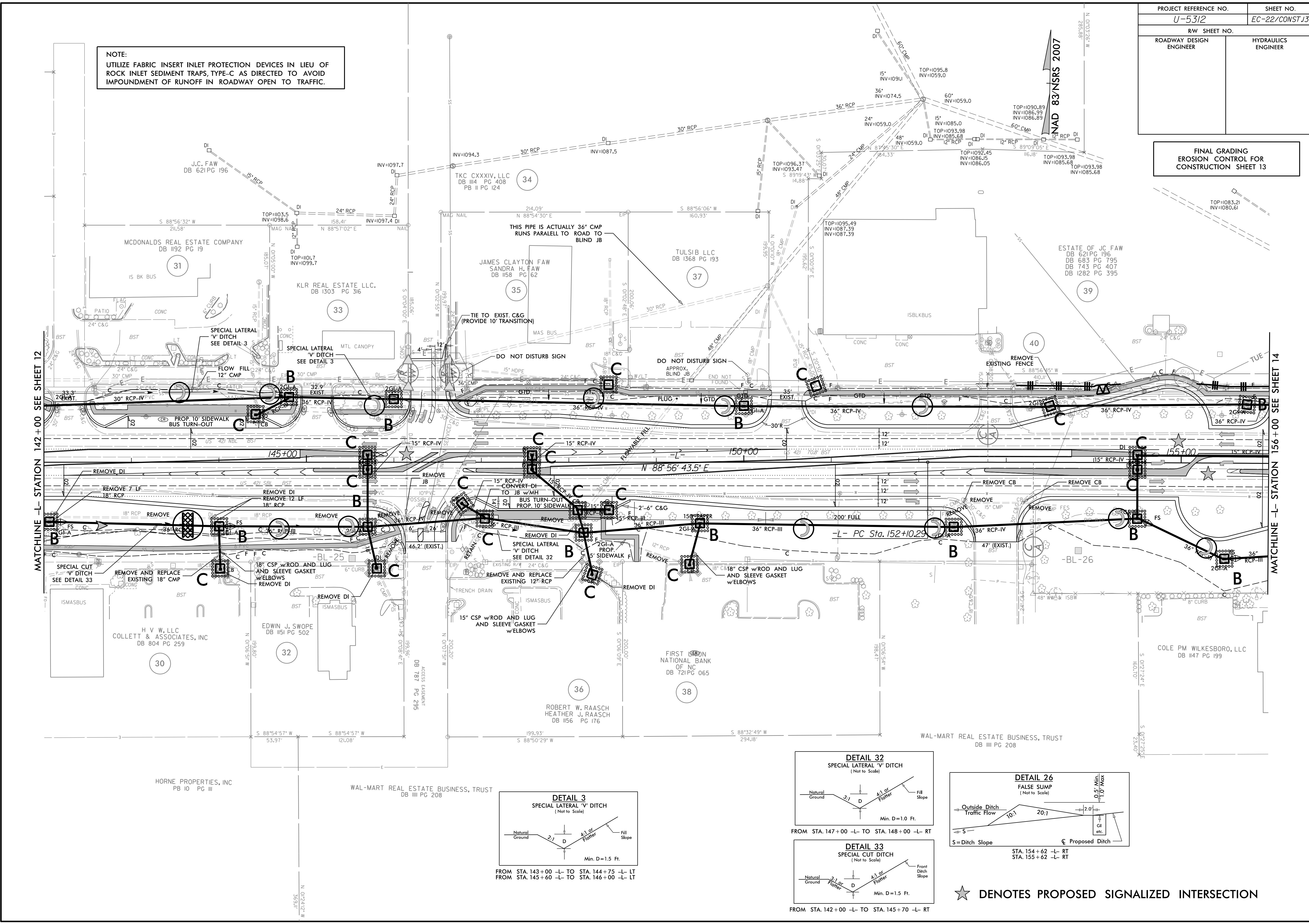

FROM STA. 143+00 -L- TO STA. 144+75 -L- LT  
FROM STA. 145+60 -L- TO STA. 146+00 -L- LT

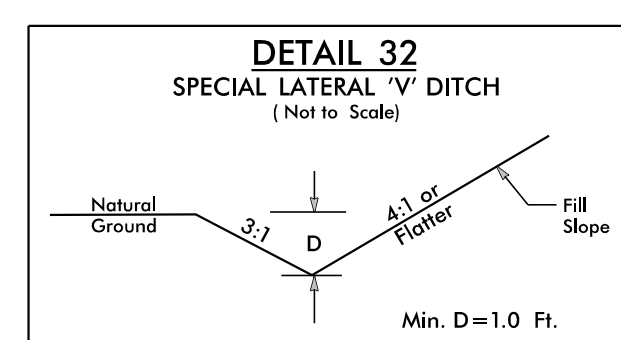

FROM STA. 147+00 -L- TO STA. 148+00 -L- RT

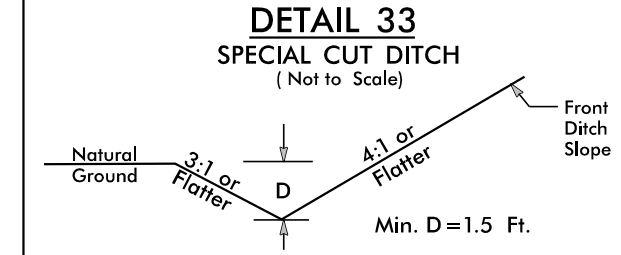

FROM STA. 142+00 -L- TO STA. 145+70 -L- RT

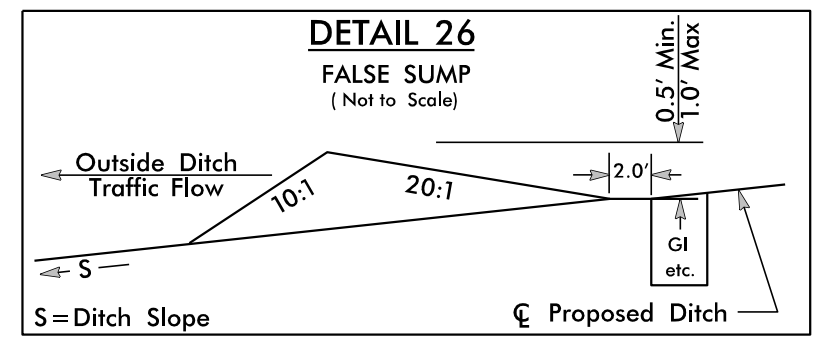

STA. 154+62 -L- RT  
STA. 155+62 -L- RT

★ DENOTES PROPOSED SIGNALIZED INTERSECTION