

PROJECT REFERENCE NO.	SHEET NO.
U-5312	EC-13/CONST.15
RW SHEET NO.	
ROADWAY DESIGN ENGINEER	HYDRAULICS ENGINEER

NOTE:  
UTILIZE FABRIC INSERT INLET PROTECTION DEVICES IN LIEU OF ROCK INLET SEDIMENT TRAPS, TYPE-C AS DIRECTED TO AVOID IMPOUNDMENT OF RUNOFF IN ROADWAY OPEN TO TRAFFIC.

NOTE:  
PLACE TEMPORARY ROCK SEDIMENT DAMS TYPE - B AND TEMPORARY ROCK SILT CHECKS TYPE - A AT DRAINAGE OUTLETS.

INSTALL PIPE(S) IN JURISDICTIONAL AREAS WITHOUT IMPACTING STREAM UNTIL AREA STABILIZED AND ACCORDING TO NCDOT BEST MANAGEMENT PRACTICES FOR CONSTRUCTION AND MAINTENANCE ACTIVITIES MANUAL.

CLEARING AND GRUBBING EROSION CONTROL FOR CONSTRUCTION SHEET 15

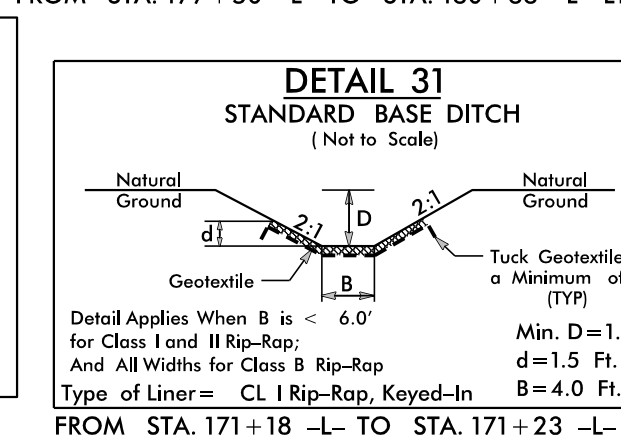
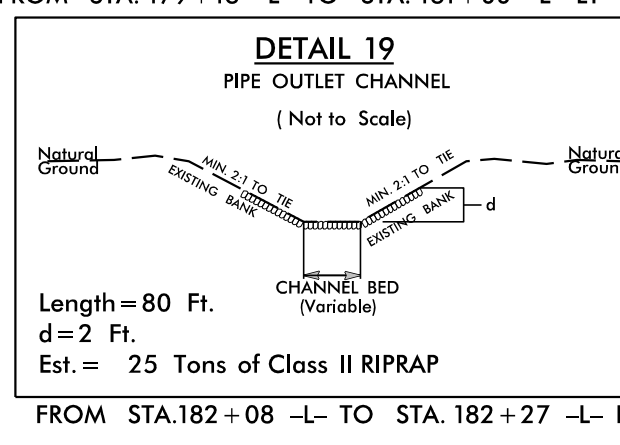
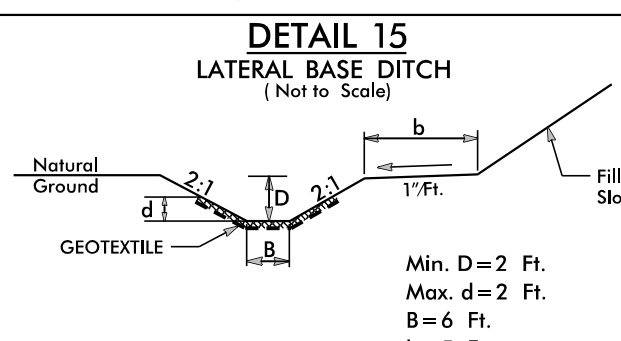
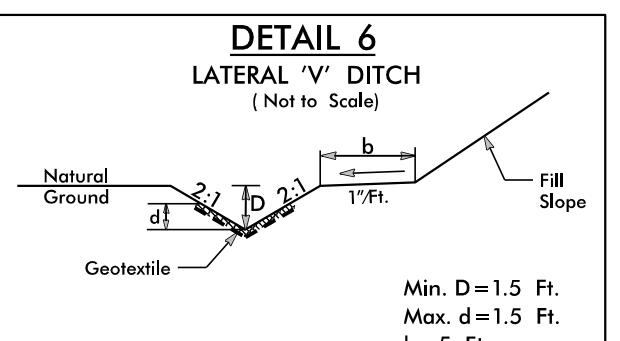
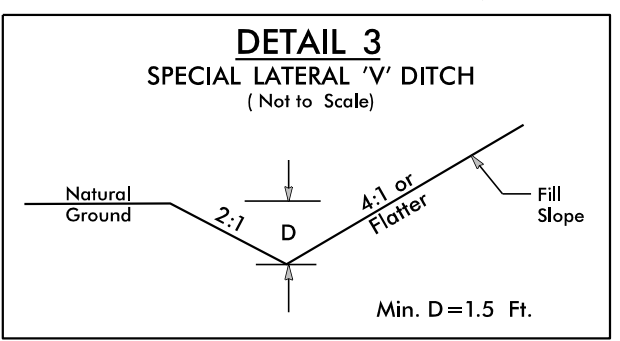
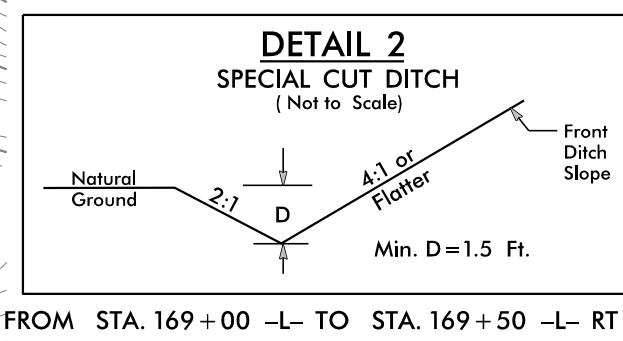
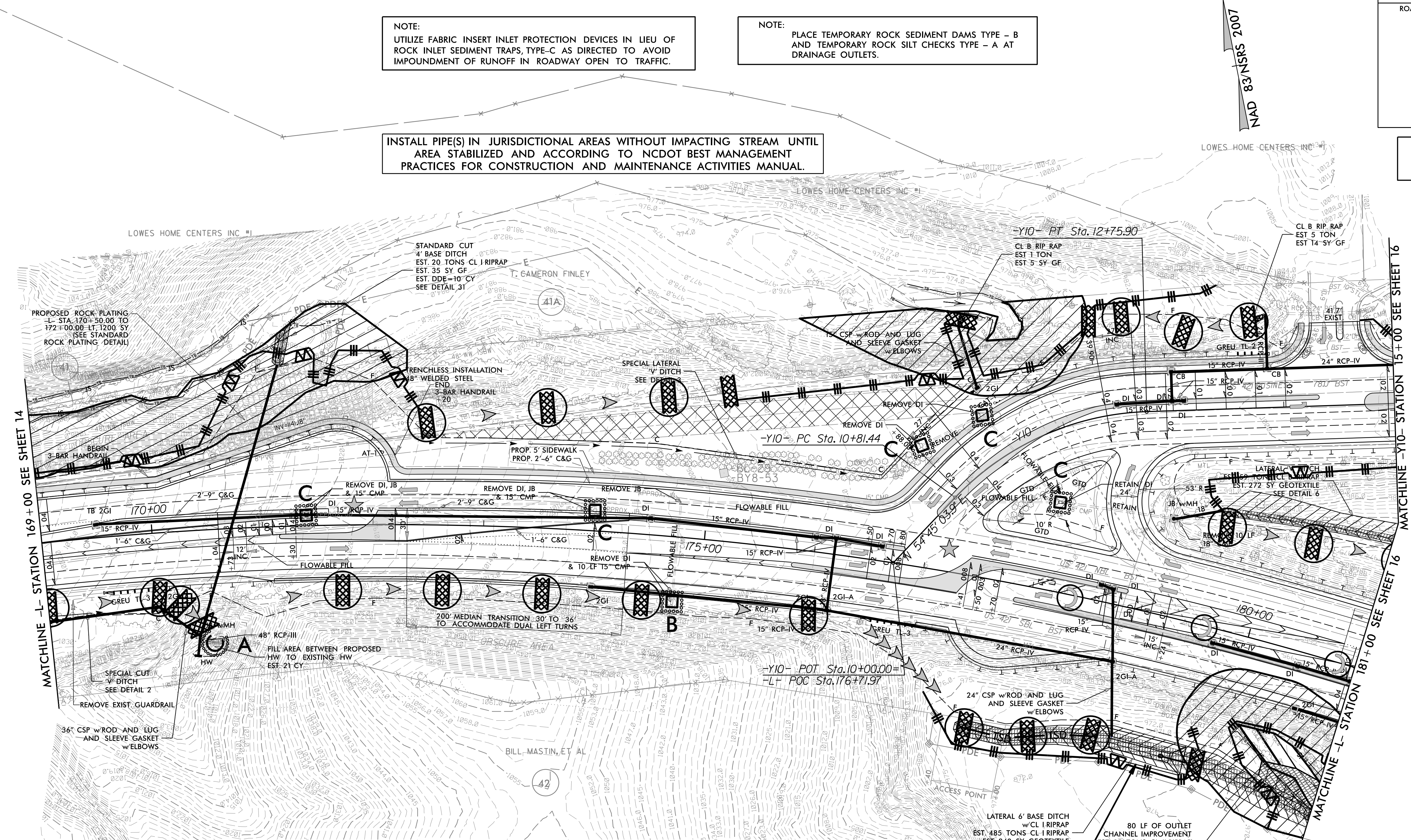

81 x 26 x 3  
1.5 inch Skimmer  
with 1.25 inch  
Orifice Diameter  
8 ft. weir  
ID 13.1

ENVIRONMENTALLY SENSITIVE AREA  
SEE PROJECT SPECIAL PROVISIONS

FOR -L- & -Y10- PROFILES SEE SHEETS 22 & 24  
FOR INTERSECTION AND U-TURN BULB DETAILS SEE SHEETS 2B-14 & 2B-15

DENOTES PROPOSED SIGNALIZED INTERSECTION