

5/14/99

PROJECT REFERENCE NO. R-5705A	SHEET NO. EC-16A/CONST.16
ROADWAY DESIGN ENGINEER	HYDRAULICS ENGINEER

CULVERT CONSTRUCTION SEQUENCE STA. 181+66 -L-

PHASE I

- 1.) UTILIZE SPECIAL STILLING BASIN(S) DURING CONSTRUCTION AS NEEDED TO DEWATER WORK SITE. (TYP.)
- 2.) CONSTRUCT TEMPORARY CHANNEL CHANGE WITH LINER (2 FT BASE, 2 FT DEEP, 2:1 SIDE SLOPES).
- 3.) CONSTRUCT IMPERVIOUS DIKES 1 AND 2, DIVERTING FLOW THROUGH TEMPORARY CHANNEL CHANGE.

PHASE II

- 1.) REMOVE EXISTING 42" RCP AND CONSTRUCT PROPOSED 5'x7' RCBC
- 2.) ADJUST TEMPORARY CHANNEL CHANGE AS NECESSARY TO MAKE UPSTREAM AND DOWNSTREAM CHANNEL IMPROVEMENTS WITHIN EASEMENTS AND PLACE REQUIRED RIPRAP AND MATTING ON CHANNEL BANKS.

PHASE III

- 1.) REMOVE IMPERVIOUS DIKES 1 AND 2 AND THE TEMPORARY CHANNEL CHANGE.
- 2.) REMOVE SPECIAL STILLING BASIN.
- 3.) STABILIZE DISTURBED AREA AND REMOVE ALL EROSION AND SEDIMENT CONTROL DEVICES AS DIRECTED.
- 4.) FINISH ROADWAY AND DRAINAGE CONSTRUCTION.

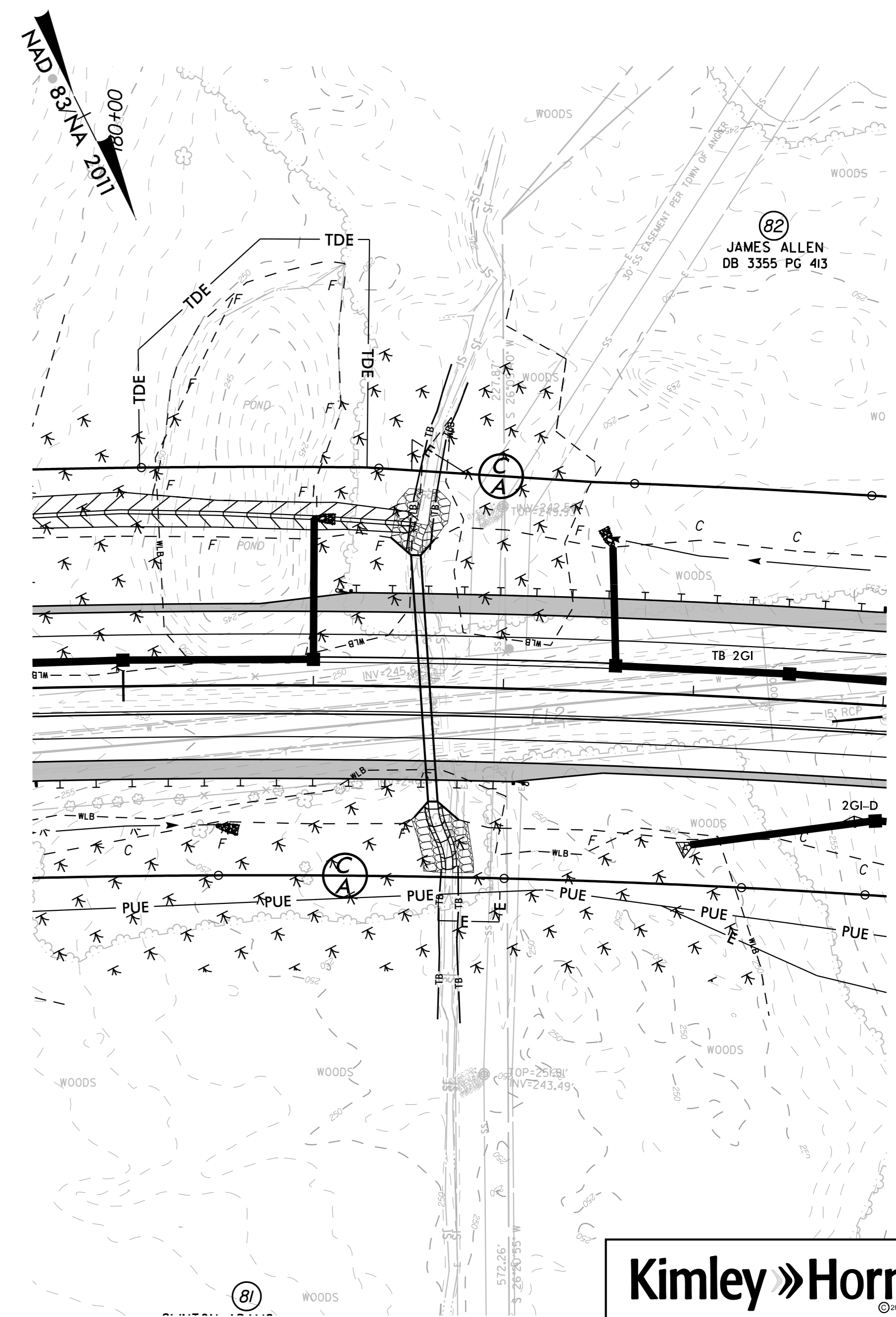
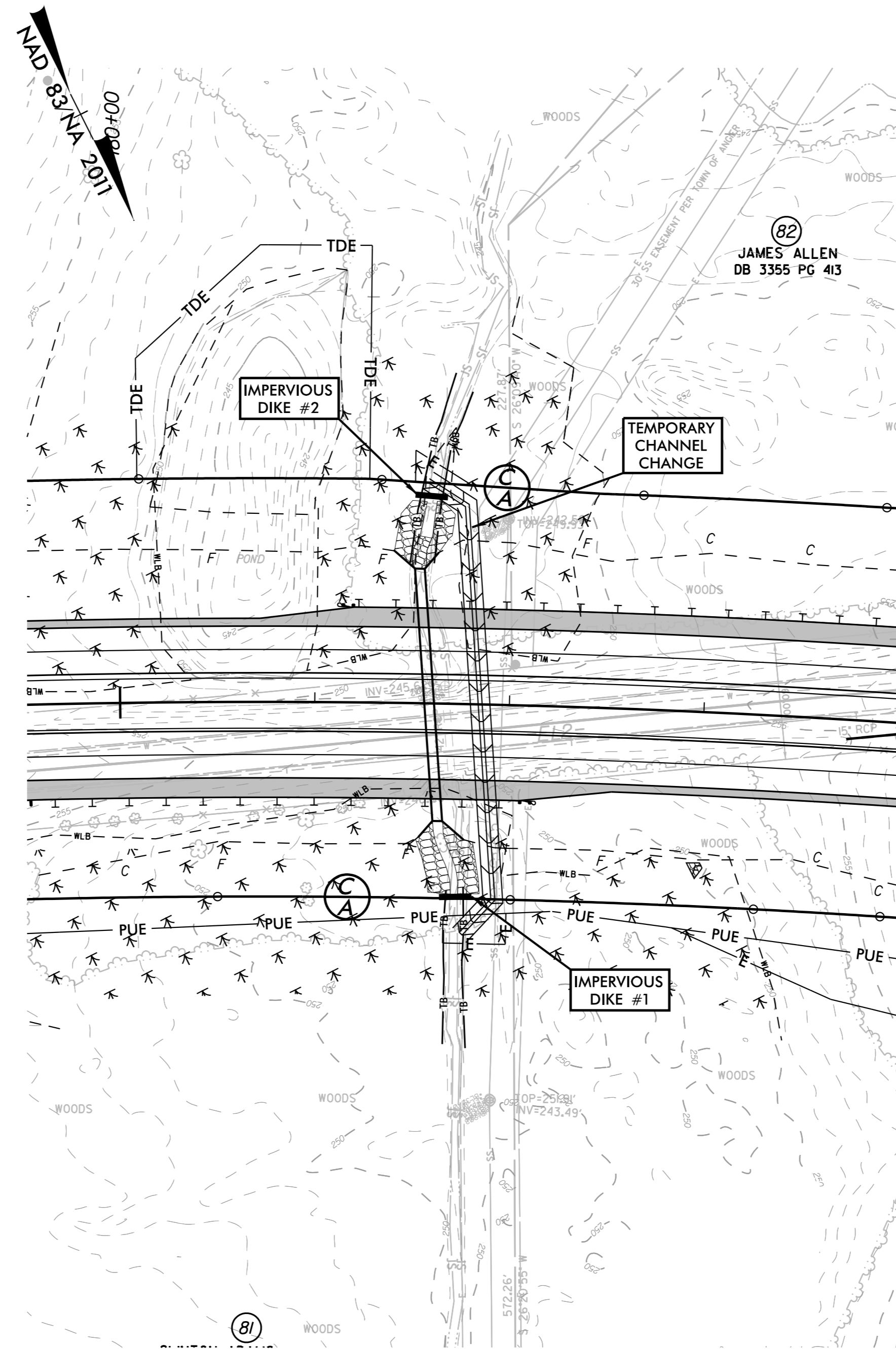
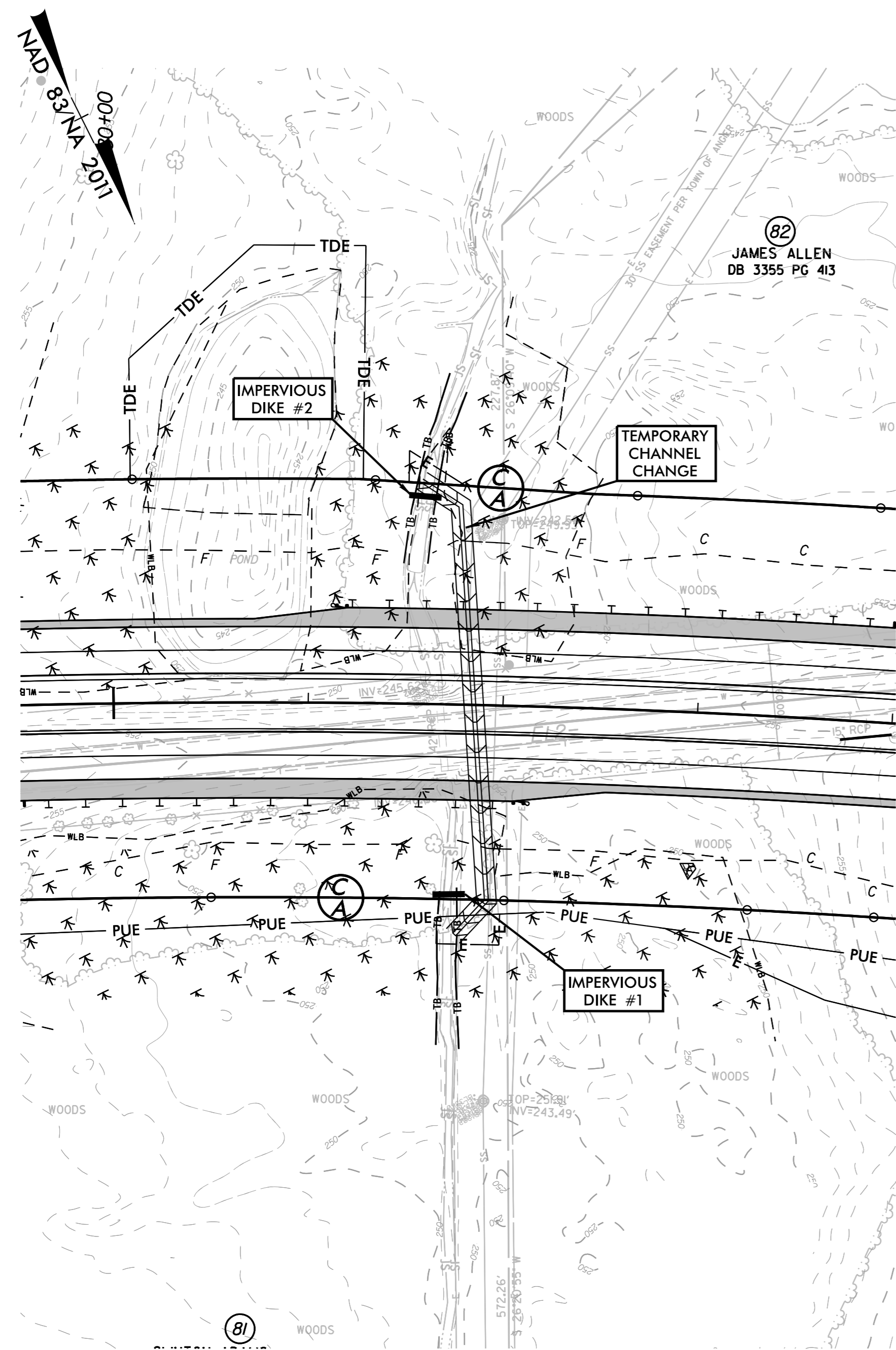

11/16/2022