

TIP PROJECT: R-5799

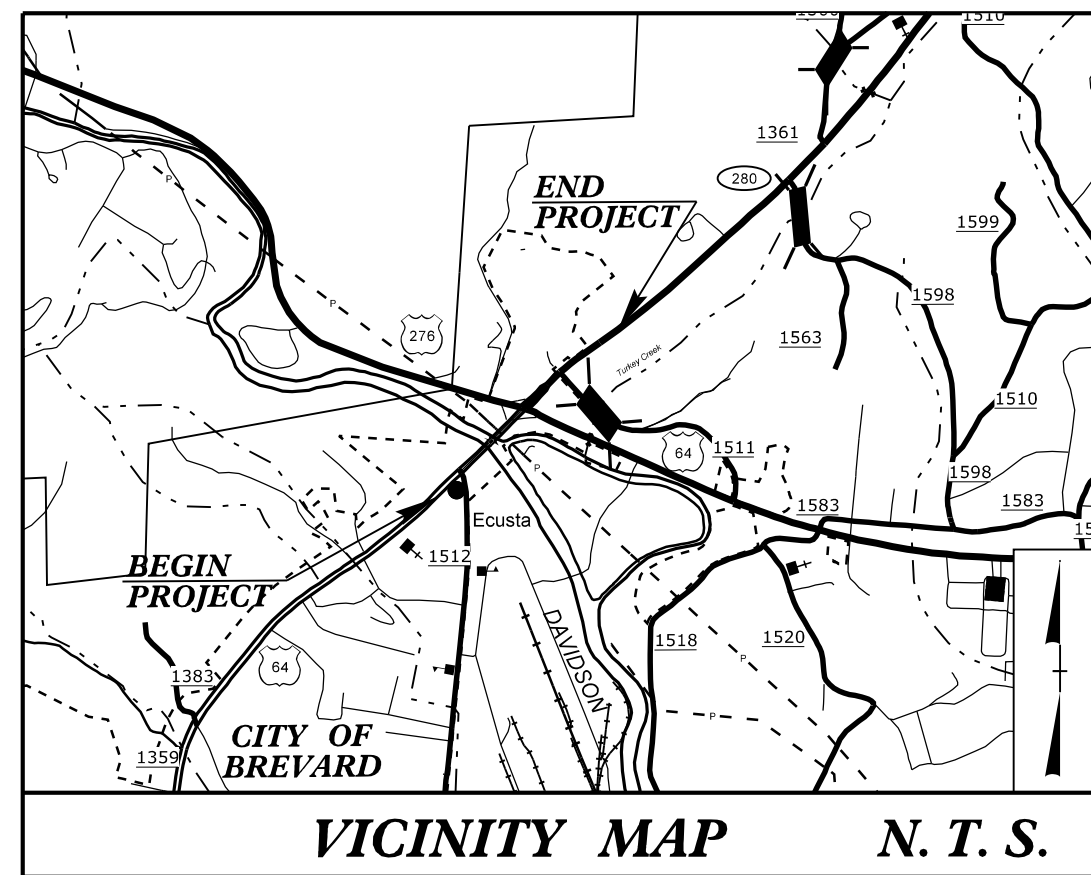

STATE OF NORTH CAROLINA
DIVISION OF HIGHWAYS

PLAN FOR PROPOSED
HIGHWAY EROSION CONTROL

TRANSYLVANIA COUNTY

LOCATION: US 64 AT NC 280 /US 64

INTERSECTION IMPROVEMENTS

TYPE OF WORK: GRADING, PAVING, DRAINAGE, CULVERT, RETAINING
WALLS, SIGNALS, AND SIGNING

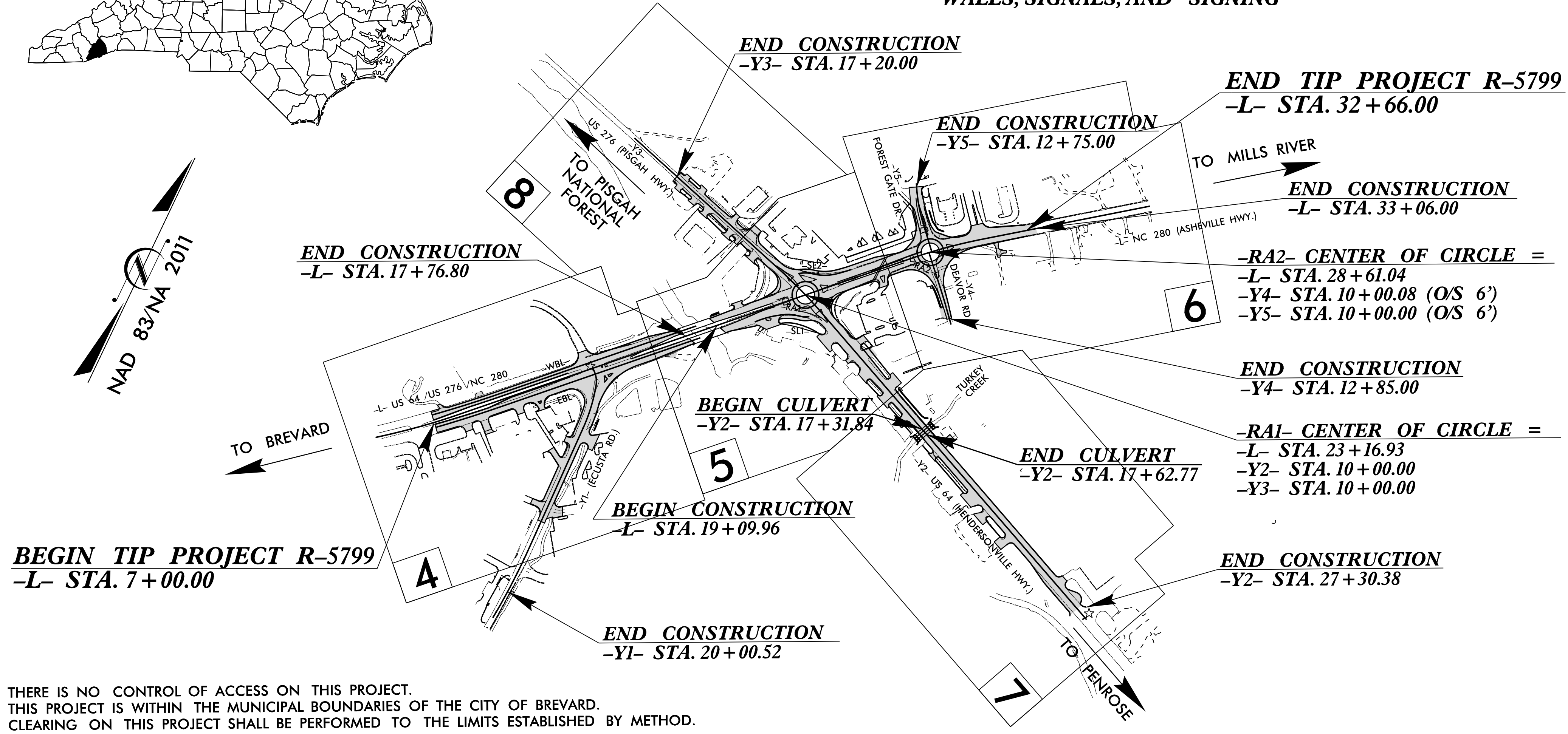
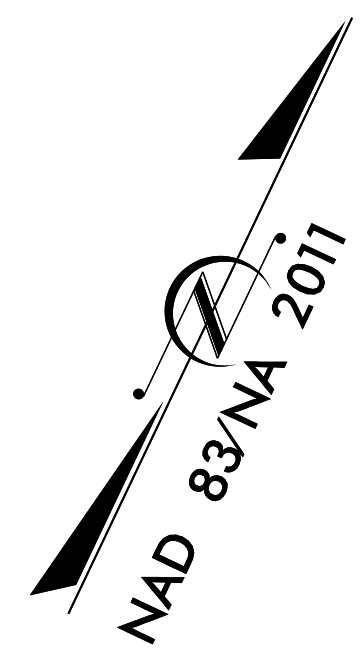
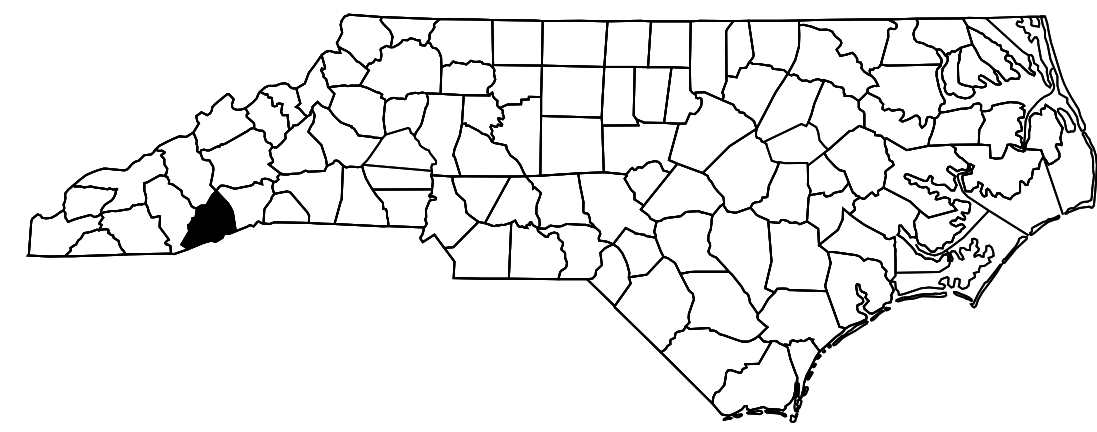

THERE IS NO CONTROL OF ACCESS ON THIS PROJECT.
THIS PROJECT IS WITHIN THE MUNICIPAL BOUNDARIES OF THE CITY OF BREVARD.
CLEARING ON THIS PROJECT SHALL BE PERFORMED TO THE LIMITS ESTABLISHED BY METHOD.

STATE	STATE PROJECT REFERENCE NO.	SHEET NO.	TOTAL SHEETS
N.C.	R-5799	EC-1	20
STATE PROJ. NO.	F.A. PROJ. NO.	DESCRIPTION	
44984.I.I	N/A	P.E.	

EROSION AND SEDIMENT CONTROL MEASURES

Sed. #	Description	Symbol
1630.03	Temporary Silt Ditch	TSD
1650.05	Temporary Diversion	TD
1605.01	Temporary Silt Fence	
1606.01	Special Sediment Control Fence	---X---
1622.01	Temporary Berms and Slope Drains	---X---
1650.02	Silt Basin Type B	---X---
1633.01	Temporary Rock Silt Check Type-A	---X---
	Temporary Rock Silt Check Type-A with Matting and Polyacrylamide (PAM)	---X---
1633.02	Temporary Rock Silt Check Type-B	---X---
	Wattle/Coir Fiber Wattle	---X---
	Wattle/Coir Fiber Wattle with Polyacrylamide (PAM)	---X---
1634.01	Temporary Rock Sediment Dam Type-A	---X---
1634.02	Temporary Rock Sediment Dam Type-B	---X---
1635.01	Rock Pipe Inlet Sediment Trap Type-A	---X---
1635.02	Rock Pipe Inlet Sediment Trap Type-B	---X---
1630.04	Stilling Basin	---X---
1630.06	Special Stilling Basin	---X---
	Rock Inlet Sediment Trap:	
1632.01	Type A	A
1632.02	Type B	B
1632.03	Type C	C
	Skimmer Basin	---X---
	Tiered Skimmer Basin	---X---
	Infiltration Basin	---X---

THIS PROJECT CONTAINS EROSION CONTROL PLANS FOR CLEARING AND GRUBBING PHASE OF CONSTRUCTION.

THIS PROJECT HAS BEEN DESIGNED TO SENSITIVE WATERSHED STANDARDS.

ENVIRONMENTALLY SENSITIVE AREA(S) EXIST ON THIS PROJECT
Refer To E. C. Special Provisions for Special Considerations.

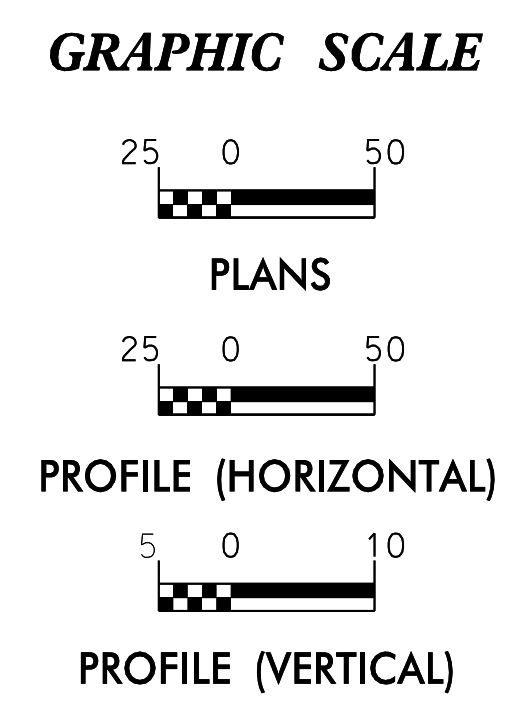

THESE EROSION AND SEDIMENT CONTROL PLANS COMPLY WITH THE REGULATIONS SET FORTH BY THE NCG-010000 GENERAL CONSTRUCTION PERMIT EFFECTIVE APRIL 1, 2019 AND ISSUED BY THE NORTH CAROLINA DEPARTMENT OF ENVIRONMENTAL QUALITY DIVISION OF WATER RESOURCES.

Prepared in the Office of:
RS&H
8521 SIX FORKS ROAD, SUITE 400
RALEIGH, NC 27615
NC FIRM LICENSE No: F-0493

Designed by:
ALEX VINSON, P.E. 3909
NAME LEVEL III CERTIFICATION NO.

Prepared in the Office of:
ROADSIDE ENVIRONMENTAL UNIT
1 South Wilmington St.
Raleigh, NC 27611

Reviewed by:
JENNIFER PARISH, P.E.

Highway Standard Drawings

The following roadway english standards as appear in "Roadway Standard Drawings"- Roadway Design Unit - N. C. Department of Transportation - Raleigh, N. C., dated January 2018 and the latest revision thereto are applicable to this project and by reference hereby are considered a part of these plans.

1604.01 Railroad Erosion Control Detail	1632.01 Rock Inlet Sediment Trap Type A
1605.01 Temporary Silt Fence	1632.02 Rock Inlet Sediment Trap Type B
1606.01 Special Sediment Control Fence	1632.03 Rock Inlet Sediment Trap Type C
1607.01 Gravel Construction Entrance	1633.01 Temporary Rock Silt Check Type A
1622.01 Temporary Berms and Slope Drains	1633.02 Temporary Rock Silt Check Type B
1630.01 Riser Basin	1634.01 Temporary Rock Sediment Dam Type A
1630.02 Silt Basin Type B	1634.02 Temporary Rock Sediment Dam Type B
1630.03 Temporary Silt Ditch	1635.01 Rock Pipe Inlet Sediment Trap Type A
1630.04 Stilling Basin	1635.02 Rock Pipe Inlet Sediment Trap Type B
1630.05 Temporary Diversion	1640.01 Coir Fiber Baffle
1630.06 Special Stilling Basin	1645.01 Temporary Stream Crossing
1631.01 Matting Installation	

26-APR-2023 09:51:00 N:\Projects\R-5799\EC.tsd.dgn