

RETAINING WALL #1:

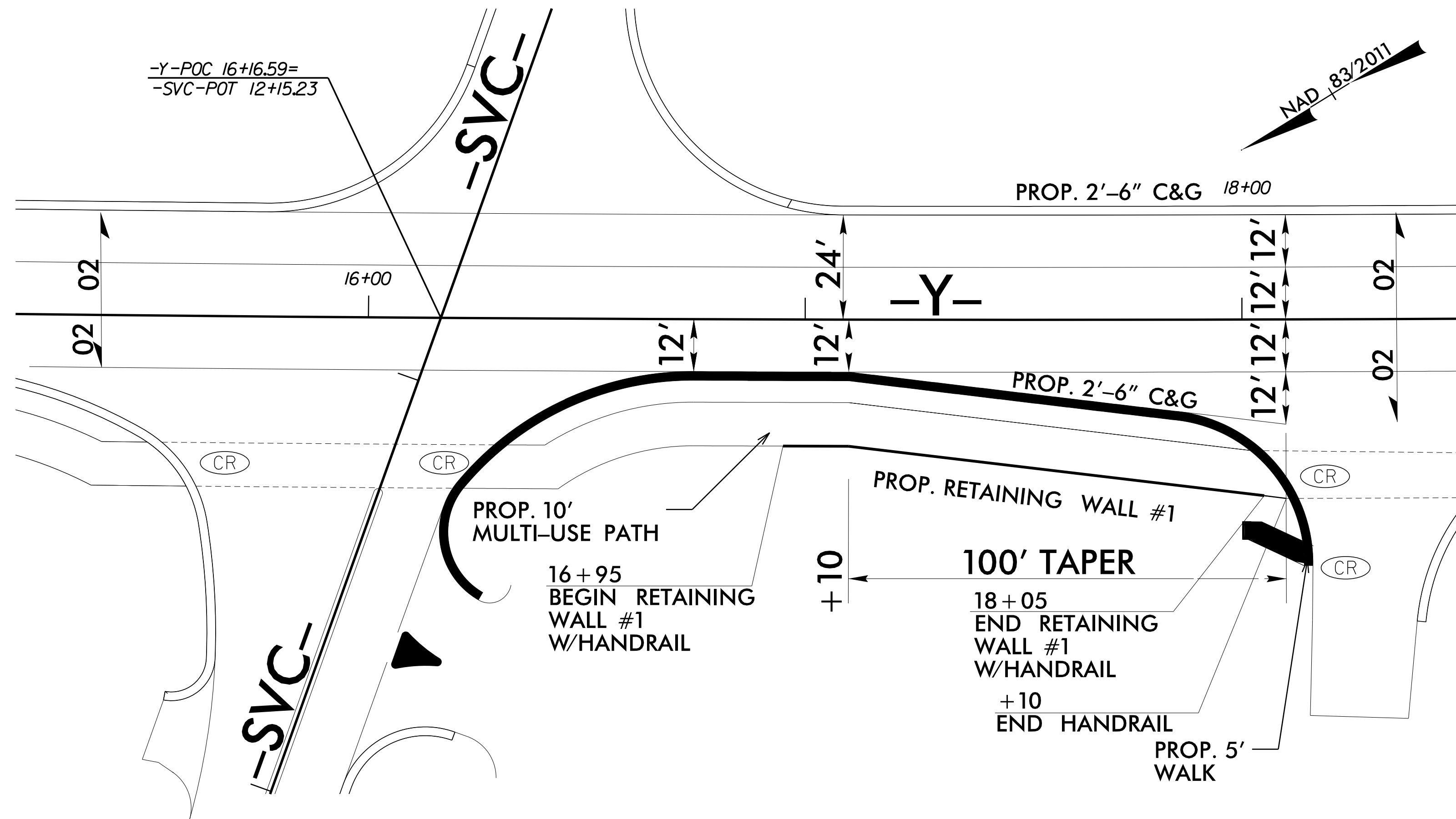

GEOTECHNICAL ENGINEER

DocuSigned by:
D. Matthew Brewer 4/1/2023

SIGNATURE DATE

**DOCUMENT NOT CONSIDERED FINAL
UNLESS ALL SIGNATURES COMPLETED**

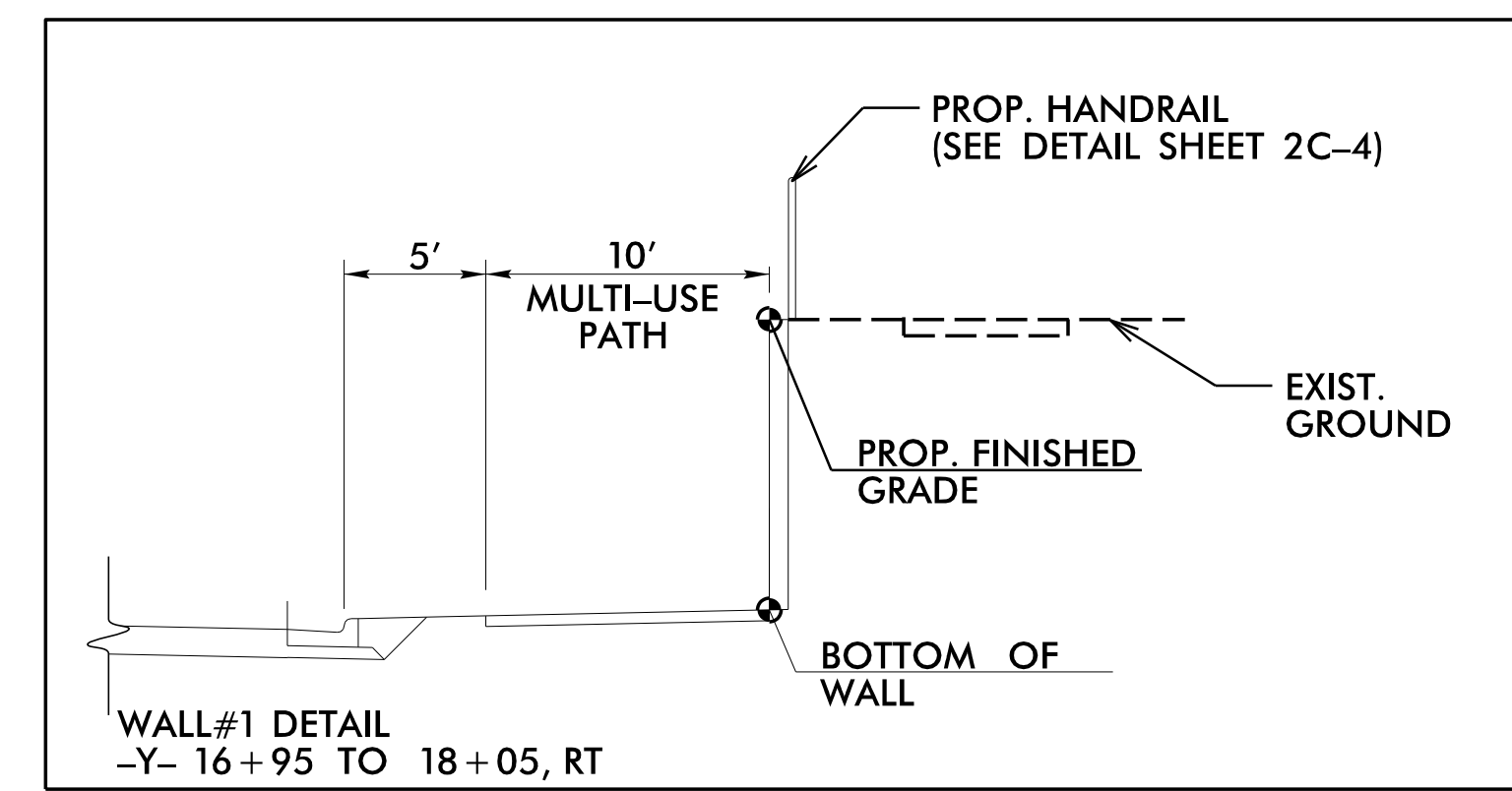

DETAIL FOR WALL #1

RETAINING WALL #1:

NOT TO SCALE
(LOOKING AT FACE OF WALL)

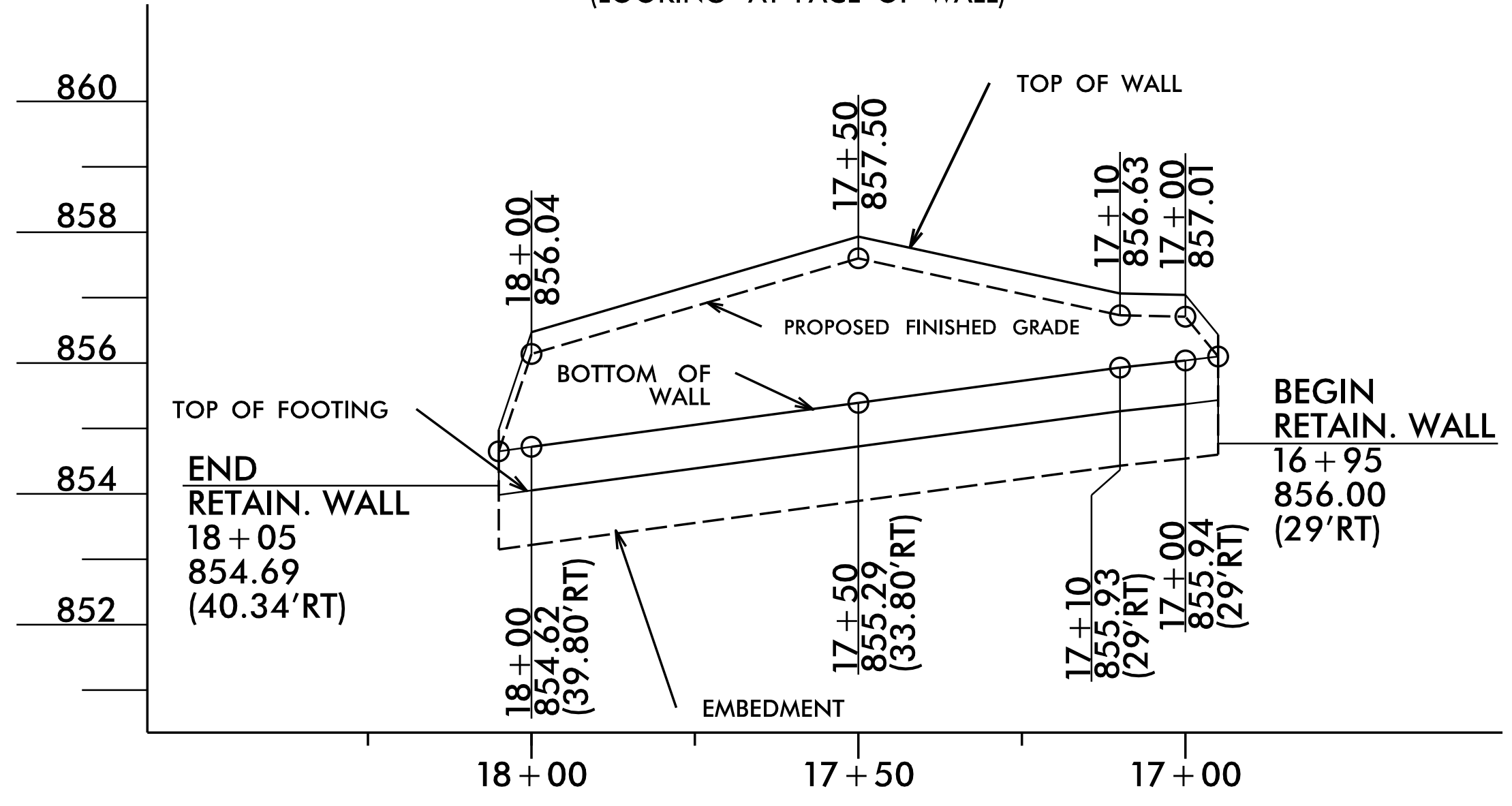

STANDARD SEGMENTAL GRAVITY RETAINING WALL QUANTITY	
RETAINING WALL # 1	280 SQ. FT.

NOTE: ESTIMATED WALL QUANTITY MEASURED FROM TOP OF WALL TO TOP OF FOOTING.

PROJECT NO.: U-5775
 CLEVELAND COUNTY
 STATION: 16+95, 29 ft RT to 18+05, 40 ft RT
 SHEET 1 OF 2 WALL ID RETAINING WALL #1

PREPARED BY: M. BREWER, P.E.	DATE: 3/29/23
REVIEWED BY: R. KRAL, P.E.	DATE: 3/29/23

Prepared in the Office of:

**CAROLINAS
GEOTECHNICAL
GROUP**

2400 CROWNPPOINT EXECUTIVE DRIVE
SUITE 800
CHARLOTTE, NC 28227
(980) 339-8684

NORTH CAROLINA
DEPARTMENT OF TRANSPORTATION
DIVISION OF HIGHWAYS

**GEOTECHNICAL
ENGINEERING UNIT**

REVISIONS						SHEET NO.
NO.	BY	DATE	NO.	BY	DATE	
1			3			W-1
2			4			