

DATE: 2/9/2023 TIME: 10:54:17 PM USER: pmw@aecom.com DN: pmw@aecom.com DSZ: LA_2020\Documents\60609754-U-5748-Upon_MIT900-CAD GIS\910_CAD\70_MCDOT_TIF\Structures\04 Drawings\402_DTL-U-5748_SML_BM_S2-35_9/0/31

BILL OF MATERIAL					
BAR	NO.	SIZE	TYPE	LENGTH	WEIGHT
* A1	592	5	STR	20'-2"	12452
A2	592	5	STR	20'-2"	12452
* B1	72	4	STR	31'-10"	1531
* B2	54	6	STR	23'-9"	1926
* B3	28	6	STR	30'-8"	1290
B4	116	5	STR	47'-6"	5747
* B5	36	4	STR	37'-5"	900
* B6	18	6	STR	44'-7"	1205
* B7	28	6	STR	20'-4"	855
B8	58	5	STR	58'-4"	3529
* D1	1184	5	STR	5'-3"	6483
* D2	1184	5	STR	3'-6"	4322
* G1	4	5	STR	20'-2"	84
* G2	4	5	STR	2'-8"	11
* K1	4	8	1	10'-1"	108
* K2	4	8	2	18'-10"	201
* K3	4	8	1	12'-2"	130
K4	9	4	STR	16'-4"	98
K5	8	4	STR	5'-10"	31
K6	8	4	STR	7'-0"	37
K7	16	4	STR	7'-4"	78
K8	8	4	STR	7'-8"	41
* K9	4	8	1	9'-7"	102
* K10	4	8	2	17'-6"	187
* K11	4	8	1	11'-8"	125
* S1	28	5	3	6'-5"	187
* S2	94	4	4	2'-9"	173
* S3	28	5	3	5'-5"	158
U1	10	4	5	14'-6"	97
U2	4	4	5	12'-6"	33
U3	10	4	5	13'-0"	87
U4	4	4	5	11'-0"	29
REINFORCING STEEL				LBS.	22,353
EPOXY COATED REINFORCING STEEL				LBS.	32,596

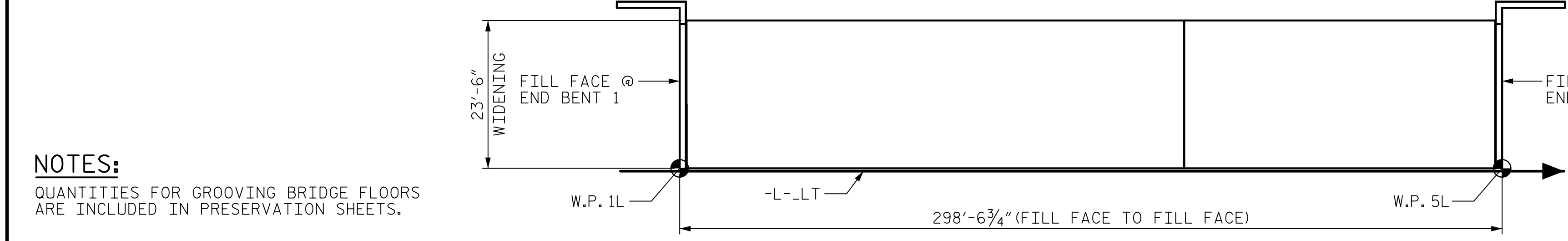
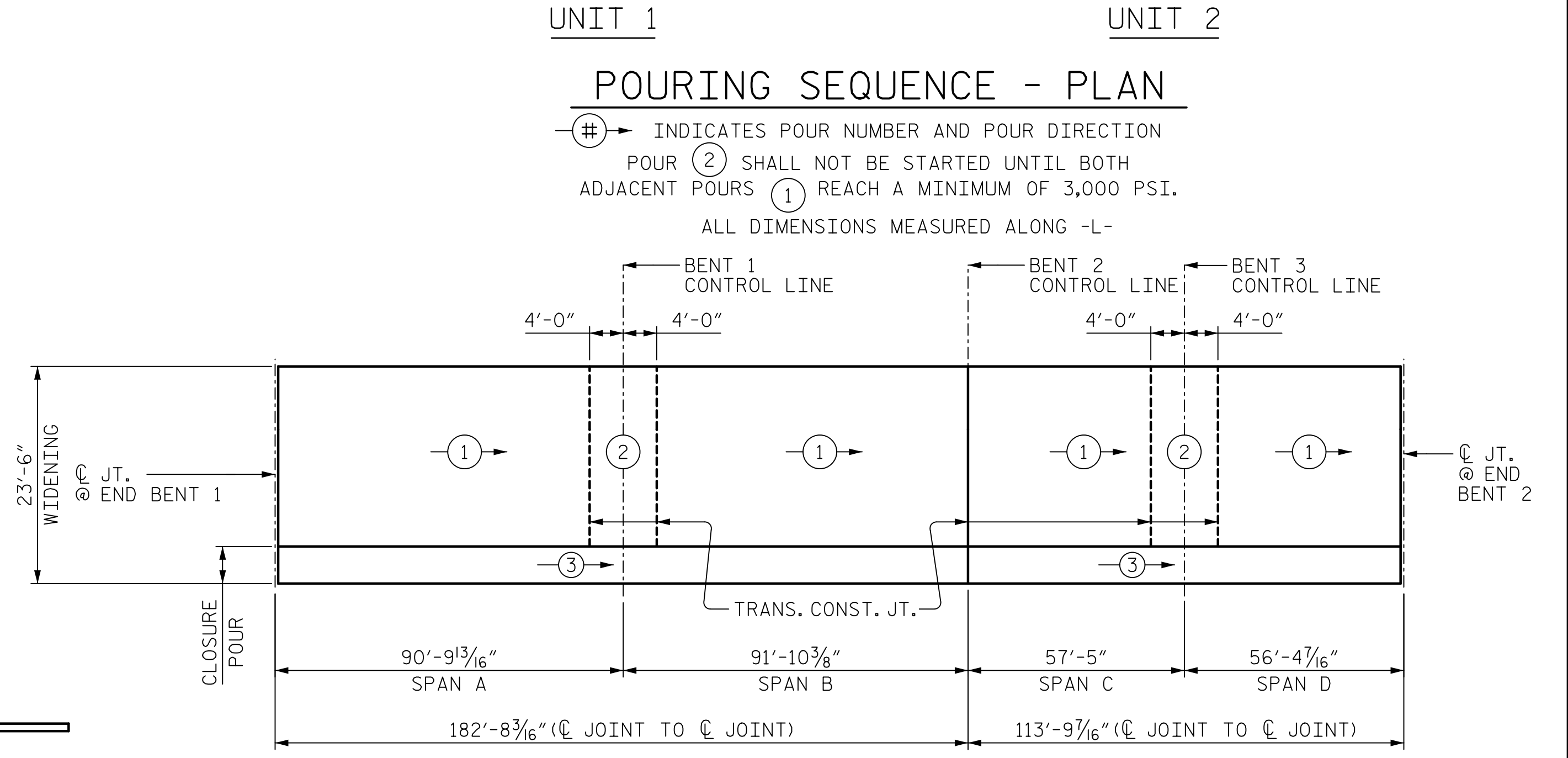
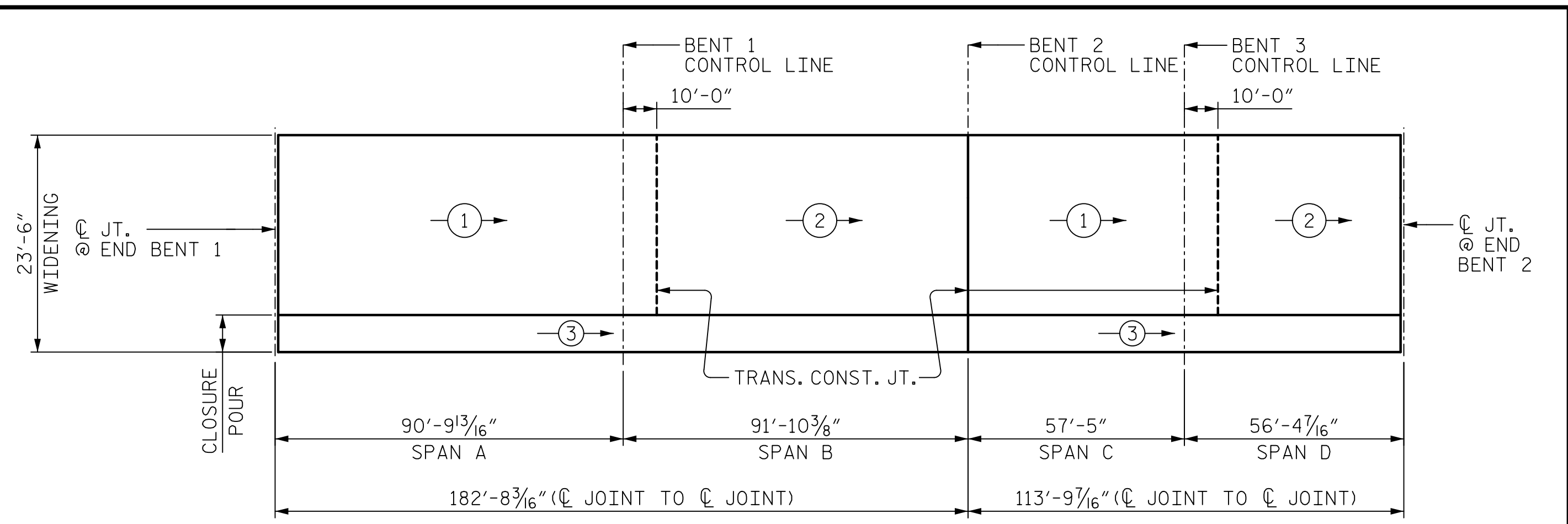
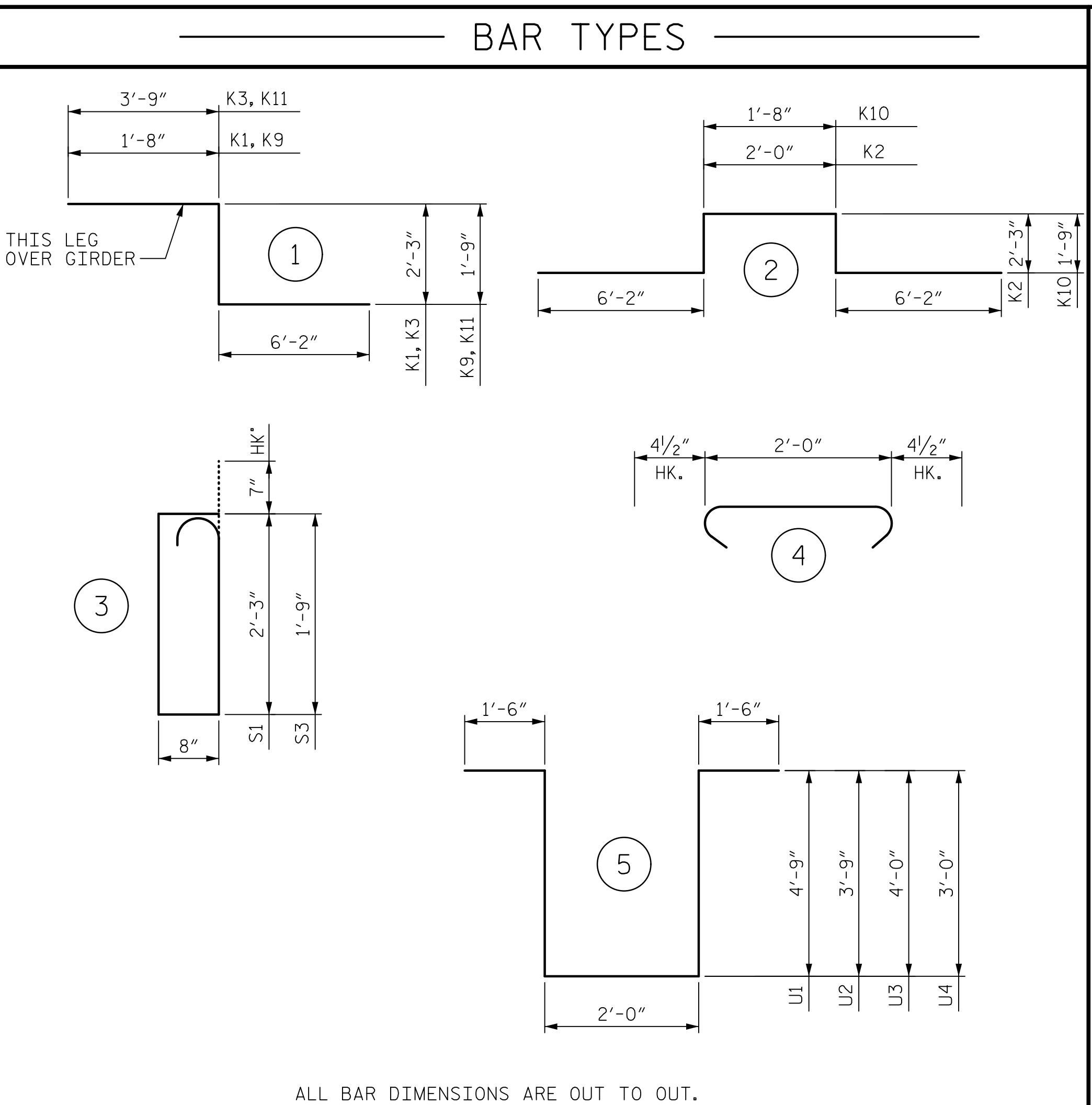

NOTES:
 QUANTITIES FOR GROOVING BRIDGE FLOORS ARE INCLUDED IN PRESERVATION SHEETS.

SUPERSTRUCTURE BILL OF MATERIAL			
	CLASS AA CONCRETE (CU. YDS.)	REINFORCING STEEL (LBS.)	EPOXY COATED REINFORCING STEEL (LBS.)
SPANS A-D		22,353	32,596
UNIT 1 - POUR #1	74.9	---	---
UNIT 1 - POUR #2	56.6	---	---
UNIT 2 - POUR #1	50.3	---	---
UNIT 2 - POUR #2	31.7	---	---
CLOSURE POUR	17.7	---	---
TOTAL	231.2	22,353	32,596

* QUANTITIES FOR BARRIER RAIL AND PARAPET ARE NOT INCLUDED

SUPERSTRUCTURE REINFORCING STEEL LENGTHS ARE BASED ON THE FOLLOWING MINIMUM SPLICE LENGTHS					
BAR SIZE	SUPERSTRUCTURE EXCEPT APPROACH SLABS, PARAPET, AND BARRIER RAIL		APPROACH SLABS		PARAPET AND BARRIER RAIL
	EPOXY COATED	UNCOATED	EPOXY COATED	UNCOATED	
#4	1'-11"	1'-7"	1'-11"	1'-7"	2'-6"
#5	2'-5"	2'-0"	2'-5"	2'-0"	3'-1"
#6	2'-10"	2'-5"	3'-7"	2'-5"	3'-8"
#7	4'-2"	2'-9"			
#8	4'-9"	3'-2"			

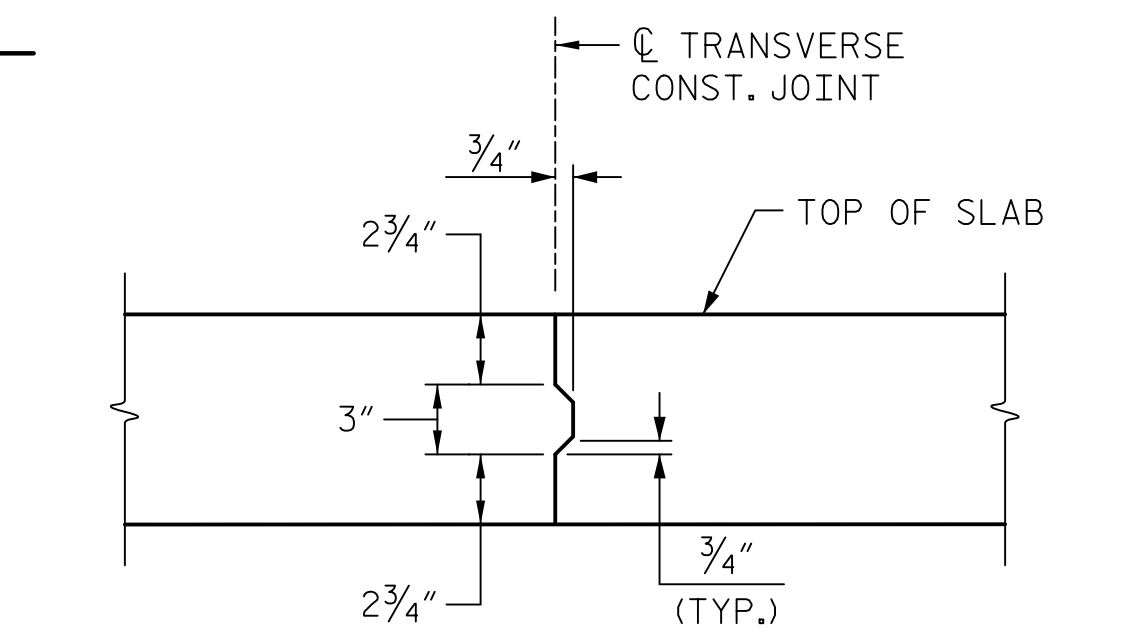

NOTES: REINFORCING STEEL IN SLAB NOT SHOWN.
 LONGITUDINAL REINFORCING STEEL SHALL BE CONTINUOUS THRU JOINT.

PROJECT NO. U-5748
 WAKE COUNTY
 STATION: 24+88.00 -L-

AECOM
 AECOM TECHNICAL SERVICES OF NC, INC.
 5438 WADE PARK BOULEVARD, SUITE 200
 RALEIGH, NC 27607
 (919) 854-6200
 www.aecom.com
 AECOM License No. F-0342

John C. Morrison
 NORTH CAROLINA PROFESSIONAL ENGINEER
 SEAL 030474
 2/10/2023

STATE OF NORTH CAROLINA DEPARTMENT OF TRANSPORTATION RALEIGH					
STANDARD SUPERSTRUCTURE BILL OF MATERIAL (SOUTHBOUND LANES)					
REVISIONS				SHEET NO.	
NO.	BY:	DATE:	NO.	BY:	DATE:
1			3		
2			4		
					TOTAL SHEETS
					119

DOCUMENT NOT CONSIDERED FINAL UNLESS ALL SIGNATURES COMPLETED