

**COLUMN & DRILLED PIER KEY**

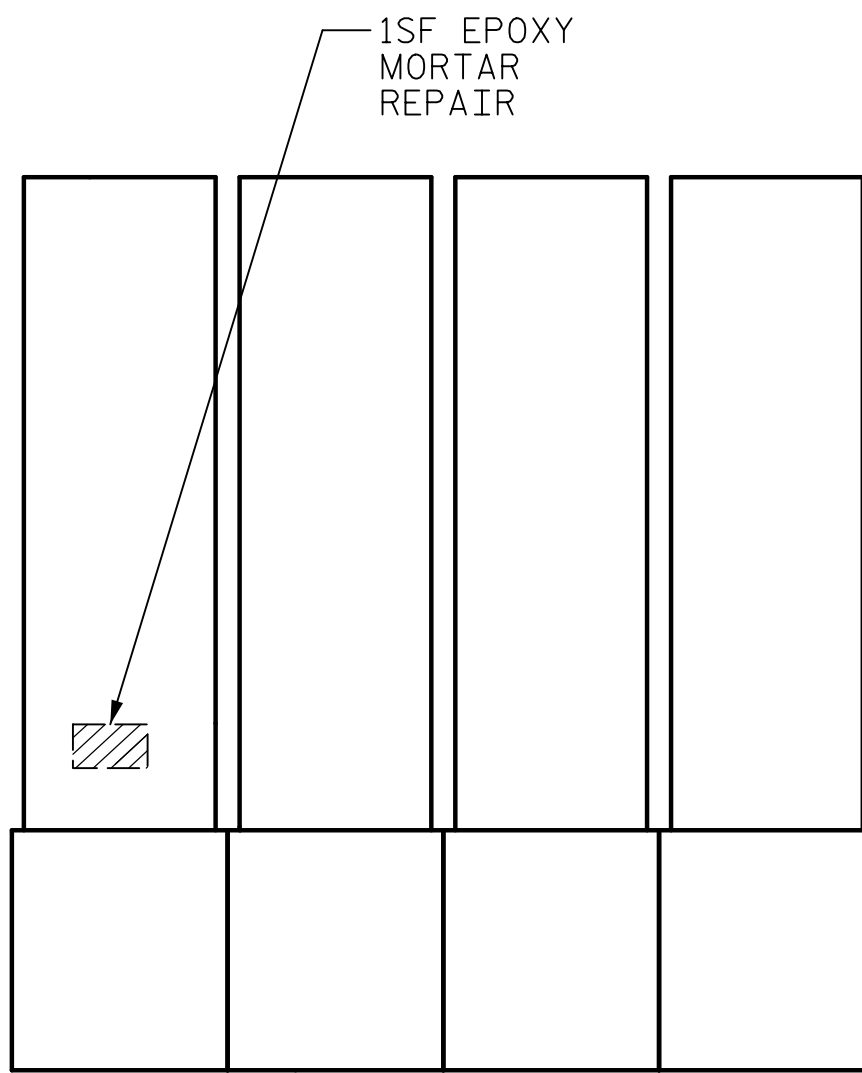

W S E N  
**COLUMN & DRILLED PIER 1**

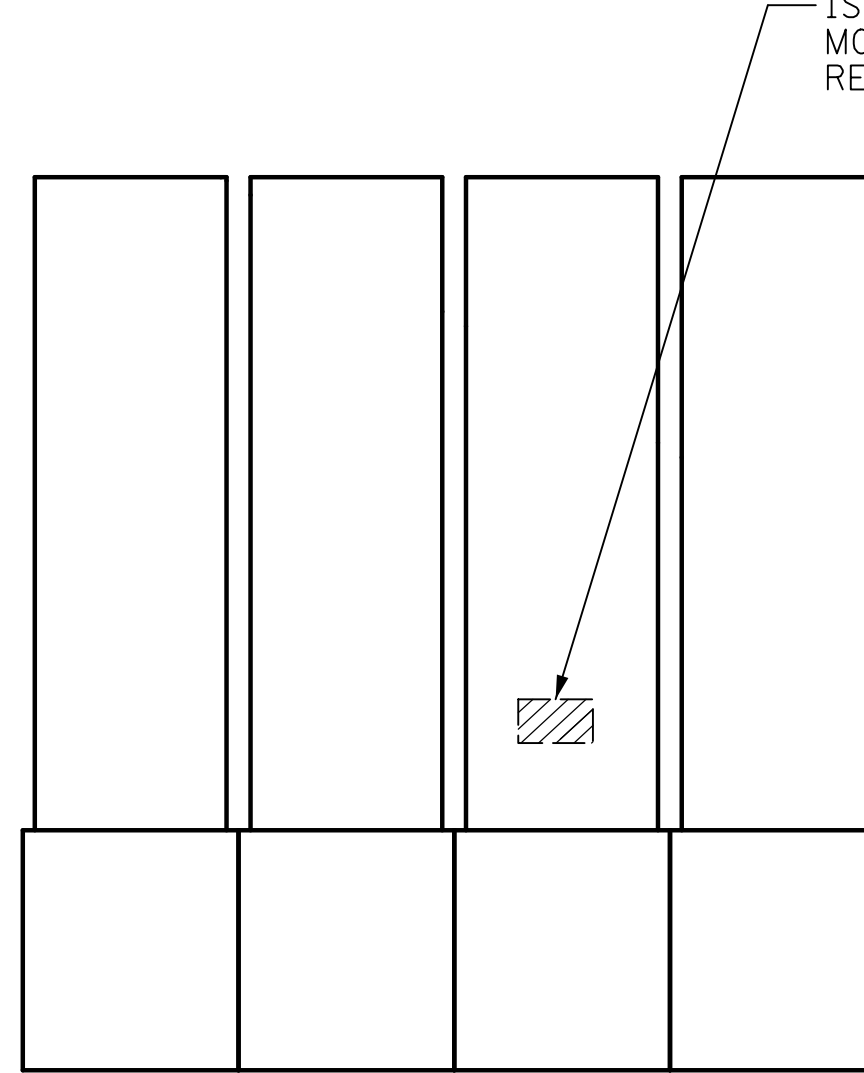

W S E N  
**COLUMN & DRILLED PIER 2**

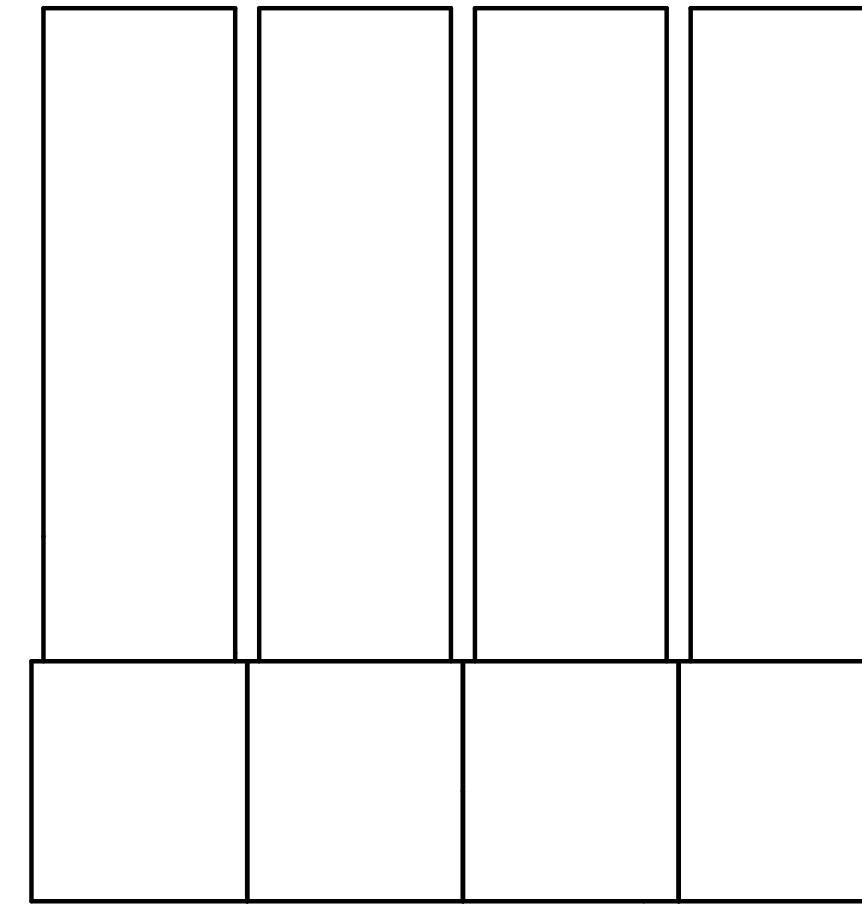

W S E N  
**COLUMN & DRILLED PIER 3**

EPOXY MORTAR REPAIR AREA

REPAIR QUANTITY TABLE		
BENT REPAIRS		
BENT 3		
	ESTIMATE	ACTUAL
EPOXY MORTAR REPAIR		
CAP	0 SF	
COLUMN	2 SF	
CONCRETE REPAIRS		
CAP	0 CF	
COLUMN	0 CF	
EPOXY RESIN INJECTION		
CAP	0 LF	
COLUMN	0 LF	

**NOTES:**  
FOR REPAIR DETAILS, SEE "REPAIR DETAILS" SHEET.

DRAWN BY : M. CATER	DATE : 10/22
CHECKED BY : G. COLS	DATE : 10/22
DESIGNED BY : G. COLS	DATE : 10/22
DESIGN CHECKED BY : J. SLOAN	DATE : 10/22

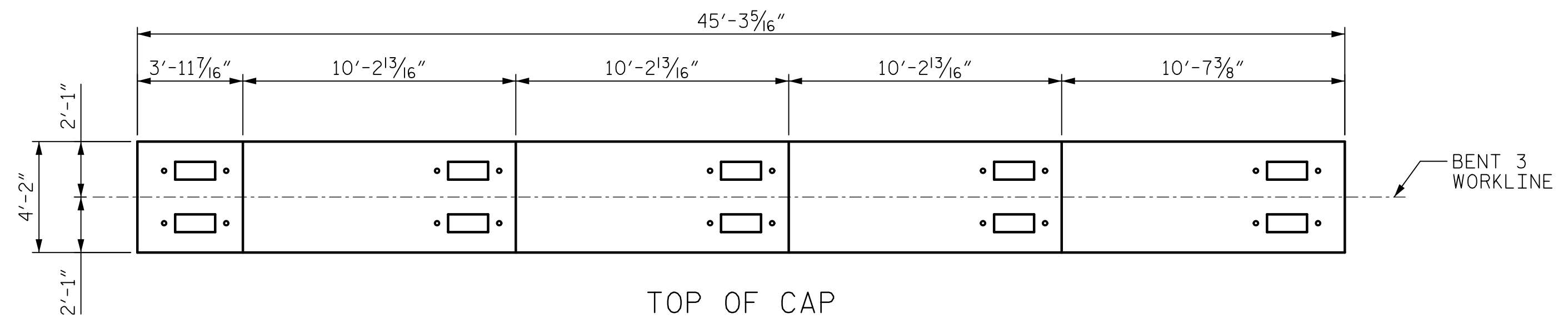

TOP OF CAP

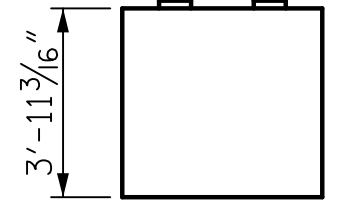

WEST FACE

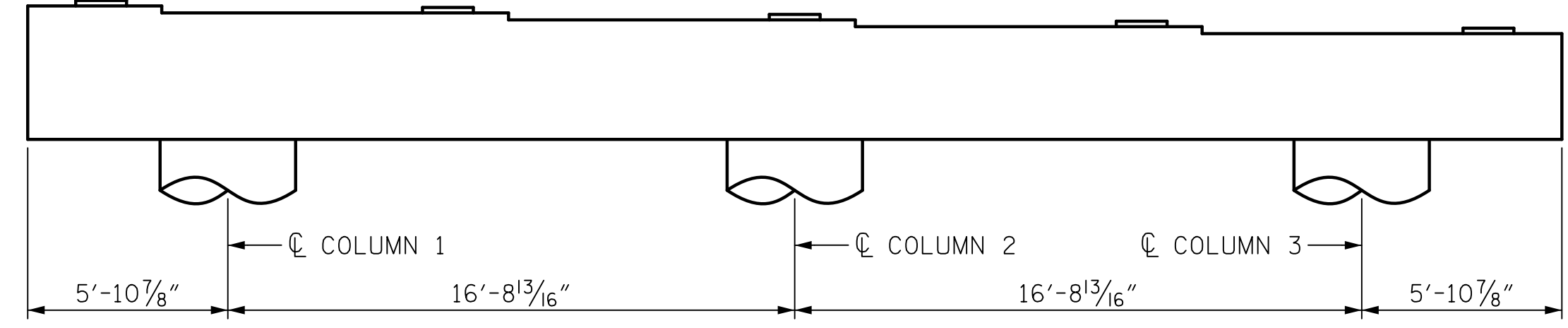

SOUTH FACE

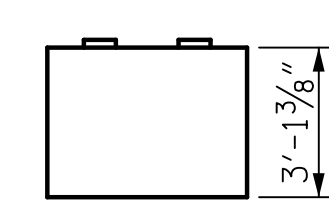

EAST FACE

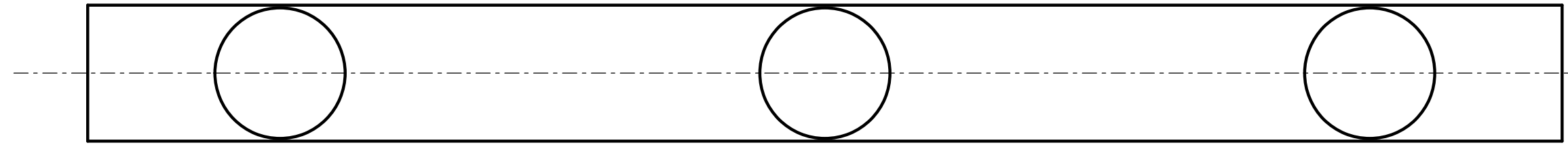

SOFFIT

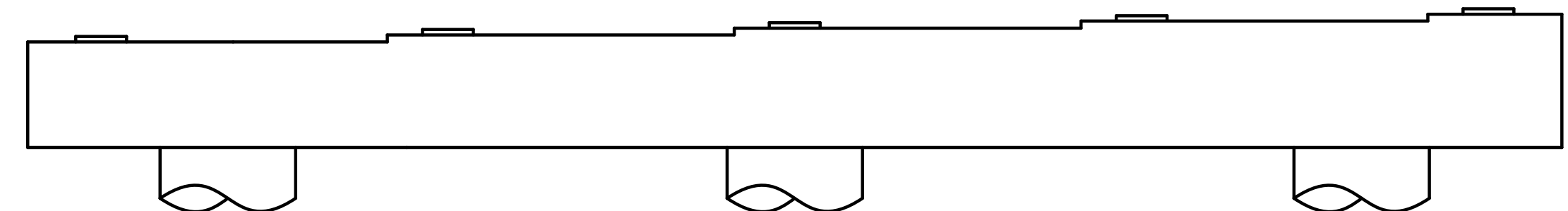

NORTH FACE  
BENT CAP

PROJECT NO. U-5748  
WAKE COUNTY  
STATION: 24+88.00 -L-

**AECOM**  
AECOM TECHNICAL SERVICES OF NC, INC.  
5438 WADE PARK BOULEVARD, SUITE 200  
RALEIGH, NC 27607  
(919) 854-6200 www.aecom.com  
AECOM License No. F-0342

**PROFESSIONAL SEAL**  
GREGORY R. COLS  
ENGINEER  
041343  
2/10/2023

STATE OF NORTH CAROLINA  
**DEPARTMENT OF TRANSPORTATION**  
RALEIGH

PRESERVATION  
**BENT 3**  
**(NORTHBOUND)**

REVISIONS					
NO.	BY:	DATE:	NO.	BY:	DATE:
1			3		
2			4		

SHEET NO. S1-59  
TOTAL SHEETS 119

DOCUMENT NOT CONSIDERED FINAL UNLESS ALL SIGNATURES COMPLETED

DATE: 2/9/2023 TIME: 12:44:27 PM  
USER: gcolson-pw\gcolson@aecom.com\gcolson D:\2020\Documents\60609754-U-5748 Ugon\_MIT1900-CAD GIS\910\_CAD\YD\_MCDOT\_TIP\Structures\04 Drawings\401\JIS\_U-5748\_SML\BT-3R\_S1-59.dwg