

PROJ. REFERENCE NO.	SHEET NO.
U-5748	TMP-16

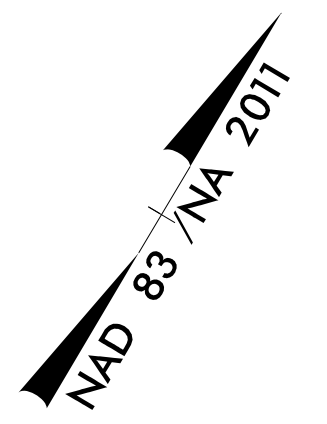

DRUMS AT 100' SPACING SET AS NEEDED FOR TEMPORARY LANE CLOSURES AND ALONG SHOULDER WHEN ALL LANES ARE OPEN

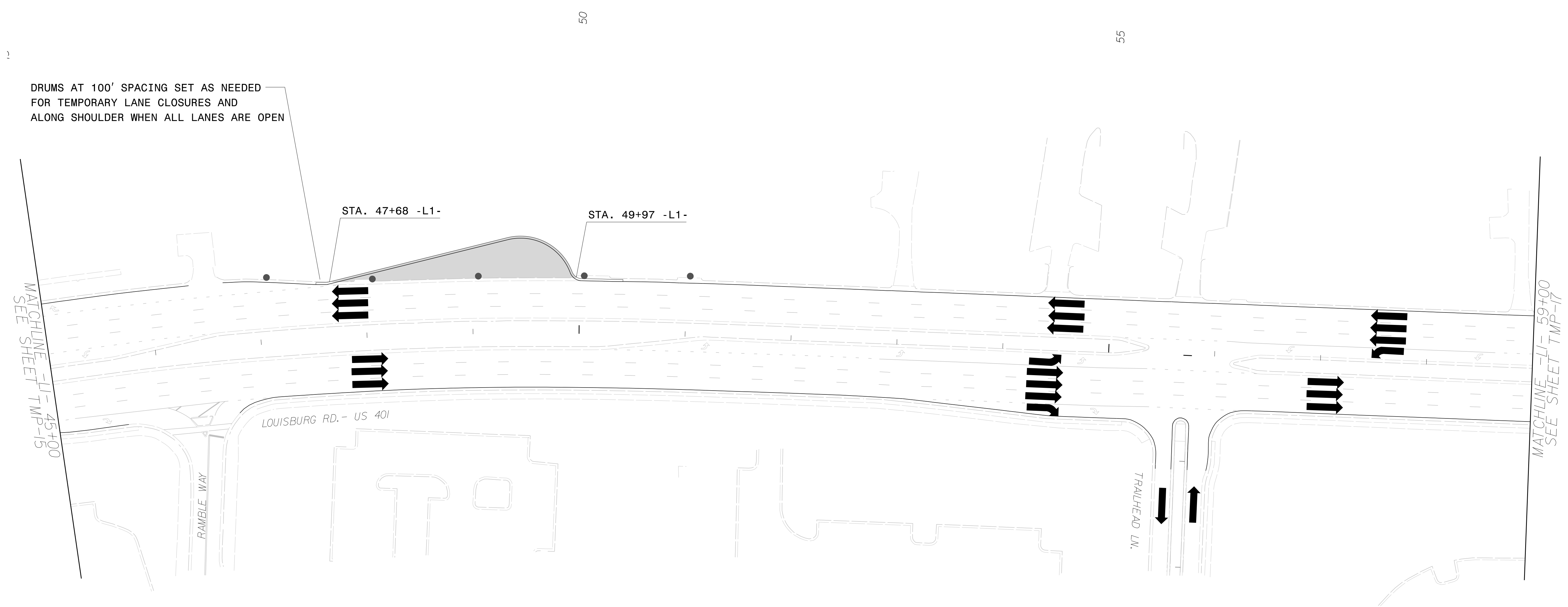

NOTE: ALL PAVEMENT MARKINGS ARE EXISTING

1/9/2023  
 pw:\aecom-na-pw.bentley.com\AECOM\_DS2\NA\_2020\Documents\60609754-U-5748 Ligon Mill\900-CAD Ligon Mill\900-CAD 615\910-CAD\70-NC DOT\_TIP\TrafficControl\TCP\200\_U5748\_fc\_TMP\_16\_PHA.dgn  
 User:rlizabeh.hunter

**AECOM**  
 NC Firm License No.: F-0342  
 5438 Wade Park Boulevard  
 Suite 200 Raleigh, NC 27607  
 Phone: 919-461-1100

APPROVED: \_\_\_\_\_  
 DATE: \_\_\_\_\_

3/7/2023

**DOCUMENT NOT CONSIDERED FINAL  
 UNLESS ALL SIGNATURES COMPLETED**

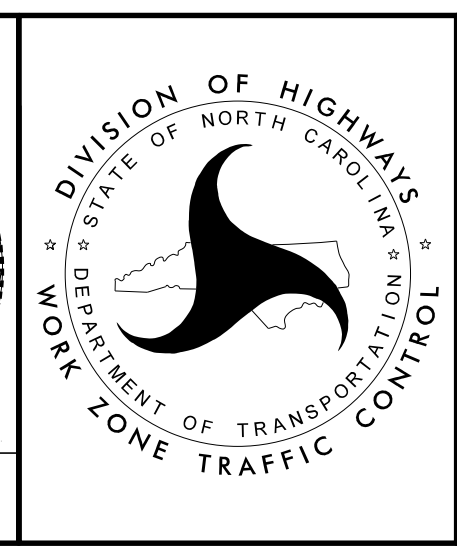

**PHASE I - A  
 DETAIL**