

5/14/99

PROJECT REFERENCE NO. U-5748		SHEET NO. 12	
RW SHEET NO.			
ROADWAY DESIGN ENGINEER	HYDRAULICS ENGINEER		
Prepared in the Office of:		NC FIRM LICENSE No. F-0342 5438 Wade Park Blvd., Suite 200 Raleigh, NC 27607 199461-000	
AECOM			
DOCUMENT NOT CONSIDERED FINAL UNLESS ALL SIGNATURES COMPLETED			

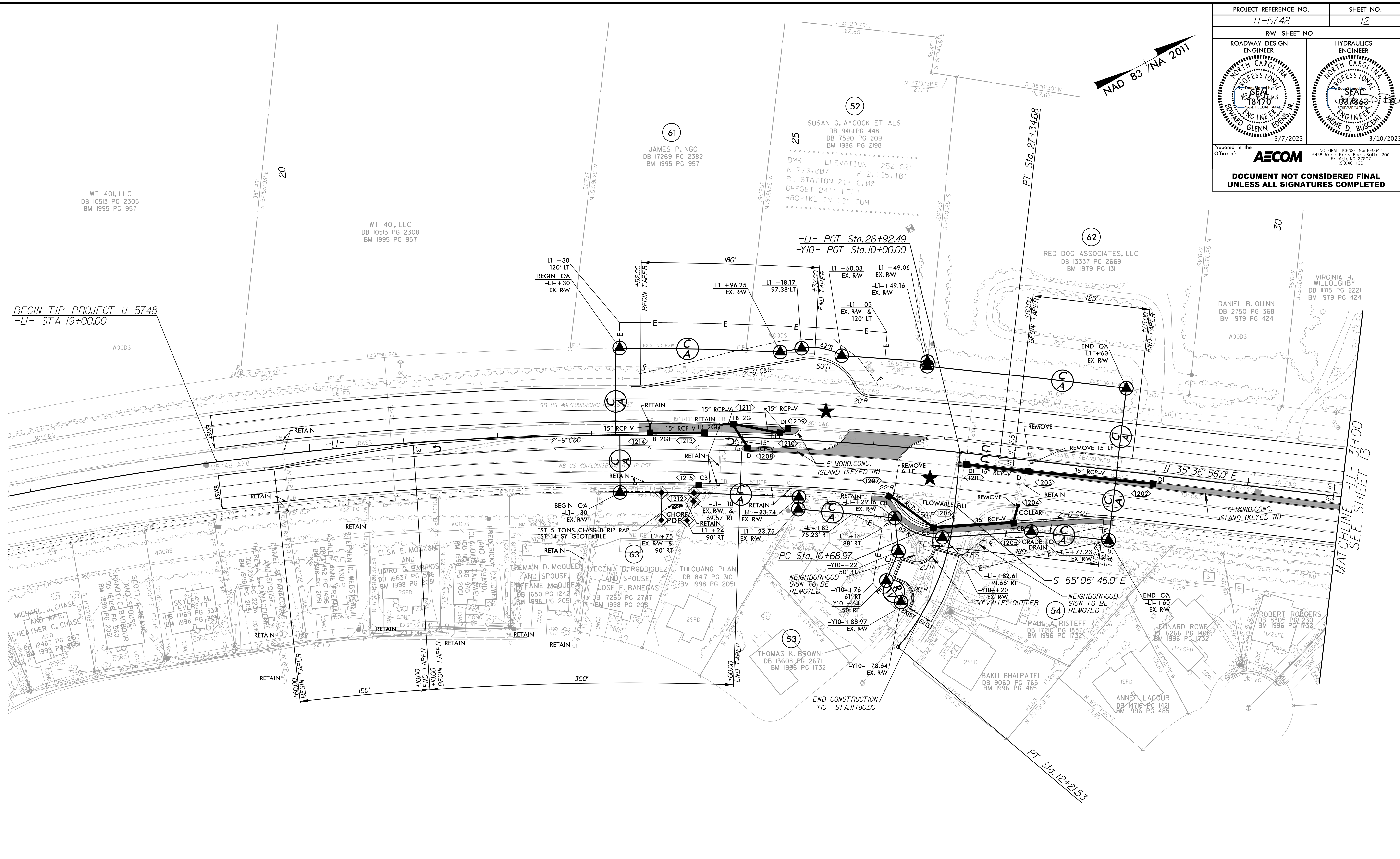

BEGIN TIP PROJECT U-5748
-LI- STA 19+00.00

MATCHLINE - SEE SHEET 13

-LI-	-Y10-
PI Sta 21+32.83	PI Sta 11+47.63
$\Delta = 20^\circ 30' 59.4''$ (RT)	$\Delta = 34^\circ 22' 23.2''$ (RT)
D = 1' 41' 09.6"	D = 22' 31' 50.8"
L = 1216.87'	L = 152.56'
T = 615.02'	T = 78.65'
R = 3,398.32'	R = 254.30'
e = EXIST.	e = EXIST.

★ PROPOSED SIGNAL

FOR -LI- PROFILE, SEE SHEET NO. 28
FOR -Y10- PROFILE, SEE SHEET NO. 31

REVISIONS

2/3/2023 10:57:48_r.dwg_osh12.dgn
patrick.moehrierson