

5/14/99

PROJECT REFERENCE NO. U-5748		SHEET NO. 11	
RW SHEET NO.			
ROADWAY DESIGN ENGINEER		HYDRAULICS ENGINEER	
Prepared in the Office of: AECOM			
NC FIRM LICENSE No. F-0342 5438 Wade Park Blvd., Suite 200 Raleigh, NC 27607 199461-000			
DOCUMENT NOT CONSIDERED FINAL UNLESS ALL SIGNATURES COMPLETED			

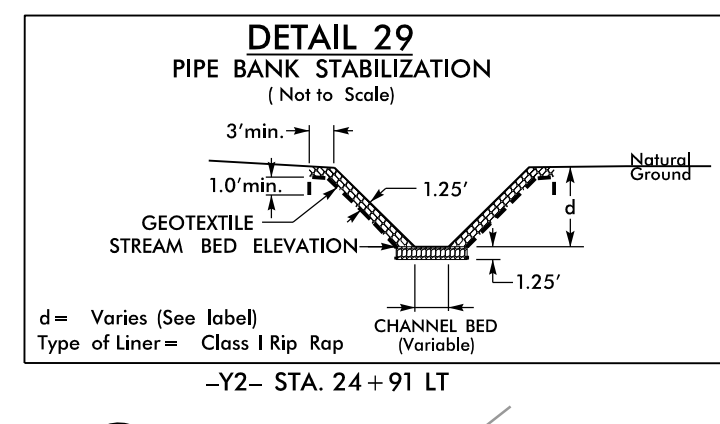
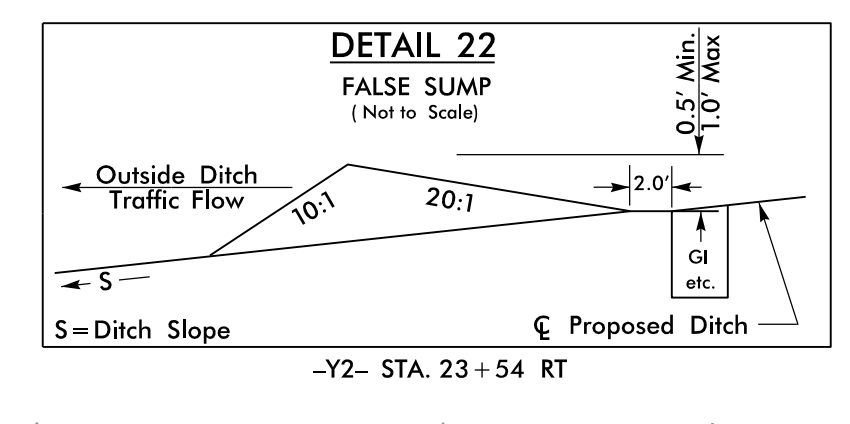
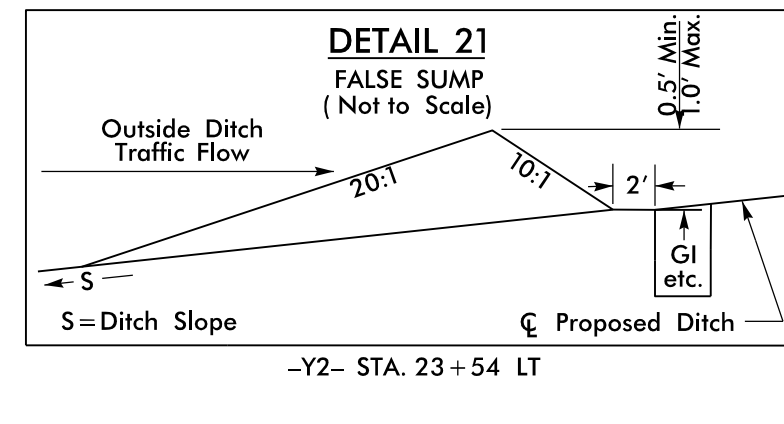
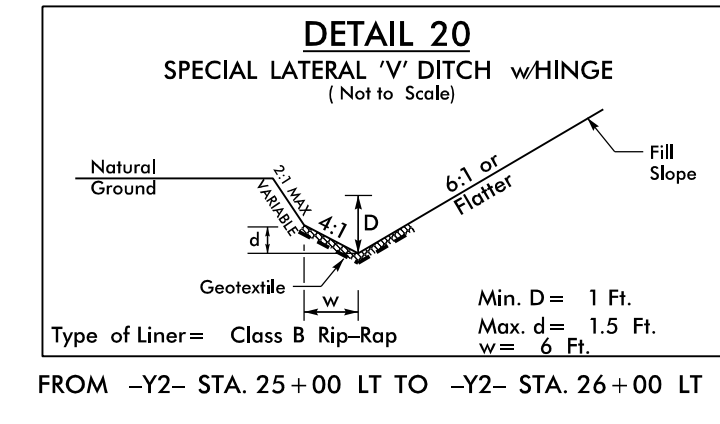
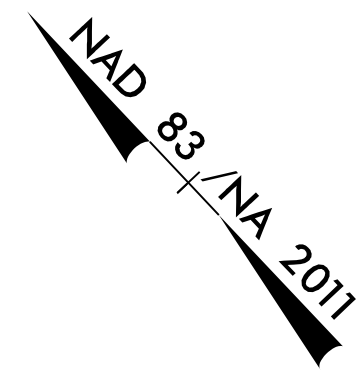

-Y2-

PI Sta 23+94.65	PI Sta 30+82.49
$\Delta = 96^{\circ}27'59.2''$ (LT)	$\Delta = 27^{\circ}14'39.9''$ (RT)
D = 6'52" 41.7"	D = 6'21" 58.3"
L = 1,402.49'	L = 427.95'
T = 932.75'	T = 218.10'
R = 833.00'	R = 900.00'
e = 0.06 FT/FT	e = 0.06 FT/FT
R.O. = 252'	R.O. = 252'

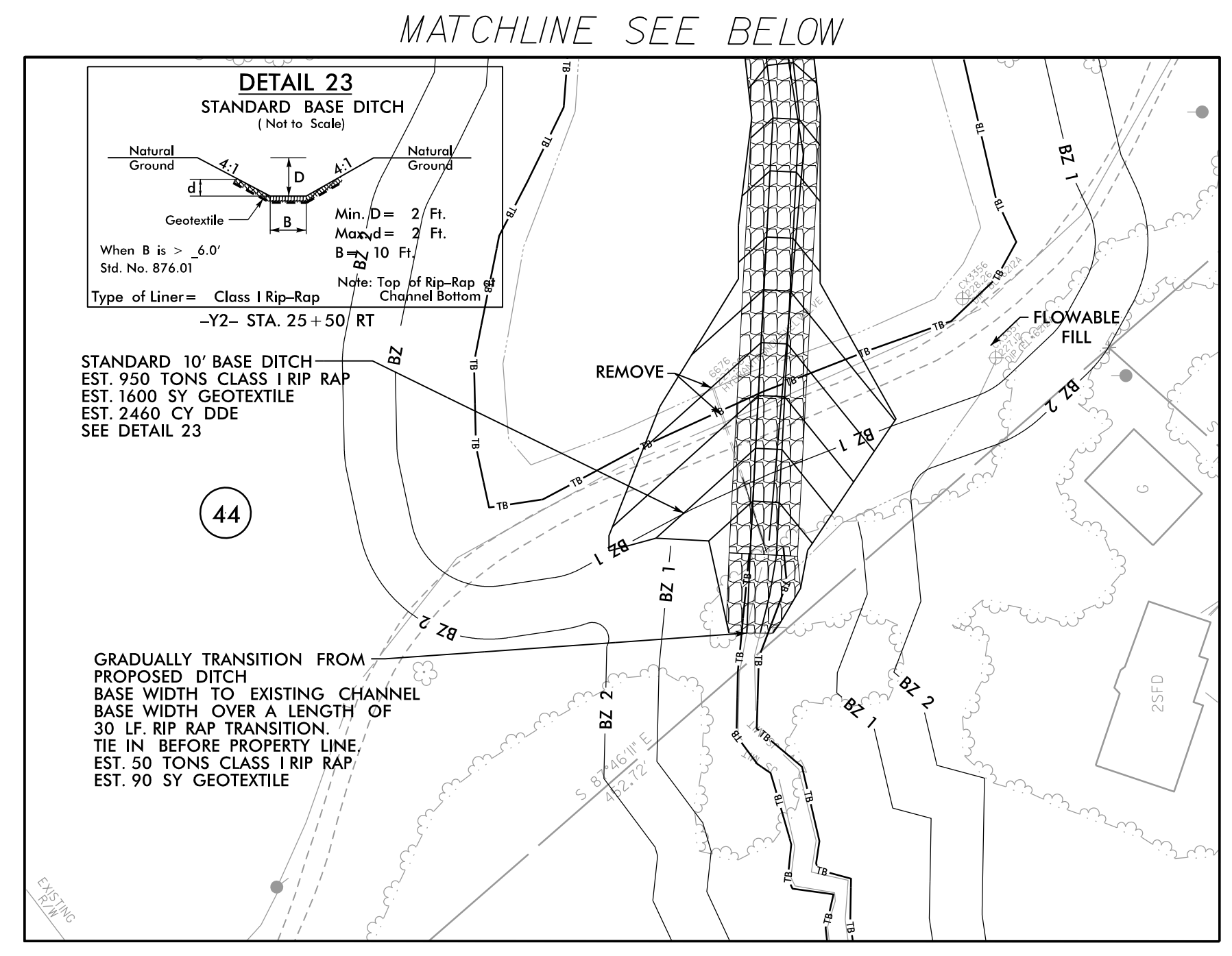
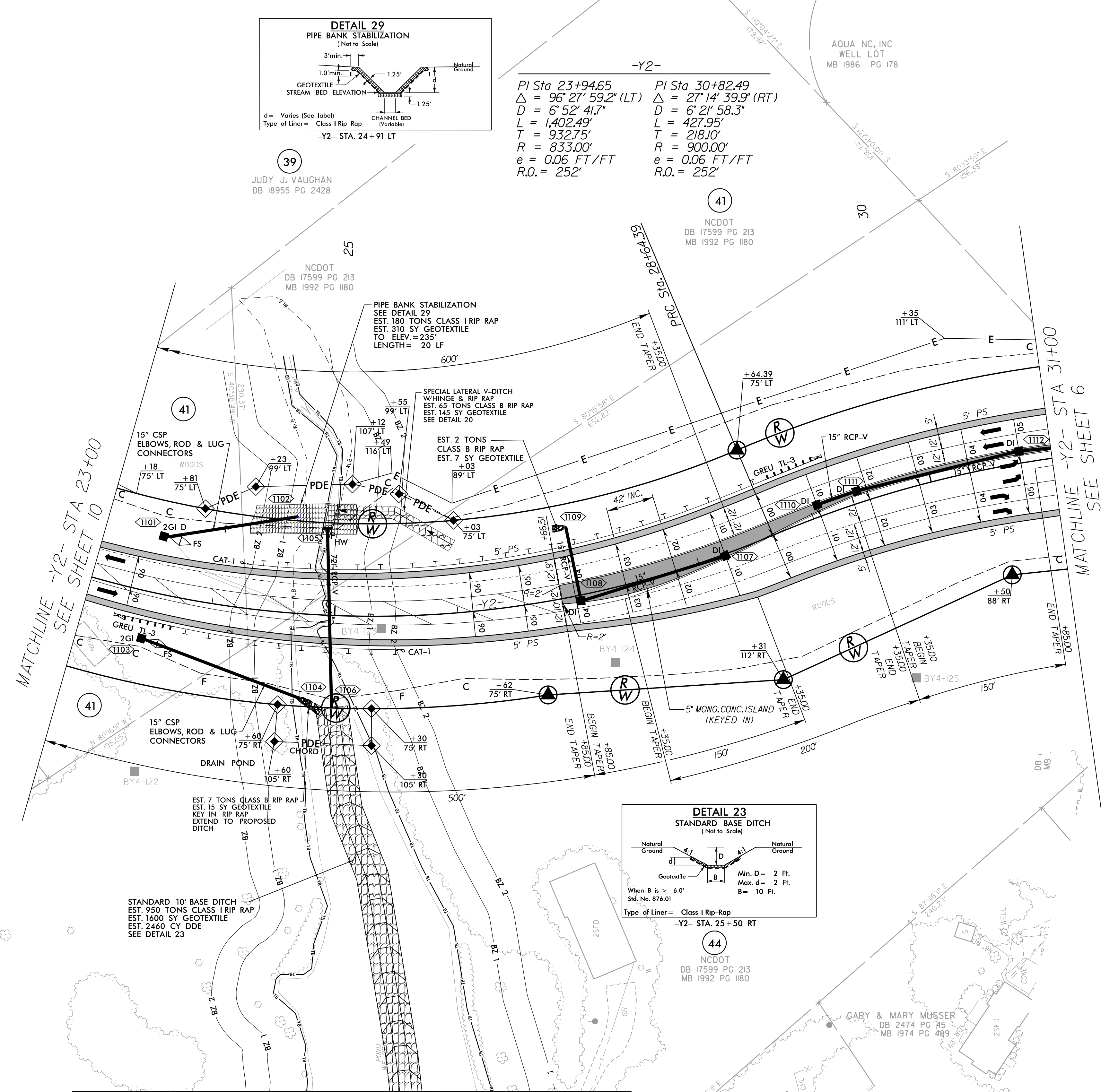

REVISIONS

2/3/2023 10:57:48_rdy_psh1.dgn
pattick.mohersob

BY4-I21

SEE INSET (THIS SHEET)

FOR -Y2- PROFILE, SEE SHEET NO. 23