

SPALLED, DELAMINATED OR CRACKED CONCRETE (REMOVE UNTIL SOUND CONCRETE IS FOUND AND 1" MIN. BEHIND ANY EXPOSED REBAR (TYP.))

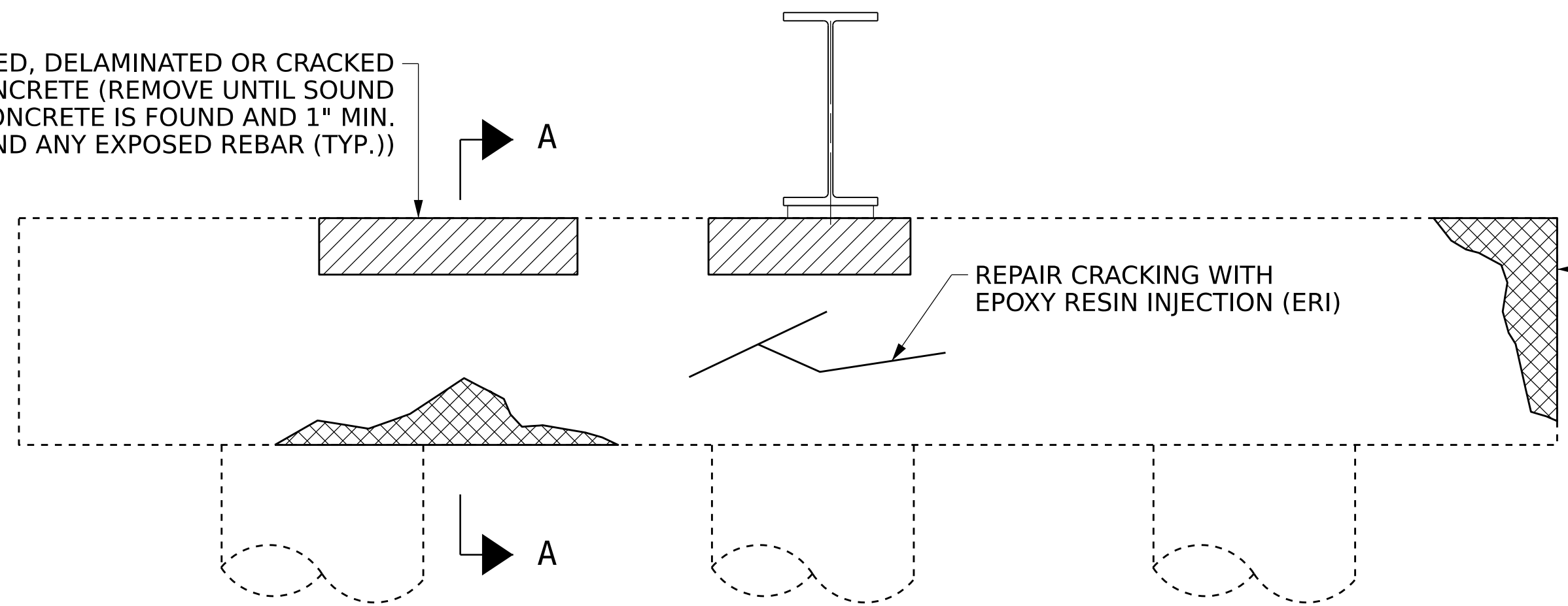

CAP REPAIRS

REPAIR CRACKING WITH EPOXY RESIN INJECTION (ERI)

REPAIR ALL SPALLED, DELAMINATED OR CRACKED CONCRETE AREAS NOT OCCURRING AT BEAM BEARING AREAS PER PLANS AND PER THE ENGINEER USING SHOTCRETE REPAIRS OR CONCRETE REPAIRS (SEE NOTES)

NOTES:

1. WORK THIS SHEET WITH REPAIR METHODS AND CONCRETE REPAIR NOTES IN "CONCRETE RESTORATION DETAILS" SHEET 1.
2. TYPICAL BENT CAP REPAIRS ARE SHOWN IN THIS SHEET. REPAIR DETAILS SIMILAR FOR END BENT CAPS.
3. THE METHOD USED TO DELINEATE THE AREAS OF UNSOUND CONCRETE TO BE REPAIRED SHALL NOT PERMANENTLY MARK THE CONCRETE, LEAVE ANY RESIDUE AFTER REMOVAL, OR REQUIRE HARSH CHEMICALS TO REMOVE.
4. THE CONTRACTOR SHALL REMOVE THE DETERIORATED CONCRETE IN ACCORDANCE WITH THE GUIDELINES SET IN THESE NOTES, IN THE SPECIAL PROVISIONS, AND THE STANDARD SPECIFICATIONS.
5. REMOVE UNSOUND CONCRETE TO THE EXTENT NECESSARY, A MINIMUM OF 1" BEHIND REBAR AND MINIMUM CLEARANCE OF 2" TO SAWCUT.
6. REINFORCING STEEL WHICH IS DETERMINED BY THE ENGINEER TO BE REPLACED, SHALL BE REMOVED TO A POINT WHERE IT IS SOUND. THE PATCH SHALL EXTEND A SUFFICIENT DISTANCE BEYOND THIS POINT TO DEVELOP A SPLICE LENGTH SPECIFIED IN THE TABLE ON THIS SHEET.
7. IF ANY AREA IS DETERMINED TO BE UNSTABLE DURING THE REPAIR PROCESS AS DETERMINED BY THE ENGINEER, STOP THE CURRENT REPAIR PROCEDURE, SHORE THE AREA AND PERFORM A "FORM AND POUR" CONCRETE REPAIR.
8. NO MORE THAN 1/3 OF THE CAP OR PILE CROSS SECTIONAL AREA SHALL BE REMOVED AT ONE TIME. SHOULD IT BECOME NECESSARY TO REMOVE MORE THAN 30% OF THE CROSS SECTIONAL AREA, NOTIFY THE ENGINEER PRIOR TO PROCEEDING.
9. SIMULTANEOUS REMOVAL OF UNSOUND CONCRETE MAY BE PERMITTED ON MORE THAN ONE FACE OF A CAP AND/OR PILE, BUT NO MORE THAN 1/3 OF THE CIRCUMFERENCE SHALL BE REMOVED AT A TIME. IF REMOVAL EXTENDS MORE THAN 1-1/2" BEHIND THE MAIN REINFORCING BARS. NOTIFY THE ENGINEER PRIOR TO PROCEEDING.
10. FOR SUBSTRUCTURE REPAIRS, SEE "SUBSTRUCTURE REPAIRS" SHEETS.

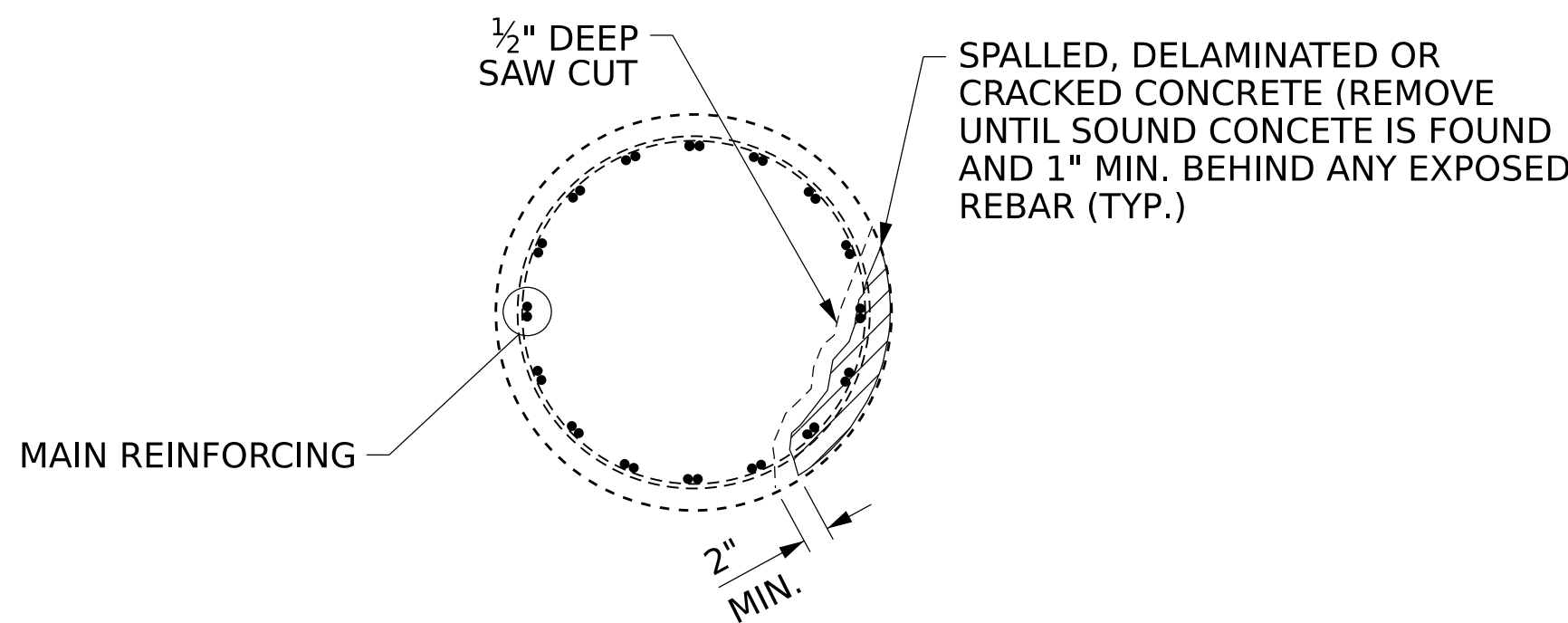

PLAN OF CIRCULAR COLUMN

EXPOSED REBAR TO BE BLAST CLEANED (TYP.)

1/2" DEEP SAW CUT (TYP.)

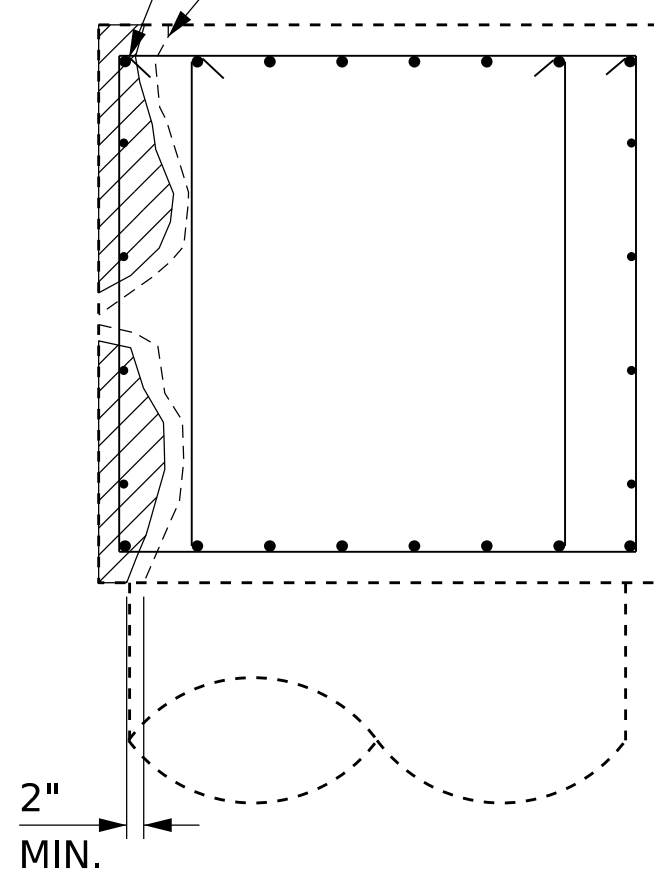

SECTION A-A

BENT CAP REPAIRS

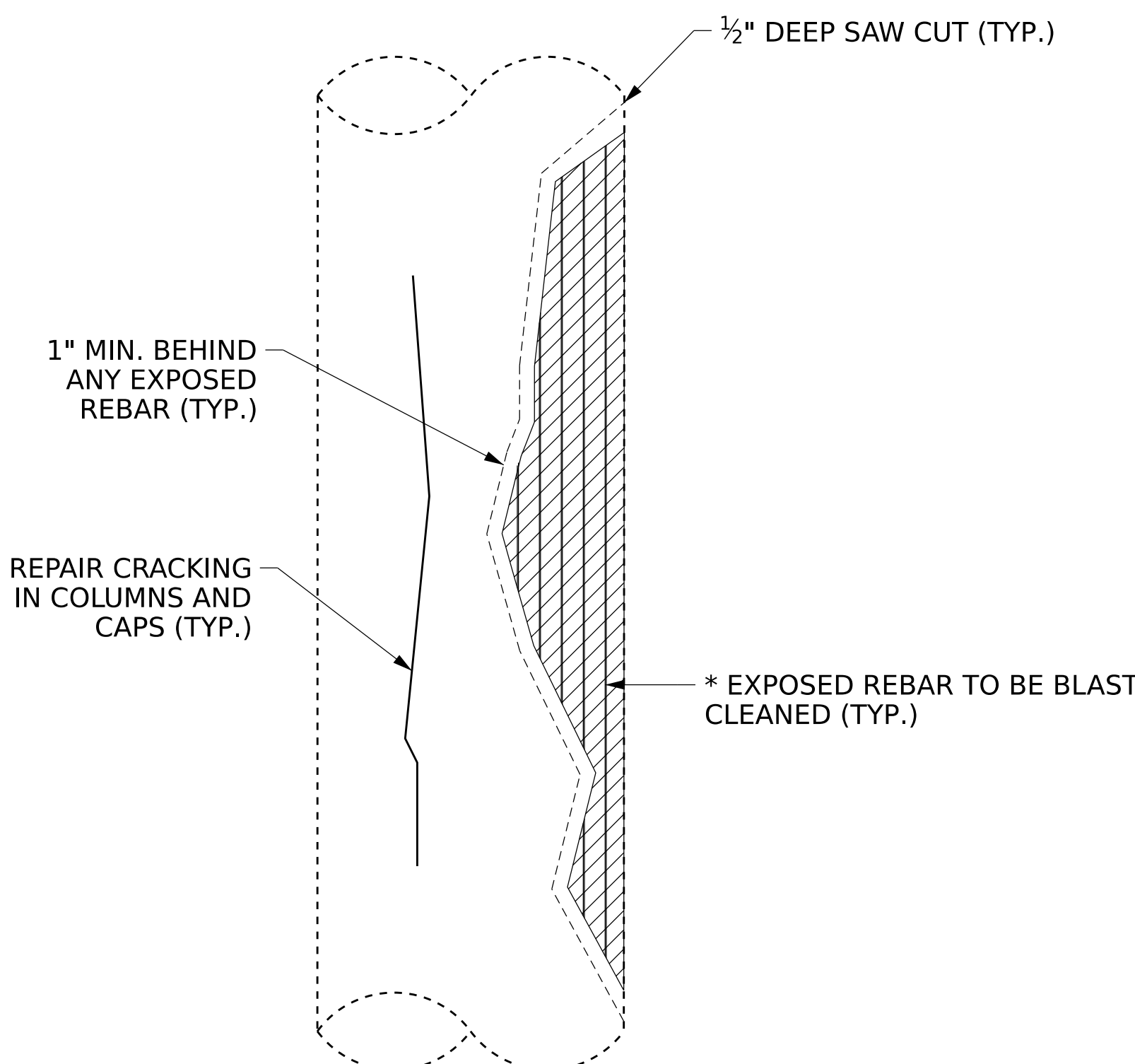

ELEVATION OF COLUMN

* REPAIR LENGTH SHALL NOT EXCEED 10 VERTICAL FEET AT ONCE OR 1/2 COLUMN DIAMETERS

COLUMN REPAIRS

LEGEND	
	CONCRETE REPAIR AREA
	SHOTCRETE REPAIR AREA
	EPOXY RESIN INJECTION (ERI)

BRIDGES: 640044, 640045, 640058, 640059

PROJECT NO. I-6039

NEW HANOVER COUNTY

BRIDGE NO. MULTIPLE

SHEET 2 OF 2

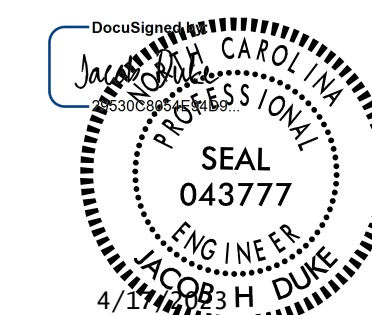

STATE OF NORTH CAROLINA
DEPARTMENT OF TRANSPORTATION
RALEIGH

**CONCRETE RESTORATION DETAILS
SUBSTRUCTURE**

REVISIONS

NO.	BY:	DATE:	NO.	BY:	DATE:	SHEET NO.
1			3			S7
2			4			

DOCUMENT NOT CONSIDERED FINAL
UNLESS ALL SIGNATURES COMPLETED

301 FAYETTEVILLE ST., SUITE 1500
RALEIGH, NC 27601 (919) 992-7839
NC FIRM LICENSE: C-1506

DRAWN BY : JASON M. DEBONE DATE : 01/2023
CHECKED BY : ALLEN J. MCSWAIN DATE : 01/2023
DESIGN ENGINEER OF RECORD: JACOB H. DUKE DATE : 01/2023

4/17/2023
I6039_SMU_CR02.dgn
jduke

PRELIMINARY PLANS
DO NOT USE FOR CONSTRUCTION