

PRELIMINARY PLANS
DO NOT USE FOR CONSTRUCTION

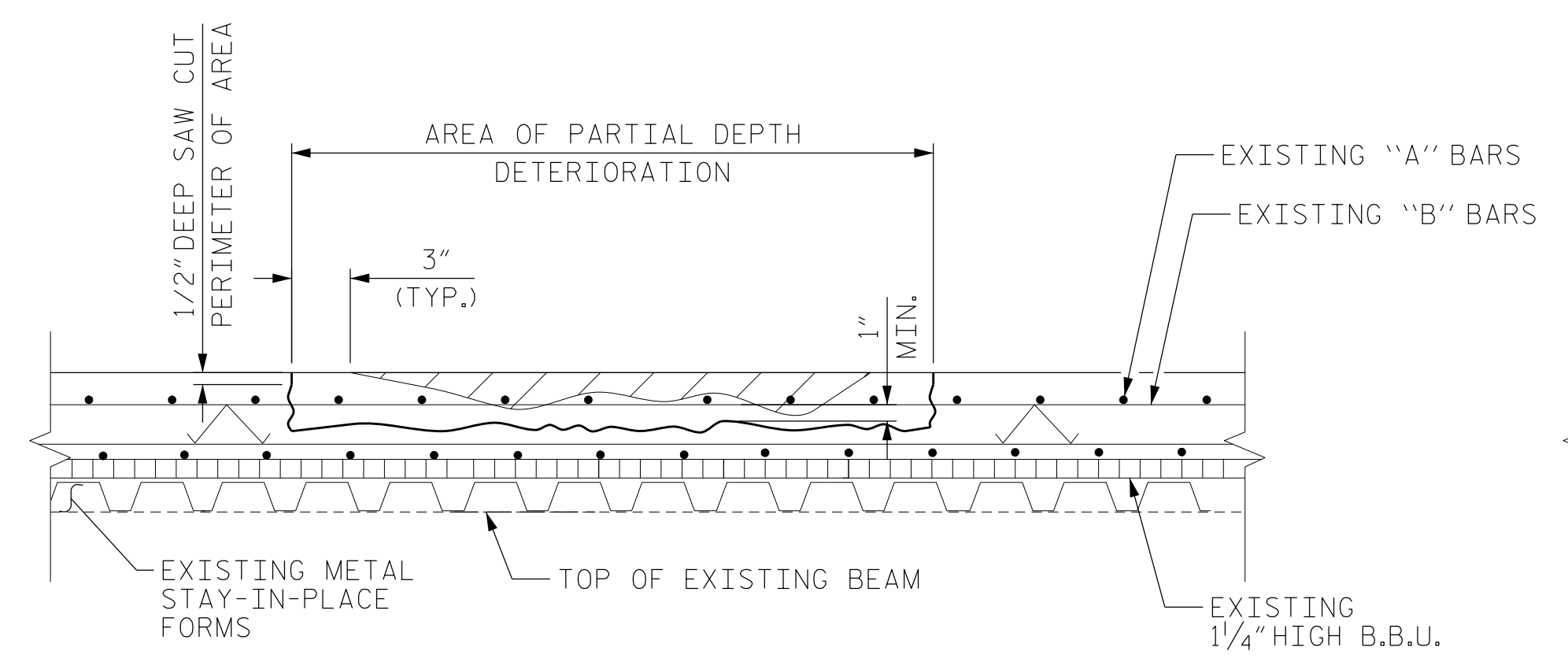

CLASS II (PARTIAL DEPTH) REPAIR

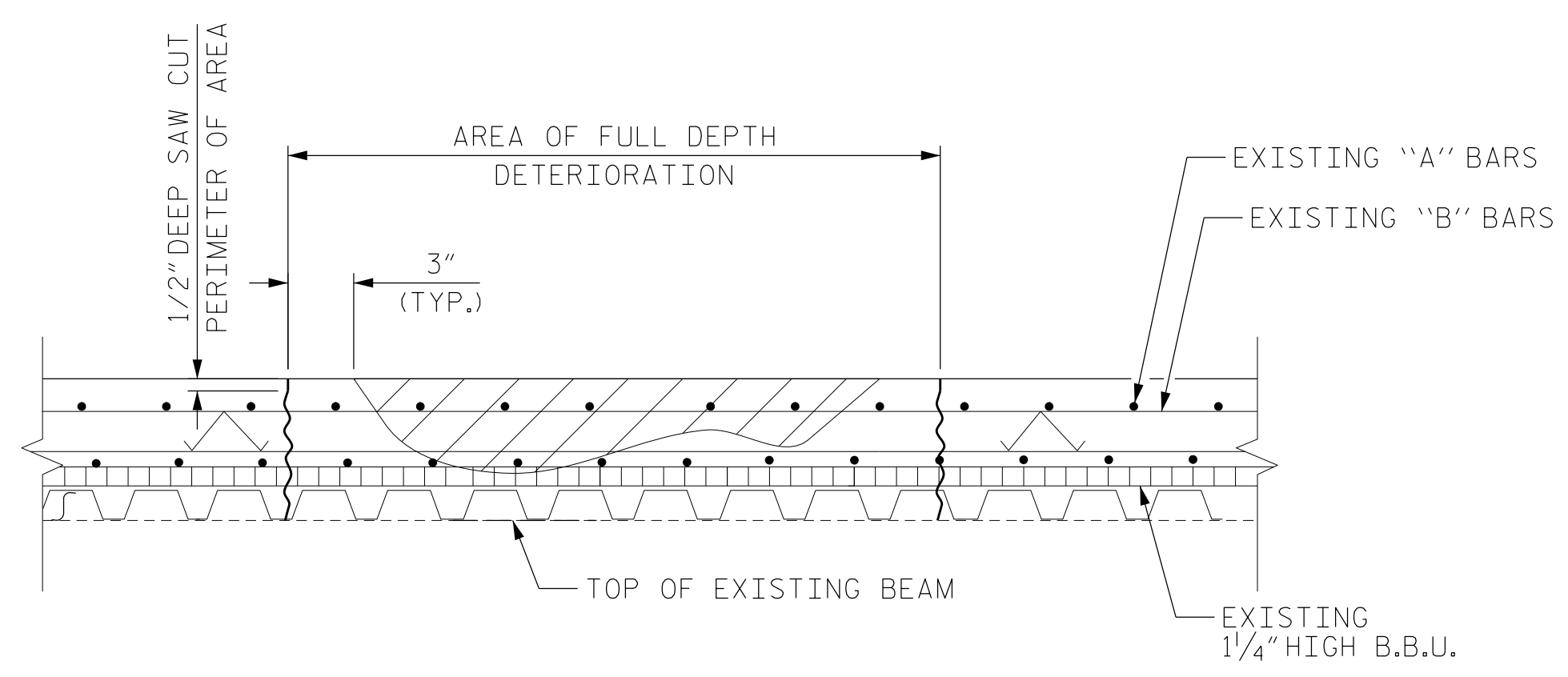

CLASS III (FULL DEPTH) REPAIR

NOTES

FOR AREAS TO BE REPAIRED, SEE "PLAN OF SPAN" SHEETS.

ALL DECK REPAIRS SHALL BE COMPLETED PRIOR TO PLACEMENT OF OVERLAY.

FOR CLASS II AND CLASS III SURFACE PREPARATION, SEE "OVERLAY SURFACE PREPARATIONS" SPECIAL PROVISION.

FOR CONCRETE FOR DECK REPAIR, SEE SPECIAL PROVISIONS.

FOR SHOTCRETE REPAIR, SEE SPECIAL PROVISIONS.

THE CONTRACTOR SHALL SUBMIT WORKING DRAWINGS TO THE ENGINEER FOR APPROVAL PRIOR TO STARTING WORK FOR TEMPORARY FORMWORK. FOR SUBMITTALS OF WORKING DRAWINGS, SEE SPECIAL PROVISIONS.

UPON REMOVAL OF TEMPORARY FORMWORK, ALL VOIDS AND HONEYCOMBS ON THE UNDERSIDE OF DECK SURFACE SHALL BE FILLED WITH THE SAME MATERIAL AS USED FOR THE PATCH, AND FINISHED TO CONFORM TO THE SURROUNDING CONCRETE SURFACE.

NO FORMWORK SHALL BE LEFT IN PLACE.

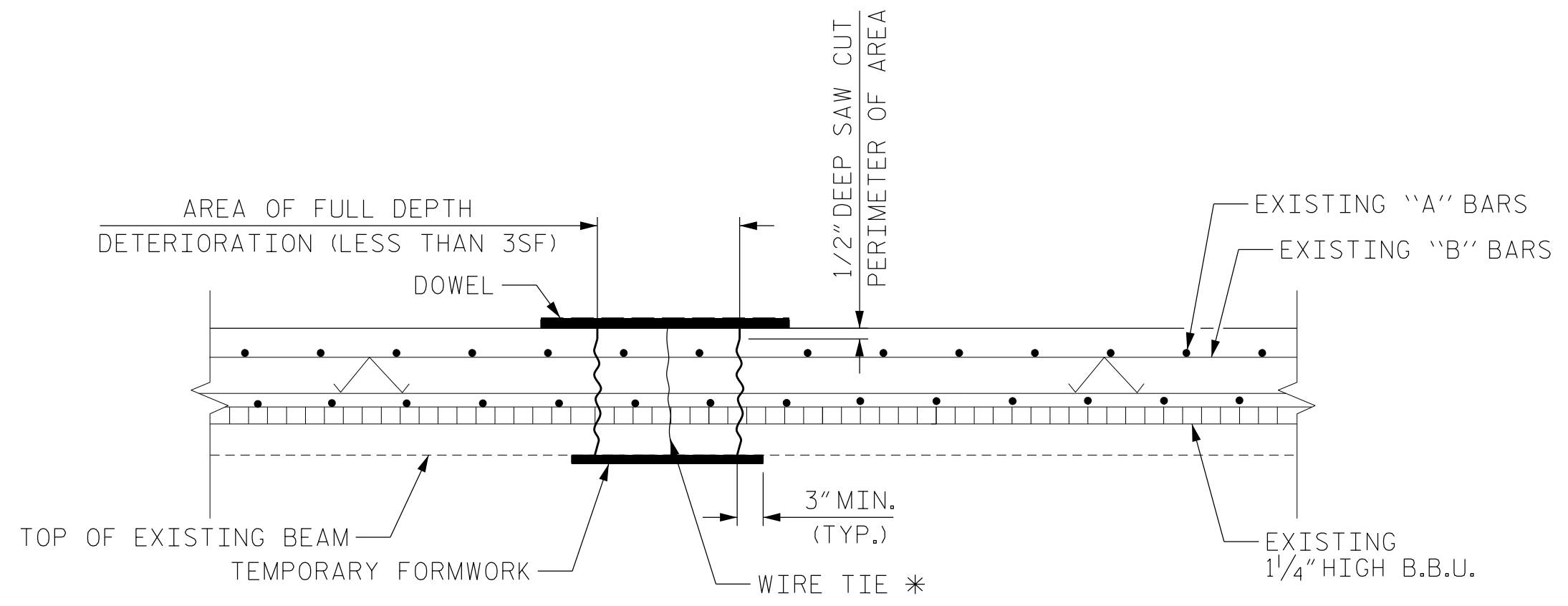

FULL DEPTH REPAIR WITH TEMPORARY FORMWORK

(FOR AREAS OF DETERIORATION EQUAL TO OR LESS THAN 3SF)

* WIRE TIE TO BE KNOTTED BELOW TEMPORARY FORMWORK AND ATTACHED TO DOWEL THAT IS WIDER THAN FORMED FULL DEPTH HOLE. ROTATE DOWEL TO TIGHTEN FORMWORK AGAINST BOTTOM OF DECK.

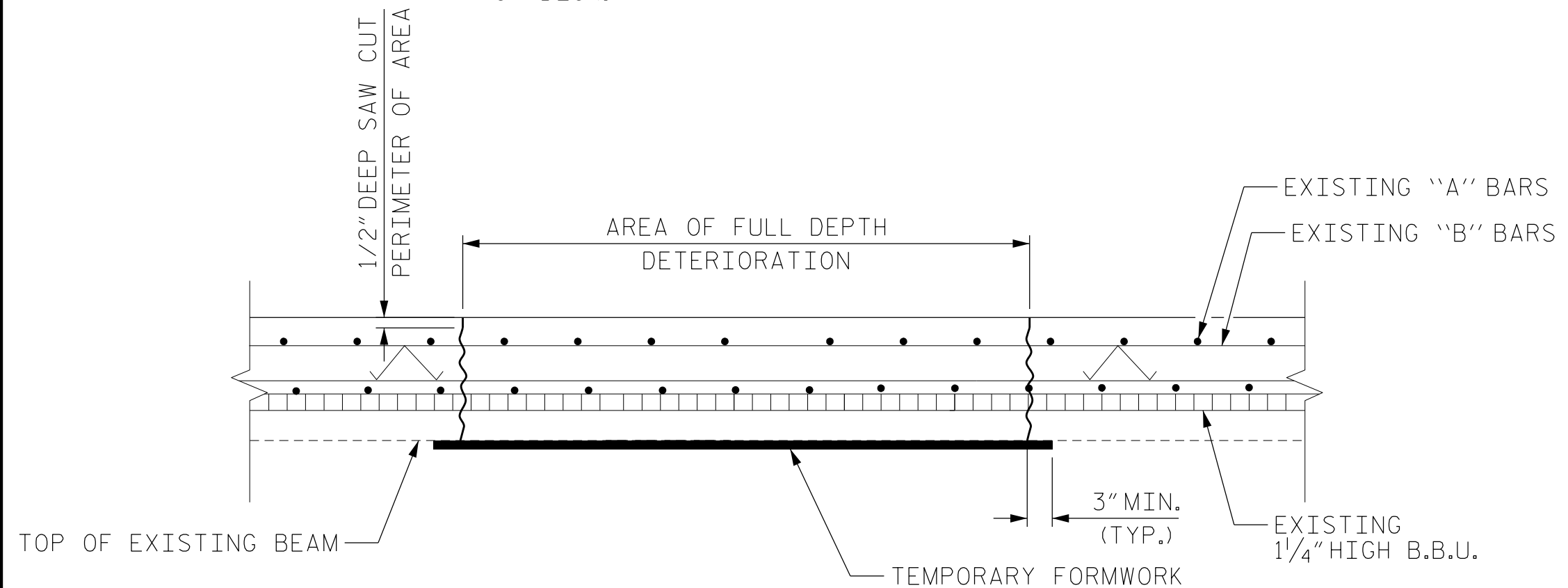

FULL DEPTH REPAIR WITH TEMPORARY FORMWORK

(FOR AREAS OF DETERIORATION GREATER THAN 3SF)

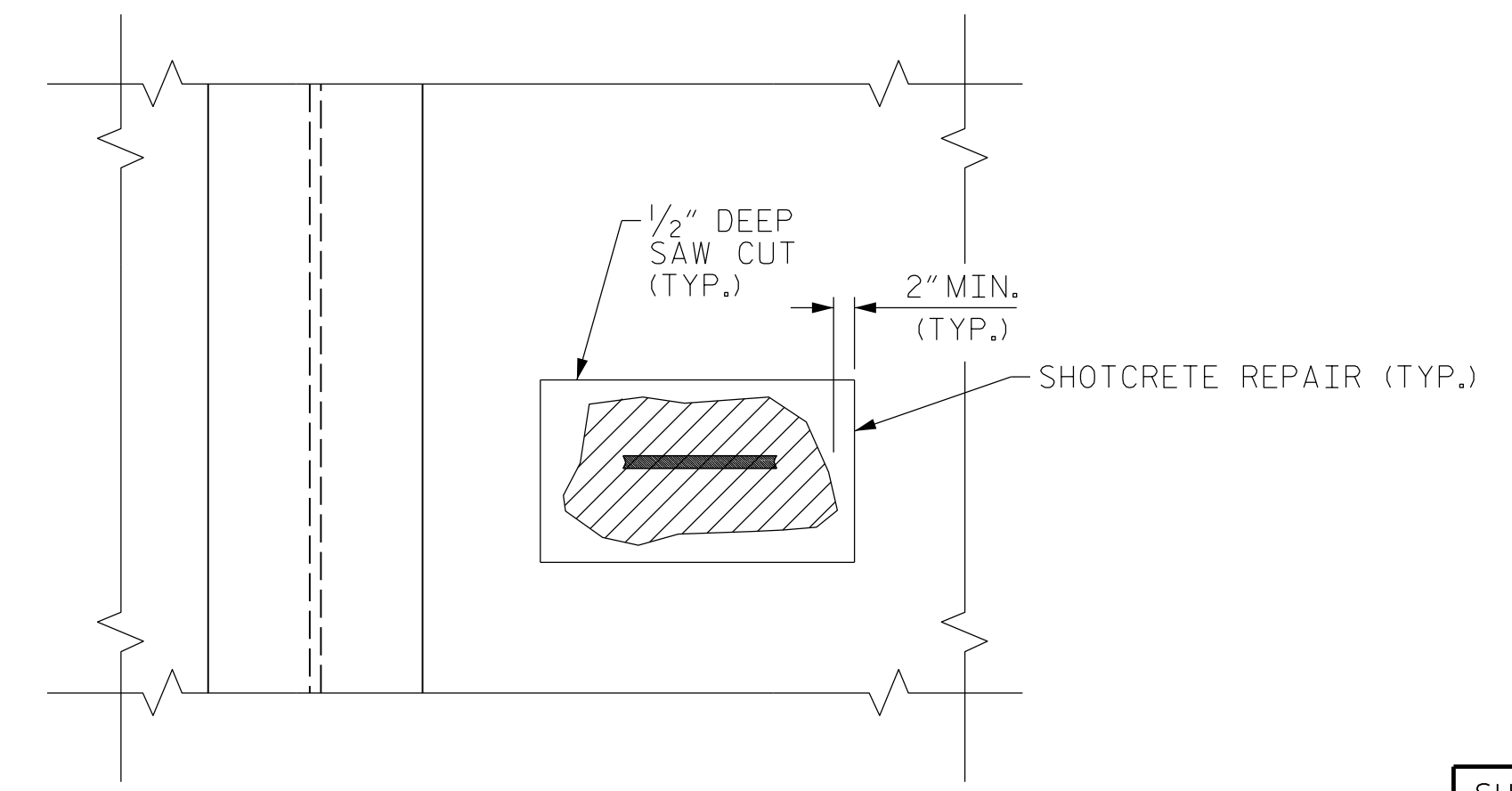

SECTION D-D

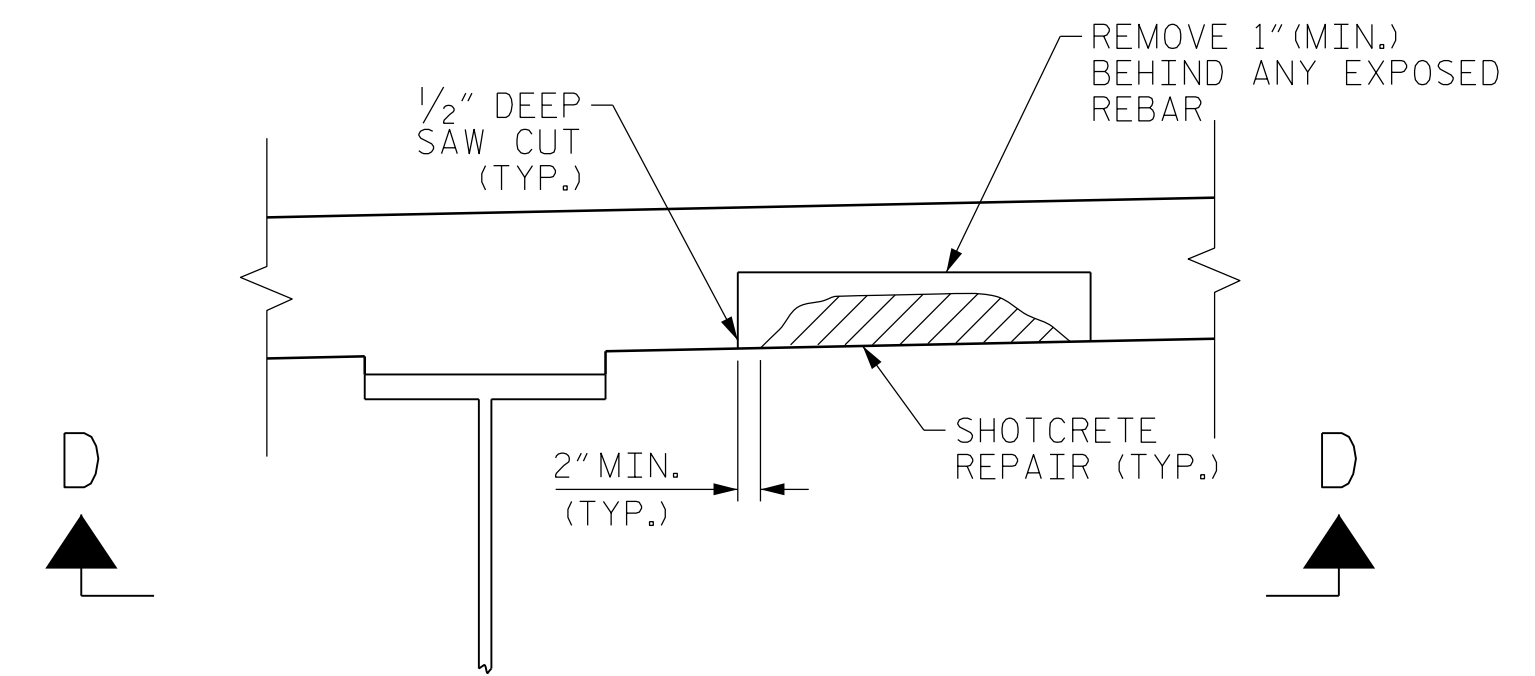

TYPICAL SECTION

UNDERSIDE OF DECK REPAIR

BAR SIZE	SUPERSTRUCTURE EXCEPT APPROACH SLABS, PARAPET AND BARRIER RAIL		APPROACH SLABS		PARAPET AND BARRIER RAIL
	EPOXY COATED	UNCOATED	EPOXY COATED	UNCOATED	
#4	2'-0"	1'-9"	2'-0"	1'-9"	2'-9"
#5	2'-6"	2'-2"	2'-6"	2'-2"	3'-5"
#6	3'-0"	2'-7"	3'-10"	2'-7"	4'-4"
#7	5'-3"	3'-6"			
#8	6'-10"	4'-7"			

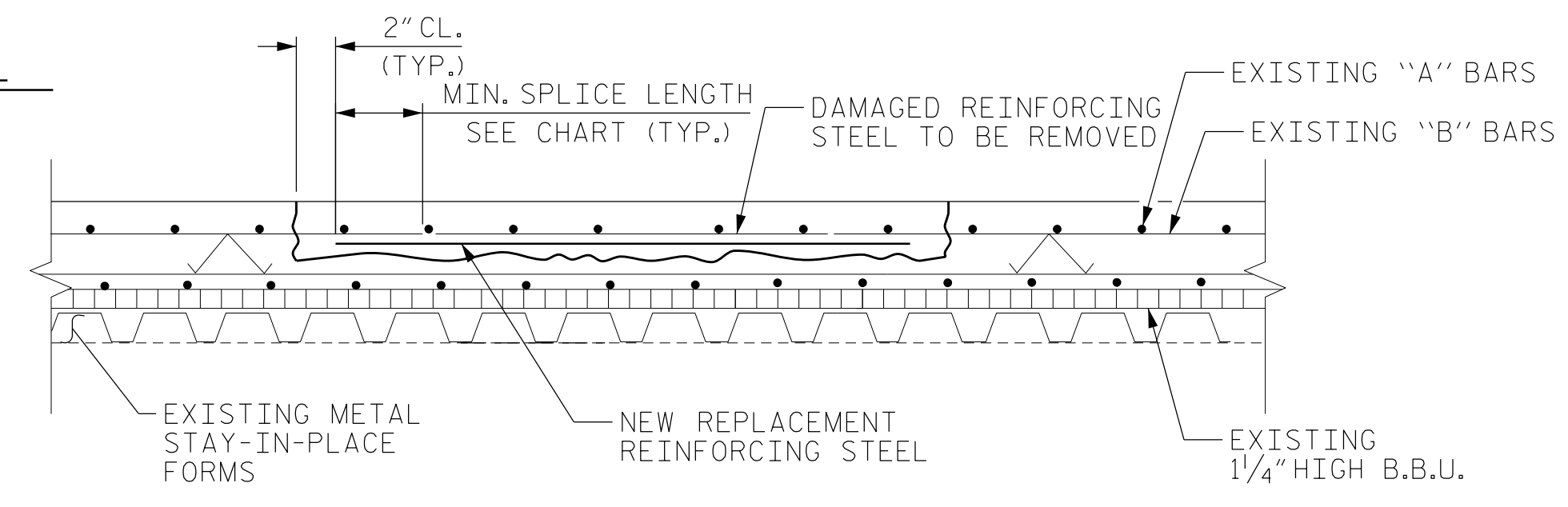

REINFORCING STEEL REPAIR

PROJECT NO. **I-6039**
NEW HANOVER COUNTY
 BRIDGE NO. **MULTIPLE**
 BRIDGES: 640044, 640045, 640058, 640059



STATE OF NORTH CAROLINA
 DEPARTMENT OF TRANSPORTATION
 RALEIGH
STANDARD
DECK REPAIR DETAILS

DRAWN BY : **JASON M. DEBONE** DATE : **01/2023**
 CHECKED BY : **ALLEN J. MCSWAIN** DATE : **01/2023**
 DESIGN ENGINEER OF RECORD: **JACOB H. DUKE** DATE : **01/2023**

4/17/2023
 I6039-SMU.DR001.dgn
 jduke

DOCUMENT NOT CONSIDERED FINAL UNLESS ALL SIGNATURES COMPLETED

301 FAYETTEVILLE ST., SUITE 1500
 RALEIGH, NC 27601 (919) 992-7839
 NC FIRM LICENSE: C-1506

REVISIONS						SHEET NO.
NO.	BY:	DATE:	NO.	BY:	DATE:	
1			3			S5 TOTAL SHEETS
2			4			