

TIP PROJECT: P-5705A

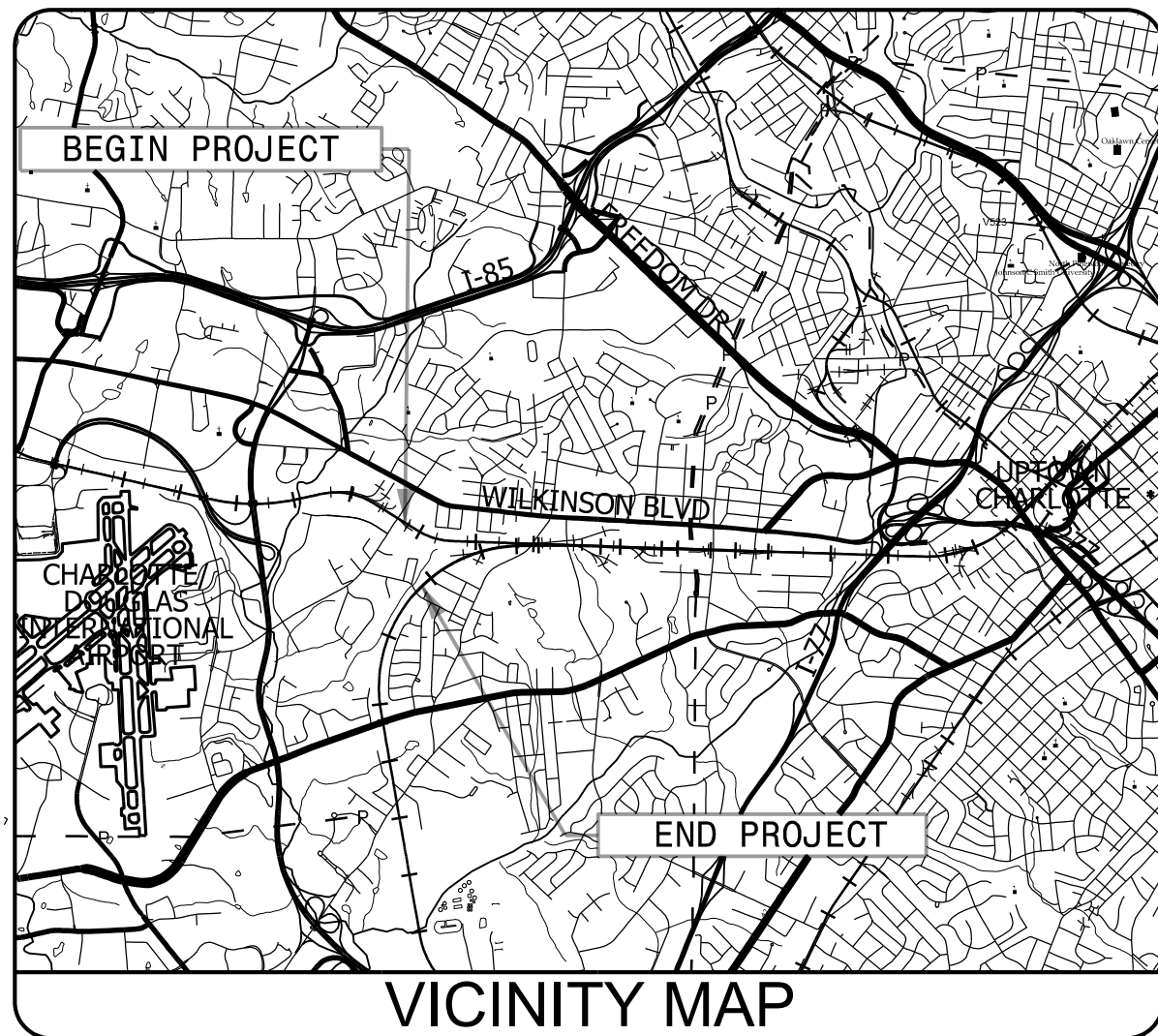

STATE OF NORTH CAROLINA
DIVISION OF HIGHWAYS

UTILITY CONSTRUCTION PLANS
MECKLENBURG COUNTY

LOCATION: CHARLOTTE JUNCTION NS MP 381.4
NS R-LINE MP R-0.3 TO MP R-0.5
TYPE OF WORK: WATER & SEWER RELOCATIONS

T.I.P. NO.	SHEET NO.
P-5705A	UC-1

DOCUMENT NOT CONSIDERED FINAL
UNLESS ALL SIGNATURES COMPLETED

SENSITIVE MATERIALS
DO NOT DUPLICATE

TO CHARLOTTE

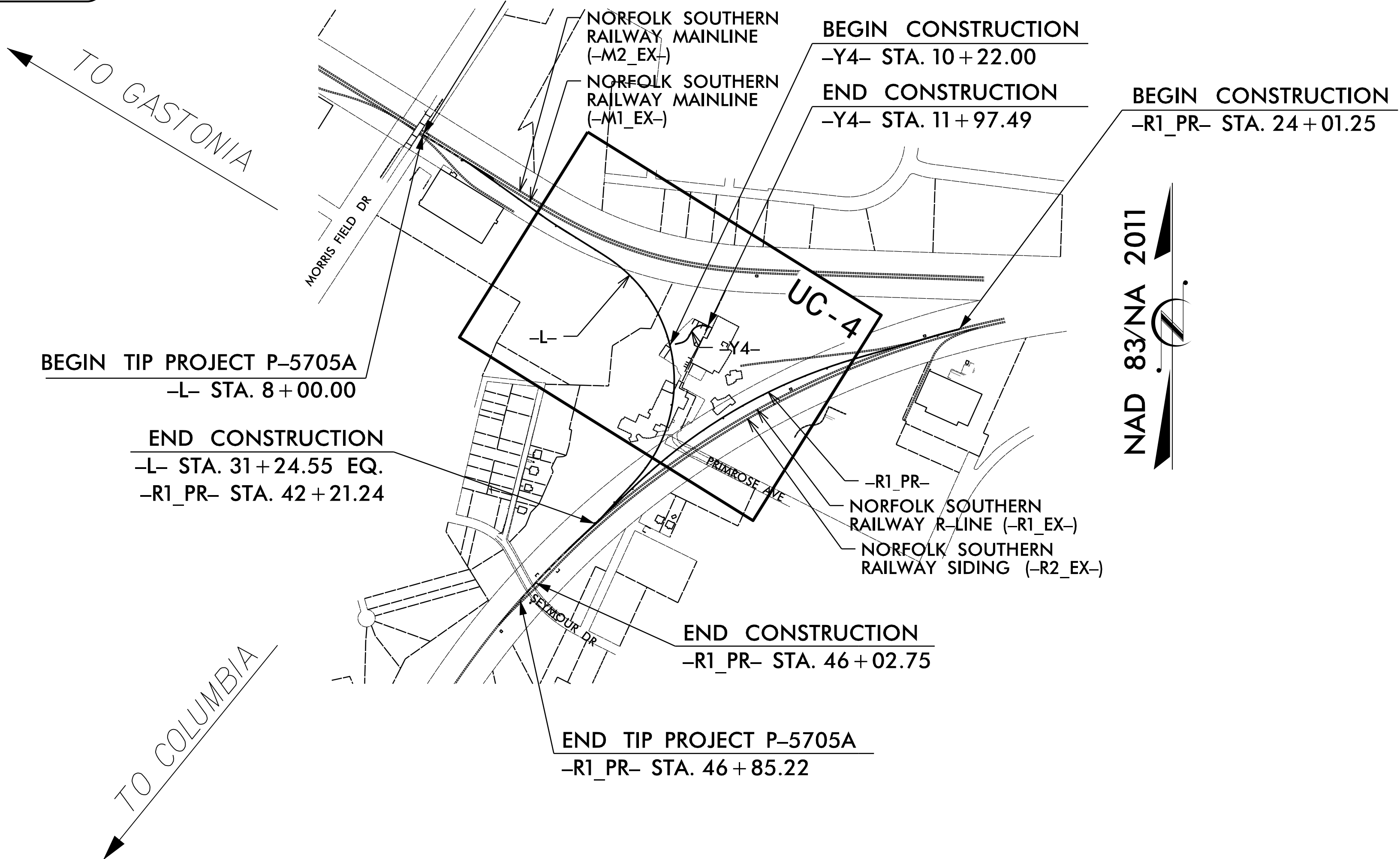

19-OCT-2022 15:22
S:\Server_Files\PROJECTS\2018\201880.00_HNTB_P-5705A\Design\Utilities\Engineering\UC\Proj\5705A_Ut_tsh_UC1.psh.dgn
\$\$\$\$\$USERNAME\$\$\$\$\$

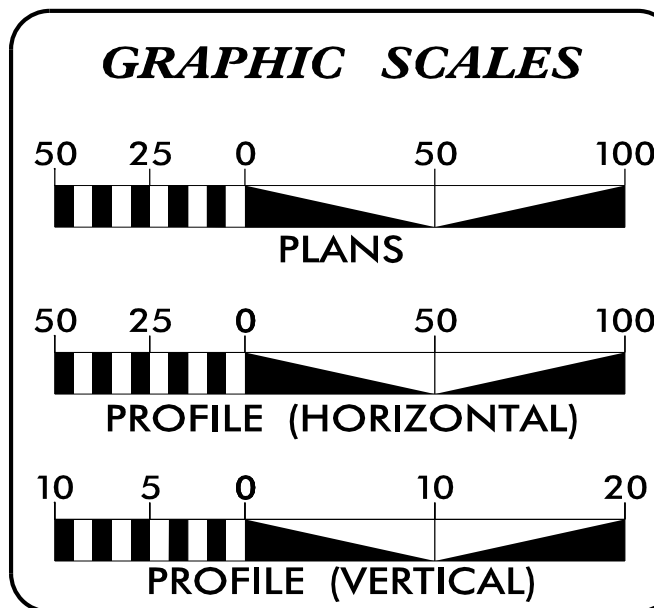

SHEET NO.	DESCRIPTION
UC-1	TITLE SHEET
UC-2	PERMITS
UC-2A	UTILITY SYMBOLOGY
UC-3	NOTES
UC-3A TO 3D	DETAILS
UC-4	UTILITY CONSTRUCTION SHEET
UC-4A	UTILITY CONSTRUCTION PHASING
UC-5	PROFILE SHEET

WATER AND SEWER OWNERS ON PROJECT
(A) WATER - CHARLOTTE WATER
(B) SEWER - CHARLOTTE WATER

PREPARED IN THE OFFICE OF:

401 Harrison Oaks Blvd., Suite 220 Cary, NC 27513
Ph. (919) 653-0001

CLINT L. STEVENS, P.E. UTILITIES PROJECT MANAGER
COREY D. BOUSQUET, P.E. UTILITIES PROJECT ENGINEER
JORDAN K. CHAPMAN UTILITIES PROJECT DESIGNER

SEAL

10/20/2022

NC DEPARTMENT OF TRANSPORTATION
RAIL DIVISION
DESIGN AND CONSTRUCTION