

**TIP PROJECT: P-5705A**

**CONTRACT: C204176**

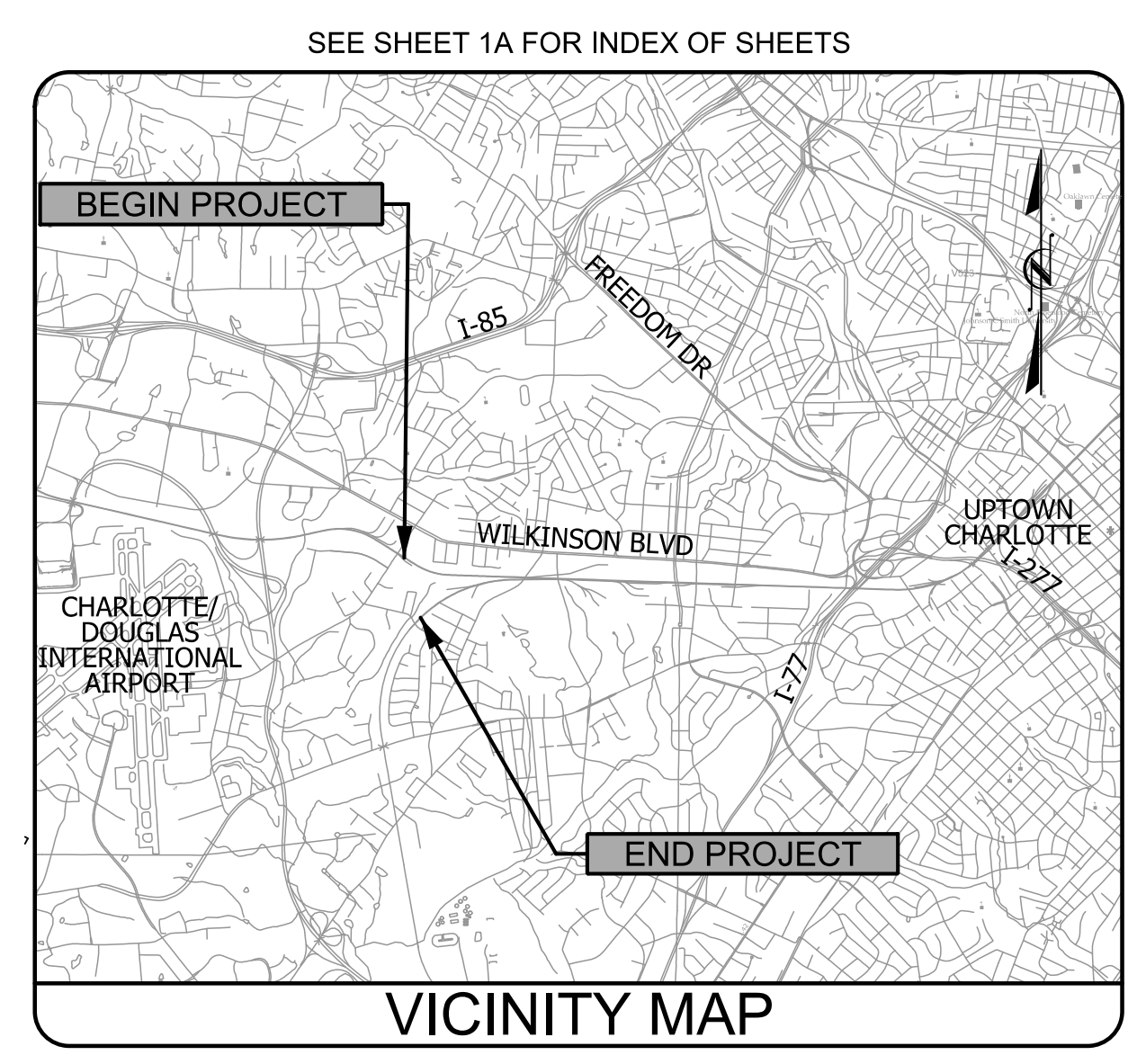

STATE OF NORTH CAROLINA  
RAIL DIVISION

# MECKLENBURG COUNTY

**LOCATION: CHARLOTTE GATEWAY STATION - RAIL (STI)  
WYE CONNECTION TRACK AT CHARLOTTE JUNCTION  
TYPE OF WORK: CULVERT, DRAINAGE, GRADING**

STATE	STATE PROJECT REFERENCE NO.	SHEET NO.	TOTAL SHEETS
N.C.	P-5705A	1	
STATE PROJ. NO.	F.A. PROJ. NO.	DESCRIPTION	
44475.1.1		P.E.	
44475.2.1		ROW / UTIL P.E.	
44475.3.1		CONST./UTIL CONST.	

**DOCUMENT NOT CONSIDERED FINAL  
UNLESS ALL SIGNATURES COMPLETED**

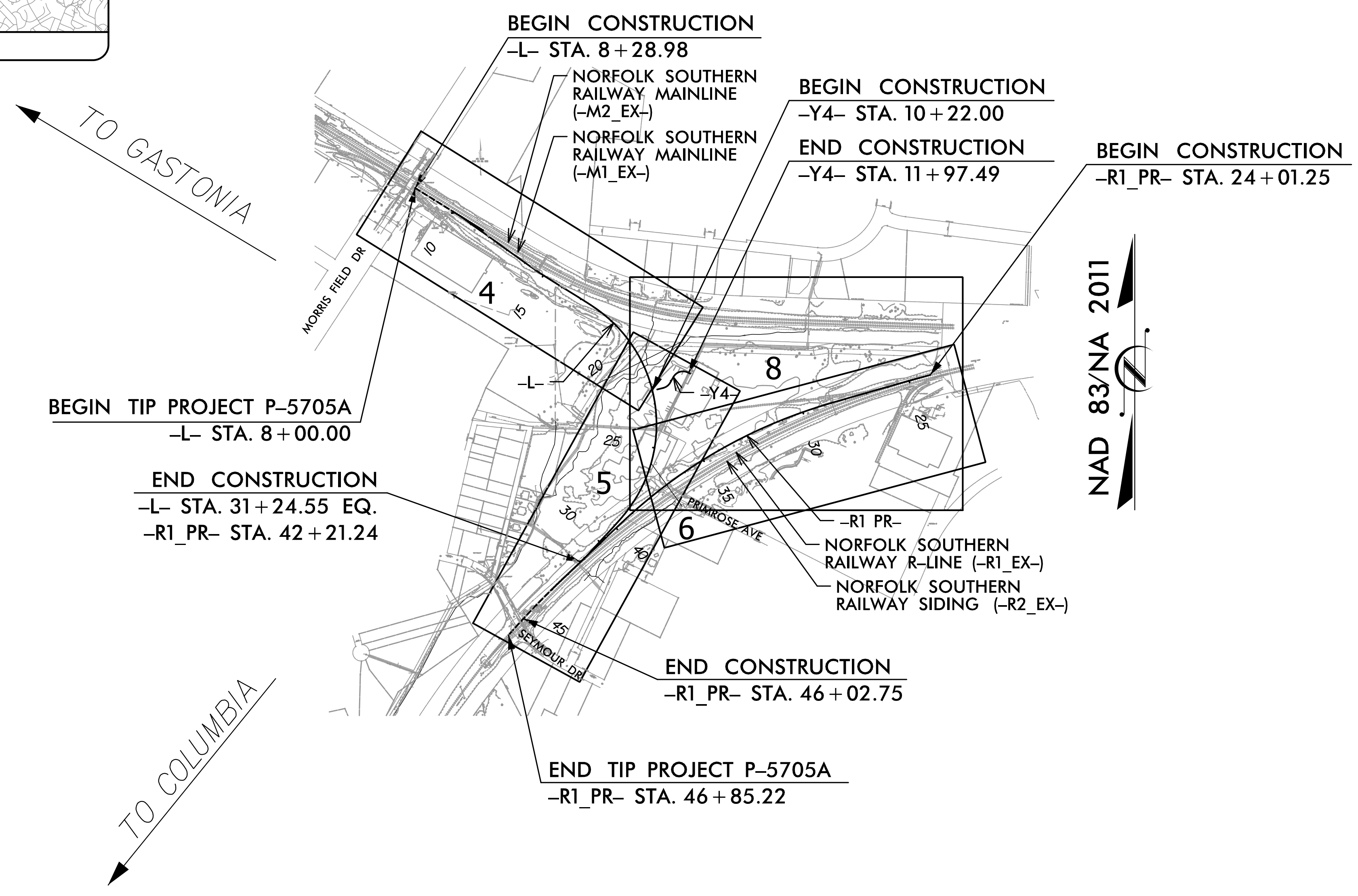

TO CHARLOTTE →

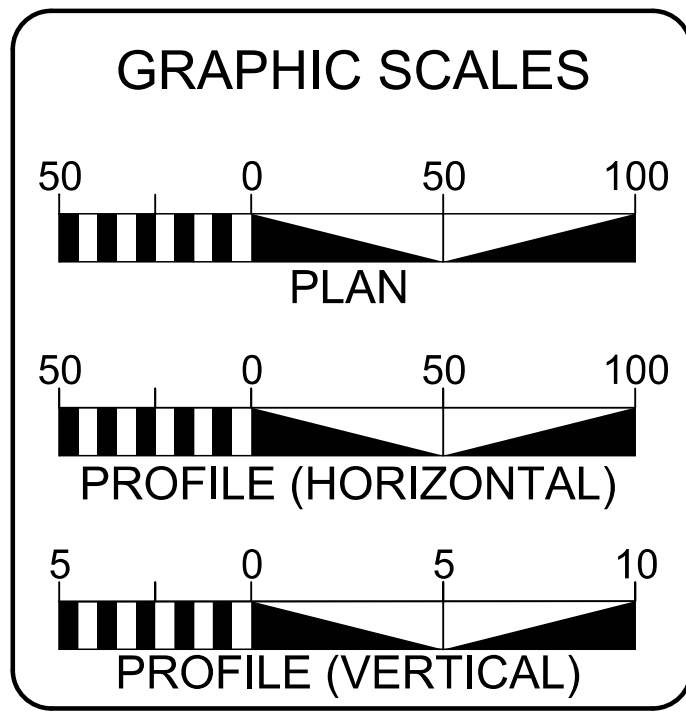

PROJECT LENGTH	
LENGTH OF RAIL TIP PROJECT	0.873 MILES
LENGTH OF STRUCTURES TIP PROJECT	0.000 MILES
TOTAL LENGTH OF RAIL TIP PROJECT	0.873 MILES
LENGTH MEASURED ALONG -L- AND -R1_PR-	
NCDOT CONTACT:	BRAD SMYTHE, P.E. NCDOT PROJECT MANAGER

**HNTB** HNTB NORTH CAROLINA, P.C.  
343 E. Six Forks Road, Suite 200  
Raleigh, North Carolina 27609  
NC License No: C-1554

2018 STANDARD SPECIFICATIONS

RIGHT OF WAY DATE:  
03/09/2018

LETTING DATE:  
07/18/2023

COREY VERNIER, P.E.  
RAIL PROJECT ENGINEER

DAVID HAWKINS, P.E.  
STRUCTURE PROJECT ENGINEER

PAUL CAMERON, P.E.  
HYDRAULICS PROJECT ENGINEER

BRAD SMYTHE, P.E.  
NCDOT PROJECT MANAGER

RAIL ENGINEER

HYDRAULICS ENGINEER

DocuSigned by:  
Corey P. Vernier  
SIGNATURE: P.E.

DocuSigned by:  
Paul H. Cameron  
SIGNATURE: P.E.

NC DEPARTMENT OF TRANSPORTATION  
**RAIL DIVISION**  
DESIGN AND CONSTRUCTION