

DESIGNED BY: DRD
DRAWN BY: DRF
CHECKED BY: DWH
APPROVED BY: RMS
REVISED:
NORTH CAROLINA DEPARTMENT OF TRANSPORTATION
UTILITIES ENGINEERING SEC. 6/6/2023
PHONE: (919) 707-6690
FAX: (919) 250-4151
UTILITY CONSTRUCTION PLANS ONLY

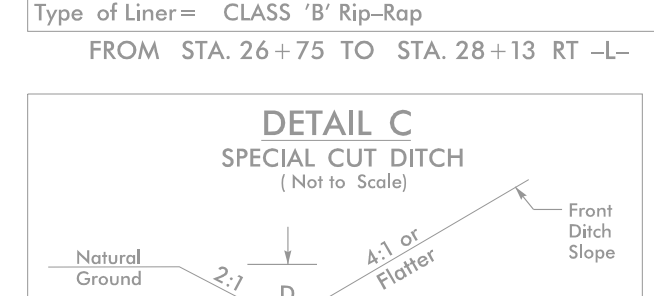
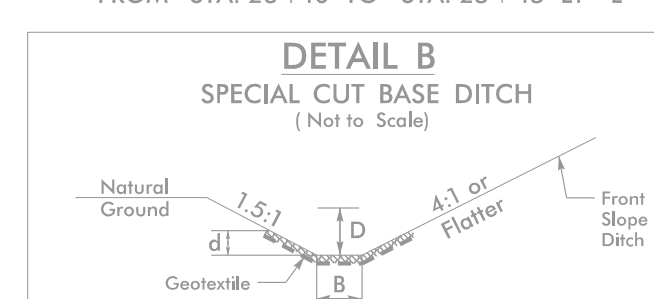
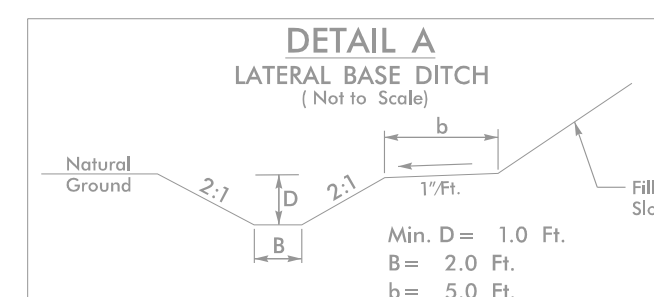
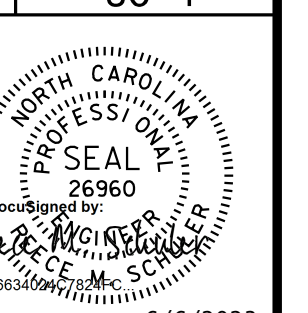

0401- INV. OUT=2065.00	0410- TOP=2061.69 INV.=2058.44	0419- TOP=2062.54 INV.=2058.29	0428- TOP=2063.40 INV.=2059.00
0402- TOP=2072.33 INV.=2068.92	0411- TOP=2061.81 INV.=2057.41	0420- INV. IN=2059.00	0429- TOP=2064.56 INV.=2062.06
0403- TOP=2072.33 INV.=2069.08	0412- TOP=2061.69 INV.=2058.44	0421- TOP=2061.73 INV.=2057.30	0430- TOP=2065.50 INV.=2061.98
0404- INV. OUT=2057.00	0413- TOP=2060.03 INV.=2057.53	0422- TOP=2061.43 INV.=2057.57	0431- TOP=2067.30 INV.=2061.66
0405- TOP=2069.08 INV.=2060.60	0414- INV. OUT=2054.00	0423- INV. IN=2080.00	0432- TOP=2070.83 INV.=2067.83
0406- TOP=2069.08 INV.=2061.32	0415- TOP=2059.21 INV.=2056.00	0424- TOP=2061.82 INV.=2058.45	0433- TOP=2071.59 INV.=2068.59
0407- INV. OUT=2054.00	0416- TOP=2061.73 INV.=2056.14	0425- TOP=2061.95 INV.=2058.70	0434- INV. IN=2062.00
0408- TOP=2059.58 INV.=2055.96	0417- TOP=2061.50 INV.=2057.22	0426- INV. OUT=2055.00	0435- TOP=2062.10 INV.=2057.55
0409- TOP=2061.81 INV.=2056.18	0418- TOP=2062.50 INV.=2058.04	0427- TOP=2061.70 INV.=2056.80	

FROM STA. 22+43 TO STA. 23+10 LT
FROM STA. 23+10 TO STA. 25+45 LT

FROM STA. 26+75 TO STA. 28+13 RT

FROM STA. 11+00 TO STA. 12+20 LT -Y2-

BEGIN STATE PROJECT
17BP.14.R.212
-L- PCC STA. 11+14.45
TIE TO TIP
PROJECT B-4159
-YI- POC STA. 11+20.00

BEGIN UTILITY CONSTRUCTION
-L- STA. POT 9+97.97
26.82' RT

BEGIN CONSTRUCTION
-DRI- POT STA. 10+52.00
-L- STA. 14+37.26 =
-DRI- STA. 11+18.23

BEGIN CONSTRUCTION
-WL-1-
CONNECT TO EX. 6" -WL- WITH
6" TAPPING SLEEVE & VALVE
-WL-1- STA. 10+00.00
-L- STA. 11+35.87 20.67' LT.

ABANDON 1,063 LF
6" UTILITY PIPE

REMOVE 2
WATER METERS

REMOVE 103 LF
6" UTILITY PIPE

REMOVE 930 LF
6" UTILITY PIPE

WATER METER
10 LF WATER SERVICE LINE

WATER METER
10 LF WATER SERVICE LINE

WATER METER
12 LF WATER SERVICE LINE

WATER METER
10 LF WATER SERVICE LINE

WATER METER
6 LF WATER SERVICE LINE

WATER METER
10 LF WATER SERVICE LINE

WATER METER
8 LF WATER SERVICE LINE

WATER METER
8 LF WATER SERVICE LINE

WATER METER
10 LF WATER SERVICE LINE

WATER METER
8 LF WATER SERVICE LINE

WATER METER
12 LF WATER SERVICE LINE

WATER METER
8 LF WATER SERVICE LINE

WATER METER
8 LF WATER SERVICE LINE

WATER METER
10 LF WATER SERVICE LINE

WATER METER
8 LF WATER SERVICE LINE

END CONSTRUCTION
-YIDET- STA. 15+23.74

END CONSTRUCTION
-YI- STA. 15+23.74

END CONSTRUCTION
-YI- STA. 15+23.74

END CONSTRUCTION
-YI- STA. 15+23.74

END CONSTRUCTION
-YI- STA. 15+23.74

END CONSTRUCTION
-YI- STA. 15+23.74

END CONSTRUCTION
-YI- STA. 15+23.74

END CONSTRUCTION
-YI- STA. 15+23.74

END CONSTRUCTION
-YI- STA. 15+23.74

END CONSTRUCTION
-YI- STA. 15+23.74

END CONSTRUCTION
-YI- STA. 15+23.74

END CONSTRUCTION
-YI- STA. 15+23.74

END CONSTRUCTION
-YI- STA. 15+23.74

END CONSTRUCTION
-YI- STA. 15+23.74

END CONSTRUCTION
-YI- STA. 15+23.74

END CONSTRUCTION
-YI- STA. 15+23.74

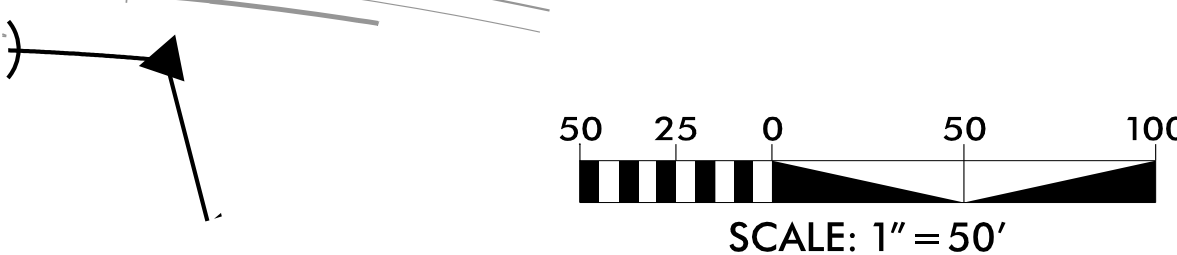
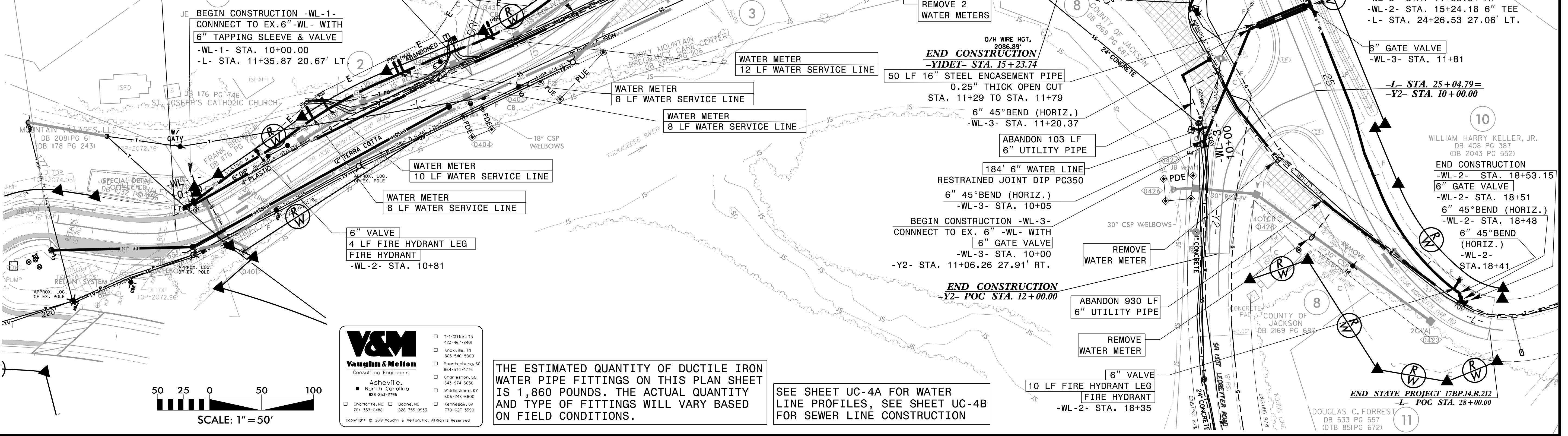

V&M
Vaughan & Melton
Consulting Engineers

Asheville, North Carolina
608-293-2796
704-351-0488 808-355-9933

- Tri-Cities, TN 423-467-8400
- Greenville, TN 865-546-5800
- Spartanburg, SC 864-574-4775
- Charleston, SC 843-974-5650
- Middlesboro, KY 606-249-8600
- Kennesaw, GA 770-627-3590

Copyright © 2009 Vaughn & Melton, Inc. All Rights Reserved

THE ESTIMATED QUANTITY OF DUCTILE IRON WATER PIPE FITTINGS ON THIS PLAN SHEET IS 1,860 POUNDS. THE ACTUAL QUANTITY AND TYPE OF FITTINGS WILL VARY BASED ON FIELD CONDITIONS.

SEE SHEET UC-4A FOR WATER LINE PROFILES, SEE SHEET UC-4B FOR SEWER LINE CONSTRUCTION

V:\NC\Utility\031730-21 49-0159 CULL BR UC\Utility Coordination\Utilities\490159_UTL_UC_UC-04.dgn

6-16-23