

09/06/99

TIP PROJECT: 17BP.14.R.212

STATE	STATE PROJECT REFERENCE NO.	SHEET NO.	TOTAL SHEETS
N.C.	17BP.14.R.212	RW01	06

STATE OF NORTH CAROLINA  
DIVISION OF HIGHWAYS

SURVEY CONTROL, EXISTING CENTERLINES,  
RIGHT OF WAY, EASEMENTS AND PROPERTY TIES

**JACKSON COUNTY**

LOCATION: SR 1336 (MONTEITH GAP ROAD) FROM NORTH OF  
SR 1002 (OLD CULLOWHEE ROAD) TO NORTH OF  
SR 1337 (LEDBETTER ROAD)

TYPE OF WORK: GRADING, PAVING, DRAINAGE, AND STRUCTURES

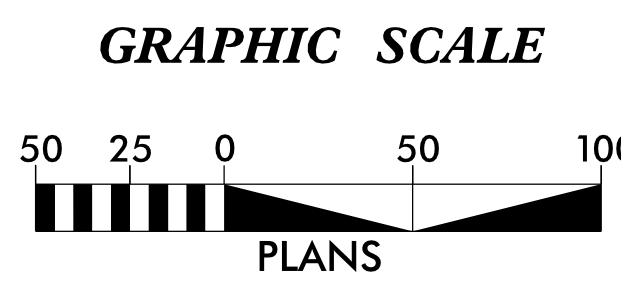
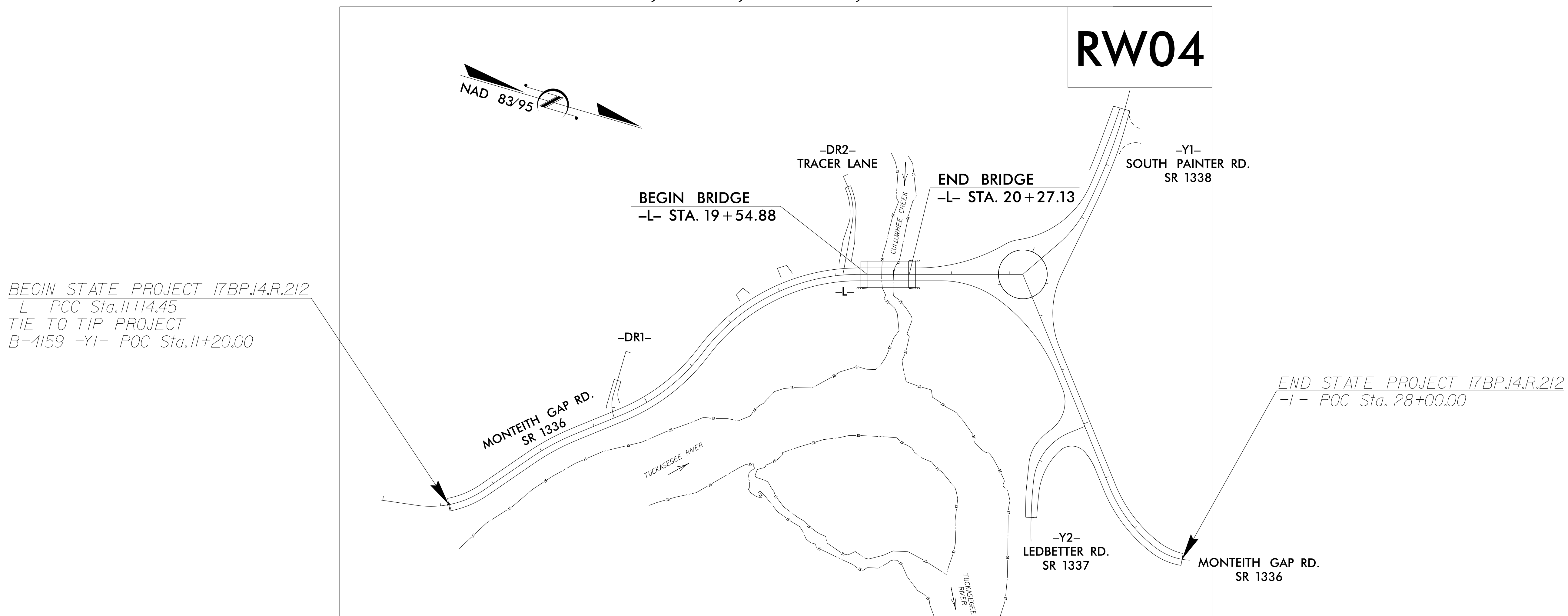

**DATUM DESCRIPTION**

THE LOCALIZED COORDINATE SYSTEM DEVELOPED FOR THIS PROJECT IS BASED ON THE STATE PLANE COORDINATES ESTABLISHED BY NCGS FOR MONUMENT "B-4159 GPS-101" WITH NAD 83/95 STATE PLANE GRID COORDINATES OF NORTHING: 595,248.141(ft) EASTING: 754,526.411(ft) ELEVATION: 2,127.67(ft) THE AVERAGE COMBINED GRID FACTOR USED ON THIS PROJECT (GROUND TO GRID) IS: 0.9997772 THE N.C. LAMBERT GRID BEARING AND LOCALIZED HORIZONTAL GROUND DISTANCE FROM "B-4159 GPS-101" TO -L- STATION 11+14.45 IS N 37-30'05.8" W 912.48'(ft) ALL LINEAR DIMENSIONS ARE LOCALIZED HORIZONTAL DISTANCES VERTICAL DATUM USED IS NAVD 88

Prepared in the Office of:

LOCATION AND SURVEYS, DIVISION 14  
122 BONNIE LANE  
SYLVA, NC 28779

2018 STANDARD SPECIFICATIONS

RIGHT OF WAY DATE:  
APRIL 09, 2021

LETTING DATE:  
FEBRUARY 22, 2022

PROFESSIONAL LAND SURVEYOR

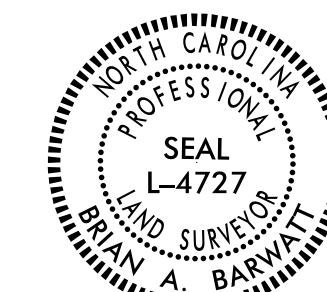

DocuSigned by:  
*Brian Barrott*  
SIGNATURE:

6/2/2021  
Date:

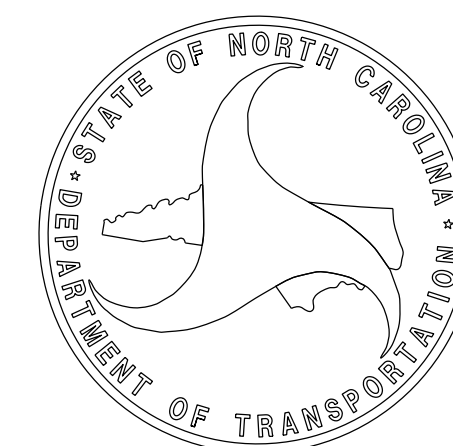

\$\$\$\$\$ SYSTEM \$\$\$\$\$\$  
\$\$\$\$\$ USER \$\$\$\$\$\$