

TIP PROJECT: R-2707E

CONTRACT: C204851

STATE OF NORTH CAROLINA
DIVISION OF HIGHWAYS

CLEVELAND COUNTY

**LOCATION: US 74 FROM EXISTING US 74 WEST OF SR 2238
(LONG BRANCH RD) TO WEST OF SR 1001 (STONEY POINT RD)**

**TYPE OF WORK: GRADING, DRAINAGE, PAVING, STRUCTURE, SIGNING, &
NOISE WALL**

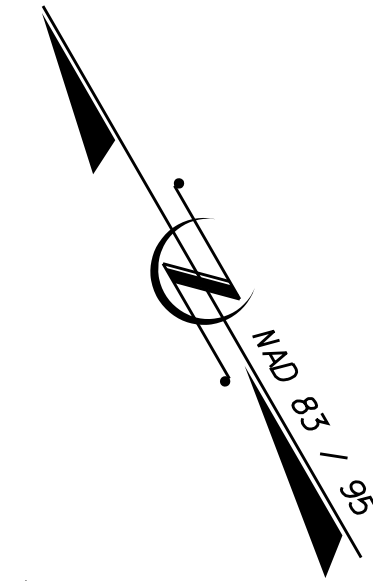
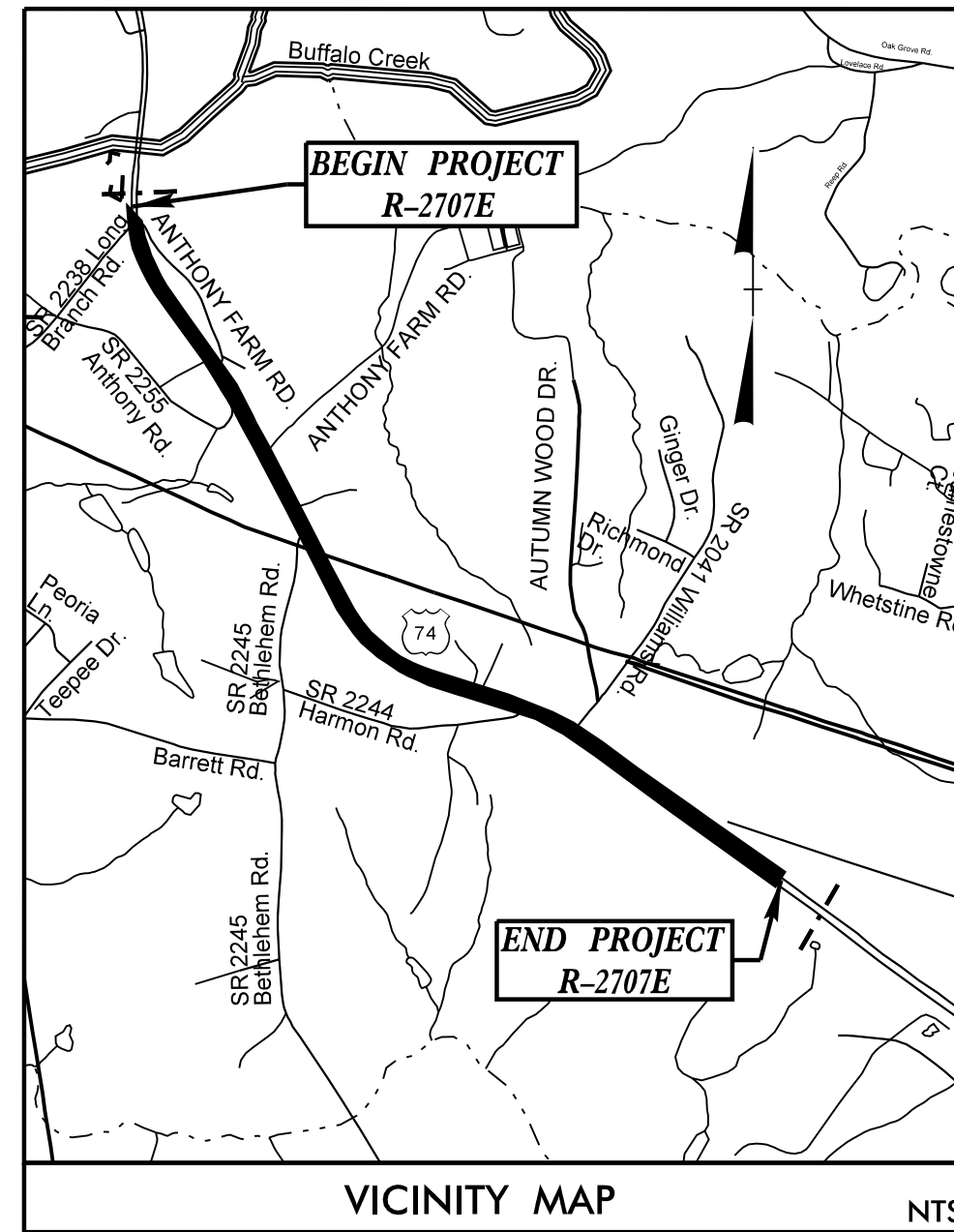

STATE	STATE PROJECT REFERENCE NO.	SHEET NO.	TOTAL SHEETS
N.C.	R-2707E	1	
STATE PROJ. NO.	F.A. PROJ. NO.	DESCRIPTION	
34497.1.FS7	NHS-0074(165)	P.E.	
34497.2.15	N/A	RW & UTIL.	
34497.3.12	N/A	CONST.	

PART 2

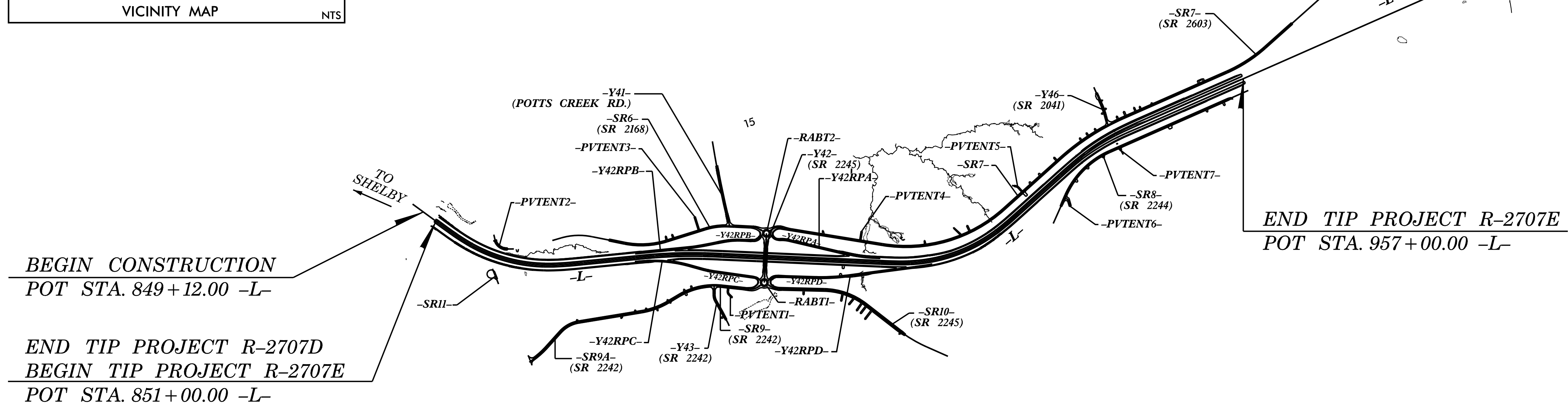

STRUCTURES

THIS IS A CONTROLLED ACCESS PROJECT WITH ACCESS BEING LIMITED TO INTERCHANGES

DESIGN DATA

ADT 2019 =	41,600
ADT 2043 =	61,700
K =	11 %
D =	55 %
T =	15 % *
V =	70 MPH
* TTST =	10% DUAL 5%
FUNC CLASS =	FREWAY
STATEWIDE TIER	

PROJECT LENGTH

LENGTH OF ROADWAY TIP PROJECT R-2707E	=	2.008 MI.
TOTAL LENGTH OF TIP PROJECT R-2707E	=	2.008 MI.

PREPARED IN THE OFFICE OF:
Stantec Consulting Services Inc. Tel. (919) 851-8866
801 Jones Franklin Road Fax. (919) 851-7024
Suite 300 www.stantec.com
Raleigh, NC 27606 License No. F-0672

FOR THE NORTH CAROLINA DEPARTMENT OF TRANSPORTATION
2018 STANDARD SPECIFICATIONS

RIGHT OF WAY DATE:
01 / 10 / 2019

LETTING DATE:
07 / 18 / 2023

JOSEPH T. KELVINGTON, P.E.
PROJECT ENGINEER

BRYAN SOWELL, P.E.
NCDOT DIVISION 12

