

5/14/23

| | |
|----------------------------------------------------------------------|---------------------------------|
| PROJECT REFERENCE NO. | SHEET NO. |
| R-2707E | JC-8/RDY-6C |
| DESIGNED BY: BCH | |
| DRAWN BY: | |
| CHECKED BY: | |
| APPROVED BY: | |
| REVISER: | |
| NORTH CAROLINA DEPARTMENT OF TRANSPORTATION | |
| UTILITIES ENGINEERING SEC. PHONE: (919) 707-6690 FAX: (919) 250-4151 | UTILITY CONSTRUCTION PLANS ONLY |

The estimated quantity of "Ductile Iron Water Pipe Fittings" on this plan sheet is 750 pounds. The actual quantity and type of fittings will vary based on field conditions.

UTILITY CONSTRUCTION

DOCUMENT NOT CONSIDERED FINAL UNLESS ALL SIGNATURES COMPLETED

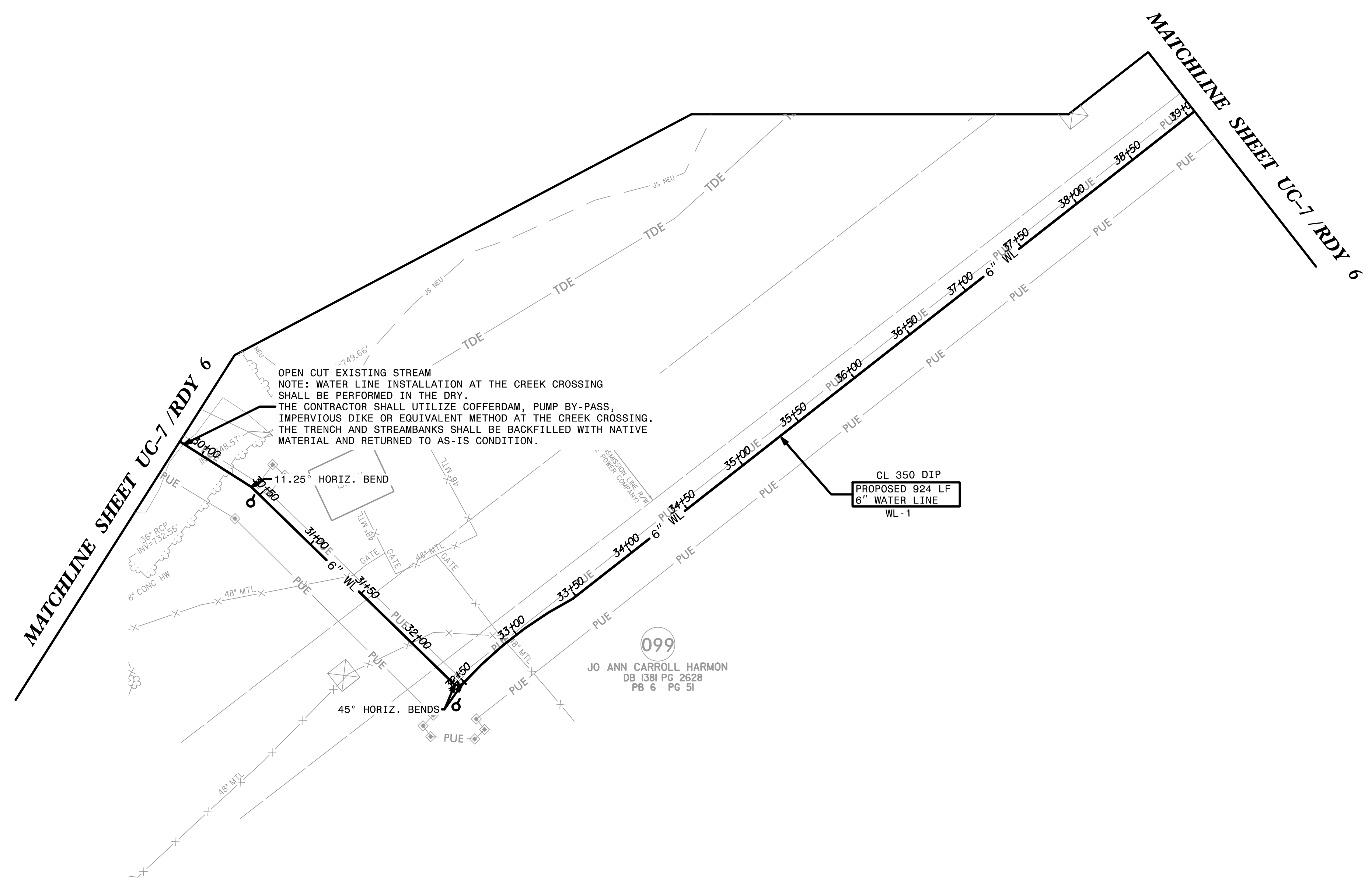

099
JO ANN CARROLL HARMON
DB 1381 PG 2628
PB 6 PG 51

3/14/2023 3:14:58 PM C:\Users\BCH\OneDrive\Documents\Projects\R2707E_Ut_(rdy_sht6c)_UC(ut)_const_Sht8)_psh.dgn