

MATCH LINE SHEET TMP-18
-L- STA. 901+00

-L- 902+00

01 TEMPORARY SHORING
-L- STA. 897+00, 28.0' LT
TO -L- STA. 908+00, 28.0' LT

END PCB
-L- STA. 909+00±

US 74 WB SHIFTED TO TEMPORARY PAVEMENT, PROPOSED UNDERCUT ON -L- WB FROM STA. 896+50± TO 909+00±.

-L- STA. 909+00± OFFSET 2'

BEGIN PCB
-L- STA. 909+50± OFFSET 6'

-L- STA. 911+60± OFFSET 2'

BEGIN PCB
-L- STA. 912+00± OFFSET 6'

-L- STA. 912+00±

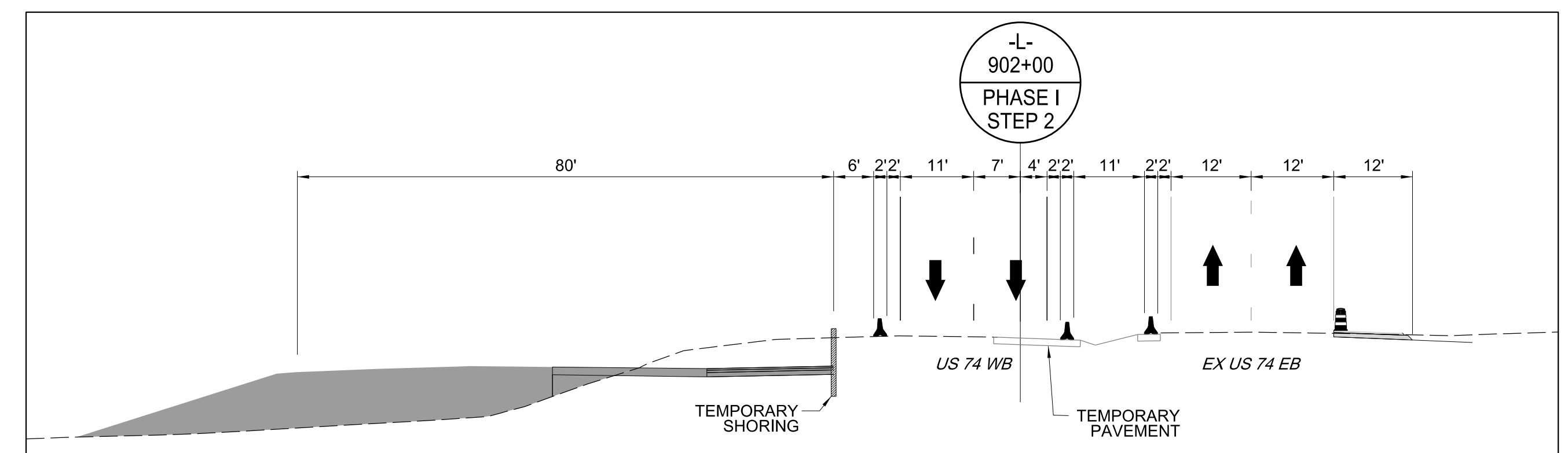

4/20/2023
c:\users\angood\pwworking\01056339\R-2707E_TMP_19_PHASE_01_STEP_02.dgn
angood

Stantec
Stantec Consulting Services Inc.
801 Jones Franklin Road
Suite 300
Raleigh, NC 27606
Tel. 919.851.6866
Fax. 919.851.7024
www.stantec.com
License No. F-0672

4/20/2023
DOCUMENT NOT CONSIDERED FINAL
UNLESS ALL SIGNATURES COMPLETED

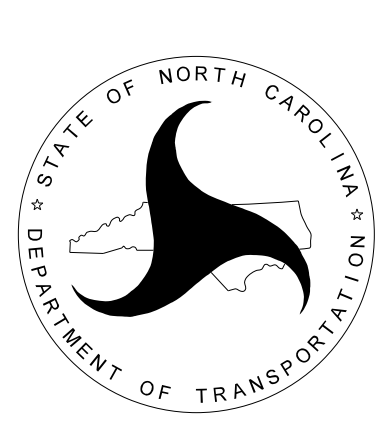

-L- US 74
PHASE I
STEP 2