

8.17/2023

4/16/2023 c:\users\mferguson\documents\pwworking\dms43124\R2707E\_RDY\_PSH11.dgn mferguson

-SR7-

PI Sta 74+83.67  
 $\Delta = 17^{\circ} 55' 53.6" (LT)$   
 $D = 3^{\circ} 13' 07.9"$   
 $L = 557.08'$   
 $T = 280.83'$   
 $R = 1,780.00'$   
 $SE = .05$   
 $RO = 120'$   
 $DS = 50 MPH$

155

JOHN L. ETTERS &  
 ANGELA H. ETTERS  
 DB 1550 PG 979, TRACT II

END CONSTRUCTION  
 POT Sta. 82+00.00 -SR7-

**SUNGATE DESIGN GROUP, P.A.**  
 905 JONES FRANKLIN ROAD  
 RALEIGH, NORTH CAROLINA 27606  
 TEL (919) 859-2243  
 ENG FIRM LICENSE NO. C-890

**Stantec**  
 Stantec Consulting Services Inc.  
 801 Jones Franklin Road  
 Suite 300  
 Raleigh, NC 27606  
 Tel. (919) 851-6866  
 Fax. (919) 851-7024  
 www.stantec.com  
 License No. F-0672

PROJECT REFERENCE NO. R-2707E	SHEET NO. II
RW SHEET NO.	
ROADWAY DESIGN ENGINEER MATTHEW B. FERGUSON 044480 4/21/2023	HYDRAULICS ENGINEER JOSHUA G. DALTON 26971 4/21/2023
<b>DOCUMENT NOT CONSIDERED FINAL UNLESS ALL SIGNATURES COMPLETED</b>	

MATCHLINE -SR7-  
 STA 73+50.00  
 SEE SHEET 10

MATCHLINE -L-  
 STA 957+00.00  
 SEE SHEET 10

MATCHLINE -L-  
 STA 970+00.00  
 SEE SHEET 12

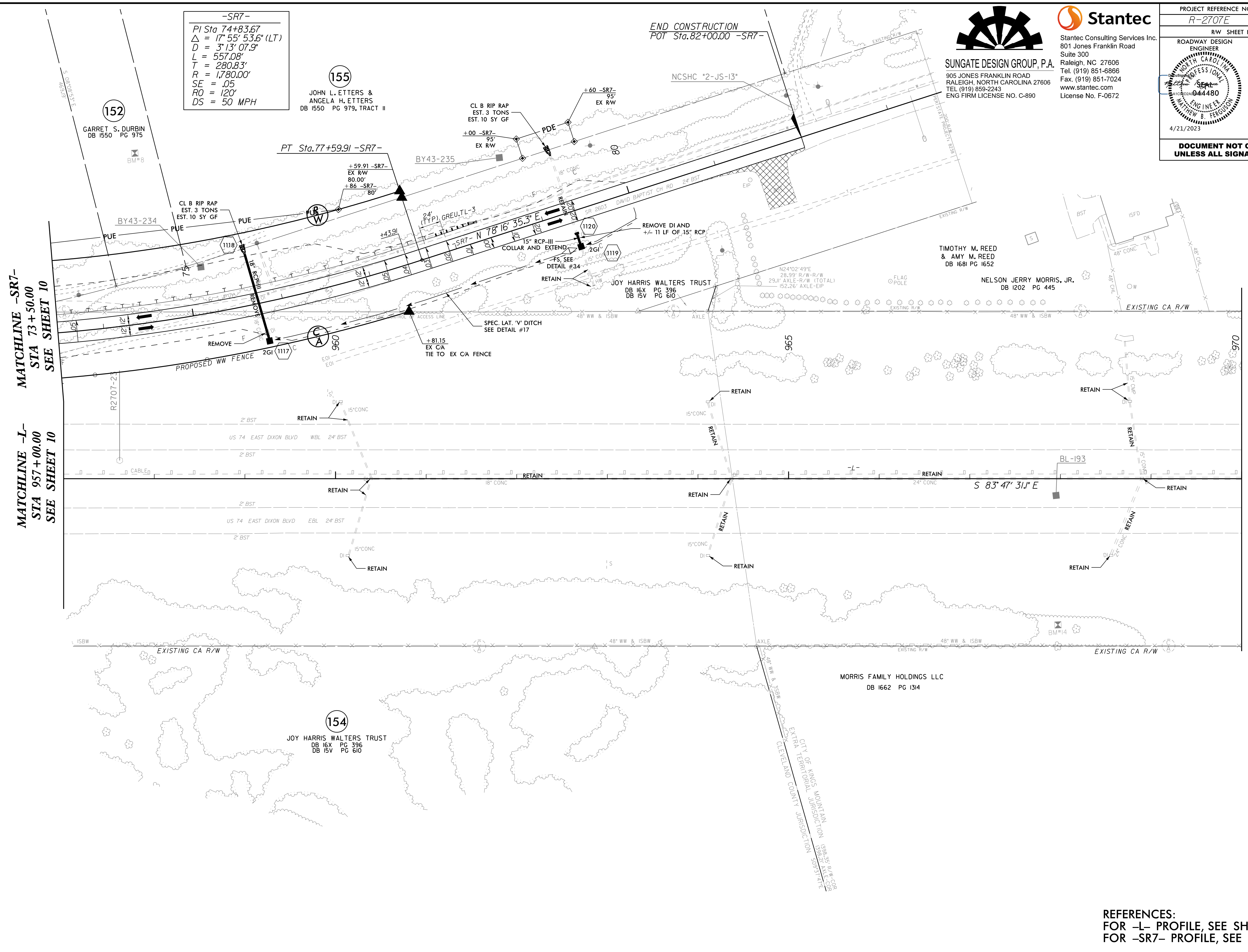

TIMOTHY M. REED & AMY M. REED  
 DB 1681 PG 1652

NELSON JERRY MORRIS, JR.  
 DB 1202 PG 445

154

JOY HARRIS WALTERS TRUST  
 DB 16X PG 396  
 DB 15V PG 610

MORRIS FAMILY HOLDINGS LLC  
 DB 1662 PG 1314

REFERENCES:  
 FOR -L- PROFILE, SEE SHEET NO. 24  
 FOR -SR7- PROFILE, SEE SHEET NO. 17