

LAYOUT FOR COMPUTING AREA REINFORCED CONCRETE DECK SLAB (SQ. FT. = 4,933)

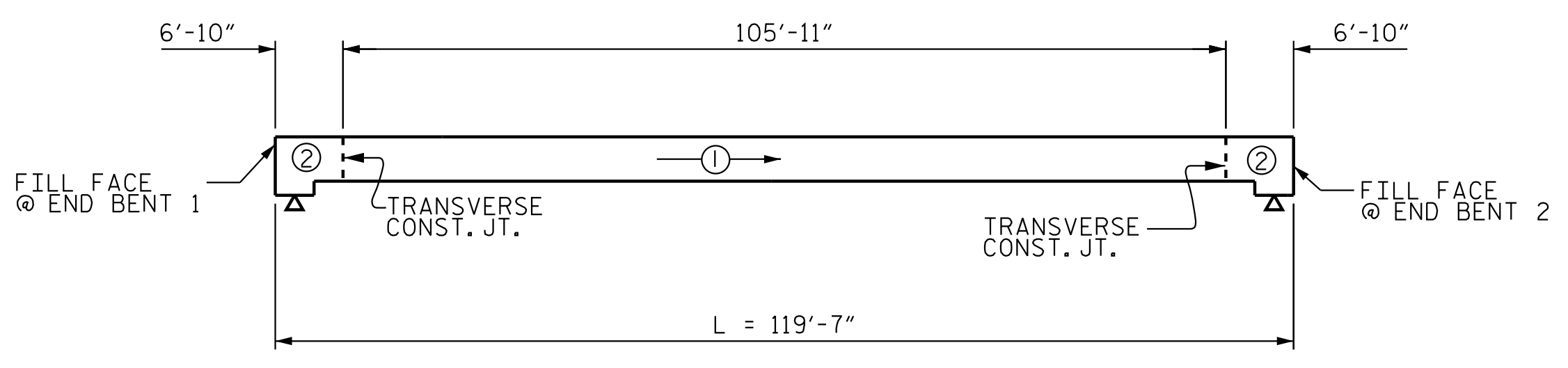

POURING SEQUENCE
ALONG GRADE LINE -LL-
⊕ → = INDICATES POUR NUMBER AND DIRECTION OF POUR

REINFORCING BAR SCHEDULE					
BAR	NO.	SIZE	TYPE	LENGTH	WEIGHT
*A1	217	#5	STR	40'-9"	9223
A2	217	#5	STR	40'-9"	9223
*B1	58	#5	STR	60'-0"	3630
B2	82	#5	STR	59'-10"	5117
*B3	54	#6	STR	22'-11"	1859
*B4	54	#6	STR	25'-9"	2089
*G1	2	#5	STR	40'-9"	85
K1	28	#4	STR	21'-3"	397
K2	6	#4	STR	7'-0"	28
K3	30	#4	STR	9'-10"	197
K4	6	#4	STR	8'-6"	34
K5	4	#4	3	5'-1"	14
K6	20	#4	3	6'-6"	87
K7	4	#4	3	5'-10"	16
K8	12	#4	STR	6'-8"	53
*S1	60	#4	2	10'-3"	411
*S2	80	#4	2	11'-8"	623
U1	60	#4	1	14'-8"	588
U2	16	#4	1	10'-10"	116
REINFORCING STEEL				15,870 LBS.	
EPOXY COATED REINFORCING STEEL				17,920 LBS.	

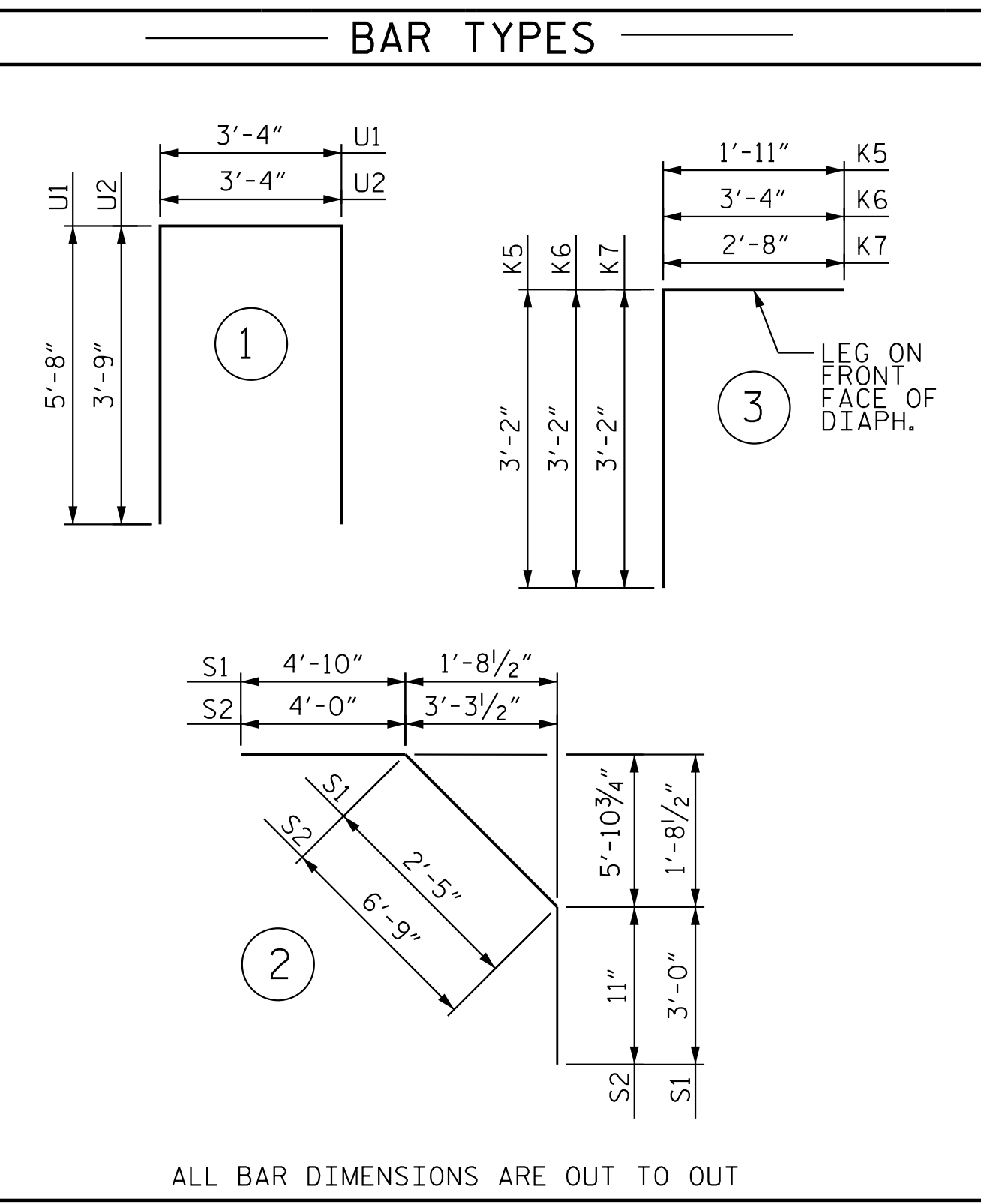

ALL BAR DIMENSIONS ARE OUT TO OUT

SUPERSTRUCTURE BILL OF MATERIAL			
	CLASS AA CONCRETE	REINFORCING STEEL	EPOXY COATED REINFORCING STEEL
	(CU. YDS.)	(LBS.)	(LBS.)
POUR #1	140.2		
POUR #2	81.2		
TOTALS**	221.3	15,870	17,920

**QUANTITIES FOR BARRIER RAIL ARE NOT INCLUDED

GROOVING BRIDGE FLOORS	
APPROACH SLABS	1692 SQ.FT.
BRIDGE DECK	4116 SQ.FT.
TOTAL	5808 SQ.FT.

BAR SIZE	SUPERSTRUCTURE EXCEPT APPROACH SLABS, PARAPET, AND BARRIER RAIL		APPROACH SLABS		PARAPET AND BARRIER RAIL
	EPOXY COATED	UNCOATED	EPOXY COATED	UNCOATED	
#4	1'-11"	1'-7"	1'-11"	1'-7"	2'-6"
#5	2'-5"	2'-0"	2'-5"	2'-0"	3'-1"
#6	2'-10"	2'-5"	3'-7"	2'-5"	3'-8"
#7	4'-2"	2'-9"			
#8	4'-9"	3'-2"			

PROJECT NO. R-2707D
CLEVELAND COUNTY
STATION: 810+00.00 -L-



STATE OF NORTH CAROLINA
DEPARTMENT OF TRANSPORTATION
RALEIGH
SUPERSTRUCTURE
BILL OF MATERIAL
(LL)

REVISIONS						SHEET NO. S8-19
NO.	BY:	DATE:	NO.	BY:	DATE:	
1			3			TOTAL SHEETS 30
2			4			

DOCUMENT NOT CONSIDERED FINAL UNLESS ALL SIGNATURES COMPLETED

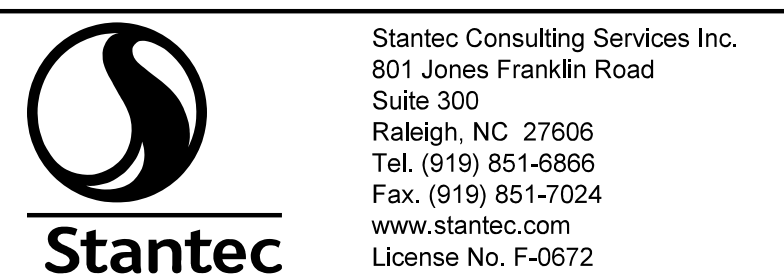

DRAWN BY: N. D'AIUTO DATE: 05/01/18
CHECKED BY: J.T. KELVINGTON DATE: 12/05/22
DESIGN ENGINEER OF RECORD: J.T. KELVINGTON DATE: 06/22/23

6/22/2023
jHogenbush
c:\pvt\working\dmis69985\R2707D_SMLL_BM_2200BB.dgn