

(A) MIN. SPLICE - #4 K14 (STAGE I) TO #4 K31 (STAGE II)

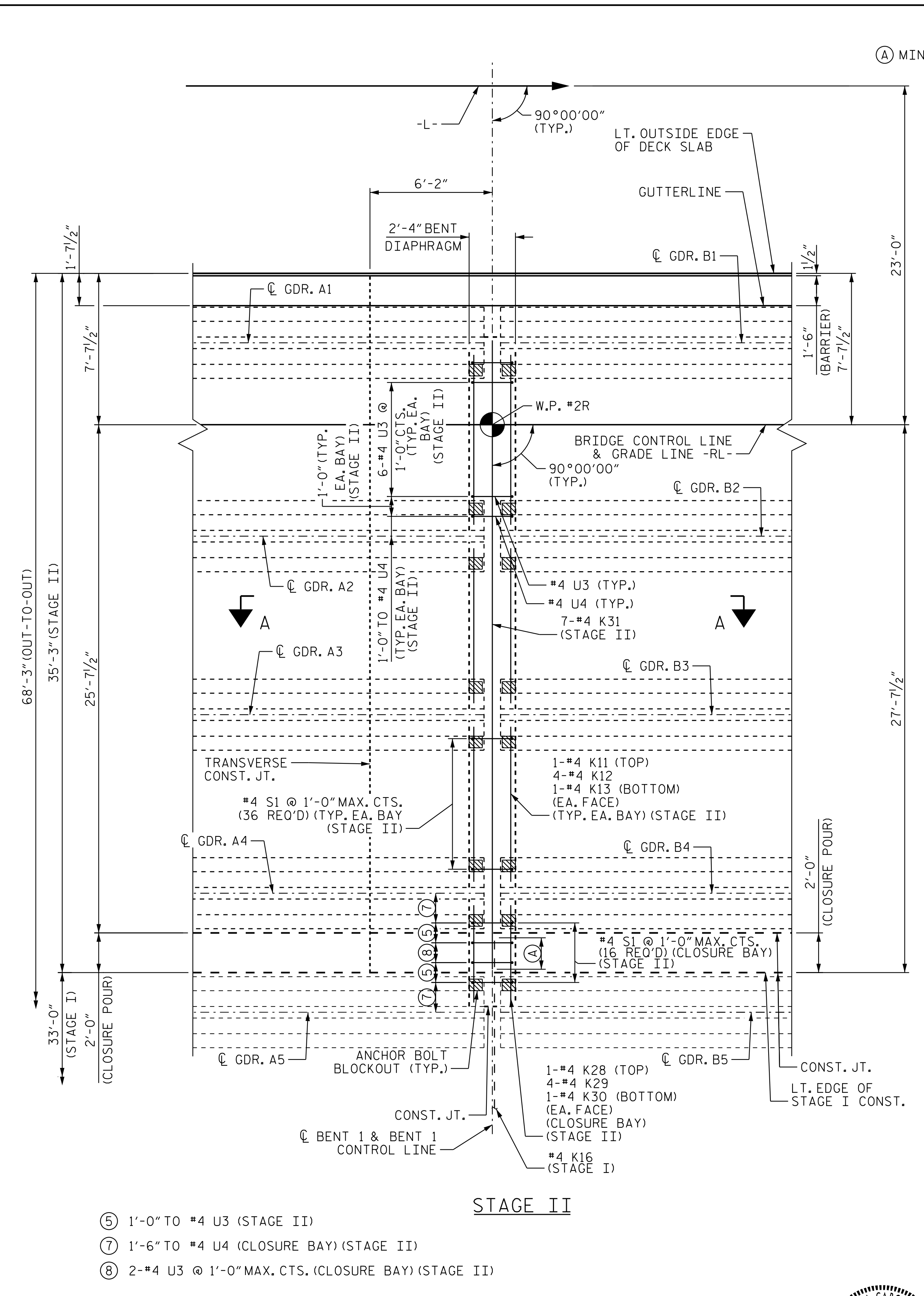
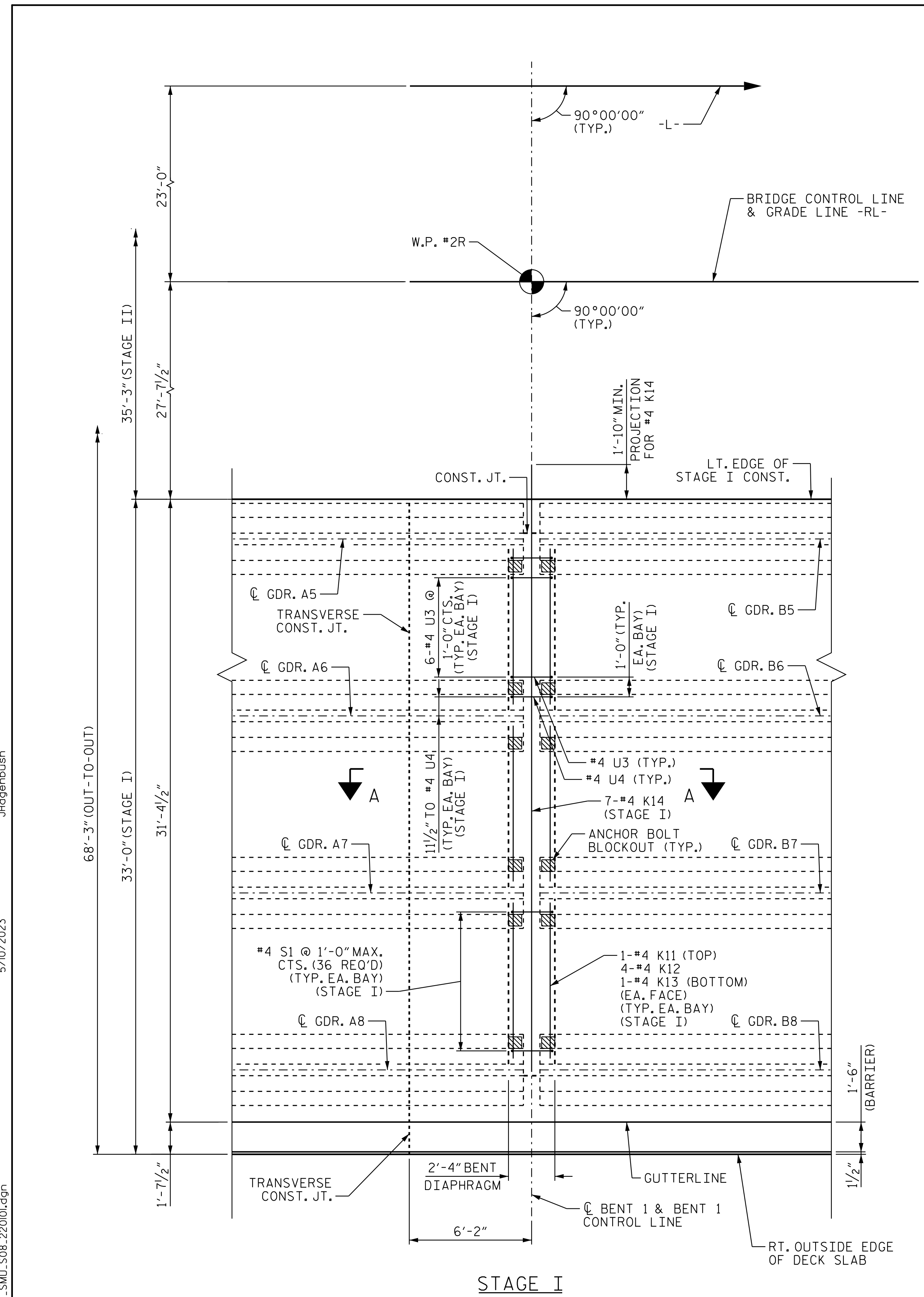

- (5) 1'-0" TO #4 U3 (STAGE II)
- (7) 1'-6" TO #4 U4 (CLOSURE BAY) (STAGE II)
- (8) 2'-#4 U3 @ 1'-0" MAX. CTS. (CLOSURE BAY) (STAGE II)

NOTES:
 S1 BARS MAY BE REPOSITIONED AS NECESSARY TO CLEAR PRESTRESSED GIRDERS AND OTHER REINFORCING BAR CONFLICTS.
 FOR SECTION A-A, SEE "TYPICAL SECTION DETAILS", SHEET 5 OF 5.
 DENOTES CONC. BLOCKOUT. SEE END BENT SHEETS AND "TYPICAL SECTION DETAILS", SHEET 5 OF 5.

PROJECT NO. R-2707D
CLEVELAND COUNTY
 STATION: 849+00.00 -L-

SHEET 8 OF 8

STATE OF NORTH CAROLINA
 DEPARTMENT OF TRANSPORTATION
 RALEIGH

**SUPERSTRUCTURE
 PLAN OF SPANS
 DETAILS - INTERIOR
 BENT DIAPHRAGMS**

(RIGHT LANE)

REVISIONS						SHEET NO. S6-20
NO.	BY:	DATE:	NO.	BY:	DATE:	
1			3			TOTAL SHEETS 56
2			4			



**TYPICAL INTERIOR BENT
 DIAPHRAGM REINFORCING DETAIL**

DETAILS AT BENT 1 SHOWN.
 DETAILS AT BENT 2 SIMILAR.

Stantec Consulting Services Inc.
 801 Jones Franklin Road
 Suite 300
 Raleigh, NC 27606
 Tel. (919) 851-6866
 Fax. (919) 851-7024
 www.stantec.com
 License No. F-0672

DRAWN BY: J. B. GEILE DATE: 10/04/18
 CHECKED BY: S. S. POOLE DATE: 12/10/22
 DESIGN ENGINEER OF RECORD: S.S. POOLE DATE: 05/10/23

DOCUMENT NOT CONSIDERED
 FINAL UNLESS ALL
 SIGNATURES COMPLETED

5/10/2023
 jHagenbush
 c:\pvt\working\dmis55490\2707D_SML_S08_220101.dgn