

* FOR S6 BARS. SEE
DETAIL "C" OF
PRESTRESSED
CONCRETE GIRDER
CONTINUOUS FOR LIVE LOAD
DETAILS, SHEET 3 OF 4.

1/2" FORMED
HOLE. SEE ELEVATION
FOR LOCATION. FOR
DIM. "A", "B" & "C"
SEE "INTERMEDIATE
STEEL DIAPHRAGMS"
SHEET.)

DEBONDING LEGEND

- FULLY BONDED STRANDS
- STRANDS DEBONDED FOR 6'-0" FROM END OF GIRDER
- STRANDS DEBONDED FOR 12'-0" FROM END OF GIRDER

AT END OF GIRDER AT C OF GIRDER
0.6" Ø LOW RELAXATION STRAND LAYOUT

0.6" Ø L. R. GRADE 270 STRANDS		
AREA (SQUARE INCHES)	ULTIMATE STRENGTH (LBS. PER STRAND)	APPLIED PRESTRESS (LBS. PER STRAND)
0.217	58,600	43,950

REINFORCING STEEL FOR ONE GDR					
BAR	NUMBER	SIZE	TYPE	LENGTH	WEIGHT
S1	240	#4	1	5'-4"	856
S2	32	#6	1	5'-4"	257
S3	10	#4	2	16'-5"	110
S4	272	#5	4	4'-4"	1230
S5	80	#4	3	3'-0"	161
*S6	30	#5	STR	3'-8"	115
S7	2	#5	2	17'-0"	36
S8	2	#3	STR	1'-10"	2
S9	40	#4	STR	3'-3"	87
S10	4	#5	5	8'-6"	36
S11	8	#4	STR	8'-0"	43

* NOTE: S6 BARS SHALL BE BENT BEFORE SHIPMENT. HEAT BENDING SHALL NOT BE ALLOWED.

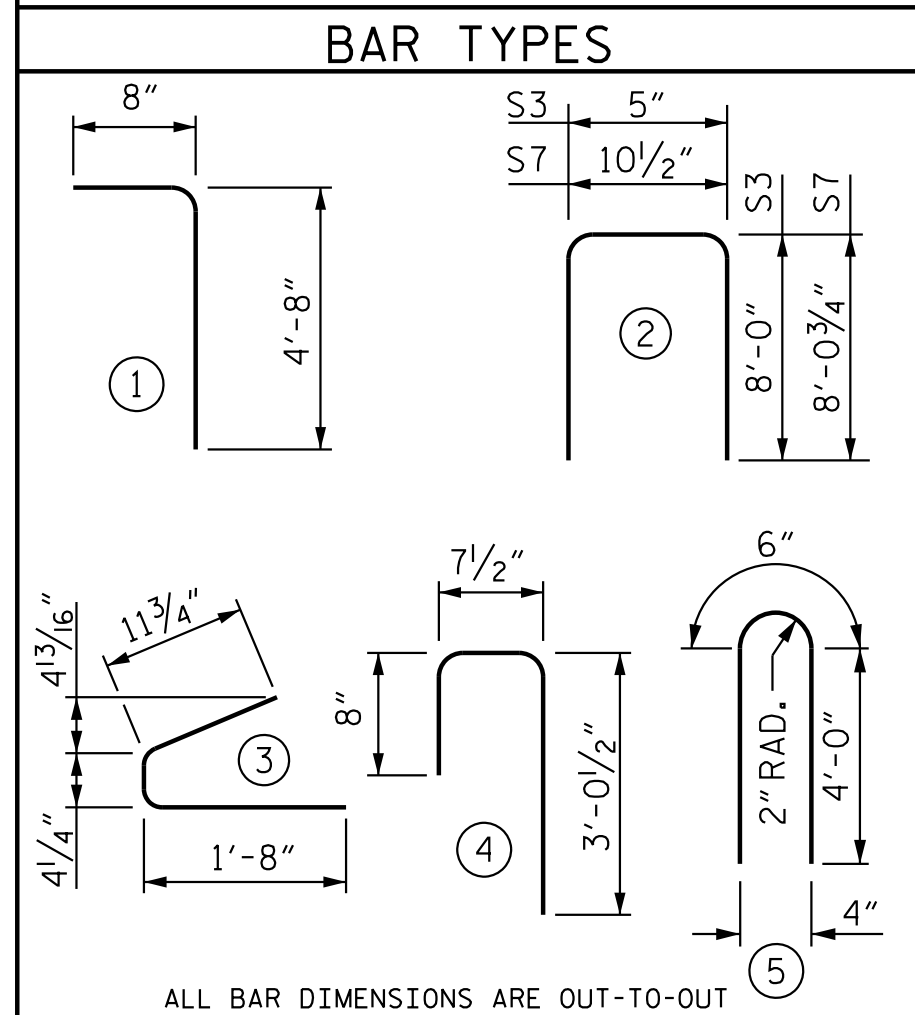

QUANTITIES FOR ONE GIRDER		
REINFORCING STEEL	8,000 PSI CONCRETE	0.6" Ø L.R. STRANDS
LB.	C.Y.	No.
2,933	17.8	34

GIRDERS REQUIRED		
NUMBER	LENGTH	TOTAL LENGTH
5	97'-9 1/2"	488'-11 1/2"

PROJECT NO. R-2707D
CLEVELAND COUNTY
STATION: 20+16.72 -Y2-

SHEET 1 OF 4

STATE OF NORTH CAROLINA
DEPARTMENT OF TRANSPORTATION
RALEIGH
SUPERSTRUCTURE
54" PRESTRESSED CONCRETE
MODIFIED BULB TEE
CONTINUOUS FOR LIVE LOAD

SPAN A

REVISIONS						SHEET NO. S2-14
NO.	BY:	DATE:	NO.	BY:	DATE:	
1			3			TOTAL SHEETS 35
2			4			

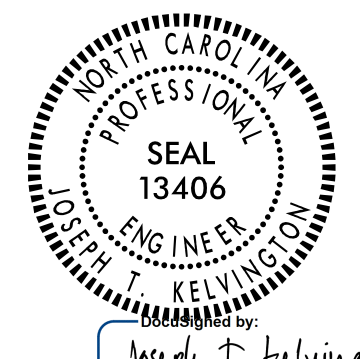

DOCUMENT NOT CONSIDERED FINAL UNLESS ALL SIGNATURES COMPLETED

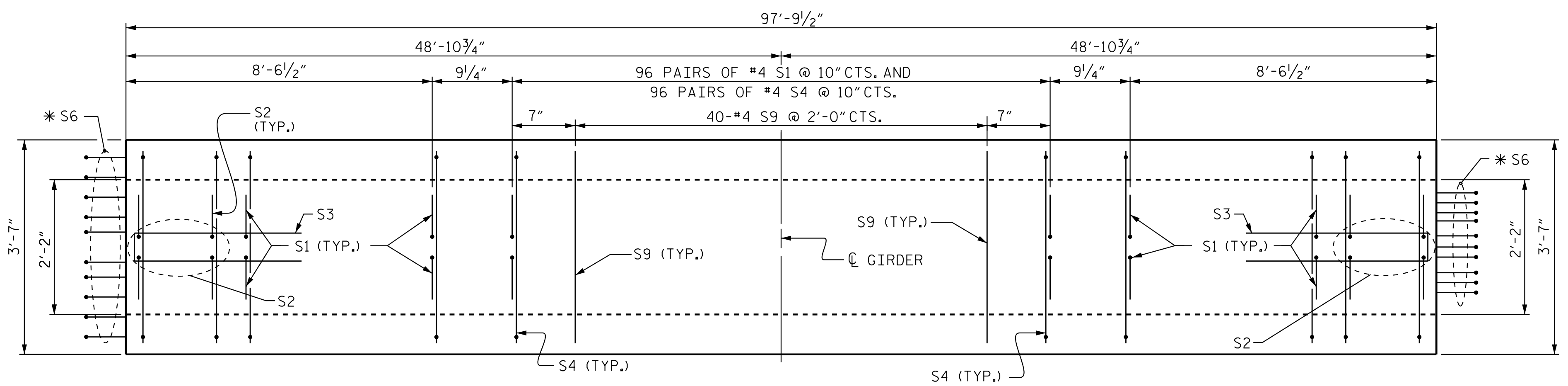

PLAN OF GIRDER

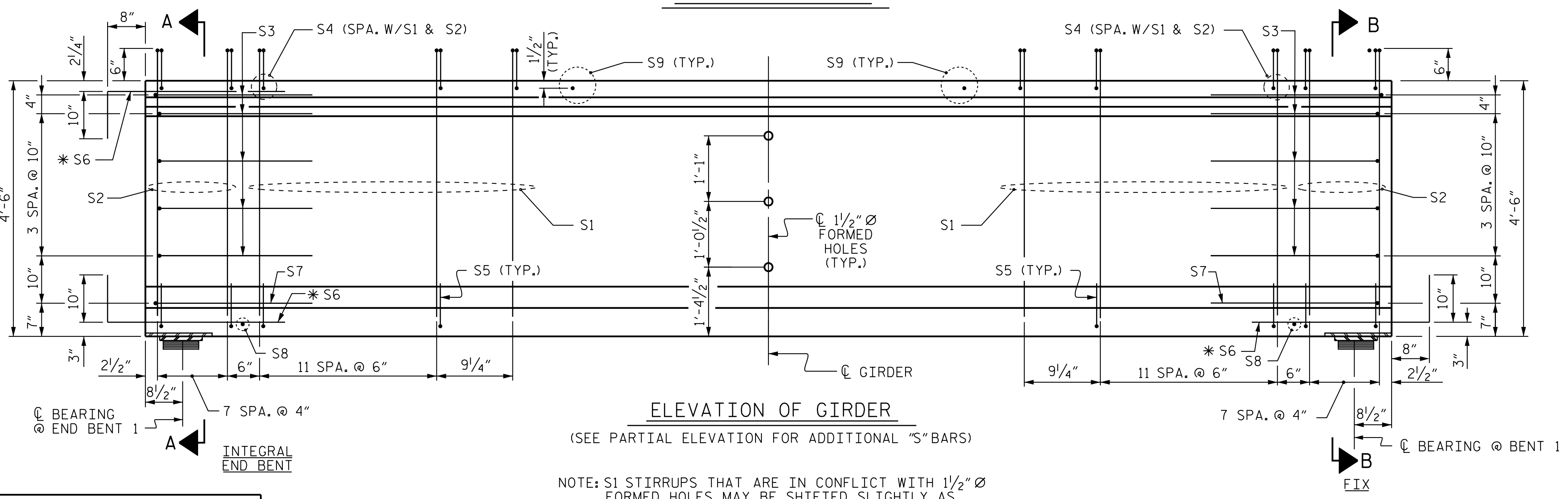

ELEVATION OF GIRDER

(SEE PARTIAL ELEVATION FOR ADDITIONAL "S" BARS)

NOTE: S1 STIRRUPS THAT ARE IN CONFLICT WITH 1/2" Ø FORMED HOLES MAY BE SHIFTED SLIGHTLY AS NECESSARY TO CLEAR HOLES AND S11 BARS.

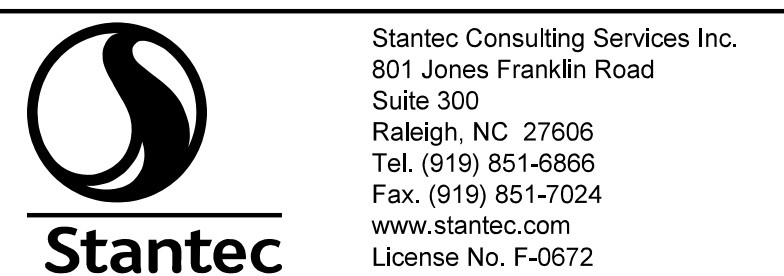

DRAWN BY: J. B. GEILE DATE: 03/01/18 DESIGN ENGINEER OF RECORD: J. T. KELVINGTON DATE: 04/27/22
CHECKED BY: M. B. ISENHOUR DATE: 05/02/18

jhhagenbush

4/27/2023

c:\p\w\king\dms5537a\R2707D_SML_G01_220489.dgn