

TOTAL LENGTH OF BRIDGE = 197'-9" (FILL FACE TO FILL FACE)

99'-10" (W.P. #1 TO W.P. #2)

97'-11" (W.P. #2 TO W.P. #3)

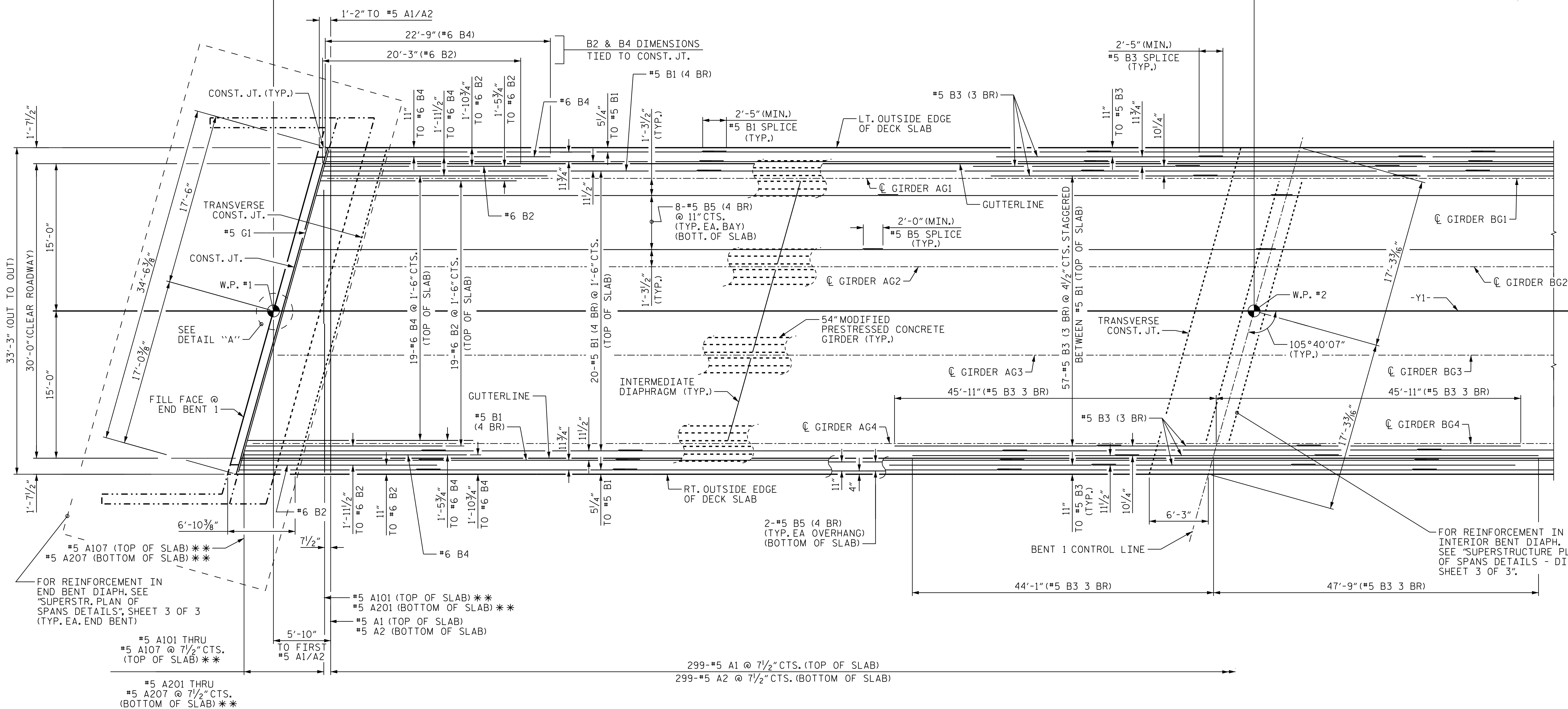

PLAN OF SPANS (SPAN A & PARTIAL SPAN B)

NOTE: (2BR) DENOTES 2 BAR RUN
(3BR) DENOTES 3 BAR RUN
(4BR) DENOTES 4 BAR RUN
** - DENOTES 2 BARS PER MARK

FOR BARRIER RAIL DETAILS AND REINFORCING STEEL, SEE "CONCRETE BARRIER RAIL" SHEET.
FOR TRANSVERSE CONSTRUCTION JOINT DETAIL, SEE "PLAN OF SPANS, SHEET 2 OF 3".
FOR POUR SEQUENCE, SEE SHEET "BILL OF MATERIALS"
FOR INTERMEDIATE STEEL DIAPHRAGM DETAILS, SEE "INTERMEDIATE STEEL DIAPHRAGMS FOR MODIFIED 54" PRESTRESSED CONCRETE GIRDER" SHEET.

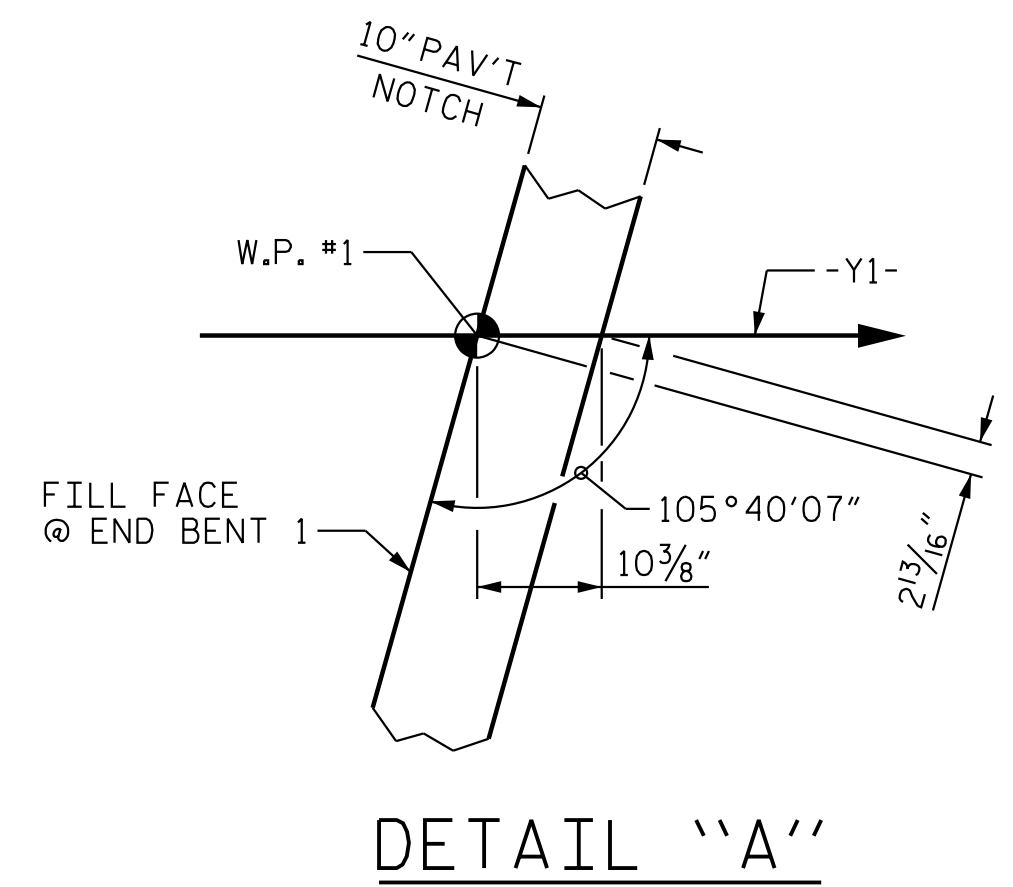

DETAIL "A"

PROJECT NO. R-2707D
CLEVELAND COUNTY
STATION: 19+82.46 -Y1-

SHEET 1 OF 3

STATE OF NORTH CAROLINA
DEPARTMENT OF TRANSPORTATION
RALEIGH
SUPERSTRUCTURE
PLAN OF SPANS
(SPAN A & PARTIAL SPAN B)

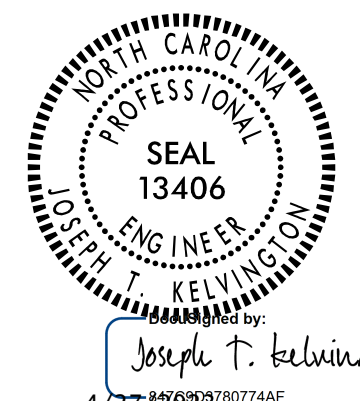

REVISIONS						SHEET NO.
NO.	BY:	DATE:	NO.	BY:	DATE:	S1-09
1			3			TOTAL SHEETS
2			4			32

DOCUMENT NOT CONSIDERED FINAL UNLESS ALL SIGNATURES COMPLETED



DRAWN BY: J. B. GEILE DATE: 01/25/18
CHECKED BY: N. D'AIUTO DATE: 01/30/18
DESIGN ENGINEER OF RECORD: J. KELVINGTON DATE: 04/27/23

4/27/2023 10:28:42 AM jHogenbush
c:\pvt\wv\king\dm55345\p2707D_SML_S01_220488.DGN