

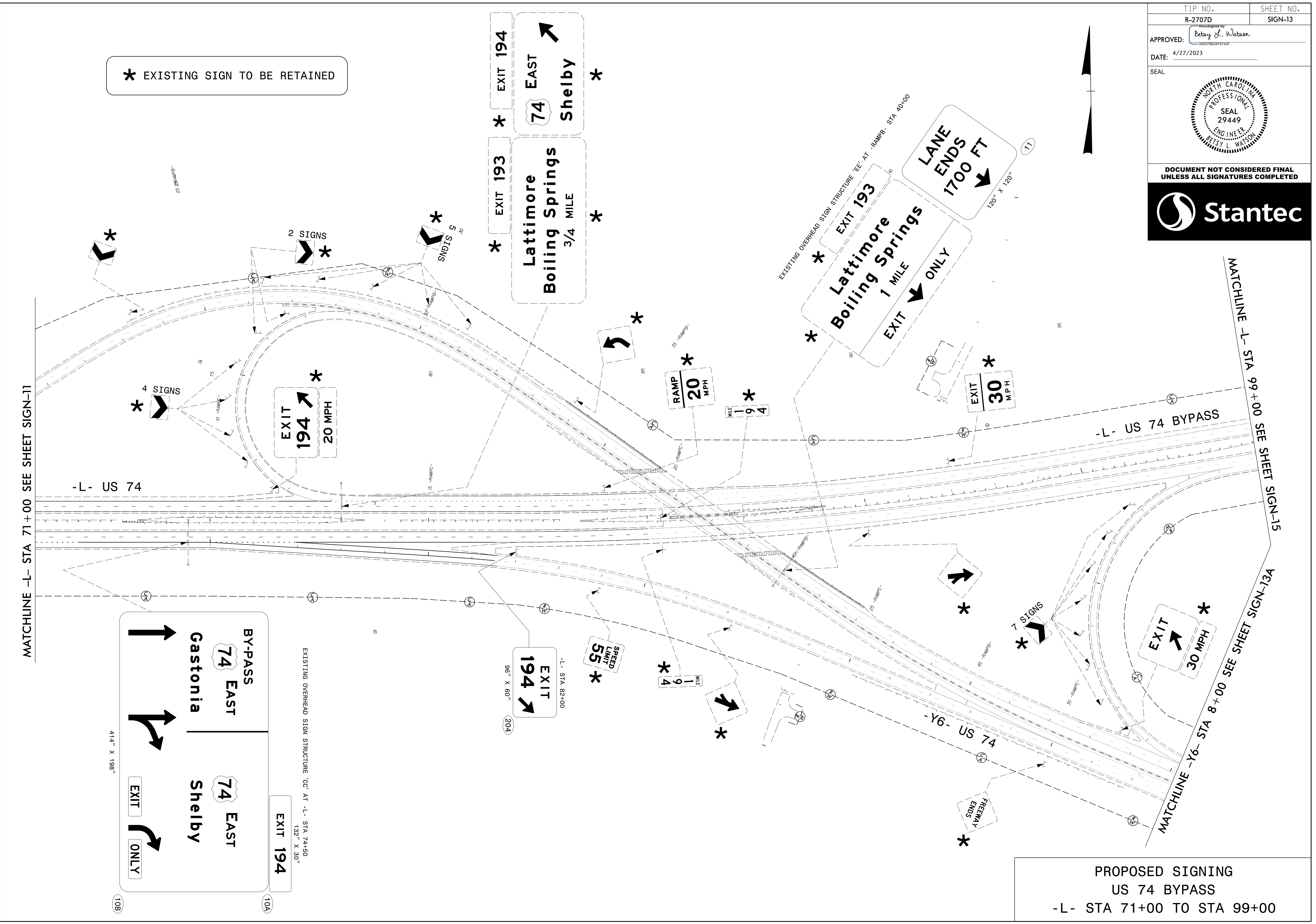

DOCUMENT NOT CONSIDERED FINAL UNLESS ALL SIGNATURES COMPLETED



\* EXISTING SIGN TO BE RETAINED

MATCHLINE -L- STA 71+00 SEE SHEET SIGN-11

MATCHLINE -L- STA 99+00 SEE SHEET SIGN-15

MATCHLINE -Y6- STA 8+00 SEE SHEET SIGN-13A

EXISTING OVERHEAD SIGN STRUCTURE '00' AT -L- STA 74+50  
132' X 30'

BY-PASS 74 EAST Gastonia	74 EAST Shelby
EXIT	EXIT ONLY

414' X 198'

EXIT 194

EXIT 194

EXIT 193  
Lattimore Boiling Springs  
1 MILE  
EXIT ONLY

LANE ENDS  
1700 FT

EXIT 30 MPH

EXIT 30 MPH

RAMP 20 MPH

SPEED LIMIT 55

\$\$\$\$\$SYTIME\$\$\$\$\$  
\$\$\$\$\$DGN\$\$\$\$\$  
\$\$\$\$\$USERNAME\$\$\$\$\$

PROPOSED SIGNING  
US 74 BYPASS  
-L- STA 71+00 TO STA 99+00