

PLANTING DETAILS

LIVE STAKES PLANTING DETAIL

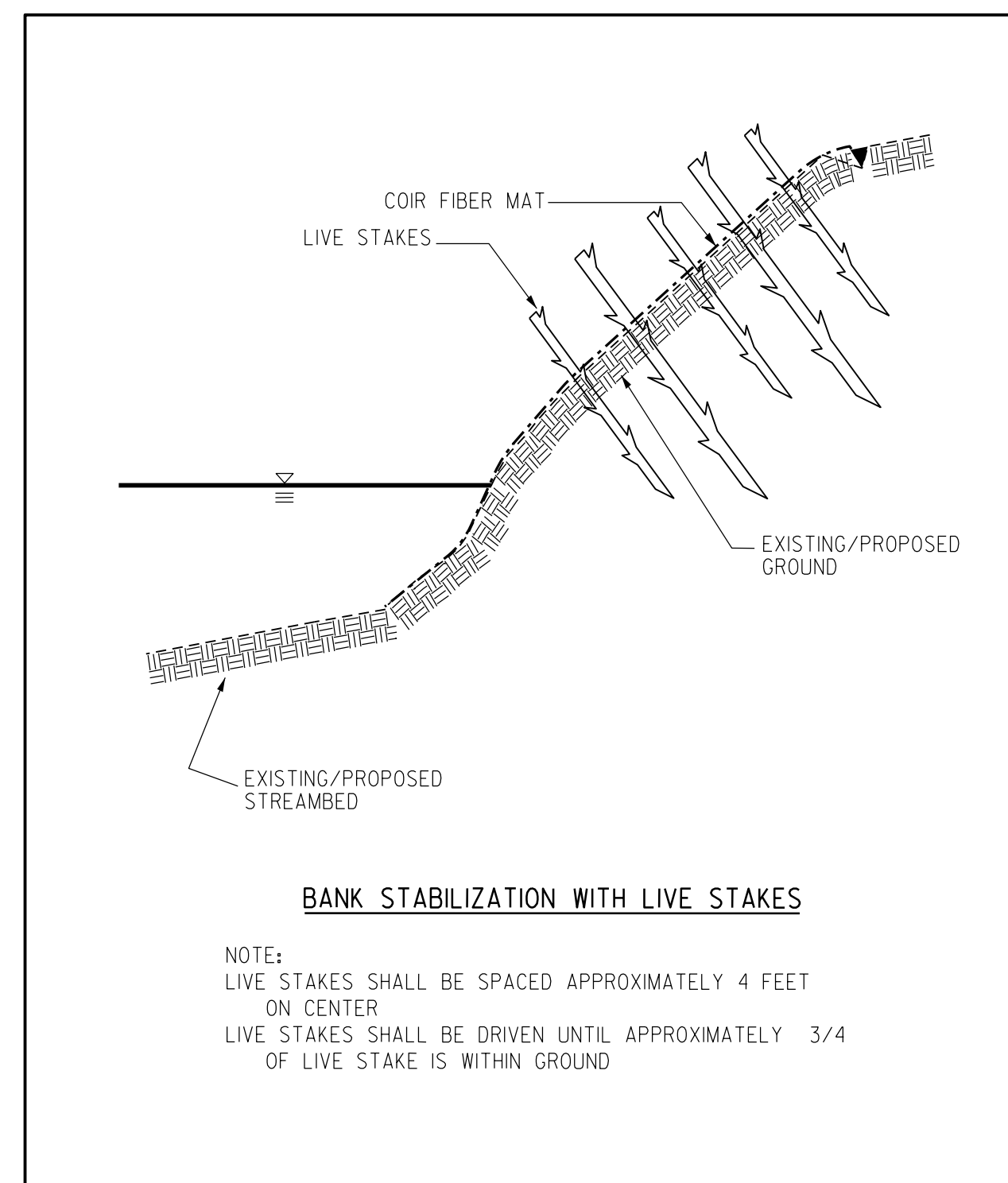

BAREROOT PLANTING DETAIL DOUBLE PLANTING METHOD USING THE K3C PLANTING BAR

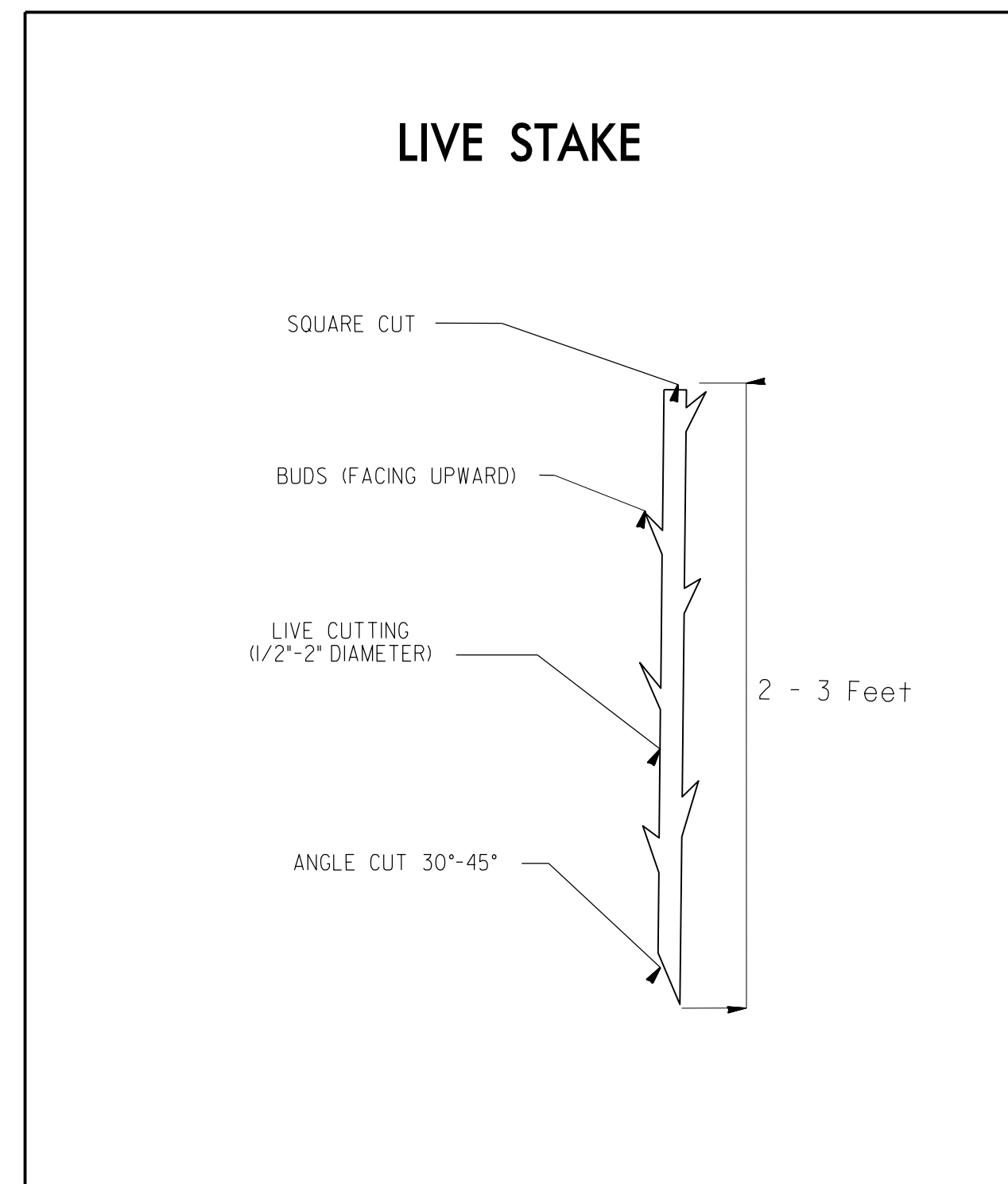
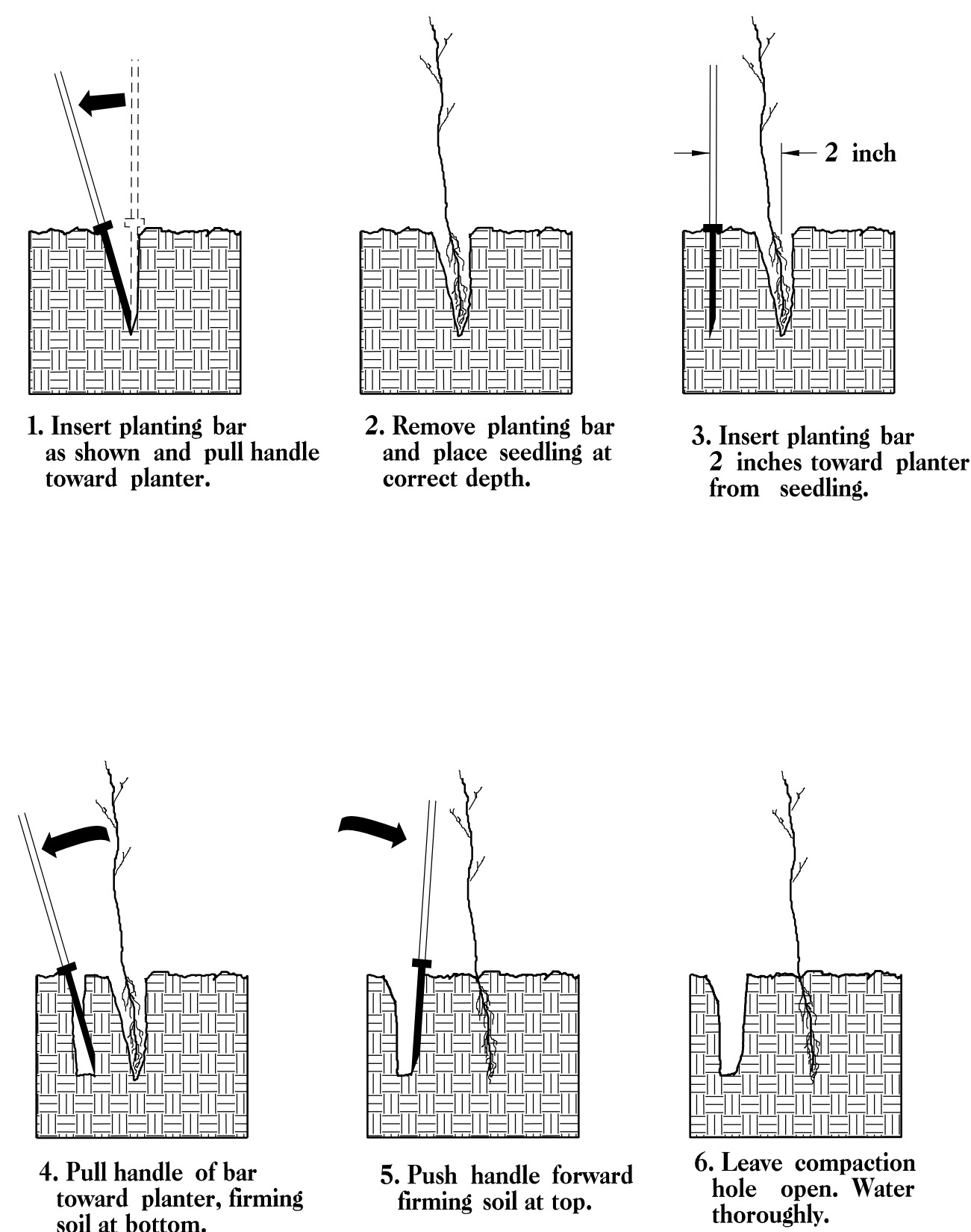

PLANTING NOTES:

PLANTING BAG
During planting, seedlings shall be kept in a moist canvas bag or similar container to prevent the root systems from drying.



K3C PLANTING BAR
Planting bar shall have a blade with a triangular cross section, and shall be 12 inches long, 4 inches wide and 1 inch thick at center.

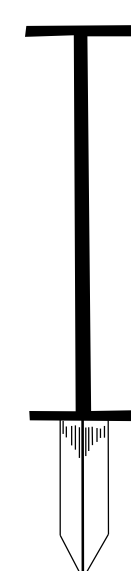

ROOT PRUNING
All seedlings shall be root pruned, if necessary, so that no roots extend more than 10 inches below the root collar.

- TYPE 1 STREAMBANK REFORESTATION SHALL BE PLANTED 3 FT. TO 5 FT. ON CENTER, RANDOM SPACING, AVERAGING 4 FT. ON CENTER, APPROXIMATELY 2724 PLANTS PER ACRE.
- TYPE 2 STREAMBANK REFORESTATION SHALL BE PLANTED 6 FT. TO 10 FT. ON CENTER, RANDOM SPACING, AVERAGING 8 FT. ON CENTER, APPROXIMATELY 680 PLANTS PER ACRE.
- NOTE: TYPE 1 AND TYPE 2 STREAMBANK REFORESTATION SHALL BE PAID FOR AS "STREAMBANK REFORESTATION"

STREAMBANK REFORESTATION TYPICAL

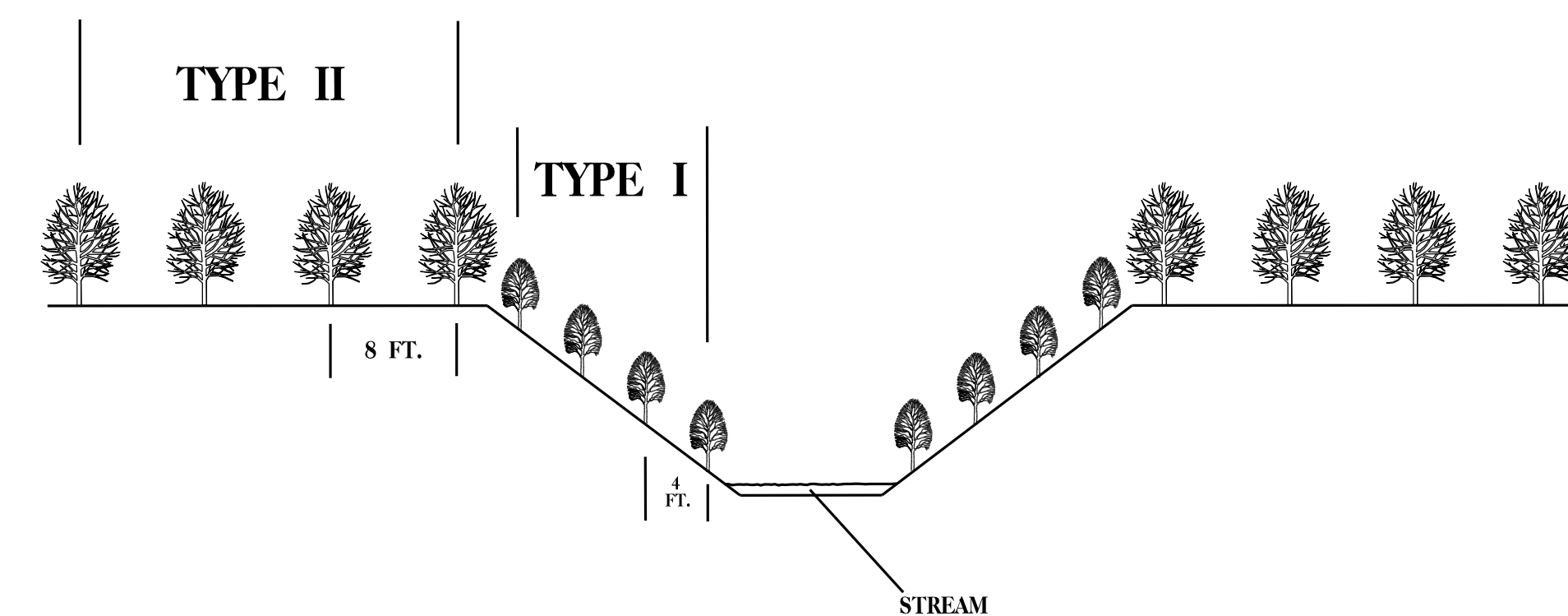

STREAMBANK REFORESTATION

MIXTURE, TYPE, SIZE, AND FURNISH SHALL CONFORM TO THE FOLLOWING:

TYPE 1

- 50% SALIX NIGRA BLACK WILLOW 2 ft - 3 ft LIVE STAKES
- 50% CORNUS AMOMUM SILKY DOGWOOD 2 ft - 3 ft LIVE STAKES

TYPE 2

- 25% LIRIODENDRON TULIPIFERA TULIP POPLAR 12 in - 18 in BR
- 25% PLATANUS OCCIDENTALIS AMERICAN SYCAMORE 12 in - 18 in BR
- 25% PRUNUS SEROTINA BLACK CHERRY 12 in - 18 in BR
- 25% BETULA NIGRA RIVER BIRCH 12 in - 18 in BR

- SEE REFORESTATION PLAN SHEETS FOR AREAS TO BE PLANTED

STREAMBANK REFORESTATION

DETAIL SHEET 1 OF 2