

09_08/2019

3/24/2023 J:\188905\14 B-5893 Bridge 19 over Cub Creek\Structures\2.0 Drafting\DCNs\401_001_B5893_SMU_TSH.dgn USJW674778

TIP PROJECT: B-5893

CONTRACT: C204491

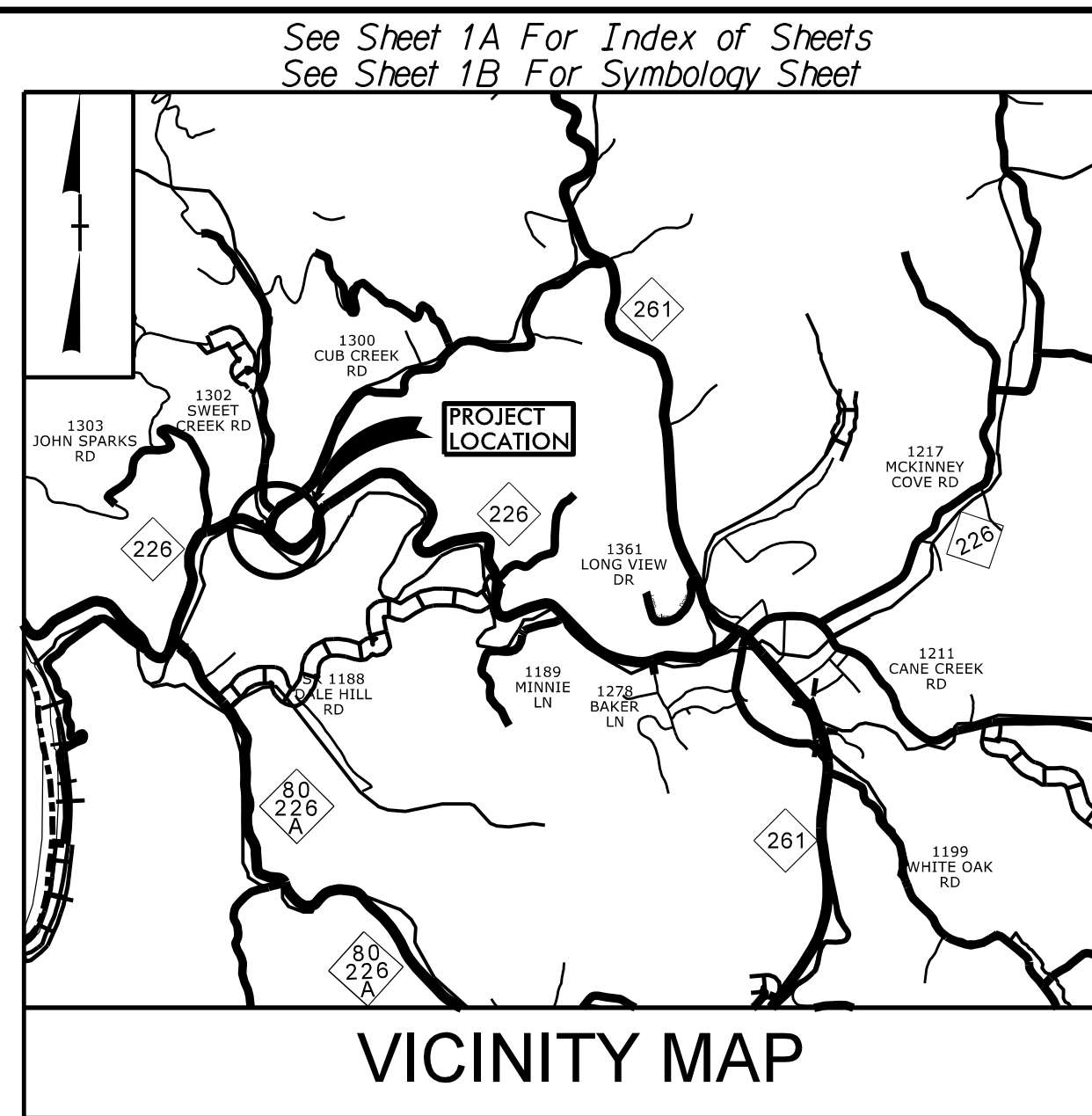

STATE OF NORTH CAROLINA
DIVISION OF HIGHWAYS

MITCHELL COUNTY

LOCATION: REPLACE BRIDGE No.19 OVER CUB CREEK ON NC 226

TYPE OF WORK: GRADING, DRAINAGE, PAVING, AND STRUCTURE

STATE	STATE PROJECT REFERENCE NO.	SHEET NO.	TOTAL SHEETS
N.C.	B-5893	1	
STATE PROJ. NO.	F.A. PROJ. NO.	DESCRIPTION	
48086.1.1	N/A	PE	
48086.2.1	N/A	RW & UTILITY	
48086.3.1	N/A	CONSTRUCTION	

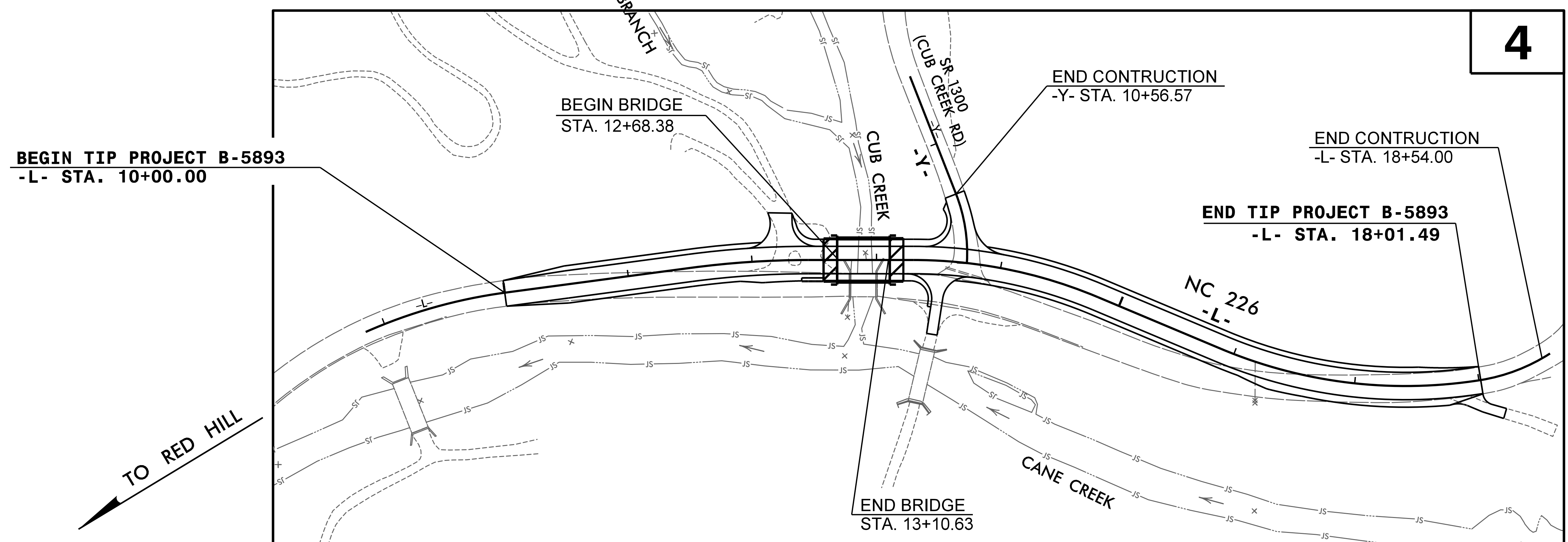

STRUCTURE

NCDOT CONTACT: DAVID STUTTS, PE
STRUCTURES MANAGEMENT UNIT

DOCUMENT NOT CONSIDERED FINAL
UNLESS ALL SIGNATURES COMPLETED

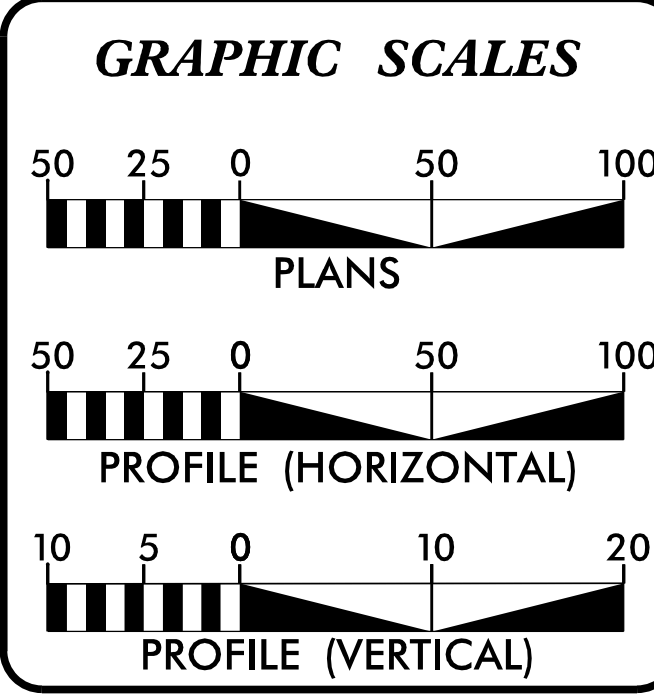

DESIGN DATA

ADT 2023 =	2088 VPD
ADT 2043 =	2388 VPD
K =	12 %
D =	55 %
T =	4 % *
V =	45 MPH
* TTST =	1% DUAL 3%
FUNC CLASS =	LOCAL
SUBREGIONAL TIER	

PROJECT LENGTH

LENGTH ROADWAY TIP PROJECT B-5893	=	0.144 MI
LENGTH STRUCTURE TIP PROJECT B-5893	=	0.008 MI
TOTAL LENGTH TIP PROJECT B-5893	=	0.152 MI

Prepared in the Office of
wsp
WSP USA
434 WHEATVILLE STREET
SUITE 100
RAVENHILL, NC 27601
TEL: 919.836.4000
FAX: 919.836.4099
LICENSE NO. F-0165

FOR THE NORTH CAROLINA DEPARTMENT OF TRANSPORTATION

2018 STANDARD SPECIFICATIONS

RIGHT OF WAY DATE: JAIME E. WHEATLEY, PE
JUNE 4, 2019
STRUCTURE DESIGN ENGINEER

LETTING DATE: JAIME E. WHEATLEY, PE
JUNE 20, 2023

STRUCTURE DESIGN ENGINEER

Seal: NORTH CAROLINA PROFESSIONAL ENGINEER, J. WHEATLEY, LICENSE NO. 036787, EXPIRES 12/24/2023

DocuSigned by:
Jaime Wheatley
P.E.

SIGNATURE:

