

09/08/19

See Sheet 1A For Index of Sheets  
See Sheet 1B For Symbology Sheet

# STATE OF NORTH CAROLINA DIVISION OF HIGHWAYS

## MITCHELL COUNTY

**LOCATION: REPLACE BRIDGE No. 19 OVER CUB CREEK ON NC 226**

**TYPE OF WORK: GRADING, DRAINAGE, PAVING, AND STRUCTURE**

STATE	STATE PROJECT REFERENCE NO.	SHEET NO.	TOTAL SHEETS
N.C.	<b>B-5893</b>	1	
STATE PROJ. NO.	F. A. PROJ. NO.	DESCRIPTION	
48086.1.1	N/A	PE	
48086.2.1	N/A	RW & UTILITY	
48086.3.1	N/A	CONSTRUCTION	

**TIP PROJECT: B-5893**

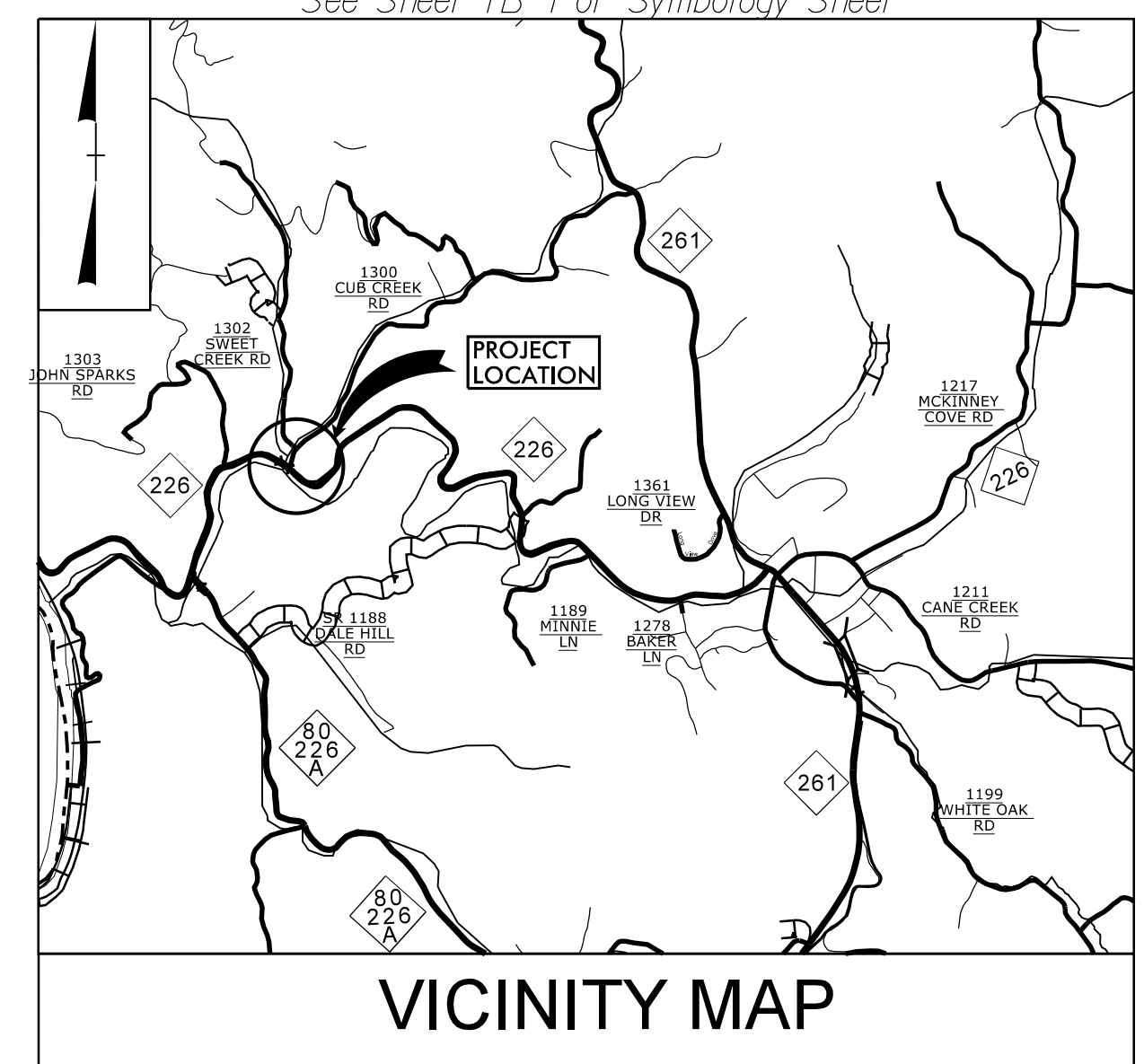

VICINITY MAP

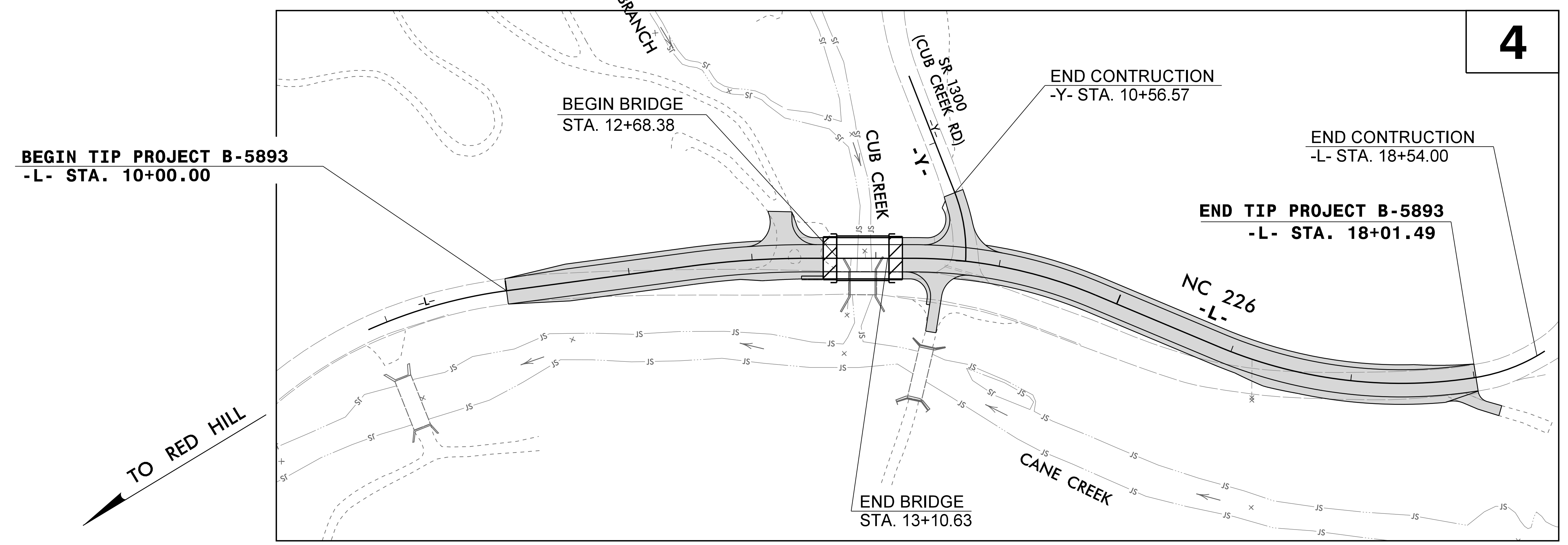

**CONTRACT: C204491**

**NCDOT CONTACT: DAVID STUTTS, PE**  
STRUCTURES MANAGEMENT UNIT

**DOCUMENT NOT CONSIDERED FINAL  
UNLESS ALL SIGNATURES COMPLETED**

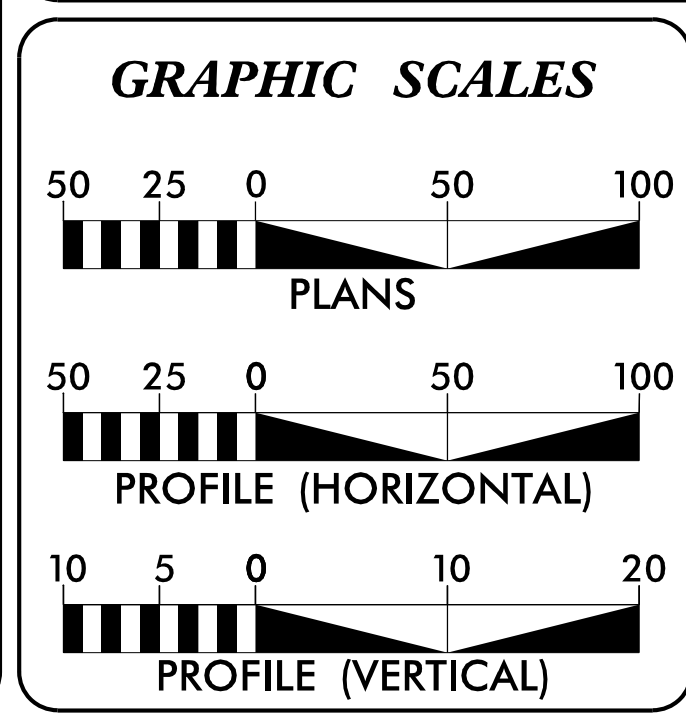

**DESIGN DATA**

ADT 2023 =	2088 VPD
ADT 2043 =	2388 VPD
K =	12 %
D =	55 %
T =	4 % *
V =	45 MPH
* TTST =	1% DUAL 3%
FUNC CLASS =	LOCAL
SUBREGIONAL TIER	

**PROJECT LENGTH**

LENGTH ROADWAY TIP PROJECT B-5893	=	0.144 MI
LENGTH STRUCTURE TIP PROJECT B-5893	=	0.008 MI
TOTAL LENGTH TIP PROJECT B-5893	=	0.152 MI

Prepared In the Office of  
**wsp**  
424 FAYETTEVILLE STREET  
SUITE 1500  
RALEIGH, NC 27601  
TEL: 919.836.4040  
FAX: 919.836.4099  
LICENSE NO. F-0165

FOR THE NORTH CAROLINA DEPARTMENT OF TRANSPORTATION

2018 STANDARD SPECIFICATIONS

**RIGHT OF WAY DATE:**  
JUNE 4, 2019

**LETTING DATE:**  
JUNE 20, 2023

**RONYELL THIGPEN, PE**  
PROJECT ENGINEER

**HOLLY CHRISTENBURY, PE**  
PROJECT DESIGN ENGINEER

**HYDRAULICS ENGINEER** 4/4/2023

DocuSigned by:  
*Charles Hafner*  
SIGNATURE:

**ROADWAY DESIGN ENGINEER**

DocuSigned by:  
*Holly Christenbury*  
SIGNATURE:

Professional Engineer Seals for Charles Hafner (032312) and Holly Christenbury (043139).

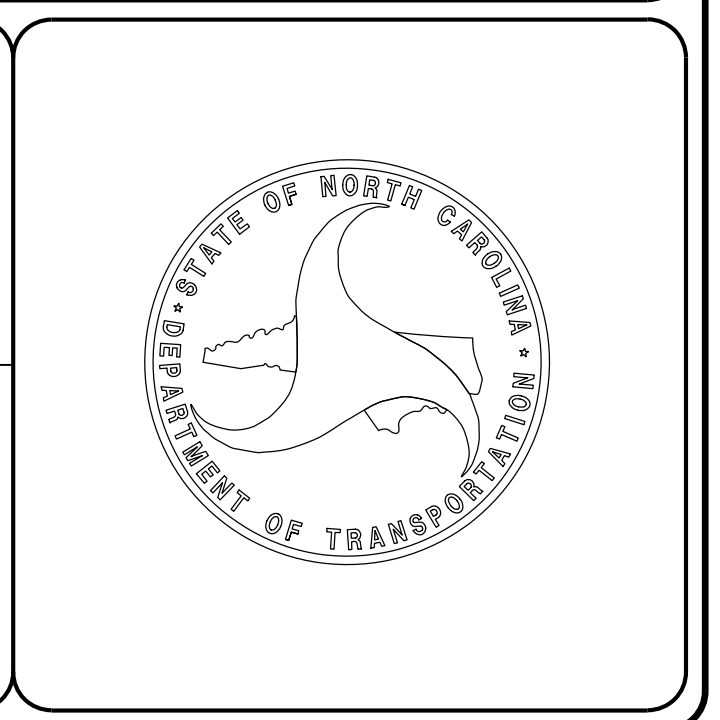

20-MAP-2023 18+50  
Roadway\Proj\B5893\_Rdy\_tsh.dgn  
WSP