

STATE	STATE PROJECT REFERENCE NO.	SHEET NO.	TOTAL SHEETS
N.C.	R-5725	RW01	

STATE OF NORTH CAROLINA
DIVISION OF HIGHWAYS

SURVEY CONTROL, EXISTING CENTERLINES,
RIGHT OF WAY, EASEMENTS AND PROPERTY TIES

GUILFORD COUNTY

TIP PROJECT: R-5725

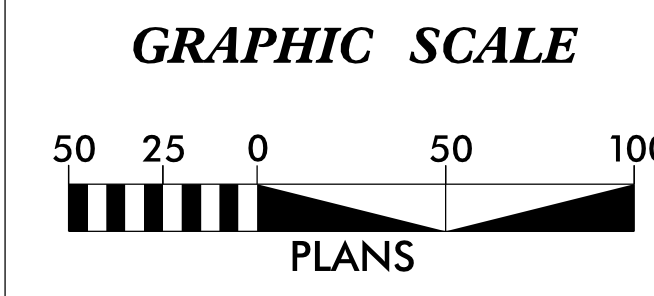
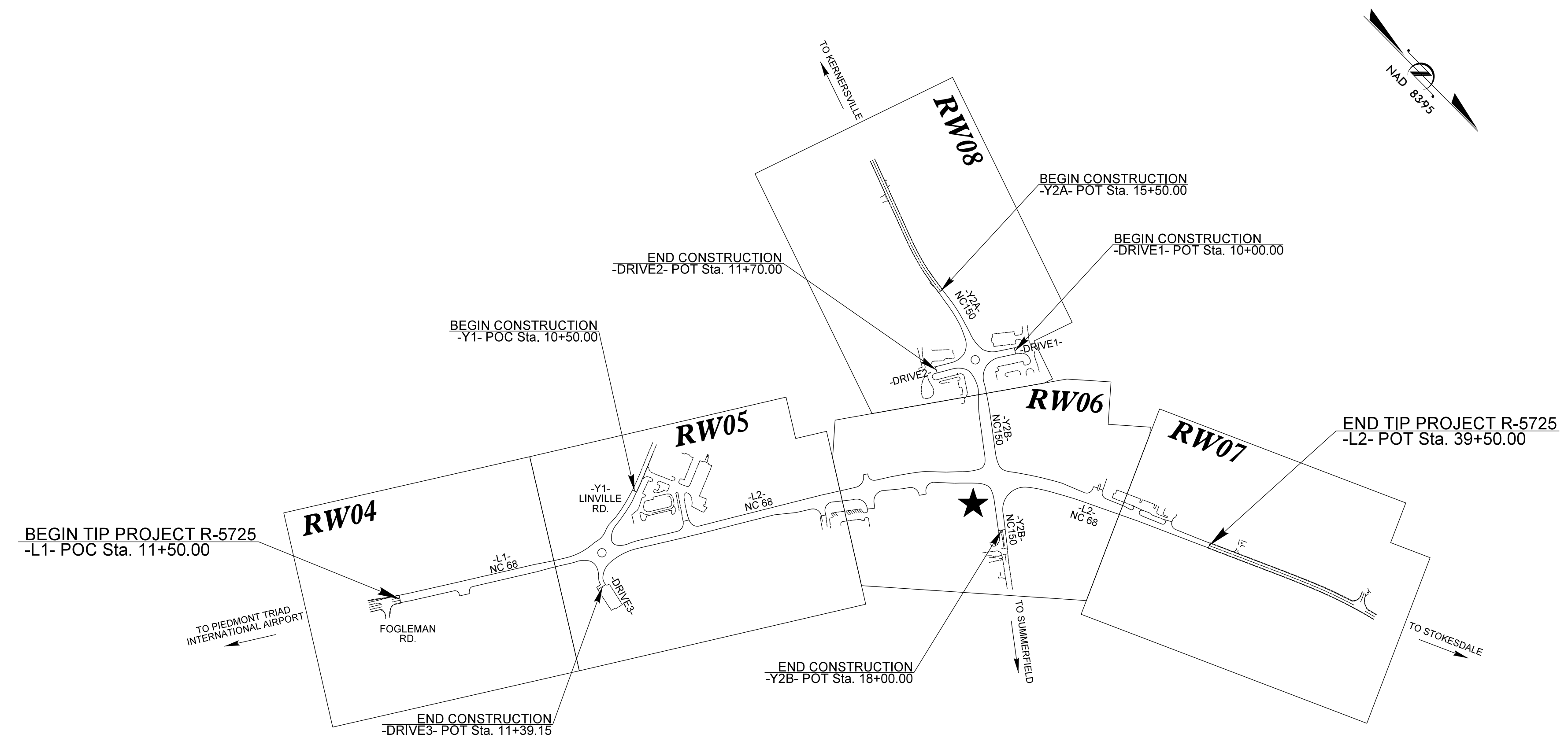

DATUM DESCRIPTION

THE LOCALIZED COORDINATE SYSTEM DEVELOPED FOR THIS PROJECT IS BASED ON THE STATE PLANE COORDINATES ESTABLISHED BY NCGS FOR MONUMENT "ACADEMY" WITH NAD 83/1995 STATE PLANE GRID COORDINATES OF NORTHING: 883,550.156(ft) EASTING: 1,707,972.155(ft) ELEVATION: 940.22(ft)

THE AVERAGE COMBINED GRID FACTOR USED ON THIS PROJECT (GROUND TO GRID) IS: 0.99996204

THE N.C. LAMBERT GRID BEARING AND LOCALIZED HORIZONTAL GROUND DISTANCE FROM "ACADEMY" TO -L2- STATION 28+84.08 IS N 89-20'21" E 67.08(ft)

ALL LINEAR DIMENSIONS ARE LOCALIZED HORIZONTAL DISTANCES VERTICAL DATUM USED IS NGVD 29

Prepared in the Office of:



2018 STANDARD SPECIFICATIONS

RIGHT OF WAY DATE:
10/13/2021

LETTING DATE:
06/20/2023

PROFESSIONAL LAND SURVEYOR

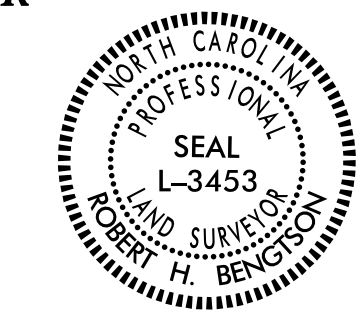

DocuSigned by:
Robert H. Bengtson
SIGNATURE:

3/9/2023
Date:

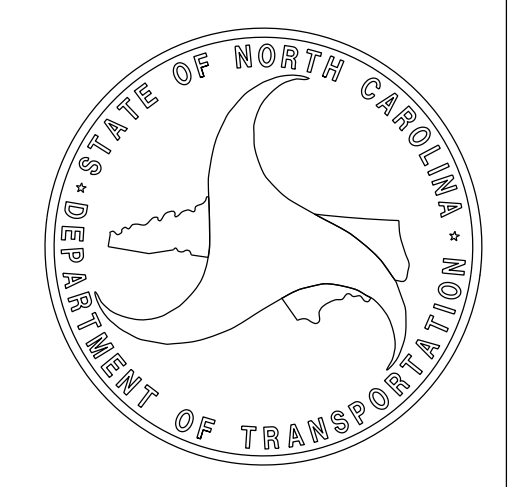

08-MAR-2023 14:25 P:\15042261\CAD\Survey\MICROSTATION\RW REVISIONS\RW SHEETS\R5725\LS.RW01_230308.dgn D:\15042261\CAD\Survey\MICROSTATION\RW REVISIONS\RW SHEETS\AT PF25GWB9